

| CURRENT OWNER  |            | TOPO             |                | UTILITIES         |              | STRT / ROAD |                        | LOCATION  |            | CURRENT ASSESSMENT     |       |                                      |                  | 801<br>FY2024<br>BARNSTABLE, MA<br><br><b>VISION</b> |                   |                                |              |                    |                    |
|--|------------|------------------|----------------|-------------------|--------------|-------------|------------------------|---|------------|------------------------|-------|--------------------------------------|------------------|--|-------------------|--------------------------------|--------------|--------------------|--------------------|
| FITZGERALD, JOHN M & TERRI GRE<br><br>316 BEAVER ST UNIT 403<br><br>SEWICKLEY PA 15143 |            | 1                | Level          | 2                 | Public Water | 1           | Paved                  |   |            | Description            | Code  | Assessed                             | Assessed         |  |                   | RESIDENTL<br>RES LAND          | 1010<br>1010 | 220,200<br>170,000 | 220,200<br>170,000 |
|  |            | 4                | Gas            |                   |              |             |                        |   |            |                        |       |                                      |                  |  |                   |                                |              |                    |                    |
|  |            | 6                | Septic         |                   |              |             |                        |   |            |                        |       |                                      |                  |  |                   |                                |              |                    |                    |
| <b>SUPPLEMENTAL DATA</b>   |            |                  |                |                   |              |             |                        |   |            | Total                  |       |                                      |                  | 390,200  | 390,200           |                                |              |                    |                    |
| Alt Prcl ID  |            | Split Zonin      |                | Plan Ref.         |              | 525/20      |                        |   |            |                        |       |                                      |                  |  |                   |                                |              |                    |                    |
| BID Parcel   |            | ResExpt Q        |                | #DL 1             |              | LOT 1       |                        | #DL 2   |            |                        |       |                                      |                  |  |                   |                                |              |                    |                    |
| GIS ID   |            | F_983284_2695796 |                | Assoc Pid#        |              |             |                        |   |            |                        |       |                                      |                  |  |                   |                                |              |                    |                    |
| RECORD OF OWNERSHIP  |            |                  |                | BK-VOL/PAGE       |              | SALE DATE   |                        | Q/U   |            | V/I                    |       | SALE PRIC                            |                  | VC   |                   | PREVIOUS ASSESSMENTS (HISTORY) |              |                    |                    |
| FITZGERALD, JOHN M & TERRI GREGO   |            |                  |                | 25046             | 0025         | 11-30-2010  | U                      | I   | 152,000    | 1S                     |       |                                      |                  |  |                   |                                |              |                    |                    |
| FEDERAL NATIONAL MORTGAGE ASSO   |            |                  |                | 24862             | 0161         | 09-28-2010  | U                      | I   | 182,002    | 1L                     | 2023  | 1010                                 | 187,700          | 2022   | 1010              | 153,400                        | 2021         | 1010               | 119,400            |
| DUMONT, CAROL  |            |                  |                | 21350             | 0111         | 09-15-2006  | Q                      | I   | 199,500    | 00                     |       | 1010                                 | 168,000          |  | 1010              | 119,400                        |              | 1010               | 6,200              |
| FBP REALTY LLC   |            |                  |                | 13905             | 0082         | 06-05-2001  | U                      | I   | 100        | 1                      |       |                                      |                  |  |                   |                                |              |                    |                    |
| PAPPAS, FRED A B   |            |                  |                | 8033              | 0004         | 05-22-1992  | U                      | I   | 95,000     | 1                      |       |                                      |                  |  |                   |                                |              |                    |                    |
| Total  |            |                  |                |                   |              |             |                        |   |            | 355,700                | Total | 272,800                              | Total            | 245,000  |                   |                                |              |                    |                    |
| EXEMPTIONS   |            |                  |                | OTHER ASSESSMENTS |              |             |                        | This signature acknowledges a visit by a Data Collector or Assessor |            |                        |       |                                      |                  |  |                   |                                |              |                    |                    |
| Year   | Code       | Description      |                | Amount            |              | Code        | Description            | Number  | Amount     | Comm Int               |       |                                      |                  |  |                   |                                |              |                    |                    |
|  |            |                  |                | 0.00              |              |             |                        |   |            |                        |       | <b>APPRAISED VALUE SUMMARY</b>       |                  |  |                   |                                |              |                    |                    |
| Total  |            |                  |                | 0.00              |              |             |                        |   |            |                        |       | Appraised Bldg. Value (Card) 214,000 |                  |  |                   |                                |              |                    |                    |
|  |            |                  |                |                   |              |             |                        |   |            |                        |       | Appraised Xf (B) Value (Bldg) 0      |                  |  |                   |                                |              |                    |                    |
|  |            |                  |                |                   |              |             |                        |   |            |                        |       | Appraised Ob (B) Value (Bldg) 6,200  |                  |  |                   |                                |              |                    |                    |
|  |            |                  |                |                   |              |             |                        |   |            |                        |       | Appraised Land Value (Bldg) 170,000  |                  |  |                   |                                |              |                    |                    |
|  |            |                  |                |                   |              |             |                        |   |            |                        |       | Special Land Value 0                 |                  |  |                   |                                |              |                    |                    |
|  |            |                  |                |                   |              |             |                        |   |            |                        |       | Total Appraised Parcel Value 390,200 |                  |  |                   |                                |              |                    |                    |
|  |            |                  |                |                   |              |             |                        |   |            |                        |       | Valuation Method C                   |                  |  |                   |                                |              |                    |                    |
|  |            |                  |                |                   |              |             |                        |   |            |                        |       | Total Appraised Parcel Value 390,200 |                  |  |                   |                                |              |                    |                    |
| BUILDING PERMIT RECORD   |            |                  |                |                   |              |             |                        |   |            | VISIT / CHANGE HISTORY |       |                                      |                  |  |                   |                                |              |                    |                    |
| Permit Id  | Issue Date | Type             | Description    | Amount            | Insp Date    | % Comp      | Date Comp              | Comments  |            | Date                   | Id    | Type                                 | Is               | Cd   | Purpost/Result    |                                |              |                    |                    |
| BLDR-23-68   | 05-19-2023 | 809              | Deck           | 5,500             |              | 0           |                        | Entry to new addition indicated                                     |            | 08-16-2021             | BM    | 22                                   |                  | 22   | Change of Address |                                |              |                    |                    |
| BLDR-23-32   | 04-05-2023 | 882              | Detached Acce  | 150,000           |              | 0           |                        | Construct detached garage wit                                       |            | 05-26-2020             | WD    |                                      |                  | FR   | Field Review      |                                |              |                    |                    |
| 201105455  | 10-18-2011 | RA               | Remodel-Additi | 75,000            | 06-07-2012   | 100         | 06-30-2012             | ADD FAMRM,WDCCK-REM0D   |            | 11-22-2017             | SR    | 02                                   |                  | 03   | Cycl Insp Comp    |                                |              |                    |                    |
| 200804010  | 07-28-2008 | OB               | Out Building   | 0                 | 01-20-2009   | 100         | 06-30-2010             | 8 X 8 SHED PP   |            | 04-22-2015             | JR    | 03                                   |                  | 03   | Cycl Insp Comp    |                                |              |                    |                    |
| B35171   | 06-01-1992 | AD               | Addition       | 20,000            | 01-15-1993   | 100         | 06-30-1993             | HY REMOD  |            | 01-31-2014             | LH    | 03                                   |                  | 16   | In Office Review  |                                |              |                    |                    |
|  |            |                  |                |                   |              |             |                        |   |            | 06-27-2012             | RB    | 03                                   |                  | 16   | In Office Review  |                                |              |                    |                    |
|  |            |                  |                |                   |              |             |                        |   |            | 03-13-2012             | JC    | 03                                   |                  | 16   | In Office Review  |                                |              |                    |                    |
| LAND LINE VALUATION SECTION  |            |                  |                |                   |              |             |                        |   |            |                        |       |                                      |                  |  |                   |                                |              |                    |                    |
| B  | Use Code   | Description      | Zone           | LA                | Land Units   | Unit Price  | Size Adj               | AC Disc   | Site Index | Cond.                  | Nbhd. | Nbhd. Adj                            | Notes            | Location Adjustmen                                   | Adj Unit P        | Land Value                     |              |                    |                    |
| 1  | 1010       | Single Fam M-0   | RB             | 4                 | 0.240        | AC          | 176,344.00             | 3.49265   | 1.0000     | 5                      | 1.00  | 0106                                 | 1.150            |  | 1.0000            | 708,303.3                      | 170,000      |                    |                    |
| Total Card Land Units  |            |                  |                |                   | 0.24         | AC          | Parcel Total Land Area |   |            |                        |       | 0.24                                 | Total Land Value |  |                   |                                |              | 170,000            |                    |

| <b>CONSTRUCTION DETAIL</b> |    |                | <b>CONSTRUCTION DETAIL (CONTINUED)</b> |    |             |
|----------------------------|----|----------------|--|----|-------------|
| Element                    | Cd | Description    | Element                                | Cd | Description |
| Style                      | 06 | Conventional   |  |    |             |
| Model                      | 01 | Residential    |  |    |             |
| Grade:                     | C  | Average        |  |    |             |
| Stories                    | 1  | 1 Story        |  |    |             |
| Exterior Wall 1            | 14 | Wood Shingle   |  |    |             |
| Exterior Wall 2            |    |                |  |    |             |
| RooF Structure             | 03 | Gable/Hip      |  |    |             |
| RooF Cover                 | 03 | Asph/F Gls/Cmp |  |    |             |
| Interior Wall 1            | 05 | Drywall        |  |    |             |
| Interior Wall 2            |    |                |  |    |             |
| Interior Floor 1           | 14 | Carpet         |  |    |             |
| Interior Floor 2           | 12 | Hardwood       |  |    |             |
| Heat Fuel                  | 03 | Gas            |  |    |             |
| Heat Type                  | 05 | Hot Water      |  |    |             |
| AC Type                    | 01 | None           |  |    |             |
| Bedrooms                   | 01 | 1 Bedroom      |  |    |             |
| Full Baths                 | 1  |                |  |    |             |
| Half Baths                 | 0  |                |  |    |             |
| Extra Fixtures             |    |                |  |    |             |
| Total Rooms                | 3  | 3 Rooms        |  |    |             |
| Bath Style                 |    |                |  |    |             |
| Kitchen Style              |    |                |  |    |             |
| Occupancy                  |    |                |  |    |             |
| UsrflD 105                 |    |                |  |    |             |
| Accessory Apt              |    |                |  |    |             |
| Foundation Alt             | 09 | Blk/Pour Ftgs  |  |    |             |
| Rms Prts                   |    |                |  |    |             |
| Bath Split                 | 10 | 1 Full-0 Half  |  |    |             |

| <b>CONDO DATA</b> |      |             |         |     |
|-------------------|------|-------------|---------|-----|
| Parcel Id         |      | C           | Ownr    | 0.0 |
|                   |      |             | B       | S   |
| Adjust Type       | Code | Description | Factor% |     |
| Condo Flr         |      |             |         |     |
| Condo Unit        |      |             |         |     |

| <b>COST / MARKET VALUATION</b> |         |
|--------------------------------|---------|
| Building Value New             | 253,376 |
| Year Built                     | 1955    |
| Effective Year Built           | 1988    |
| Depreciation Code              | G       |
| Remodel Rating                 |         |
| Year Remodeled                 |         |
| Depreciation %                 | 24      |
| Functional Obsol               | 0       |
| External Obsol                 | 0       |
| Trend Factor                   | 1       |
| Condition                      |         |
| Condition %                    |         |
| Percent Good                   | 76      |
| RCNLD                          | 214,000 |
| Dep % Ovr                      |         |
| Dep Ovr Comment                |         |
| Misc Imp Ovr                   |         |
| Misc Imp Ovr Comment           |         |
| Cost to Cure Ovr               |         |
| Cost to Cure Ovr Comment       |         |

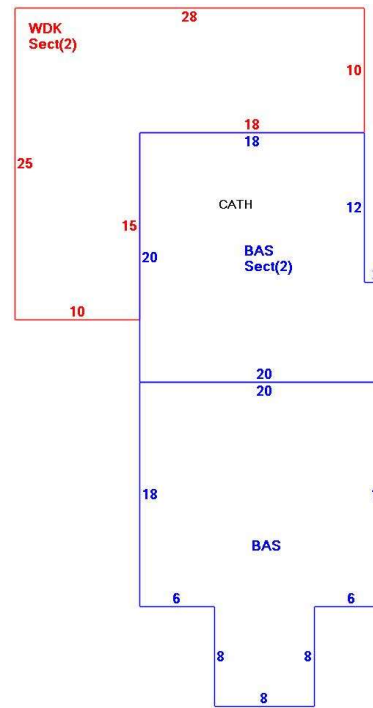

| <b>OB - OUTBUILDING &amp; YARD ITEMS(L) / XF - BUILDING EXTRA FEATURES(B)</b> |             |     |       |            |        |          |      |       |            |             |
|---|-------------|-----|-------|------------|--------|----------|------|-------|------------|-------------|
| Code  | Description | L/B | Units | Unit Price | Yr Blt | Cond. Cd | % Gd | Grade | Grade Adj. | Appr. Value |
|   |             |     |       |            |        |          |      |       |            |             |

| <b>BUILDING SUB-AREA SUMMARY SECTION</b> |             |             |            |          |           |                |  |
|--|-------------|-------------|------------|----------|-----------|----------------|--|
| Code                                     | Description | Living Area | Floor Area | Eff Area | Unit Cost | Undeprec Value |  |
| BAS                                      | First Floor | 424         | 424        | 424      | 316.72    | 134,289        |  |
| Ttl Gross Liv / Lease Area               |             | 424         | 424        | 424      |           | 134,289        |  |



| CURRENT OWNER  |            | TOPO                    |                | UTILITIES                |              | STRT / ROAD      |                        | LOCATION                        |            | CURRENT ASSESSMENT              |  |   |                                       | 801<br>FY2024<br>BARNSTABLE, MA<br><br><b>VISION</b> |                   |                       |              |                    |                    |
|--|------------|-------------------------|----------------|--------------------------|--------------|------------------|------------------------|---------------------------------|------------|---------------------------------|--|---|---------------------------------------|--|-------------------|-----------------------|--------------|--------------------|--------------------|
| FITZGERALD, JOHN M & TERRI GRE<br><br>316 BEAVER ST UNIT 403<br><br>SEWICKLEY PA 15143 |            | 1                       | Level          | 2                        | Public Water | 1                | Paved                  |                                 |            | Description                     | Code   | Assessed  | Assessed                              |  |                   | RESIDENTL<br>RES LAND | 1010<br>1010 | 220,200<br>170,000 | 220,200<br>170,000 |
|  |            | 4                       | Gas            |                          |              |                  |                        |                                 |            |                                 |  |   |                                       |  |                   |                       |              |                    |                    |
|  |            | 6                       | Septic         |                          |              |                  |                        |                                 |            |                                 |  |   |                                       |  |                   |                       |              |                    |                    |
| <b>SUPPLEMENTAL DATA</b>   |            |                         |                |                          |              |                  |                        |                                 |            | Total                           |  |   |                                       | 390,200  | 390,200           |                       |              |                    |                    |
| Alt Prcl ID  |            | Split Zonin             |                | Plan Ref.                |              | Land Ct#         |                        | 525/20                          |            |                                 |  |   |                                       |  |                   |                       |              |                    |                    |
| BID Parcel   |            | #SR                     |                | Life Estate              |              | PP STATU         |                        |                                 |            |                                 |  |   |                                       |  |                   |                       |              |                    |                    |
| ResExpt Q  |            | #DL 1 LOT 1             |                | Assoc Pid#               |              |                  |                        |                                 |            |                                 |  |   |                                       |  |                   |                       |              |                    |                    |
| #DL 2  |            | GIS ID F_983284_2695796 |                |                          |              |                  |                        |                                 |            |                                 |  |   |                                       |  |                   |                       |              |                    |                    |
| <b>RECORD OF OWNERSHIP</b>   |            |                         |                | <b>BK-VOL/PAGE</b>       |              | <b>SALE DATE</b> |                        | <b>Q/U</b>                      | <b>V/I</b> | <b>SALE PRIC</b>                |  | <b>VC</b>   | <b>PREVIOUS ASSESSMENTS (HISTORY)</b> |  |                   |                       |              |                    |                    |
| FITZGERALD, JOHN M & TERRI GREGO   |            |                         |                | 25046                    | 0025         | 11-30-2010       | U                      | I                               | 152,000    | 1S                              | Year Code Assessed Year Code Assessed V Year Code Assessed |   |                                       |  |                   |                       |              |                    |                    |
| FEDERAL NATIONAL MORTGAGE ASSO   |            |                         |                | 24862                    | 0161         | 09-28-2010       | U                      | I                               | 182,002    | 1L                              | 2023   | 1010  | 187,700                               | 2022   | 1010              | 153,400               | 2021         | 1010               | 119,400            |
| DUMONT, CAROL  |            |                         |                | 21350                    | 0111         | 09-15-2006       | Q                      | I                               | 199,500    | 00                              |  | 1010  | 168,000                               |  | 1010              | 119,400               |              | 1010               | 119,400            |
| FBP REALTY LLC   |            |                         |                | 13905                    | 0082         | 06-05-2001       | U                      | I                               | 100        | 1                               |  |   |                                       |  |                   |                       |              | 1010               | 6,200              |
| PAPPAS, FRED A B   |            |                         |                | 8033                     | 0004         | 05-22-1992       | U                      | I                               | 95,000     | 1                               |  |   |                                       |  |                   |                       |              |                    |                    |
| Total  |            |                         |                |                          |              |                  |                        |                                 |            | 355,700                         | Total  | 272,800   | Total                                 | 245,000  |                   |                       |              |                    |                    |
| <b>EXEMPTIONS</b>  |            |                         |                | <b>OTHER ASSESSMENTS</b> |              |                  |                        |                                 |            |                                 |  | This signature acknowledges a visit by a Data Collector or Assessor |                                       |  |                   |                       |              |                    |                    |
| Year   | Code       | Description             |                | Amount                   | Code         | Description      | Number                 | Amount                          | Comm Int   |                                 |  |   |                                       |  |                   |                       |              |                    |                    |
|  |            |                         |                |                          |              |                  |                        |                                 |            |                                 |  |   |                                       |  |                   |                       |              |                    |                    |
| Total  |            |                         |                | 0.00                     |              |                  |                        |                                 |            |                                 |  | <b>APPRAISED VALUE SUMMARY</b>                                      |                                       |  |                   |                       |              |                    |                    |
| Nbhd   |            |                         |                | Nbhd Name                |              | B                |                        | Tracing                         |            | Batch                           |  | Appraised Bldg. Value (Card) 214,000                                |                                       |  |                   |                       |              |                    |                    |
| 0106   |            |                         |                |                          |              |                  |                        | HYAN                            |            | Appraised Xf (B) Value (Bldg) 0 |  |   |                                       |  |                   |                       |              |                    |                    |
| <b>NOTES</b>   |            |                         |                |                          |              |                  |                        |                                 |            |                                 |  |   | Appraised Ob (B) Value (Bldg) 6,200   |  |                   |                       |              |                    |                    |
|  |            |                         |                |                          |              |                  |                        |                                 |            |                                 |  |   | Appraised Land Value (Bldg) 170,000   |  |                   |                       |              |                    |                    |
|  |            |                         |                |                          |              |                  |                        |                                 |            |                                 |  |   | Special Land Value 0                  |  |                   |                       |              |                    |                    |
|  |            |                         |                |                          |              |                  |                        |                                 |            |                                 |  |   | Total Appraised Parcel Value 390,200  |  |                   |                       |              |                    |                    |
|  |            |                         |                |                          |              |                  |                        |                                 |            |                                 |  |   | Valuation Method C                    |  |                   |                       |              |                    |                    |
|  |            |                         |                |                          |              |                  |                        |                                 |            |                                 |  |   | Total Appraised Parcel Value 390,200  |  |                   |                       |              |                    |                    |
| <b>BUILDING PERMIT RECORD</b>  |            |                         |                |                          |              |                  |                        |                                 |            | <b>VISIT / CHANGE HISTORY</b>   |  |   |                                       |  |                   |                       |              |                    |                    |
| Permit Id  | Issue Date | Type                    | Description    | Amount                   | Insp Date    | % Comp           | Date Comp              | Comments                        |            | Date                            | Id   | Type  | Is                                    | Cd   | Purpost/Result    |                       |              |                    |                    |
| BLDR-23-68   | 05-19-2023 | 809                     | Deck           | 5,500                    |              | 0                |                        | Entry to new addition indicated |            | 08-16-2021                      | BM   | 22  |                                       | 22   | Change of Address |                       |              |                    |                    |
| BLDR-23-32   | 04-05-2023 | 882                     | Detached Acce  | 150,000                  |              | 0                |                        | Construct detached garage wit   |            | 05-26-2020                      | WD   |   |                                       | FR   | Field Review      |                       |              |                    |                    |
| 201105455  | 10-18-2011 | RA                      | Remodel-Additi | 75,000                   | 06-07-2012   | 100              | 06-30-2012             | ADD FAMRM,WDCCK-REM0D           |            | 11-22-2017                      | SR   | 02  |                                       | 03   | Cycl Insp Comp    |                       |              |                    |                    |
| 200804010  | 07-28-2008 | OB                      | Out Building   | 0                        | 01-20-2009   | 100              | 06-30-2010             | 8 X 8 SHED PP                   |            | 04-22-2015                      | JR   | 03  |                                       | 03   | Cycl Insp Comp    |                       |              |                    |                    |
| B35171   | 06-01-1992 | AD                      | Addition       | 20,000                   | 01-15-1993   | 100              | 06-30-1993             | HY REMOD                        |            | 01-31-2014                      | LH   | 03  |                                       | 16   | In Office Review  |                       |              |                    |                    |
|  |            |                         |                |                          |              |                  |                        |                                 |            | 06-27-2012                      | RB   | 03  |                                       | 16   | In Office Review  |                       |              |                    |                    |
|  |            |                         |                |                          |              |                  |                        |                                 |            | 03-13-2012                      | JC   | 03  |                                       | 16   | In Office Review  |                       |              |                    |                    |
| <b>LAND LINE VALUATION SECTION</b>   |            |                         |                |                          |              |                  |                        |                                 |            |                                 |  |   |                                       |  |                   |                       |              |                    |                    |
| B  | Use Code   | Description             | Zone           | LA                       | Land Units   | Unit Price       | Size Adj               | AC Disc                         | Site Index | Cond.                           | Nbhd.  | Nbhd. Adj   | Notes                                 | Location Adjustmen                                   | Adj Unit P        | Land Value            |              |                    |                    |
| 1  | 1010       | Single Fam M-0          | RB             | 4                        | 0.240        | AC               | 176,344.00             | 3.49265                         | 1.0000     | 5                               | 1.00   | 0106  | 1.150                                 |  | 1.0000            | 708,303.3             | 170,000      |                    |                    |
| Total Card Land Units  |            |                         |                |                          | 0.24         | AC               | Parcel Total Land Area |                                 |            |                                 |  | 0.24  | Total Land Value                      |  |                   |                       |              | 170,000            |                    |

| CONSTRUCTION DETAIL |    |                | CONSTRUCTION DETAIL (CONTINUED) |    |             |
|---------------------|----|----------------|---------------------------------|----|-------------|
| Element             | Cd | Description    | Element                         | Cd | Description |
| Style               | 06 | Conventional   |                                 |    |             |
| Model               | 01 | Residential    |                                 |    |             |
| Grade:              | C  | Average        |                                 |    |             |
| Stories             | 1  | 1 Story        |                                 |    |             |
| Exterior Wall 1     | 14 | Wood Shingle   |                                 |    |             |
| Exterior Wall 2     |    |                |                                 |    |             |
| RooF Structure      | 03 | Gable/Hip      |                                 |    |             |
| RooF Cover          | 03 | Asph/F Gls/Cmp |                                 |    |             |
| Interior Wall 1     | 05 | Drywall        |                                 |    |             |
| Interior Wall 2     |    |                |                                 |    |             |
| Interior Floor 1    | 14 | Carpet         |                                 |    |             |
| Interior Floor 2    | 12 | Hardwood       |                                 |    |             |
| Heat Fuel           | 03 | Gas            |                                 |    |             |
| Heat Type           | 05 | Hot Water      |                                 |    |             |
| AC Type             | 01 | None           |                                 |    |             |
| Bedrooms            | 00 |                |                                 |    |             |
| Full Baths          | 1  |                |                                 |    |             |
| Half Baths          | 0  |                |                                 |    |             |
| Extra Fixtures      |    |                |                                 |    |             |
| Total Rooms         | 1  |                |                                 |    |             |
| Bath Style          |    |                |                                 |    |             |
| Kitchen Style       |    |                |                                 |    |             |
| Occupancy           |    |                |                                 |    |             |
| Usrflid 105         |    |                |                                 |    |             |
| Accessory Apt       |    |                |                                 |    |             |
| Foundation Alt      | 09 | Blk/Pour Ftgs  |                                 |    |             |
| Rms Prts            |    |                |                                 |    |             |
| Bath Split          | 10 | 1 Full-0 Half  |                                 |    |             |

| CONDO DATA  |      |             |         |     |
|-------------|------|-------------|---------|-----|
| Parcel Id   |      | C           | Owne    | 0.0 |
| Adjust Type | Code | Description | Factor% |     |
| Condo Flr   |      |             |         |     |
| Condo Unit  |      |             |         |     |

| COST / MARKET VALUATION  |         |
|--------------------------|---------|
| Building Value New       | 253,376 |
| Year Built               | 2011    |
| Effective Year Built     | 2011    |
| Depreciation Code        | A       |
| Remodel Rating           |         |
| Year Remodeled           |         |
| Depreciation %           | 6       |
| Functional Obsol         | 0       |
| External Obsol           | 0       |
| Trend Factor             | 1       |
| Condition                |         |
| Condition %              |         |
| Percent Good             | 94      |
| RCNLD                    | 214,000 |
| Dep % Ovr                |         |
| Dep Ovr Comment          |         |
| Misc Imp Ovr             |         |
| Misc Imp Ovr Comment     |         |
| Cost to Cure Ovr         |         |
| Cost to Cure Ovr Comment |         |

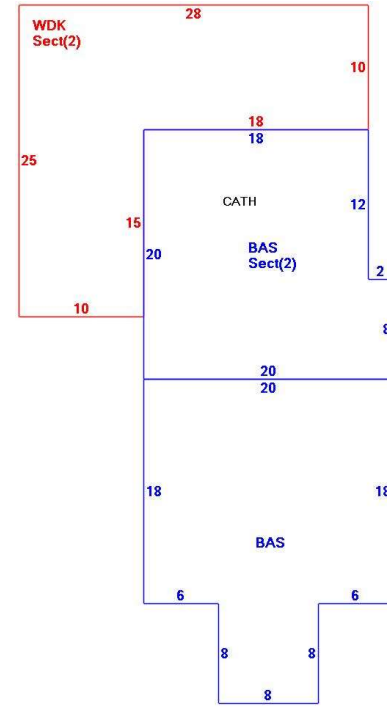

| OB - OUTBUILDING & YARD ITEMS(L) / XF - BUILDING EXTRA FEATURES(B) |              |     |       |            |        |          |      |       |            |             |
|--|--------------|-----|-------|------------|--------|----------|------|-------|------------|-------------|
| Code   | Description  | L/B | Units | Unit Price | Yr Blt | Cond. Cd | % Gd | Grade | Grade Adj. | Appr. Value |
| WDC  | Wood Deck w/ | L   | 430   | 18.00      | 2011   |          | 84   |       | 0.00       | 6,200       |

| BUILDING SUB-AREA SUMMARY SECTION |             |             |            |          |           |                |
|-----------------------------------|-------------|-------------|------------|----------|-----------|----------------|
| Code                              | Description | Living Area | Floor Area | Eff Area | Unit Cost | Undeprec Value |
| BAS                               | First Floor | 376         | 376        | 376      | 316.72    | 119,087        |
| WDC                               | Wood Deck   | 0           | 430        | 0        | 0.00      | 0              |
| Ttl Gross Liv / Lease Area        |             | 376         | 806        | 376      |           | 119,087        |

