

CONSTRUCTION DETAIL			CONSTRUCTION DETAIL (CONTINUED)		
Element	Cd	Description	Element	Cd	Description
Style	01	Ranch			
Model	01	Residential			
Grade:	C+	Average Plus			
Stories	1	1 Story			
Exterior Wall 1	14	Wood Shingle			
Exterior Wall 2					
RooF Structure	03	Gable/Hip			
RooF Cover	03	Asph/F Gls/Cmp			
Interior Wall 1	03	Plastered			
Interior Wall 2					
Interior Floor 1	12	Hardwood			
Interior Floor 2	14	Carpet			
Heat Fuel	03	Gas			
Heat Type	04	Hot Air			
AC Type	03	Central			
Bedrooms	02	2 Bedrooms			
Full Baths	2				
Half Baths	0				
Extra Fixtures					
Total Rooms	5	5 Rooms			
Bath Style					
Kitchen Style					
Occupancy					
Usrflid 105					
Accessory Apt					
Foundation Alt	01	Poured Conc.			
Rms Prts					
Bath Split	20	2 Full-0 Half			

CONDO DATA			
Parcel Id		C	Ownr 0.0
		B	S
Adjust Type	Code	Description	Factor%
Condo Flr			
Condo Unit			

COST / MARKET VALUATION	
Building Value New	433,253
Year Built	2004
Effective Year Built	2008
Depreciation Code	A
Remodel Rating	
Year Remodeled	
Depreciation %	9
Functional Obsol	0
External Obsol	0
Trend Factor	1
Condition	
Condition %	
Percent Good	91
RCNLD	394,300
Dep % Ovr	
Dep Ovr Comment	
Misc Imp Ovr	
Misc Imp Ovr Comment	
Cost to Cure Ovr	
Cost to Cure Ovr Comment	

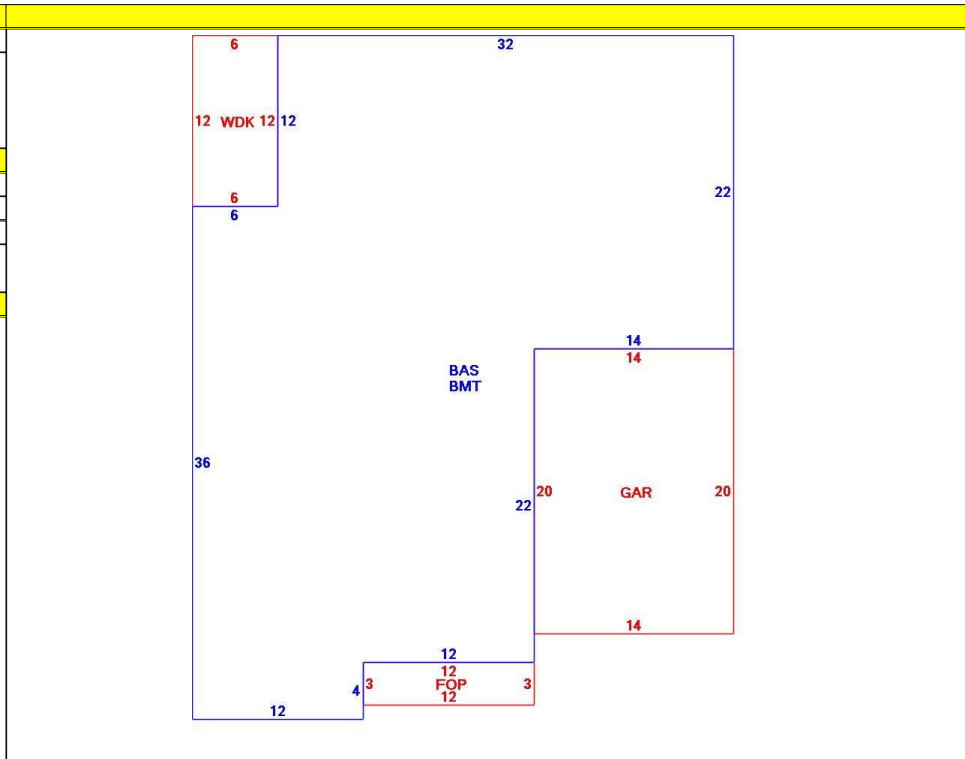

OB - OUTBUILDING & YARD ITEMS(L) / XF - BUILDING EXTRA FEATURES(B)										
Code	Description	L/B	Units	Unit Price	Yr Blt	Cond. Cd	% Gd	Grade	Grade Adj.	Appr. Value
FPL1	Fireplace 1 sto	B	1	5000.00	2010		91		0.00	4,600
WDC	Wood Decking	L	72	20.00	2007		76		0.00	2,500
FOP	Open Porch-ro	B	36	55.00	2010		91		0.00	2,500
GAR	Attached Gara	B	280	40.00	2010		91		0.00	11,600
BMT	Basement-Unfi	B	1,340	26.01	2010		91		0.00	29,700
FPLG	Gas Fireplace-	B	1	2500.00	2010		91		0.00	2,300

BUILDING SUB-AREA SUMMARY SECTION						
Code	Description	Living Area	Floor Area	Eff Area	Unit Cost	Undeprec Value
BAS	First Floor	1,340	1,340	1,340	323.32	433,253
BMT	Basement Area	0	1,340	0	0.00	0
FOP	Open Porch	0	36	0	0.00	0
GAR	Attached Garage	0	280	0	0.00	0
WDK	Wood Deck	0	72	0	0.00	0
Ttl Gross Liv / Lease Area		1,340	3,068	1,340		433,253

