

CURRENT OWNER		TOPO	UTILITIES	STRT / ROAD	LOCATION	CURRENT ASSESSMENT			
BEARING SURFACES LLC						Description	Code	Assessed	Assessed
700 ATTUCKS LN STE 1A						COMMERC.	3470	1,038,800	1,038,800
HYANNIS MA 02601		<b>SUPPLEMENTAL DATA</b>							
Alt Prcl ID		Split Zonin		Plan Ref. 589/69-71					
#DL 1 UNIT 1A		#DL 2		Land Ct#					
GIS ID F_984529_2709291		Assoc Pid#		Life Estate					
				PP STATU					
						Total		1,038,800	1,038,800

801  
 FY2024  
 BARNSTABLE, MA

**VISION**

RECORD OF OWNERSHIP		BK-VOL/PAGE	SALE DATE	Q/U	V/I	SALE PRICE	VC	PREVIOUS ASSESSMENTS (HISTORY)					
BEARING SURFACES LLC		18427 0326	04-08-2004	Q	I	1,110,420	00	Year	Code	Assessed	Year	Code	Assessed
22 ATTUCKS LP		15841 0328	11-01-2002	U	I	1,680,000	1	2023	3470	1,038,800	2022	3470	824,800
								2021	3470	824,800	Total		824,800
								Total		1,038,800	Total		824,800

EXEMPTIONS			OTHER ASSESSMENTS				APPROAISED VALUE SUMMARY		
Year	Code	Description	Amount	Code	Description	Number	Amount	Comm Int	
		Total	0.00						
Nbhd		Nbhd Name		B		Tracing		Batch	
0003								BARNS	
<b>NOTES</b>									
This signature acknowledges a visit by a Data Collector or Assessor									
								Appraised Bldg. Value (Card)	
								1,038,800	
								Appraised Xf (B) Value (Bldg)	
								0	
								Appraised Ob (B) Value (Bldg)	
								0	
								Appraised Land Value (Bldg)	
								0	
								Special Land Value	
								0	
								Total Appraised Parcel Value	
								1,038,800	
								Valuation Method	
								C	
								Total Appraised Parcel Value	
								1,038,800	

BUILDING PERMIT RECORD								VISIT / CHANGE HISTORY						
Permit Id	Issue Date	Type	Description	Amount	Insp Date	% Comp	Date Comp	Comments	Date	Id	Type	Is	Cd	Purpost/Result
BLDC-23-11	06-01-2023	803	Addn Alt-Comm	0		100		Tenant fit-out no construction fr	04-30-2020	GM	04		FR	Field Review
200700100	01-18-2007	RE	Remodel	18,000		100	06-30-2008		09-06-2019	SR	02		03	Cycl Insp Comp
									11-17-2008	JG	03		16	In Office Review
									11-05-2008	TP	03		16	In Office Review
									07-10-2007	SF	03		16	In Office Review

LAND LINE VALUATION SECTION																	
B	Use Code	Description	Zone	Dist	Land Type	Land Units	Unit Price	Size Adj	Site Index	Cond.	Nbhd.	Nbhd. Adj	Notes	Location Adjustmen	Adj Unit P	Land Value	
1	3470	MEDICL OFC C	IND	1		0 SF	0.00	1.00000	5	1.00	0003	1.000		0.0000	0	0	
Total Card Land Units						0 SF	Parcel Total Land Area						0.00	Total Land Value			0

CONSTRUCTION DETAIL			CONSTRUCTION DETAIL (CONTINUED)		
Element	Cd	Description	Element	Cd	Description
Style	56	Condo Office			
Model	06	Com Condo			
Bedrm Func	B	Custom			
Stories	1	1 Story			
Occupancy	1				
Interior Wall 1	05	Drywall			
Interior Wall 2					
Interior Floor 1	14	Carpet			
Interior Floor 2					
Heat Fuel	03	Gas			
Heat Type	04	Hot Air			
AC Type	03	Central			
Bedrooms	00				
Full Baths	0				
Half Baths	2				
Extra Fixtures					
Total Rooms					
Bath Style					
Kitchen Style					
Master Deed L	3621				
Bath Split	02	0 Full-2 Half			
Foundation	03	Conc. Slab			
AC Type Alt					
Sewer Occupan					
<b>CONDO DATA</b>					
Parcel Id	104380	C 0960	Owne	13.	
	NORTH BAY		B 1	S 1	
Adjust Type	Code	Description	Factor%		
Condo Flr			100		
Condo Unit			100		
<b>COST / MARKET VALUATION</b>					
Building Value New		1,282,452			
Year Built		1983			
Effective Year Built		1994			
Depreciation Code		G			
Remodel Rating					
Year Remodeled		2004			
Depreciation %		19			
Functional Obsol					
External Obsol					
Trend Factor		1			
Condition					
Condition %					
Percent Good		81			
Cns Sect Rcnd		1,038,800			
Dep % Ovr					
Dep Ovr Comment					
Misc Imp Ovr					
Misc Imp Ovr Comment					
Cost to Cure Ovr					
Cost to Cure Ovr Comment					

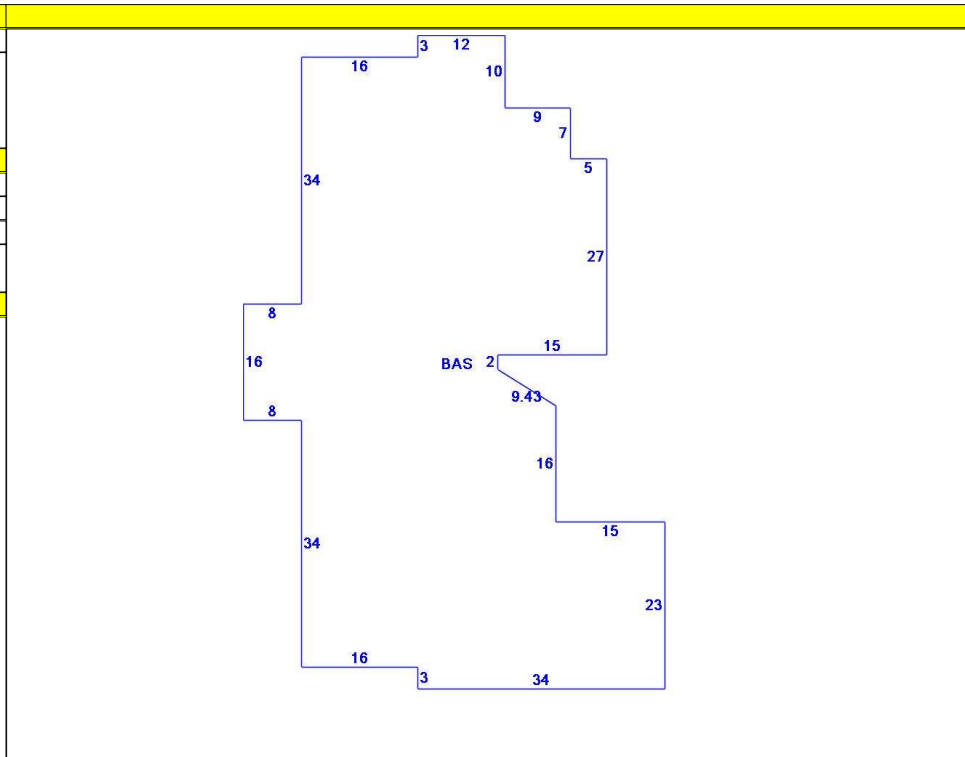

OB - OUTBUILDING & YARD ITEMS(L) / XF - BUILDING EXTRA FEATURES(B)										
Code	Description	L/B	Units	Unit Price	Yr Blt	Cond. Cd	% Gd	Grade	Grade Adj.	Appr. Value

BUILDING SUB-AREA SUMMARY SECTION							
Code	Description	Living Area	Floor Area	Eff Area	Unit Cost	Undeprec Value	
BAS	First Floor	3,624	3,624	3,624	353.88	1,282,452	
Ttl Gross Liv / Lease Area		3,624	3,624	3,624		1,282,452	



11.5.2018