

CURRENT OWNER		TOPO	UTILITIES	STRT / ROAD	LOCATION	CURRENT ASSESSMENT						801 FY2024 BARNSTABLE, MA VISION							
MACOMBER711 REALTY LLC 68 CENTER STREET UNIT 21 HYANNIS MA 02601						Description	Code	Assessed	Assessed										
						COMMERC.	3270	546,800	546,800										
SUPPLEMENTAL DATA						Total													
Alt Prcl ID Split Zonin BID Parcel ResExpt Q #DL 1 UNIT 21 #DL 2 GIS ID F_989327_2702043				Plan Ref. 618/34-38, 619/62 Land Ct# #SR Life Estate PP STATU Assoc Pid#															
RECORD OF OWNERSHIP			BK-VOL/PAGE	SALE DATE	Q/U	V/I	SALE PRICE	VC	PREVIOUS ASSESSMENTS (HISTORY)										
MACOMBER711 REALTY LLC			31801	0271	01-25-2019	U	I	100	1F	Year	Code	Assessed	Year	Code	Assessed	Year	Code	Assessed	
JOYCE REALTY LLC			22122	0101	06-19-2007	Q	I	500,000	00	2023	3270	699,300	2022	3270	582,100	2021	3270	546,100	
CODE REALTY LLC			19487	0241	01-31-2005	U	I	2,250,000	1P										
						Total						699,300		582,100		546,100			
EXEMPTIONS				OTHER ASSESSMENTS				This signature acknowledges a visit by a Data Collector or Assessor											
Year	Code	Description	Amount	Code	Description	Number	Amount	Comm Int											
			Total					0.00											
ASSESSING NEIGHBORHOOD												APPRAISED VALUE SUMMARY							
Nbhd		Nbhd Name		B		Tracing		Batch		Appraised Bldg. Value (Card)					546,800				
0001								HYAN		Appraised Xf (B) Value (Bldg)					0				
												Appraised Ob (B) Value (Bldg)					0		
												Appraised Land Value (Bldg)					0		
												Special Land Value					0		
												Total Appraised Parcel Value					546,800		
												Valuation Method					C		
												Total Appraised Parcel Value					546,800		
BUILDING PERMIT RECORD										VISIT / CHANGE HISTORY									
Permit Id	Issue Date	Type	Description	Amount	Insp Date	% Comp	Date Comp	Comments		Date	Id	Type	Is	Cd	Purpost/Result				
200702257	04-24-2007	RE	Remodel	80,000	06-30-2008	100	06-30-2008	INT BUILD OUT		04-29-2020	GM	04		FR	Field Review				
										10-10-2018	SR	02		03	Cycl Insp Comp				
										07-30-2015	TP	03		16	In Office Review				
										07-15-2008	TP	03		16	In Office Review				
LAND LINE VALUATION SECTION																			
B	Use Code	Description	Zone	Dist	Land Type	Land Units	Unit Price	Size Adj	Site Index	Cond.	Nbhd.	Nbhd. Adj	Notes	Location Adjustmen	Adj Unit P	Land Value			
1	3270	RETAIL CONDO	DMS	4		0 SF	0.00	1.00000	5	1.00	0003	1.000			0.0000	0	0		
Total Card Land Units						0	SF	Parcel Total Land Area						0.00	Total Land Value				0

CONSTRUCTION DETAIL			CONSTRUCTION DETAIL (CONTINUED)		
Element	Cd	Description	Element	Cd	Description
Style	90	Retail Condo			
Model	06	Com Condo			
Bedrm Func	B+	Custom Plus			
Stories	1	1 Story			
Occupancy					
Interior Wall 1	05	Drywall			
Interior Wall 2					
Interior Floor 1	12	Hardwood			
Interior Floor 2	14	Carpet			
Heat Fuel	03	Gas			
Heat Type	04	Hot Air			
AC Type	03	Central			
Bedrooms	00				
Full Baths	0				
Half Baths	2				
Extra Fixtures					
Total Rooms	1				
Bath Style					
Kitchen Style					
Master Deed L					
Bath Split	2550	0 Full-2 Half			
Foundation	02	Poured Conc.			
AC Type Alt	01				
Sewer Occupan					
CONDO DATA					
Parcel Id	105877	C 102	Ownr	7.2	
	STONERIDGE CRS	B 1	S 1		
Adjust Type	Code	Description	Factor%		
Condo Flr			100		
Condo Unit	INSV	INSV	95		
COST / MARKET VALUATION					
Building Value New		600,840			
Year Built		2007			
Effective Year Built		2008			
Depreciation Code		A			
Remodel Rating					
Year Remodeled					
Depreciation %		9			
Functional Obsol					
External Obsol					
Trend Factor		1			
Condition					
Condition %					
Percent Good		91			
Cns Sect Rcnd		546,800			
Dep % Ovr					
Dep Ovr Comment					
Misc Imp Ovr					
Misc Imp Ovr Comment					
Cost to Cure Ovr					
Cost to Cure Ovr Comment					

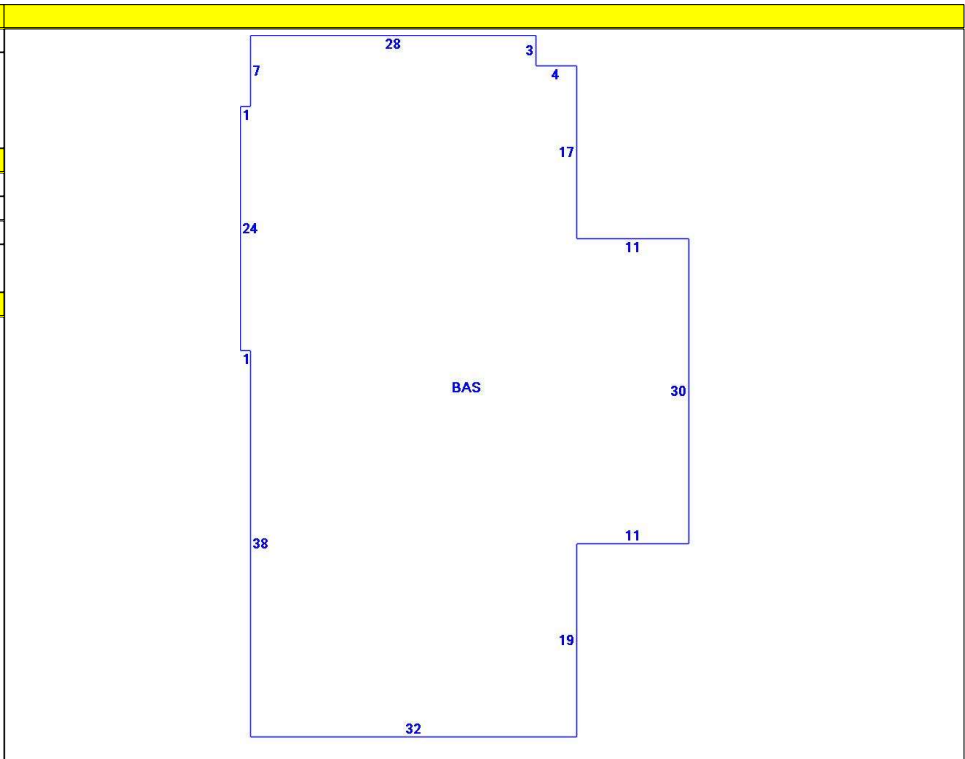

OB - OUTBUILDING & YARD ITEMS(L) / XF - BUILDING EXTRA FEATURES(B)										
Code	Description	L/B	Units	Unit Price	Yr Blt	Cond. Cd	% Gd	Grade	Grade Adj.	Appr. Value

BUILDING SUB-AREA SUMMARY SECTION							
Code	Description	Living Area	Floor Area	Eff Area	Unit Cost	Undeprec Value	
BAS	First Floor	2,550	2,550	2,550	235.62	600,831	
Ttl Gross Liv / Lease Area		2,550	2,550	2,550		600,831	

