

| CURRENT OWNER | | TOPO | UTILITIES | STRT / ROAD | LOCATION | CURRENT ASSESSMENT | | | | 801 FY2024 BARNSTABLE, MA VISION | |
|--|--|---------|----------------|---|----------|--------------------|------|----------|----------|--|-----------|
| BELL, DAVID E & STACEY J 1 HUNTINGTON AVE., #1303 BOSTON MA 02116 | | 1 Level | 2 Public Water | 1 Paved | | Description | Code | Assessed | Assessed | | |
| | | | 4 Gas | | | RESIDNTL | 1010 | 812,600 | 812,600 | | |
| | | | 6 Septic | | | RES LAND | 1010 | 977,000 | 977,000 | | |
| SUPPLEMENTAL DATA | | | | | | Total | | | | 1,789,600 | 1,789,600 |
| Alt Prcl ID Split Zonin BID Parcel ResExpt Q #DL 1 LOT 1 #DL 2 GIS ID F_964851_2694206 | | | | Plan Ref. Land Ct# 26824-B #SR Life Estate PP STATU Assoc Pid# | | | | | | | |

| RECORD OF OWNERSHIP | | BK-VOL/PAGE | SALE DATE | Q/U | V/I | SALE PRIC | VC | PREVIOUS ASSESSMENTS (HISTORY) | | | | | | | | |
|--------------------------------|---------|-------------|------------|------|----------|-----------|------|--------------------------------|-------|---------|-----------|-------|---------|-----------|------|---------|
| Year | Code | Assessed | Year | Code | Assessed | Year | Code | Assessed | Year | Code | Assessed | | | | | |
| BELL, DAVID E & STACEY J | C181155 | 0 | 09-22-2006 | Q | V | 1,200,000 | 00 | | | | | | | | | |
| LANGWAY, JAMES F & DEIRDRE A | C146374 | 0 | 10-31-1997 | Q | V | 435,000 | 1 | 2023 | 1010 | 727,400 | 2022 | 1010 | 608,800 | 2021 | 1010 | 519,800 |
| TARDANICO, CHARLES W TR | C144366 | 0 | 05-07-1997 | Q | V | 133,000 | 00 | | 1010 | 808,000 | | 1010 | 528,100 | | 1010 | 480,100 |
| STRICKLAND, WILLIAM W & NELIDA | C142524 | 0 | 10-31-1996 | Q | V | 120,000 | 00 | | | | | | | | 1010 | 3,300 |
| COREY, DONALD J TR | C135485 | 0 | 11-04-1994 | Q | V | 330,000 | U | | | | | | | | | |
| Total | | | | | | | | 1,535,400 | Total | | 1,136,900 | Total | | 1,003,200 | | |

| EXEMPTIONS | | | | OTHER ASSESSMENTS | | | | APPRaised VALUE SUMMARY | | | | |
|------------|------|-------------|--------|-------------------|-------------|--------|--------|-------------------------|--|--|--|--|
| Year | Code | Description | Amount | Code | Description | Number | Amount | Comm Int | This signature acknowledges a visit by a Data Collector or Assessor | | | |
| | | | | | | | | | Appraised Bldg. Value (Card) 737,200 Appraised Xf (B) Value (Bldg) 72,100 Appraised Ob (B) Value (Bldg) 3,300 Appraised Land Value (Bldg) 977,000 Special Land Value 0 Total Appraised Parcel Value 1,789,600 Valuation Method C | | | |
| Total | | | 0.00 | | | | | | | | | |
| Total | | | 0.00 | | | | | | | | | |

| ASSESSING NEIGHBORHOOD | | | | |
|------------------------|-----------|---|---------|--------|
| Nbhd | Nbhd Name | B | Tracing | Batch |
| 0114 | | | | OSTVIL |

| NOTES | | | | | | | | | | | |
|-------|--|--|--|--|--|--|--|--|--|--|--|
| | | | | | | | | | | | |

| BUILDING PERMIT RECORD | | | | | | | | VISIT / CHANGE HISTORY | | | | | | |
|------------------------|------------|------|----------------|---------|------------|--------|------------|-------------------------------------|------------|----|------|----|----|----------------------------|
| Permit Id | Issue Date | Type | Description | Amount | Insp Date | % Comp | Date Comp | Comments | Date | Id | Type | Is | Cd | Purpost/Result |
| EXPR-22-1 | 09-02-2022 | 835 | Sid/Wind/Roof/ | 24,869 | | 100 | | Replace 3 patio doors and 1 wi ROOF | 06-04-2020 | WD | | | FR | Field Review |
| 20-856 | 03-18-2020 | 835 | Sid/Wind/Roof/ | 8,000 | | 100 | | | 08-04-2017 | MS | 02 | | 14 | Cyclical Inspection |
| 22945 | 05-05-1997 | DW | Dwelling | 160,875 | 06-25-1998 | 100 | 01-01-1998 | | 05-11-2015 | JR | 03 | | 03 | Cycl Insp Comp |
| | | | | | | | | | 05-26-2010 | DR | 22 | | 22 | Change of Address |
| | | | | | | | | | 04-25-2008 | PT | 02 | | 14 | Cyclical Inspection |
| | | | | | | | | | 09-25-1999 | DD | 01 | | 00 | Meas/Listed-Interior Acces |
| | | | | | | | | | 06-25-1998 | LK | 02 | | 02 | Bldg Permit Completed |

| LAND LINE VALUATION SECTION | | | | | | | | | | | | | | | | | | |
|-----------------------------|----------|----------------|------|----|------------|---------------|------------------------|---------|------------|-------|-------|-----------|------------------|--------------------|------------|------------|--|---------|
| B | Use Code | Description | Zone | LA | Land Units | Unit Price | Size Adj | AC Disc | Site Index | Cond. | Nbhd. | Nbhd. Adj | Notes | Location Adjustmen | Adj Unit P | Land Value | | |
| 1 | 1010 | Single Fam M-0 | RC | 3 | 1.000 | AC 176,344.00 | 1.00000 | 1.0000 | 5 | 1.00 | 0112 | 5.500 | | | 1.0000 | 969,892 | | |
| 1 | 1010 | Single Fam M-0 | RC | 3 | 0.090 | AC 14,250.00 | 1.00000 | 1.0000 | 0 | 1.00 | 0112 | 5.500 | | | 1.0000 | 78,375 | | |
| Total Card Land Units | | | | | 1.09 | AC | Parcel Total Land Area | | | | | 1.09 | Total Land Value | | | | | 977,000 |

| CONSTRUCTION DETAIL | | | CONSTRUCTION DETAIL (CONTINUED) | | |
|---------------------|------|----------------|---------------------------------|----|-------------|
| Element | Cd | Description | Element | Cd | Description |
| Style | 04 | Cape Cod | | | |
| Model | 01 | Residential | | | |
| Grade: | C+ | Average Plus | | | |
| Stories | 1.75 | 1 3/4 Stories | | | |
| Exterior Wall 1 | 14 | Wood Shingle | | | |
| Exterior Wall 2 | 11 | Clapboard | | | |
| RooF Structure | 03 | Gable/Hip | | | |
| RooF Cover | 03 | Asph/F Gls/Cmp | | | |
| Interior Wall 1 | 03 | Plastered | | | |
| Interior Wall 2 | | | | | |
| Interior Floor 1 | 12 | Hardwood | | | |
| Interior Floor 2 | 14 | Carpet | | | |
| Heat Fuel | 03 | Gas | | | |
| Heat Type | 04 | Hot Air | | | |
| AC Type | 03 | Central | | | |
| Bedrooms | 04 | 4 Bedrooms | | | |
| Full Baths | 3 | | | | |
| Half Baths | 1 | | | | |
| Extra Fixtures | | | | | |
| Total Rooms | 8 | 8 Rooms | | | |
| Bath Style | 02 | Average | | | |
| Kitchen Style | 02 | Modernized | | | |
| Occupancy | | | | | |
| Usrflid 105 | | | | | |
| Accessory Apt | | | | | |
| Foundation Alt | 01 | Poured Conc. | | | |
| Rms Prts | | | | | |
| Bath Split | 31 | 3 Full-1 Half | | | |

| CONDO DATA | | | | |
|-------------|------|-------------|---------|----------|
| Parcel Id | | C | | Ownr 0.0 |
| | | | B | S |
| Adjust Type | Code | Description | Factor% | |
| Condo Flr | | | | |
| Condo Unit | | | | |

| COST / MARKET VALUATION | |
|--------------------------|---------|
| Building Value New | 837,713 |
| Year Built | 1997 |
| Effective Year Built | 2004 |
| Depreciation Code | A |
| Remodel Rating | |
| Year Remodeled | |
| Depreciation % | 12 |
| Functional Obsol | 0 |
| External Obsol | 0 |
| Trend Factor | 1 |
| Condition | |
| Condition % | |
| Percent Good | 88 |
| RCNLD | 737,200 |
| Dep % Ovr | |
| Dep Ovr Comment | |
| Misc Imp Ovr | |
| Misc Imp Ovr Comment | |
| Cost to Cure Ovr | |
| Cost to Cure Ovr Comment | |

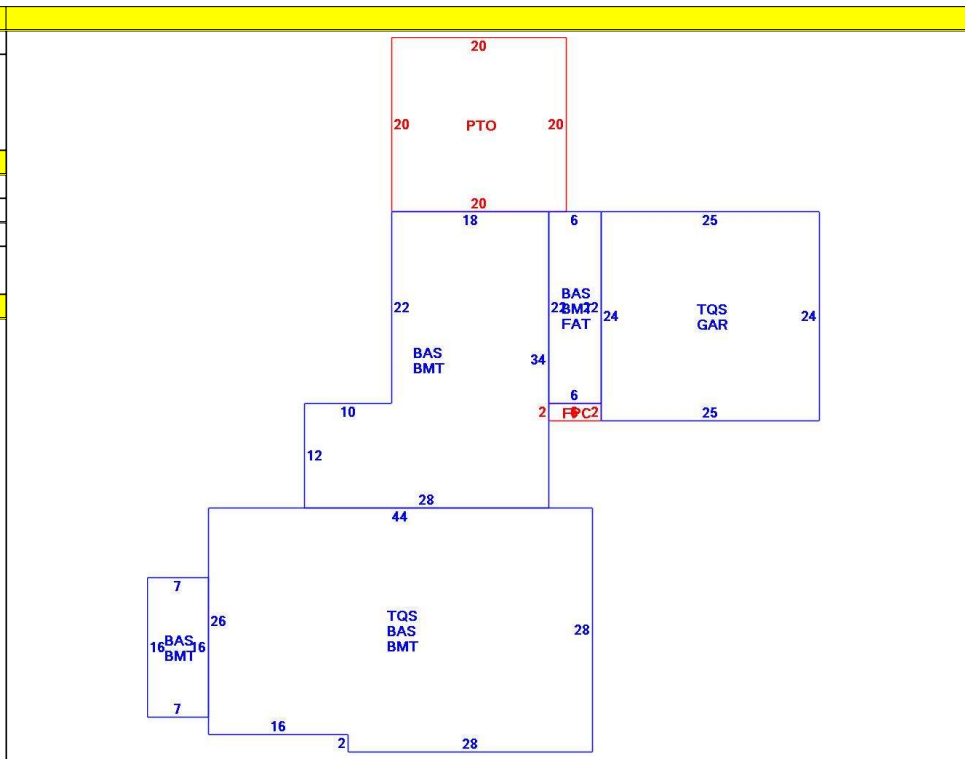

| OB - OUTBUILDING & YARD ITEMS(L) / XF - BUILDING EXTRA FEATURES(B) | | | | | | | | | | |
|--|-----------------|-----|-------|------------|--------|----------|------|-------|------------|-------------|
| Code | Description | L/B | Units | Unit Price | Yr Blt | Cond. Cd | % Gd | Grade | Grade Adj. | Appr. Value |
| FPL2 | Fireplace 1.5 s | B | 2 | 6000.00 | 2006 | | 88 | | 0.00 | 10,600 |
| PAT2 | Patio-Good | L | 400 | 9.94 | 2004 | | 85 | | 0.00 | 3,300 |
| FOPC | Open Prch-roo | B | 12 | 55.00 | 2006 | | 88 | | 0.00 | 900 |
| GAR | Attached Gara | B | 600 | 40.00 | 2006 | | 88 | | 0.00 | 18,500 |
| BMT | Basement-Unfi | B | 2,176 | 26.01 | 2006 | | 88 | | 0.00 | 42,100 |

| BUILDING SUB-AREA SUMMARY SECTION | | | | | | |
|-----------------------------------|------------------------|-------------|------------|----------|-----------|----------------|
| Code | Description | Living Area | Floor Area | Eff Area | Unit Cost | Undeprec Value |
| BAS | First Floor | 2,176 | 2,176 | 2,176 | 248.88 | 541,552 |
| BMT | Basement Area | 0 | 2,176 | 0 | 0.00 | 0 |
| FAT | Attic, Finished | 20 | 132 | 20 | 37.71 | 4,978 |
| FPC | Open Porch Conc. Floor | 0 | 12 | 0 | 0.00 | 0 |
| GAR | Attached Garage | 0 | 600 | 0 | 0.00 | 0 |
| PTO | Patio | 0 | 400 | 0 | 0.00 | 0 |
| TQS | Three Quarter Story | 1,170 | 1,800 | 1,170 | 161.77 | 291,184 |
| Ttl Gross Liv / Lease Area | | 3,366 | 7,296 | 3,366 | | 837,714 |

