

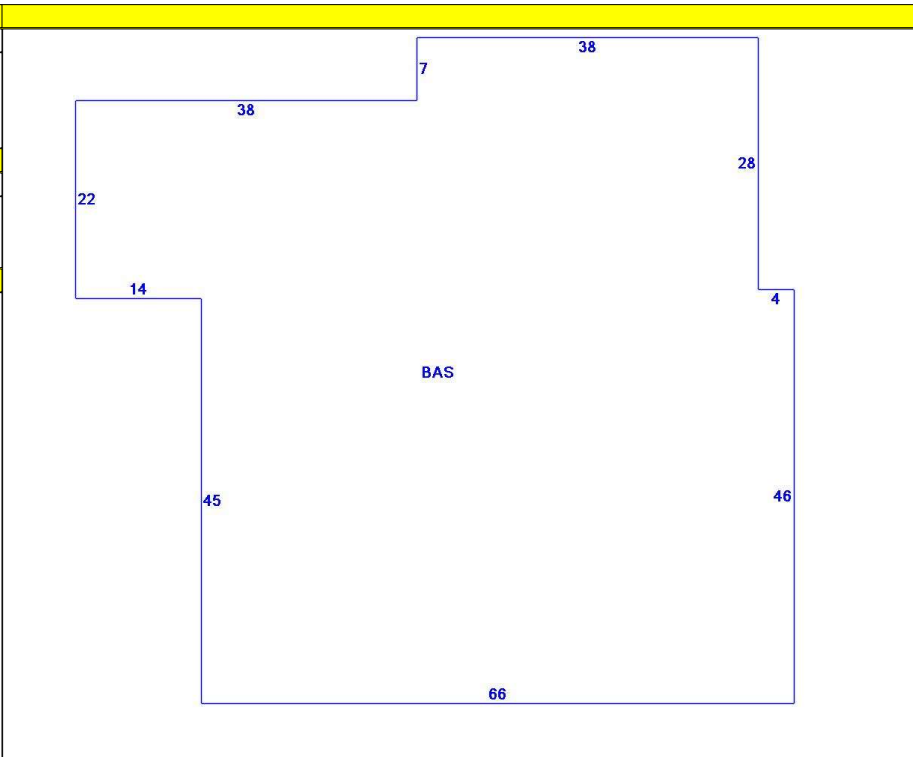

CONSTRUCTION DETAIL			CONSTRUCTION DETAIL (CONTINUED)		
Element	Cd	Description	Element	Cd	Description
Style	83	Schools-Public			
Model	94	Commercial			
Grade	C	Average			
Stories	1				
Occupancy	0.00				
Exterior Wall 1	20	Brick/Masonry			
Exterior Wall 2					
Roof Structure	01	Flat			
Roof Cover	04	Tar & Gravel			
Interior Wall 1	03	Plastered			
Interior Wall 2					
Interior Floor 1	05	Vinyl/Asphalt			
Interior Floor 2					
Heating Fuel	03	Gas			
Heating Type	04	Hot Air			
AC Type	03	Central			
Size Adj Tbl	9340	Municipal Edu Impr			
Total Rooms					
Bedrooms	0				
Full Bathrooms					
Bath Split					
Rms/Partitions	02				
Heat/AC	01	HEAT/AC PKGS			
Frame Type	03	MASONRY			
Baths/Plumbing	02	AVERAGE			
Ceiling/Wall	06	CEIL & WALLS			
Common Wall	00	10%			
Wall Height	10.00				
1st Floor Use:					
Sewer Occupan					

MIXED USE		
Code	Description	Percentage
9340	Municipal Edu Impr	100
		0
		0

COST / MARKET VALUATION	
RCN	1,353,682
Year Built	1980
Effective Year Built	1989
Depreciation Code	A
Remodel Rating	
Year Remodeled	
Depreciation %	23
Functional Obsol	
External Obsol	
Trend Factor	1
Condition	
Condition %	
Percent Good	77
RCNLD	1,042,300
Dep % Ovr	
Dep Ovr Comment	
Misc Imp Ovr	
Misc Imp Ovr Comment	
Cost to Cure Ovr	
Cost to Cure Ovr Comment	



OB - OUTBUILDING & YARD ITEMS(L) / XF - BUILDING EXTRA FEATURES(B)										
Code	Description	L/B	Units	Unit Price	Yr Blt	Cond. Cd	% Good	Grade	Grade Adj	Appr. Value
TEN	Tennis Court 72	L	11,000	6.84	1985		32	C	1.00	24,100

BUILDING SUB-AREA SUMMARY SECTION							
Code	Description	Living Area	Floor Area	Eff Area	Unit Cost	Undeprec Value	
BAS	First Floor	4,912	4,912	4,912	275.59	1,353,682	
Ttl Gross Liv / Lease Area		4,912	4,912	4,912		1,353,682	