

| CURRENT OWNER   |            | TOPO                  | UTILITIES         | STRT / ROAD         | LOCATION    | CURRENT ASSESSMENT |   |                                 |            | 801<br>FY2024<br>BARNSTABLE, MA<br><br><b>VISION</b> |       |  |                  |                    |            |            |         |
|---|------------|-----------------------|-------------------|---------------------|-------------|--------------------|---|---------------------------------|------------|--|-------|--|------------------|--------------------|------------|------------|---------|
| MORAHAN, EDMUND L JR & PATRICI<br><br>98 ELIJAH CHILDS LANE<br><br>CENTERVILLE MA 02632 |            | 1 Level               | 6 Septic          | 1 Paved             |             | Description        | Code  | Assessed                        | Assessed   |  |       | RESIDNTL 1010 459,900<br>RES LAND 1010 156,500 |                  |                    |            |            |         |
|   |            |                       | 4 Gas             |                     |             |                    |   |                                 |            |  |       |  |                  |                    |            |            |         |
|   |            |                       | 2 Public Water    |                     |             |                    |   |                                 |            |  |       |  |                  |                    |            |            |         |
| <b>SUPPLEMENTAL DATA</b>  |            |                       |                   |                     |             | Total              |   | 616,400                         | 616,400    |  |       |  |                  |                    |            |            |         |
| Alt Prcl ID   |            | Split Zonin           |                   | Plan Ref. 343/84-86 |             |                    |   |                                 |            |  |       |  |                  |                    |            |            |         |
| BID Parcel  |            | ResExpt Q YES:        |                   | Land Ct#            |             |                    |   |                                 |            |  |       |  |                  |                    |            |            |         |
| #DL 1 LOT 60  |            | #DL 2                 |                   | Life Estate         |             |                    |   |                                 |            |  |       |  |                  |                    |            |            |         |
| GIS ID F_965545_2705769   |            | Assoc Pid#            |                   | PP STATU            |             |                    |   |                                 |            |  |       |  |                  |                    |            |            |         |
| RECORD OF OWNERSHIP   |            | BK-VOL/PAGE           | SALE DATE         | Q/U                 | V/I         | SALE PRIC          | VC  | PREVIOUS ASSESSMENTS (HISTORY)  |            |  |       |  |                  |                    |            |            |         |
| MORAHAN, EDMUND L JR & PATRICIA A   |            | 31922 0347            | 04-01-2019        | U                   | I           | 1                  | 1F  | Year                            | Code       | Assessed   | Year  | Code   | Assessed         | Year               | Code       | Assessed   |         |
| MORAHAN, EDMUND L JR & PATRICIA A   |            | 13157 0183            | 07-31-2000        | Q                   | I           | 228,000            | 00  | 2023                            | 1010       | 396,400  | 2022  | 1010   | 346,800          | 2021               | 1010       | 281,200    |         |
| CAMPBELL, NORMA L   |            | 12943 0231            | 04-13-2000        | U                   | I           | 0                  | 1   |                                 | 1010       | 142,300  |       | 1010   | 105,400          |                    | 1010       | 105,400    |         |
| CAMPBELL, MARVIN O & NORMA L  |            | 3475 0177             | 05-15-1982        | Q                   | I           | 72,000             | U   | Total                           |            | 538,700  | Total |  | 452,200          | Total              |            | 387,900    |         |
| EXEMPTIONS  |            |                       | OTHER ASSESSMENTS |                     |             |                    | This signature acknowledges a visit by a Data Collector or Assessor |                                 |            |  |       |  |                  |                    |            |            |         |
| Year  | Code       | Description           | Amount            | Code                | Description | Number             | Amount  | Comm Int                        |            |  |       |  |                  |                    |            |            |         |
| 2023  | 5C         | RESIDENTIAL EXEMPTION | 0.00              |                     |             |                    |   |                                 |            |  |       |  |                  |                    |            |            |         |
| 2024  | 41C        | SENIOR                | 0.00              |                     |             |                    |   |                                 |            |  |       |  |                  |                    |            |            |         |
| Total   |            |                       | 0.00              |                     |             |                    |   |                                 |            |  |       |  |                  |                    |            |            |         |
| ASSESSING NEIGHBORHOOD  |            |                       |                   |                     |             |                    |   |                                 |            |  |       |  |                  |                    |            |            |         |
| Nbhd  |            | Nbhd Name             |                   | B                   |             | Tracing            |   | Batch                           |            |  |       |  |                  |                    |            |            |         |
| 0105  |            |                       |                   |                     |             |                    |   | CENVIL                          |            |  |       |  |                  |                    |            |            |         |
| NOTES   |            |                       |                   |                     |             |                    |   |                                 |            |  |       |  |                  |                    |            |            |         |
|   |            |                       |                   |                     |             |                    |   |                                 |            |  |       |  |                  |                    |            |            |         |
| BUILDING PERMIT RECORD  |            |                       |                   |                     |             |                    |   | VISIT / CHANGE HISTORY          |            |  |       |  |                  |                    |            |            |         |
| Permit Id   | Issue Date | Type                  | Description       | Amount              | Insp Date   | % Comp             | Date Comp   | Comments                        | Date       | Id   | Type  | Is   | Cd               | Purpost/Result     |            |            |         |
| 18-3303   | 10-05-2018 | 822                   | Insulation        | 6,900               |             | 100                |   | R30 unrestricted cellulose to 1 | 09-13-2023 | EG   | 03    |  | 16               | In Office Review   |            |            |         |
|   |            |                       |                   |                     |             |                    |   |                                 | 09-19-2022 | EG   | 03    |  | 16               | In Office Review   |            |            |         |
|   |            |                       |                   |                     |             |                    |   |                                 | 09-13-2022 | EG   | 03    |  | 16               | In Office Review   |            |            |         |
|   |            |                       |                   |                     |             |                    |   |                                 | 07-22-2022 | JO   |       |  | 16               | In Office Review   |            |            |         |
|   |            |                       |                   |                     |             |                    |   |                                 | 11-01-2021 | JD   | 03    |  | 16               | In Office Review   |            |            |         |
|   |            |                       |                   |                     |             |                    |   |                                 | 09-15-2020 | JD   | 03    |  | 16               | In Office Review   |            |            |         |
|   |            |                       |                   |                     |             |                    |   |                                 | 04-23-2020 | LS   |       |  | FR               | Field Review       |            |            |         |
| LAND LINE VALUATION SECTION   |            |                       |                   |                     |             |                    |   |                                 |            |  |       |  |                  |                    |            |            |         |
| B   | Use Code   | Description           | Zone              | LA                  | Land Units  | Unit Price         | Size Adj  | AC Disc                         | Site Index | Cond.  | Nbhd. | Nbhd. Adj                                      | Notes            | Location Adjustmen | Adj Unit P | Land Value |         |
| 1   | 1010       | Single Fam M-0        | RC                | 3                   | 0.480 AC    | 176,344.00         | 1.84893   | 1.0000                          | 5          | 1.00   | 0105  | 1.000  | POWER EASEMENT   |                    | 1.0000     | 326,042.4  | 156,500 |
| Total Card Land Units   |            |                       |                   |                     | 0.48        | AC                 | Parcel Total Land Area  |                                 |            |  |       | 0.48   | Total Land Value |                    |            |            | 156,500 |

| CONSTRUCTION DETAIL |    |                | CONSTRUCTION DETAIL (CONTINUED) |    |             |
|---------------------|----|----------------|---------------------------------|----|-------------|
| Element             | Cd | Description    | Element                         | Cd | Description |
| Style               | 01 | Ranch          |                                 |    |             |
| Model               | 01 | Residential    |                                 |    |             |
| Grade:              | C+ | Average Plus   |                                 |    |             |
| Stories             | 1  | 1 Story        |                                 |    |             |
| Exterior Wall 1     | 14 | Wood Shingle   |                                 |    |             |
| Exterior Wall 2     | 25 | Vinyl Siding   |                                 |    |             |
| Roof Structure      | 03 | Gable/Hip      |                                 |    |             |
| Roof Cover          | 03 | Asph/F Gls/Cmp |                                 |    |             |
| Interior Wall 1     | 05 | Drywall        |                                 |    |             |
| Interior Wall 2     |    |                |                                 |    |             |
| Interior Floor 1    | 12 | Hardwood       |                                 |    |             |
| Interior Floor 2    |    |                |                                 |    |             |
| Heat Fuel           | 03 | Gas            |                                 |    |             |
| Heat Type           | 05 | Hot Water      |                                 |    |             |
| AC Type             | 01 | None           |                                 |    |             |
| Bedrooms            | 03 | 3 Bedrooms     |                                 |    |             |
| Full Baths          | 2  |                |                                 |    |             |
| Half Baths          | 0  |                |                                 |    |             |
| Extra Fixtures      |    |                |                                 |    |             |
| Total Rooms         | 6  | 6 Rooms        |                                 |    |             |
| Bath Style          |    |                |                                 |    |             |
| Kitchen Style       |    |                |                                 |    |             |
| Occupancy           |    |                |                                 |    |             |
| Usrflid 105         |    |                |                                 |    |             |
| Accessory Apt       |    |                |                                 |    |             |
| Foundation Alt      | 01 | Poured Conc.   |                                 |    |             |
| Rms Prts            |    |                |                                 |    |             |
| Bath Split          | 20 | 2 Full-0 Half  |                                 |    |             |

| CONDO DATA  |      |             |         |
|-------------|------|-------------|---------|
| Parcel Id   | C    | Ownr        | 0.0     |
|             |      |             |         |
| Adjust Type | Code | Description | Factor% |
| Condo Flr   |      |             |         |
| Condo Unit  |      |             |         |

| COST / MARKET VALUATION  |         |
|--------------------------|---------|
| Building Value New       | 481,235 |
| Year Built               | 1982    |
| Effective Year Built     | 1997    |
| Depreciation Code        | A       |
| Remodel Rating           |         |
| Year Remodeled           |         |
| Depreciation %           | 17      |
| Functional Obsol         | 0       |
| External Obsol           | 0       |
| Trend Factor             | 1       |
| Condition                |         |
| Condition %              |         |
| Percent Good             | 83      |
| RCNLD                    | 399,400 |
| Dep % Ovr                |         |
| Dep Ovr Comment          |         |
| Misc Imp Ovr             |         |
| Misc Imp Ovr Comment     |         |
| Cost to Cure Ovr         |         |
| Cost to Cure Ovr Comment |         |

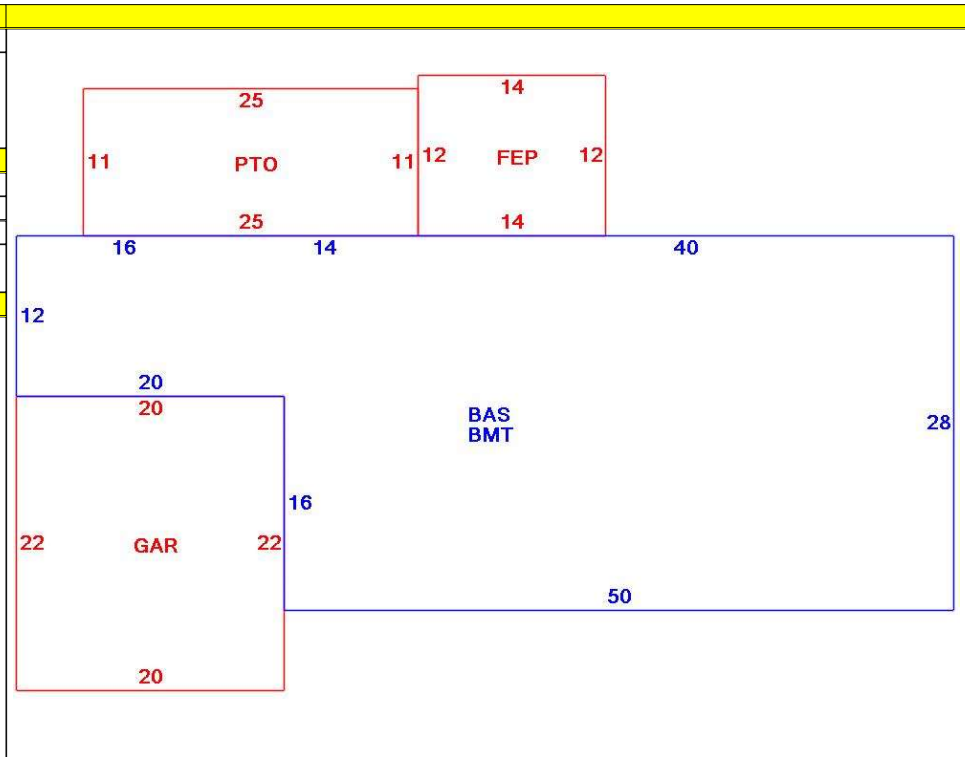

| OB - OUTBUILDING & YARD ITEMS(L) / XF - BUILDING EXTRA FEATURES(B) |                 |     |       |            |        |          |      |       |            |             |
|--|-----------------|-----|-------|------------|--------|----------|------|-------|------------|-------------|
| Code   | Description     | L/B | Units | Unit Price | Yr Blt | Cond. Cd | % Gd | Grade | Grade Adj. | Appr. Value |
| FPL1   | Fireplace 1 sto | B   | 1     | 5000.00    | 1999   |          | 83   |       | 0.00       | 4,200       |
| PAT1   | Patio- Average  | L   | 264   | 5.89       | 1998   |          | 79   |       | 0.00       | 1,300       |
| FEP  | Enclosed porc   | B   | 168   | 70.00      | 1999   |          | 83   |       | 0.00       | 9,400       |
| GAR  | Attached Gara   | B   | 440   | 40.00      | 1999   |          | 83   |       | 0.00       | 14,200      |
| BMT  | Basement-Unfi   | B   | 1,640 | 26.01      | 1999   |          | 83   |       | 0.00       | 31,400      |

| BUILDING SUB-AREA SUMMARY SECTION |                 |             |            |          |           |                |
|-----------------------------------|-----------------|-------------|------------|----------|-----------|----------------|
| Code                              | Description     | Living Area | Floor Area | Eff Area | Unit Cost | Undeprec Value |
| BAS                               | First Floor     | 1,640       | 1,640      | 1,640    | 293.44    | 481,235        |
| BMT                               | Basement Area   | 0           | 1,640      | 0        | 0.00      | 0              |
| FEP                               | Enclosed Porch  | 0           | 168        | 0        | 0.00      | 0              |
| GAR                               | Attached Garage | 0           | 440        | 0        | 0.00      | 0              |
| PTO                               | Patio           | 0           | 275        | 0        | 0.00      | 0              |
| Ttl Gross Liv / Lease Area        |                 | 1,640       | 4,163      | 1,640    |           | 481,235        |

