

| CURRENT OWNER | | TOPO | UTILITIES | STRT / ROAD | LOCATION | CURRENT ASSESSMENT | | | |
|--|--|--|--|-------------|----------|-------------------------------------|----------------------|--------------------------------|---------------------------------|
| VOGT, MARY P TR MARY P VOGT 2003 TRUST 78 BAY LANE | | 1 Level | 6 Septic | 1 Paved | | Description RESIDNTL RES LAND | Code 1010 1010 | Assessed 971,700 587,300 | Assessed 971,700 587,300 |
| | | | 4 Gas | | | | | | |
| CENTERVILLE MA 02632 | | SUPPLEMENTAL DATA | | | | Total | 1,559,000 | 1,559,000 | 801 FY2024 BARNSTABLE, MA |
| | | Alt Prcl ID Split Zonin BID Parcel ResExpt Q YES: #DL 1 LOT 2A #DL 2 GIS ID F_968826_2695519 | Plan Ref. 338/39 Land Ct# #SR Life Estate PP STATU Assoc Pid# | | | | | | |

VISION

| RECORD OF OWNERSHIP | | BK-VOL/PAGE | SALE DATE | Q/U | V/I | SALE PRIC | VC | PREVIOUS ASSESSMENTS (HISTORY) | | | | | |
|-----------------------------|-------|-------------|------------|-----|-----|-----------|----|--------------------------------|-------|-----------|-------|---------|----------|
| VOGT, MARY P TR | 22526 | 0297 | 12-11-2007 | U | I | 1 | 1F | Year | Code | Assessed | Year | Code | Assessed |
| VOGT, MARY P | 17105 | 0216 | 06-18-2003 | U | I | 1 | 1F | 2023 | 1010 | 826,100 | 2022 | 1010 | 672,000 |
| VOGT, JOSEPH A & MARY P | 11567 | 0049 | 07-13-1998 | Q | I | 350,000 | 00 | | 1010 | 418,000 | | 1010 | 363,500 |
| LONG, PETER P & ELIZABETH A | 7530 | 0180 | 05-14-1991 | Q | I | 325,000 | U | | | | | 1010 | 11,500 |
| SULLIVAN, MICHAEL T K & T F | 4930 | 0321 | 02-19-1986 | Q | I | 335,000 | U | | | | | | |
| Total | | | | | | | | 1,244,100 | Total | 1,035,500 | Total | 946,200 | |

| EXEMPTIONS | | | | OTHER ASSESSMENTS | | | |
|------------|------|-----------------------|--------|---|-------------|--------|--------|
| Year | Code | Description | Amount | Code | Description | Number | Amount |
| 2010 | 5C | RESIDENTIAL EXEMPTION | 0.00 | | | | |
| Total | | | 0.00 | This signature acknowledges a visit by a Data Collector or Assessor | | | |

| ASSESSING NEIGHBORHOOD | | | | APPRAISED VALUE SUMMARY | | | | |
|------------------------|-----------|---|---------|-------------------------------|-------------------------------|--|--|-----------|
| Nbhd | Nbhd Name | B | Tracing | Batch | Appraised Bldg. Value (Card) | | | 899,100 |
| 0110 | | | CENVIL | | Appraised Xf (B) Value (Bldg) | | | 61,100 |
| NOTES | | | | Appraised Ob (B) Value (Bldg) | | | | 11,500 |
| | | | | Appraised Land Value (Bldg) | | | | 587,300 |
| | | | | Special Land Value | | | | 0 |
| | | | | Total Appraised Parcel Value | | | | 1,559,000 |
| | | | | Valuation Method | | | | C |
| | | | | Total Appraised Parcel Value | | | | 1,559,000 |

| BUILDING PERMIT RECORD | | | | | | | | VISIT / CHANGE HISTORY | | | | | | | |
|-------------------------------|--|-----------------|--|----------------------------|-----------|-------------------|-----------|--|--|--|--|----|--|--|--|
| Permit Id | Issue Date | Type | Description | Amount | Insp Date | % Comp | Date Comp | Comments | Date | Id | Type | Is | Cd | Purpost/Result | |
| EXPR-21-11 76229 B27675 | 08-03-2021 04-27-2004 04-01-1985 | 835 AD DW | Sid/Wind/Roof/ Addition Dwelling | 5,354 70,000 150,000 | | 100 100 100 | | insulation and air sealing work CE 2 STOR | 05-14-2020 02-23-2018 08-13-2009 11-18-2008 03-26-2008 05-17-2005 12-24-2003 | WD KM NF PT JR MF GB | 02 03 03 02 03 02 01 | | FR 03 03 14 15 02 00 | Field Review Cycl Insp Comp Cycl Insp Comp Cyclical Inspection Abatement Review Bldg Permit Completed Meas/Listed-Interior Acces | |

| LAND LINE VALUATION SECTION | | | | | | | | | | | | | | | | |
|-----------------------------|----------|----------------|------|----|------------|---------------|------------------------|---------|------------|-------|-------|-----------|------------------|--------------------|------------|------------|
| B | Use Code | Description | Zone | LA | Land Units | Unit Price | Size Adj | AC Disc | Site Index | Cond. | Nbhd. | Nbhd. Adj | Notes | Location Adjustmen | Adj Unit P | Land Value |
| 1 | 1010 | Single Fam M-0 | RD- | 3 | 1.000 | AC 176,344.00 | 1.00000 | 1.0000 | 5 | 1.00 | 0110 | 3.100 | | 1.0000 | 546,666.4 | 546,700 |
| 1 | 1010 | Single Fam M-0 | RD- | 3 | 0.740 | AC 14,250.00 | 1.00000 | 1.0000 | 0 | 1.00 | 0110 | 3.100 | | 1.0000 | 44,175 | 32,700 |
| 1 | 1010 | Single Fam M-0 | RD- | 3 | 3.310 | AC 2,375.00 | 1.00000 | 1.0000 | 0 | 1.00 | WTLD | 1.000 | WETLAND | 1.0000 | 2,375 | 7,900 |
| Total Card Land Units | | | | | 5.05 | AC | Parcel Total Land Area | | | | | 5.05 | Total Land Value | | | 587,300 |

| CONSTRUCTION DETAIL | | | CONSTRUCTION DETAIL (CONTINUED) | | |
|---------------------|----|----------------|---------------------------------|----|-------------|
| Element | Cd | Description | Element | Cd | Description |
| Style | 03 | Colonial | | | |
| Model | 01 | Residential | | | |
| Grade: | B | Custom | | | |
| Stories | 2 | 2 Stories | | | |
| Exterior Wall 1 | 11 | Clapboard | | | |
| Exterior Wall 2 | | | | | |
| Roof Structure | 03 | Gable/Hip | | | |
| Roof Cover | 03 | Asph/F Gls/Cmp | | | |
| Interior Wall 1 | 05 | Drywall | | | |
| Interior Wall 2 | | | | | |
| Interior Floor 1 | 14 | Carpet | | | |
| Interior Floor 2 | 12 | Hardwood | | | |
| Heat Fuel | 03 | Gas | | | |
| Heat Type | 04 | Hot Air | | | |
| AC Type | 03 | Central | | | |
| Bedrooms | 05 | 5 Bedrooms | | | |
| Full Baths | 4 | | | | |
| Half Baths | 1 | | | | |
| Extra Fixtures | | | | | |
| Total Rooms | 9 | | | | |
| Bath Style | | | | | |
| Kitchen Style | | | | | |
| Occupancy | | | | | |
| Usrflid 105 | | | | | |
| Accessory Apt | | | | | |
| Foundation Alt | 01 | Poured Conc. | | | |
| Rms Prts | | | | | |
| Bath Split | 41 | 4 Full-1 Half | | | |

| CONDO DATA | | | | |
|-------------|------|-------------|---------|-----|
| Parcel Id | | C | Owne | 0.0 |
| Adjust Type | Code | Description | Factor% | |
| Condo Flr | | | | |
| Condo Unit | | | | |

| COST / MARKET VALUATION | | |
|--------------------------|--|-----------|
| Building Value New | | 1,070,409 |
| Year Built | | 1985 |
| Effective Year Built | | 1998 |
| Depreciation Code | | A |
| Remodel Rating | | |
| Year Remodeled | | |
| Depreciation % | | 16 |
| Functional Obsol | | 0 |
| External Obsol | | 0 |
| Trend Factor | | 1 |
| Condition | | |
| Condition % | | |
| Percent Good | | 84 |
| RCNLD | | 899,100 |
| Dep % Ovr | | |
| Dep Ovr Comment | | |
| Misc Imp Ovr | | |
| Misc Imp Ovr Comment | | |
| Cost to Cure Ovr | | |
| Cost to Cure Ovr Comment | | |

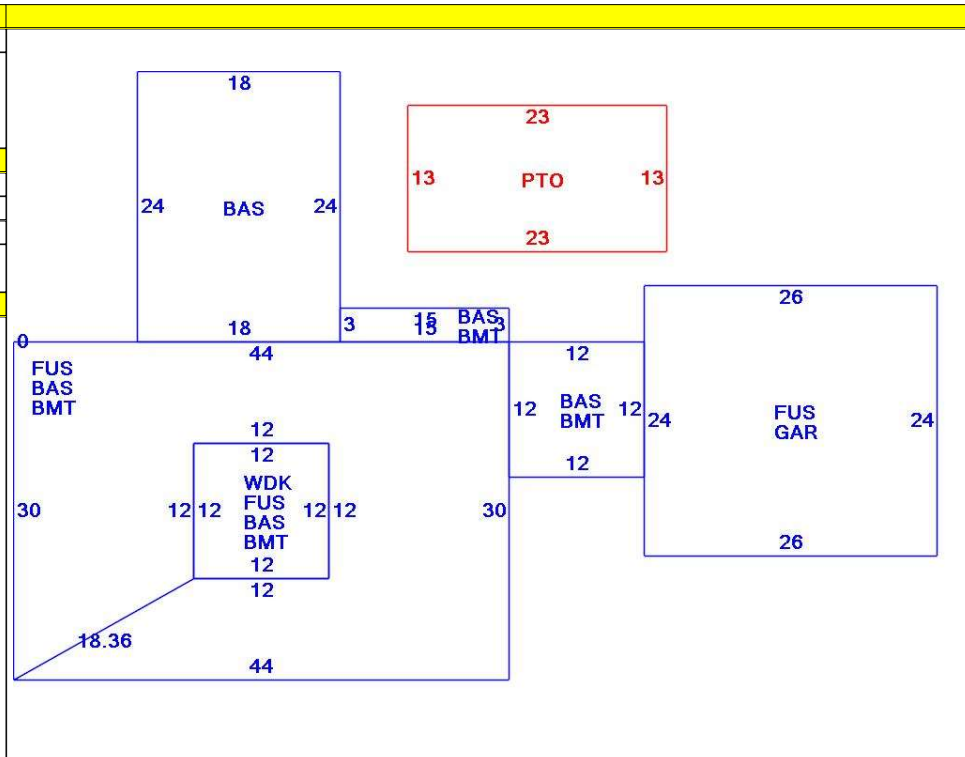

| OB - OUTBUILDING & YARD ITEMS(L) / XF - BUILDING EXTRA FEATURES(B) | | | | | | | | | | |
|--|-----------------|-----|-------|------------|--------|----------|------|-------|------------|-------------|
| Code | Description | L/B | Units | Unit Price | Yr Blt | Cond. Cd | % Gd | Grade | Grade Adj. | Appr. Value |
| FPL2 | Fireplace 1.5 s | B | 1 | 6000.00 | 2000 | | 84 | | 0.00 | 5,000 |
| FPO | Ext FP Openin | B | 1 | 2000.00 | 2000 | | 84 | | 0.00 | 1,700 |
| FPL1 | Fireplace 1 sto | B | 1 | 5000.00 | 2000 | | 84 | | 0.00 | 4,200 |
| GEN | Emergency Ge | L | 1 | 5550.00 | 2008 | | 78 | | 0.00 | 4,300 |
| WDC | Wood Decking | L | 144 | 20.00 | 1999 | | 60 | | 0.00 | 2,400 |
| PATS | Patio-Concrete | L | 299 | 20.00 | 1999 | | 80 | | 0.00 | 4,800 |
| GAR | Attached Gara | B | 624 | 40.00 | 2000 | | 84 | | 0.00 | 18,200 |
| BMT | Basement-Unfi | B | 1,509 | 26.01 | 2000 | | 84 | | 0.00 | 29,900 |
| FPLG | Gas Fireplace- | B | 1 | 2500.00 | 2000 | | 84 | | 0.00 | 2,100 |

| BUILDING SUB-AREA SUMMARY SECTION | | | | | | |
|-----------------------------------|-----------------|-------------|------------|----------|-----------|----------------|
| Code | Description | Living Area | Floor Area | Eff Area | Unit Cost | Undeprec Value |
| BAS | First Floor | 1,941 | 1,941 | 1,941 | 275.52 | 534,791 |
| BMT | Basement Area | 0 | 1,509 | 0 | 0.00 | 0 |
| FUS | Upper Story | 1,944 | 1,944 | 1,944 | 275.52 | 535,618 |
| GAR | Attached Garage | 0 | 624 | 0 | 0.00 | 0 |
| PTO | Patio | 0 | 299 | 0 | 0.00 | 0 |
| WDK | Wood Deck | 0 | 144 | 0 | 0.00 | 0 |
| Ttl Gross Liv / Lease Area | | 3,885 | 6,461 | 3,885 | | 1,070,409 |

