

| CURRENT OWNER  |  | TOPO  | UTILITIES      | STRT / ROAD   | LOCATION | CURRENT ASSESSMENT |      |           |           |
|--|--|---|----------------|---|----------|--------------------|------|-----------|-----------|
| CEDERGREN, KARIN MORNER & PE<br><br>100 VILLA BELLA DRIVE<br><br>ISLAMORADA FL 33036 |  | 1 Level   | 6 Septic       | 1 Paved   |          | Description        | Code | Assessed  | Assessed  |
|  |  |   | 4 Gas          |   |          | RESIDNTL           | 1010 | 738,700   | 738,700   |
|  |  |   | 2 Public Water |   |          | RES LAND           | 1010 | 346,400   | 346,400   |
| <b>SUPPLEMENTAL DATA</b>   |  |   |                |   |          | Total              |      |           |           |
|  |  | Alt Prcl ID<br>Split Zonin<br>BID Parcel<br>ResExpt Q NO APP:<br>#DL 1 LOT 3<br>#DL 2 |                | Plan Ref.<br>Land Ct# 41630-A<br>#SR<br>Life Estate<br>PP STATU<br><br>Assoc Pid# |          |                    |      |           |           |
|  |  |   |                |   |          | Total              |      | 1,085,100 | 1,085,100 |

801  
 FY2024  
 BARNSTABLE, MA

**VISION**

| RECORD OF OWNERSHIP           |         | BK-VOL/PAGE | SALE DATE  | Q/U | V/I | SALE PRIC | VC | PREVIOUS ASSESSMENTS (HISTORY) |      |          |       |      |          |       |  |         |
|-------------------------------|---------|-------------|------------|-----|-----|-----------|----|--------------------------------|------|----------|-------|------|----------|-------|--|---------|
| CEDERGREN, KARIN MORNER & PER | C228090 | 0           | 11-02-2021 | Q   | I   | 1,050,000 | 00 | Year                           | Code | Assessed | Year  | Code | Assessed |       |  |         |
| MATHIEU, GREGG E & DEBORAH J  | C161136 | 0           | 04-09-2001 | Q   | I   | 535,000   | 1  | 2023                           | 1010 | 663,300  | 2022  | 1010 | 557,600  |       |  |         |
| HANNAN, ANNETTE               | C148240 | 0           | 04-27-1998 | Q   | I   | 355,000   | 00 |                                | 1010 | 322,200  |       | 1010 | 223,400  |       |  |         |
| HILL, GERARD F & JEAN M       | C132629 | 0           | 01-15-1994 | Q   | I   | 284,000   | U  |                                |      |          |       | 1010 | 7,300    |       |  |         |
| DACEY, BRIAN T TR             | C126707 | 0           | 05-15-1992 | U   | V   | 56,000    | B  | Total                          |      | 985,500  | Total |      | 781,000  | Total |  | 720,900 |

| EXEMPTIONS |      |                          |        | OTHER ASSESSMENTS |             |        |        |
|------------|------|--------------------------|--------|-------------------|-------------|--------|--------|
| Year       | Code | Description              | Amount | Code              | Description | Number | Amount |
| 2023       | N5C  | NO RESIDENTIAL EXEMPTION | 0.00   |                   |             |        |        |
| Total      |      |                          | 0.00   |                   |             |        |        |

This signature acknowledges a visit by a Data Collector or Assessor

| ASSESSING NEIGHBORHOOD |           |   |         |
|------------------------|-----------|---|---------|
| Nbhd                   | Nbhd Name | B | Tracing |
| 0109                   |           |   | CENVIL  |

| APPRAISED VALUE SUMMARY       |           |
|-------------------------------|-----------|
| Appraised Bldg. Value (Card)  | 656,000   |
| Appraised Xf (B) Value (Bldg) | 75,400    |
| Appraised Ob (B) Value (Bldg) | 7,300     |
| Appraised Land Value (Bldg)   | 346,400   |
| Special Land Value            | 0         |
| Total Appraised Parcel Value  | 1,085,100 |
| Valuation Method              | C         |
| Total Appraised Parcel Value  | 1,085,100 |

| BUILDING PERMIT RECORD |            |      |                |         |            |        |            |                             | VISIT / CHANGE HISTORY |    |      |    |    |                            |
|------------------------|------------|------|----------------|---------|------------|--------|------------|-----------------------------|------------------------|----|------|----|----|----------------------------|
| Permit Id              | Issue Date | Type | Description    | Amount  | Insp Date  | % Comp | Date Comp  | Comments                    | Date                   | Id | Type | Is | Cd | Purpost/Result             |
| 20-2399                | 09-18-2020 | 835  | Sid/Wind/Roof/ | 1,700   |            | 100    |            | Remove and replace existing | 02-02-2022             | BM | 03   |    | 16 | In Office Review           |
| 20-1577                | 06-25-2020 | 822  | Insulation     | 4,600   |            | 100    |            | attic insulation            | 05-27-2020             | LS |      |    | FR | Field Review               |
| 53088                  | 05-01-2001 | RE   | Remodel        | 20,000  | 01-01-2002 | 100    | 06-30-2002 | FINISH BASEMENT             | 01-30-2015             | JR | 03   |    | 03 | Cycl Insp Comp             |
| B36105                 | 08-01-1993 | DW   | Dwelling       | 170,000 | 01-15-1994 | 100    | 06-30-1994 | CE 11/2 S                   | 06-01-2011             | RB | 03   |    | 03 | Cycl Insp Comp             |
|                        |            |      |                |         |            |        |            |                             | 11-26-2008             | PT | 02   |    | 14 | Cyclical Inspection        |
|                        |            |      |                |         |            |        |            |                             | 04-05-2002             | MF | 02   |    | 02 | Bldg Permit Completed      |
|                        |            |      |                |         |            |        |            |                             | 06-07-2001             | SM | 01   |    | 00 | Meas/Listed-Interior Acces |

| LAND LINE VALUATION SECTION |          |                |      |    |            |               |                        |         |            |       |       |           |                  |                    |            |            |
|-----------------------------|----------|----------------|------|----|------------|---------------|------------------------|---------|------------|-------|-------|-----------|------------------|--------------------|------------|------------|
| B                           | Use Code | Description    | Zone | LA | Land Units | Unit Price    | Size Adj               | AC Disc | Site Index | Cond. | Nbhd. | Nbhd. Adj | Notes            | Location Adjustmen | Adj Unit P | Land Value |
| 1                           | 1010     | Single Fam M-0 | RD-  | 3  | 0.480      | AC 176,344.00 | 1.84893                | 1.0000  | 5          | 1.00  | 0109  | 2.200     |                  |                    | 1.0000     | 717,314.4  |
| 1                           | 1010     | Single Fam M-0 | RD-  | 3  | 0.870      | AC 2,375.00   | 1.00000                | 1.0000  | 0          | 1.00  | WTLD  | 1.000     | WETLAND          |                    | 1.0000     | 2,375      |
| Total Card Land Units       |          |                |      |    | 1.35       | AC            | Parcel Total Land Area |         |            |       |       | 1.35      | Total Land Value |                    |            | 346,400    |

| CONSTRUCTION DETAIL |      |                | CONSTRUCTION DETAIL (CONTINUED) |    |             |
|---------------------|------|----------------|---------------------------------|----|-------------|
| Element             | Cd   | Description    | Element                         | Cd | Description |
| Style               | 04   | Cape Cod       |                                 |    |             |
| Model               | 01   | Residential    |                                 |    |             |
| Grade:              | C+   | Average Plus   |                                 |    |             |
| Stories             | 1.75 | 1 3/4 Stories  |                                 |    |             |
| Exterior Wall 1     | 14   | Wood Shingle   |                                 |    |             |
| Exterior Wall 2     | 11   | Clapboard      |                                 |    |             |
| Roof Structure      | 03   | Gable/Hip      |                                 |    |             |
| Roof Cover          | 03   | Asph/F Gls/Cmp |                                 |    |             |
| Interior Wall 1     | 03   | Plastered      |                                 |    |             |
| Interior Wall 2     |      |                |                                 |    |             |
| Interior Floor 1    | 14   | Carpet         |                                 |    |             |
| Interior Floor 2    | 12   | Hardwood       |                                 |    |             |
| Heat Fuel           | 03   | Gas            |                                 |    |             |
| Heat Type           | 04   | Hot Air        |                                 |    |             |
| AC Type             | 03   | Central        |                                 |    |             |
| Bedrooms            | 03   | 3 Bedrooms     |                                 |    |             |
| Full Baths          | 4    |                |                                 |    |             |
| Half Baths          | 1    |                |                                 |    |             |
| Extra Fixtures      |      |                |                                 |    |             |
| Total Rooms         | 10   | 8 Rooms        |                                 |    |             |
| Bath Style          |      |                |                                 |    |             |
| Kitchen Style       |      |                |                                 |    |             |
| Occupancy           |      |                |                                 |    |             |
| Usrflid 105         |      |                |                                 |    |             |
| Accessory Apt       |      |                |                                 |    |             |
| Foundation Alt      | 01   | Poured Conc.   |                                 |    |             |
| Rms Prts            |      |                |                                 |    |             |
| Bath Split          | 41   | 4 Full-1 Half  |                                 |    |             |

| CONDO DATA  |      |             |         |          |
|-------------|------|-------------|---------|----------|
| Parcel Id   |      | C           |         | Owne 0.0 |
|             |      |             | B       | S        |
| Adjust Type | Code | Description | Factor% |          |
| Condo Flr   |      |             |         |          |
| Condo Unit  |      |             |         |          |

| COST / MARKET VALUATION  |  |         |
|--------------------------|--|---------|
| Building Value New       |  | 754,008 |
| Year Built               |  | 1993    |
| Effective Year Built     |  | 2002    |
| Depreciation Code        |  | A       |
| Remodel Rating           |  |         |
| Year Remodeled           |  |         |
| Depreciation %           |  | 13      |
| Functional Obsol         |  | 0       |
| External Obsol           |  | 0       |
| Trend Factor             |  | 1       |
| Condition                |  |         |
| Condition %              |  |         |
| Percent Good             |  | 87      |
| RCNLD                    |  | 656,000 |
| Dep % Ovr                |  |         |
| Dep Ovr Comment          |  |         |
| Misc Imp Ovr             |  |         |
| Misc Imp Ovr Comment     |  |         |
| Cost to Cure Ovr         |  |         |
| Cost to Cure Ovr Comment |  |         |

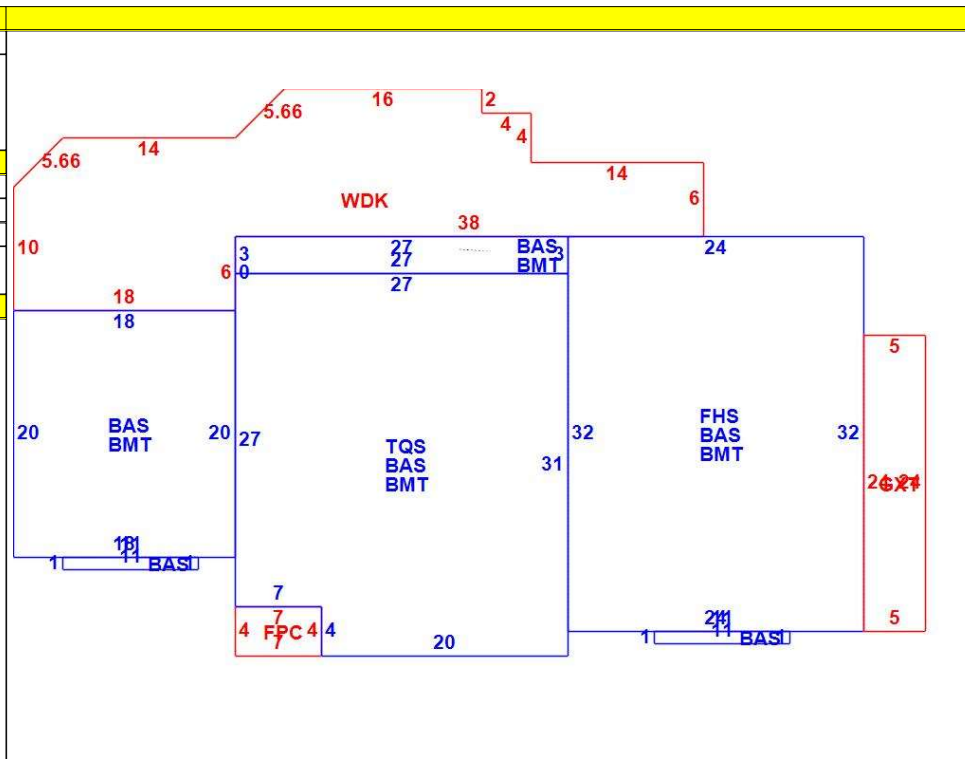

| OB - OUTBUILDING & YARD ITEMS(L) / XF - BUILDING EXTRA FEATURES(B) |                 |     |       |            |        |          |      |       |            |             |
|--|-----------------|-----|-------|------------|--------|----------|------|-------|------------|-------------|
| Code   | Description     | L/B | Units | Unit Price | Yr Blt | Cond. Cd | % Gd | Grade | Grade Adj. | Appr. Value |
| FPL2   | Fireplace 1.5 s | B   | 1     | 6000.00    | 2004   |          | 87   |       | 0.00       | 5,200       |
| BGAR   | Bsmt Garage     | B   | 1     | 2326.00    | 2004   |          | 87   |       | 0.00       | 2,000       |
| BFA1   | Bsmt Fin-Goo    | B   | 728   | 32.56      | 2004   |          | 87   |       | 0.00       | 20,600      |
| WDC  | Wood Decking    | L   | 600   | 20.00      | 2002   |          | 66   |       | 0.00       | 7,300       |
| FOPC   | Open Prch-roo   | B   | 28    | 55.00      | 2004   |          | 87   |       | 0.00       | 1,600       |
| BMT  | Basement-Unfi   | B   | 2,018 | 26.01      | 2004   |          | 87   |       | 0.00       | 39,200      |
| GXT  | Garage Extens   | B   | 120   | 65.00      | 2004   |          | 87   |       | 0.00       | 6,800       |

| BUILDING SUB-AREA SUMMARY SECTION |                        |             |            |          |           |                |
|-----------------------------------|------------------------|-------------|------------|----------|-----------|----------------|
| Code                              | Description            | Living Area | Floor Area | Eff Area | Unit Cost | Undeprec Value |
| BAS                               | First Floor            | 2,040       | 2,040      | 2,040    | 255.60    | 521,416        |
| BMT                               | Basement Area          | 0           | 2,018      | 0        | 0.00      | 0              |
| FHS                               | Half Story             | 384         | 768        | 384      | 127.80    | 98,149         |
| FPC                               | Open Porch Conc. Floor | 0           | 28         | 0        | 0.00      | 0              |
| GXT                               | Gar Extension-Front    | 0           | 120        | 0        | 0.00      | 0              |
| TQS                               | Three Quarter Story    | 526         | 809        | 526      | 166.18    | 134,443        |
| WDK                               | Wood Deck              | 0           | 600        | 0        | 0.00      | 0              |
| Ttl Gross Liv / Lease Area        |                        | 2,950       | 6,383      | 2,950    |           | 754,008        |



11/21/2019