

| CURRENT OWNER | | TOPO | UTILITIES | STRT / ROAD | LOCATION | CURRENT ASSESSMENT | | | |
|---|--|---------|----------------|---|----------|-----------------------|------|----------|----------|
| PATKOWSKI, CAROLYN TR CAROLYN PATKOWSKI LIVING TRUS 1390 BUMPS RIVER ROAD CENTERVILLE MA 02632 | | 1 Level | 2 Public Water | 1 Paved | | Description | Code | Assessed | Assessed |
| | | | 4 Gas | | | RESIDNTL | 1010 | 515,700 | 515,700 |
| | | | 6 Septic | | | RES LAND | 1010 | 246,900 | 246,900 |
| SUPPLEMENTAL DATA | | | | | | | | | |
| Alt Prcl ID Split Zonin BID Parcel ResExpt Q YES: #DL 1 #DL 2 GIS ID F_970169_2699448 | | | | Plan Ref. SEE DEED DESC Land Ct# #SR Life Estate PP STATU Assoc Pid# | | Total 762,600 762,600 | | | |

801
 FY2024
 BARNSTABLE, MA
VISION

| RECORD OF OWNERSHIP | | BK-VOL/PAGE | SALE DATE | Q/U | V/I | SALE PRIC | VC | PREVIOUS ASSESSMENTS (HISTORY) | | | | | |
|--------------------------------|--|-------------|------------|-----|-----|-----------|----|--------------------------------|------|----------|-------|------|----------|
| PATKOWSKI, CAROLYN TR | | 34289 203 | 07-13-2021 | U | I | 1 | 1F | Year | Code | Assessed | Year | Code | Assessed |
| PATKOWSKI, CAROLYN H | | 26163 0332 | 03-16-2012 | U | I | 1 | 1A | 2023 | 1010 | 441,900 | 2022 | 1010 | 369,700 |
| PATKOWSKI, PIOTR & CAROLYN TRS | | 17553 0194 | 08-29-2003 | U | I | 0 | 1F | | 1010 | 224,400 | | 1010 | 154,400 |
| PATKOWSKI, PIOTR J & CAROLYN | | 5784 0307 | 06-15-1987 | Q | I | 224,500 | U | | | | | 1010 | 11,600 |
| BEARSE, SANDRA | | 5286 0221 | 09-15-1986 | U | I | 1 | 1A | Total | | 666,300 | Total | | 524,100 |
| | | | | | | | | Total | | | Total | | 467,800 |

| EXEMPTIONS | | | | OTHER ASSESSMENTS | | | |
|------------|------|-----------------------|--------|-------------------|-------------|--------|--------|
| Year | Code | Description | Amount | Code | Description | Number | Amount |
| 2023 | 5C | RESIDENTIAL EXEMPTION | 0.00 | | | | |
| Total | | | 0.00 | | | | |

This signature acknowledges a visit by a Data Collector or Assessor

| ASSESSING NEIGHBORHOOD | | | |
|------------------------|-----------|---|---------|
| Nbhd | Nbhd Name | B | Tracing |
| 0107 | | | CENVIL |

| APPRAISED VALUE SUMMARY | |
|-------------------------------|---------|
| Appraised Bldg. Value (Card) | 456,300 |
| Appraised Xf (B) Value (Bldg) | 47,800 |
| Appraised Ob (B) Value (Bldg) | 11,600 |
| Appraised Land Value (Bldg) | 246,900 |
| Special Land Value | 0 |
| Total Appraised Parcel Value | 762,600 |
| Valuation Method | C |
| Total Appraised Parcel Value | 762,600 |

| NOTES | | | | | | | | | |
|-------|--|--|--|--|--|--|--|--|--|
| | | | | | | | | | |

| BUILDING PERMIT RECORD | | | | | | | | | VISIT / CHANGE HISTORY | | | | | |
|------------------------|------------|------|-------------|--------|------------|--------|------------|----------|------------------------|----|------|----|----|------------------|
| Permit Id | Issue Date | Type | Description | Amount | Insp Date | % Comp | Date Comp | Comments | Date | Id | Type | Is | Cd | Purpost/Result |
| 15749 | 06-10-1986 | RE | Remodel | 6,400 | 01-01-1997 | 100 | 01-01-1997 | FAT | 08-03-2022 | JO | | | 16 | In Office Review |
| B29570 | 06-01-1986 | AD | Addition | 15,000 | 01-15-1987 | 100 | 01-15-1987 | CE ADD'N | 05-27-2020 | LS | | | FR | Field Review |
| | | | | | | | | | 01-21-2016 | SR | 02 | | 03 | Cycl Insp Comp |
| | | | | | | | | | 03-27-2013 | GC | 03 | | 16 | In Office Review |
| | | | | | | | | | 03-20-2013 | DR | 03 | | 16 | In Office Review |
| | | | | | | | | | 03-19-2012 | DR | 03 | | 16 | In Office Review |
| | | | | | | | | | 09-06-2011 | RB | 03 | | 16 | In Office Review |

| LAND LINE VALUATION SECTION | | | | | | | | | | | | | | | | | |
|-----------------------------|----------|----------------|------|----|------------|------------|------------------------|---------|------------|-------|-------|-----------|------------------|--------------------|------------|------------|---------|
| B | Use Code | Description | Zone | LA | Land Units | Unit Price | Size Adj | AC Disc | Site Index | Cond. | Nbhd. | Nbhd. Adj | Notes | Location Adjustmen | Adj Unit P | Land Value | |
| 1 | 1010 | Single Fam M-0 | RD- | 3 | 1.000 AC | 176,344.00 | 1.00000 | 1.0000 | 5 | 1.00 | 0107 | 1.400 | | | 1.0000 | 246,881.6 | |
| Total Card Land Units | | | | | 1.00 | AC | Parcel Total Land Area | | | | | 1.00 | Total Land Value | | | | 246,900 |

| CONSTRUCTION DETAIL | | | CONSTRUCTION DETAIL (CONTINUED) | | |
|---------------------|-----|----------------|---------------------------------|----|-------------|
| Element | Cd | Description | Element | Cd | Description |
| Style | 06 | Conventional | | | |
| Model | 01 | Residential | | | |
| Grade: | C+ | Average Plus | | | |
| Stories | 2.4 | | | | |
| Exterior Wall 1 | 11 | Clapboard | | | |
| Exterior Wall 2 | | | | | |
| RooF Structure | 03 | Gable/Hip | | | |
| RooF Cover | 03 | Asph/F Gls/Cmp | | | |
| Interior Wall 1 | 03 | Plastered | | | |
| Interior Wall 2 | | | | | |
| Interior Floor 1 | 09 | Pine/Soft Wood | | | |
| Interior Floor 2 | 14 | Carpet | | | |
| Heat Fuel | 02 | Oil | | | |
| Heat Type | 05 | Hot Water | | | |
| AC Type | 01 | None | | | |
| Bedrooms | 04 | 4 Bedrooms | | | |
| Full Baths | 1 | | | | |
| Half Baths | 1 | | | | |
| Extra Fixtures | | | | | |
| Total Rooms | 8 | 8 Rooms | | | |
| Bath Style | | | | | |
| Kitchen Style | | | | | |
| Occupancy | | | | | |
| Usrflid 105 | | | | | |
| Accessory Apt | | | | | |
| Foundation Alt | 05 | Stone Walls | | | |
| Rms Prts | | | | | |
| Bath Split | 11 | 1 Full-1 Half | | | |

| CONDO DATA | | | | |
|-------------|------|-------------|---------|----------|
| Parcel Id | | C | | Owne 0.0 |
| | | | B | S |
| Adjust Type | Code | Description | Factor% | |
| Condo Flr | | | | |
| Condo Unit | | | | |

| COST / MARKET VALUATION | |
|--------------------------|---------|
| Building Value New | 625,031 |
| Year Built | 1900 |
| Effective Year Built | 1984 |
| Depreciation Code | G |
| Remodel Rating | |
| Year Remodeled | |
| Depreciation % | 27 |
| Functional Obsol | 0 |
| External Obsol | 0 |
| Trend Factor | 1 |
| Condition | |
| Condition % | |
| Percent Good | 73 |
| RCNLD | 456,300 |
| Dep % Ovr | |
| Dep Ovr Comment | |
| Misc Imp Ovr | |
| Misc Imp Ovr Comment | |
| Cost to Cure Ovr | |
| Cost to Cure Ovr Comment | |

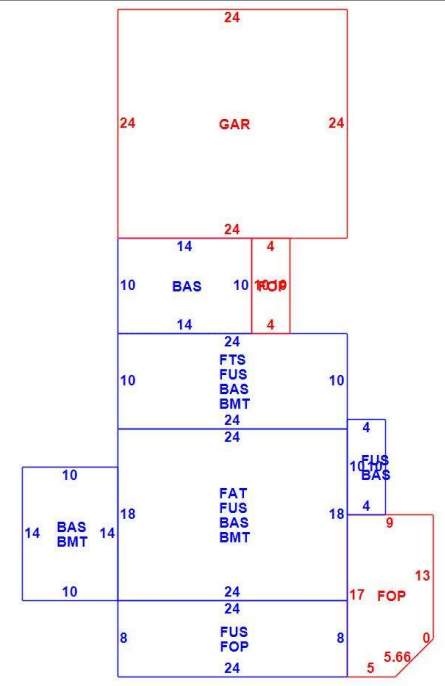

| OB - OUTBUILDING & YARD ITEMS(L) / XF - BUILDING EXTRA FEATURES(B) | | | | | | | | | | |
|--|-----------------|-----|-------|------------|--------|----------|------|-------|------------|-------------|
| Code | Description | L/B | Units | Unit Price | Yr Blt | Cond. Cd | % Gd | Grade | Grade Adj. | Appr. Value |
| FPL1 | Fireplace 1 sto | B | 1 | 5000.00 | 1984 | | 73 | | 0.00 | 3,700 |
| FGR6 | Gar w/Lft Avg | L | 360 | 60.00 | 1950 | | 31 | 00 | 1.00 | 6,700 |
| FOP | Open Porch-ro | B | 377 | 55.00 | 1984 | | 73 | | 0.00 | 10,700 |
| GAR | Attached Gara | B | 576 | 40.00 | 1984 | | 73 | | 0.00 | 14,900 |
| BMT | Basement-Unfi | B | 812 | 26.01 | 1984 | | 73 | | 0.00 | 16,700 |
| FPLG | Gas Fireplace- | B | 1 | 2500.00 | 1984 | | 73 | | 0.00 | 1,800 |
| GEN | Emergency Ge | L | 1 | 5550.00 | 2013 | | 88 | | 0.00 | 4,900 |

| BUILDING SUB-AREA SUMMARY SECTION | | | | | | |
|-----------------------------------|----------------------|-------------|------------|----------|-----------|----------------|
| Code | Description | Living Area | Floor Area | Eff Area | Unit Cost | Undeprec Value |
| BAS | First Floor | 992 | 992 | 992 | 283.98 | 281,704 |
| BMT | Basement Area | 0 | 812 | 0 | 0.00 | 0 |
| FAT | Attic, Finished | 65 | 432 | 65 | 42.73 | 18,458 |
| FOP | Open Porch | 0 | 377 | 0 | 0.00 | 0 |
| FTS | Finished Third Story | 240 | 240 | 240 | 283.98 | 68,154 |
| FUS | Upper Story | 904 | 904 | 904 | 283.98 | 256,714 |
| GAR | Attached Garage | 0 | 576 | 0 | 0.00 | 0 |
| Ttl Gross Liv / Lease Area | | 2,201 | 4,333 | 2,201 | | 625,030 |

