

| CURRENT OWNER   |  | TOPO           | UTILITIES      | STRT / ROAD | LOCATION   | CURRENT ASSESSMENT                  |                      |                                |                                |
|---|--|----------------|----------------|-------------|--|-------------------------------------|----------------------|--------------------------------|--------------------------------|
| SMITH, GREGG P & PRICE, JANE M<br>MALEC REALTY TRUST<br>20 ABERDEEN AVENUE<br><br>WEST NYACK NY 10994     |  | 2 Above Street | 2 Public Water |             |  | Description<br>RESIDNTL<br>RES LAND | Code<br>1010<br>1010 | Assessed<br>298,100<br>155,900 | Assessed<br>298,100<br>155,900 |
|   |  | 4 Gas          | 1 Paved        |             |  |                                     |                      |                                |                                |
|   |  | 6 Septic       |                |             |  |                                     |                      |                                |                                |
| SUPPLEMENTAL DATA   |  |                |                |             |  |                                     |                      |                                |                                |
| Alt Prcl ID<br>Split Zonin<br>BID Parcel<br>ResExpt Q<br>#DL 1 LOT 52<br>#DL 2<br>GIS ID F_946051_2695055 |  |                |                |             | Plan Ref. TUBE 167<br>Land Ct#<br>#SR<br>Life Estate<br>PP STATU<br>Assoc Pid# |                                     |                      |                                |                                |
| Total   |  |                |                |             |  |                                     | 454,000              | 454,000                        |                                |

801  
 FY2024  
 BARNSTABLE, MA  
**VISION**

| RECORD OF OWNERSHIP                |       | BK-VOL/PAGE | SALE DATE  | Q/U | V/I | SALE PRIC | VC | PREVIOUS ASSESSMENTS (HISTORY) |      |          |       |      |          |       |  |         |
|------------------------------------|-------|-------------|------------|-----|-----|-----------|----|--------------------------------|------|----------|-------|------|----------|-------|--|---------|
| SMITH, GREGG P & PRICE, JANE M TRS | 25192 | 0076        | 01-19-2011 | U   | I   | 1         | 1F | Year                           | Code | Assessed | Year  | Code | Assessed |       |  |         |
| SMITH, GREGG P & PRICE, JANE M     | 24832 | 0335        | 09-16-2010 | U   | I   | 1         | 1F | 2023                           | 1010 | 260,300  | 2022  | 1010 | 225,300  |       |  |         |
| SMITH, GREGG P & PRICE, JANE M TRS | 22432 | 0290        | 10-29-2007 | U   | I   | 1         | 1A |                                | 1010 | 141,700  | 2021  | 1010 | 105,000  |       |  |         |
| SMITH, GREGG P & COLLEEN M         | 21204 | 0088        | 07-21-2006 | U   | I   | 1         | 1A |                                |      |          |       | 1010 | 2,700    |       |  |         |
| MALEC, JOHN E & JANE G             | 7978  | 0274        | 04-15-1992 | U   | I   | 1         | F  | Total                          |      | 402,000  | Total |      | 330,300  | Total |  | 291,100 |

| EXEMPTIONS |      |             | OTHER ASSESSMENTS |      |             |        |        |          |
|------------|------|-------------|-------------------|------|-------------|--------|--------|----------|
| Year       | Code | Description | Amount            | Code | Description | Number | Amount | Comm Int |
| Total      |      |             | 0.00              |      |             |        |        |          |

This signature acknowledges a visit by a Data Collector or Assessor

| APPRAISED VALUE SUMMARY       |         |
|-------------------------------|---------|
| Appraised Bldg. Value (Card)  | 257,300 |
| Appraised Xf (B) Value (Bldg) | 38,100  |
| Appraised Ob (B) Value (Bldg) | 2,700   |
| Appraised Land Value (Bldg)   | 155,900 |
| Special Land Value            | 0       |
| Total Appraised Parcel Value  | 454,000 |
| Valuation Method              | C       |
| Total Appraised Parcel Value  | 454,000 |

| ASSESSING NEIGHBORHOOD |           |   |         |
|------------------------|-----------|---|---------|
| Nbhd                   | Nbhd Name | B | Tracing |
| 0105                   |           |   | COTUIT  |

| NOTES |  |  |  |  |  |  |  |  |  |
|-------|--|--|--|--|--|--|--|--|--|
|       |  |  |  |  |  |  |  |  |  |

| BUILDING PERMIT RECORD |            |      |             |        |            |        |            |           | VISIT / CHANGE HISTORY |    |      |    |    |                            |
|------------------------|------------|------|-------------|--------|------------|--------|------------|-----------|------------------------|----|------|----|----|----------------------------|
| Permit Id              | Issue Date | Type | Description | Amount | Insp Date  | % Comp | Date Comp  | Comments  | Date                   | Id | Type | Is | Cd | Purpost/Result             |
| B21846                 | 11-01-1979 | DW   | Dwelling    | 0      | 01-15-1981 | 100    | 12-31-1981 | CO 1 STOR | 05-28-2020             | DM |      |    | FR | Field Review               |
|                        |            |      |             |        |            |        |            |           | 09-11-2013             | RB | 03   |    | 03 | Cycl Insp Comp             |
|                        |            |      |             |        |            |        |            |           | 03-20-2006             | JK | 22   |    | 22 | Change of Address          |
|                        |            |      |             |        |            |        |            |           | 03-31-2005             | PT | 02   |    | 01 | Meas/Est                   |
|                        |            |      |             |        |            |        |            |           | 09-15-1999             | MF | 01   |    | 00 | Meas/Listed-Interior Acces |

| LAND LINE VALUATION SECTION |          |                |      |    |            |                        |          |         |            |       |       |                  |       |                    |            |            |         |
|-----------------------------|----------|----------------|------|----|------------|------------------------|----------|---------|------------|-------|-------|------------------|-------|--------------------|------------|------------|---------|
| B                           | Use Code | Description    | Zone | LA | Land Units | Unit Price             | Size Adj | AC Disc | Site Index | Cond. | Nbhd. | Nbhd. Adj        | Notes | Location Adjustmen | Adj Unit P | Land Value |         |
| 1                           | 1010     | Single Fam M-0 | RF   | 2  | 0.460 AC   | 176,344.00             | 1.92125  | 1.0000  | 5          | 1.00  | 0105  | 1.000            |       | 1.0000             | 338,809.7  | 155,900    |         |
| Total Card Land Units       |          |                |      |    | 0.46 AC    | Parcel Total Land Area |          |         |            |       | 0.46  | Total Land Value |       |                    |            |            | 155,900 |

| CONSTRUCTION DETAIL |    |                | CONSTRUCTION DETAIL (CONTINUED) |    |             |
|---------------------|----|----------------|---------------------------------|----|-------------|
| Element             | Cd | Description    | Element                         | Cd | Description |
| Style               | 01 | Ranch          |                                 |    |             |
| Model               | 01 | Residential    |                                 |    |             |
| Grade:              | C  | Average        |                                 |    |             |
| Stories             | 1  | 1 Story        |                                 |    |             |
| Exterior Wall 1     | 14 | Wood Shingle   |                                 |    |             |
| Exterior Wall 2     |    |                |                                 |    |             |
| RooF Structure      | 03 | Gable/Hip      |                                 |    |             |
| RooF Cover          | 03 | Asph/F Gls/Cmp |                                 |    |             |
| Interior Wall 1     | 05 | Drywall        |                                 |    |             |
| Interior Wall 2     |    |                |                                 |    |             |
| Interior Floor 1    | 12 | Hardwood       |                                 |    |             |
| Interior Floor 2    | 05 | Vinyl/Asphalt  |                                 |    |             |
| Heat Fuel           | 03 | Gas            |                                 |    |             |
| Heat Type           | 05 | Hot Water      |                                 |    |             |
| AC Type             | 01 | None           |                                 |    |             |
| Bedrooms            | 03 | 3 Bedrooms     |                                 |    |             |
| Full Baths          | 1  |                |                                 |    |             |
| Half Baths          | 1  |                |                                 |    |             |
| Extra Fixtures      |    |                |                                 |    |             |
| Total Rooms         | 5  | 5 Rooms        |                                 |    |             |
| Bath Style          |    |                |                                 |    |             |
| Kitchen Style       |    |                |                                 |    |             |
| Occupancy           |    |                |                                 |    |             |
| Usrflid 105         |    |                |                                 |    |             |
| Accessory Apt       |    |                |                                 |    |             |
| Foundation Alt      | 01 | Poured Conc.   |                                 |    |             |
| Rms Prts            |    |                |                                 |    |             |
| Bath Split          | 11 | 1 Full-1 Half  |                                 |    |             |

| CONDO DATA  |      |             |          |
|-------------|------|-------------|----------|
| Parcel Id   |      | C           | Ownr 0.0 |
|             |      | B           | S        |
| Adjust Type | Code | Description | Factor%  |
| Condo Flr   |      |             |          |
| Condo Unit  |      |             |          |

| COST / MARKET VALUATION  |         |
|--------------------------|---------|
| Building Value New       | 317,698 |
| Year Built               | 1979    |
| Effective Year Built     | 1995    |
| Depreciation Code        | A       |
| Remodel Rating           |         |
| Year Remodeled           |         |
| Depreciation %           | 19      |
| Functional Obsol         | 0       |
| External Obsol           | 0       |
| Trend Factor             | 1       |
| Condition                |         |
| Condition %              |         |
| Percent Good             | 81      |
| RCNLD                    | 257,300 |
| Dep % Ovr                |         |
| Dep Ovr Comment          |         |
| Misc Imp Ovr             |         |
| Misc Imp Ovr Comment     |         |
| Cost to Cure Ovr         |         |
| Cost to Cure Ovr Comment |         |

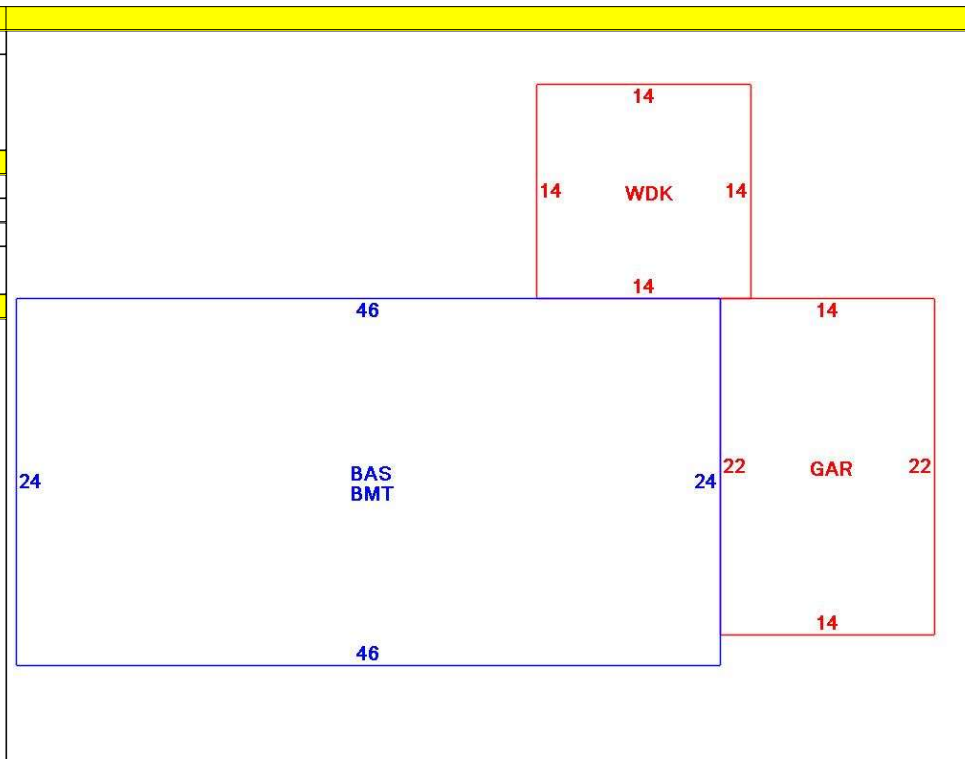

| OB - OUTBUILDING & YARD ITEMS(L) / XF - BUILDING EXTRA FEATURES(B) |                 |     |       |            |        |          |      |       |            |             |
|--|-----------------|-----|-------|------------|--------|----------|------|-------|------------|-------------|
| Code   | Description     | L/B | Units | Unit Price | Yr Blt | Cond. Cd | % Gd | Grade | Grade Adj. | Appr. Value |
| FPL1   | Fireplace 1 sto | B   | 1     | 5000.00    | 1997   |          | 81   |       | 0.00       | 4,100       |
| WDC  | Wood Decking    | L   | 196   | 20.00      | 1998   |          | 58   |       | 0.00       | 2,700       |
| GAR  | Attached Gara   | B   | 308   | 40.00      | 1997   |          | 81   |       | 0.00       | 11,000      |
| BMT  | Basement-Unfi   | B   | 1,104 | 26.01      | 1997   |          | 81   |       | 0.00       | 23,000      |

| BUILDING SUB-AREA SUMMARY SECTION |                 |             |            |          |           |                |
|-----------------------------------|-----------------|-------------|------------|----------|-----------|----------------|
| Code                              | Description     | Living Area | Floor Area | Eff Area | Unit Cost | Undeprec Value |
| BAS                               | First Floor     | 1,104       | 1,104      | 1,104    | 287.77    | 317,698        |
| BMT                               | Basement Area   | 0           | 1,104      | 0        | 0.00      | 0              |
| GAR                               | Attached Garage | 0           | 308        | 0        | 0.00      | 0              |
| WDC                               | Wood Deck       | 0           | 196        | 0        | 0.00      | 0              |
| Ttl Gross Liv / Lease Area        |                 | 1,104       | 2,712      | 1,104    |           | 317,698        |

