

| CURRENT OWNER  |         | TOPO           | UTILITIES | STRT / ROAD      | LOCATION | CURRENT ASSESSMENT |      |          |          | 801<br>FY2024<br>BARNSTABLE, MA<br><br><b>VISION</b> |         |
|--|---------|----------------|-----------|------------------|----------|--------------------|------|----------|----------|--|---------|
| MCBREARTY, ANDREW R & FIDLER,<br><br>15 CANTWELL ROAD<br><br>MILTON MA 02186 | 1 Level | 2 Public Water | 1 Paved   |                  |          | Description        | Code | Assessed | Assessed |  |         |
|  |         | 4 Gas          |           |                  |          | RESIDENTL          | 1010 | 403,300  | 403,300  |  |         |
|  |         | 6 Septic       |           |                  |          | RES LAND           | 1010 | 206,900  | 206,900  |  |         |
| <b>SUPPLEMENTAL DATA</b>   |         |                |           |                  |          | Total              |      |          |          | 610,200  | 610,200 |
| Alt Prcl ID  |         | Split Zonin    |           | Plan Ref. 140/33 |          |                    |      |          |          |  |         |
| MILTON MA 02186  |         | #DL 1 LOT 35   |           | Land Ct#         |          |                    |      |          |          |  |         |
| #DL 2  |         | ResExpt Q      |           | #SR              |          |                    |      |          |          |  |         |
| GIS ID F_972811_2697149  |         | Assoc Pid#     |           | Life Estate      |          |                    |      |          |          |  |         |
|  |         | PP STATU       |           |                  |          |                    |      |          |          |  |         |

| RECORD OF OWNERSHIP              |       | BK-VOL/PAGE | SALE DATE  | Q/U | V/I | SALE PRIC | VC | PREVIOUS ASSESSMENTS (HISTORY) |      |          |       |      |          |       |         |
|----------------------------------|-------|-------------|------------|-----|-----|-----------|----|--------------------------------|------|----------|-------|------|----------|-------|---------|
| MCBREARTY, ANDREW R & FIDLER, AN | 26560 | 0013        | 08-03-2012 | Q   | I   | 340,000   | 00 | Year                           | Code | Assessed | Year  | Code | Assessed |       |         |
| PROIA, FREDERICK & LESLIE M      | 15688 | 0047        | 10-02-2002 | Q   | I   | 320,000   | 00 | 2023                           | 1010 | 352,600  | 2022  | 1010 | 305,900  |       |         |
| BUSCONI, JOHN R                  | 12666 | 0316        | 11-16-1999 | Q   | I   | 185,000   | 00 |                                | 1010 | 188,100  |       | 1010 | 129,400  |       |         |
| HANSEN, KATHERINE F              | 8648  | 0010        | 06-15-1993 | Q   | I   | 1         | 00 |                                |      |          |       | 1010 | 26,400   |       |         |
| HANSEN, ROGER H & KATHERINE F    | 3023  | 0129        | 11-30-1979 | U   |     | 0         |    | Total                          |      | 540,700  | Total |      | 435,300  | Total | 384,900 |

| EXEMPTIONS |      |             | OTHER ASSESSMENTS |      |             |        | APPRAISED VALUE SUMMARY |                               |   |  |  |        |         |
|------------|------|-------------|-------------------|------|-------------|--------|-------------------------|-------------------------------|---|--|--|--------|---------|
| Year       | Code | Description | Amount            | Code | Description | Number | Amount                  | Comm Int                      | This signature acknowledges a visit by a Data Collector or Assessor |  |  |        |         |
|            |      |             |                   |      |             |        |                         |                               | Appraised Bldg. Value (Card)  |  |  |        | 343,300 |
| Total      |      |             | 0.00              |      |             |        |                         | Appraised Xf (B) Value (Bldg) |   |  |  | 33,600 |         |

| ASSESSING NEIGHBORHOOD |           |   |         |
|------------------------|-----------|---|---------|
| Nbhd                   | Nbhd Name | B | Tracing |
| 0107                   |           |   | CENVIL  |

| NOTES  |  |  |  |  |  |  |  |  |  |  |  |
|--|--|--|--|--|--|--|--|--|--|--|--|
| <p>Appraised Land Value (Bldg) 206,900</p> <p>Special Land Value 0</p> <p>Total Appraised Parcel Value 610,200</p> <p>Valuation Method C</p> <p>Total Appraised Parcel Value 610,200</p> |  |  |  |  |  |  |  |  |  |  |  |

| BUILDING PERMIT RECORD |            |      |              |         |            |        |           | VISIT / CHANGE HISTORY           |            |    |      |    |    |                     |
|------------------------|------------|------|--------------|---------|------------|--------|-----------|----------------------------------|------------|----|------|----|----|---------------------|
| Permit Id              | Issue Date | Type | Description  | Amount  | Insp Date  | % Comp | Date Comp | Comments                         | Date       | Id | Type | Is | Cd | Purpost/Result      |
| BLDR-23-78             | 07-17-2023 | 809  | Deck         | 10,000  |            | 0      |           | Construct a new 12' x 16'        | 05-14-2020 | WD |      |    | FR | Field Review        |
| BLDR-23-15             | 02-23-2023 | 804  | Addn Alt-Res | 100,000 |            | 0      |           | Interior renovation of kitchen a | 07-26-2016 | KM | 02   |    | 03 | Cycl Insp Comp      |
| B31873                 | 05-01-1988 | AD   | Addition     | 6,500   | 01-15-1989 | 100    |           | CE ENC.PC                        | 08-02-2013 | JR | 03   |    | 20 | Sale Review         |
| B31569                 | 01-01-1988 | AD   | Addition     | 12,000  | 01-15-1989 | 100    |           | CE GARAGE                        | 08-28-2009 | PT | 02   |    | 14 | Cyclical Inspection |
| B30948                 | 07-01-1987 | AD   | Addition     | 2,500   | 01-15-1989 | 100    |           | CE PORCH                         |            |    |      |    |    |                     |

| LAND LINE VALUATION SECTION |          |                |      |    |            |            |                        |         |            |       |       |           |                  |                    |            |            |
|-----------------------------|----------|----------------|------|----|------------|------------|------------------------|---------|------------|-------|-------|-----------|------------------|--------------------|------------|------------|
| B                           | Use Code | Description    | Zone | LA | Land Units | Unit Price | Size Adj               | AC Disc | Site Index | Cond. | Nbhd. | Nbhd. Adj | Notes            | Location Adjustmen | Adj Unit P | Land Value |
| 1                           | 1010     | Single Fam M-0 | RC   | 3  | 0.240 AC   | 176,344.00 | 3.49265                | 1.0000  | 5          | 1.00  | 0107  | 1.400     |                  | 1.0000             | 862,269.2  | 206,900    |
| Total Card Land Units       |          |                |      |    | 0.24       | AC         | Parcel Total Land Area |         |            |       |       | 0.24      | Total Land Value |                    |            | 206,900    |

| CONSTRUCTION DETAIL |    |                | CONSTRUCTION DETAIL (CONTINUED) |    |             |
|---------------------|----|----------------|---------------------------------|----|-------------|
| Element             | Cd | Description    | Element                         | Cd | Description |
| Style               | 01 | Ranch          |                                 |    |             |
| Model               | 01 | Residential    |                                 |    |             |
| Grade:              | C+ | Average Plus   |                                 |    |             |
| Stories             | 1  | 1 Story        |                                 |    |             |
| Exterior Wall 1     | 19 | Brick Veneer   |                                 |    |             |
| Exterior Wall 2     | 25 | Vinyl Siding   |                                 |    |             |
| RooF Structure      | 03 | Gable/Hip      |                                 |    |             |
| RooF Cover          | 03 | Asph/F Gls/Cmp |                                 |    |             |
| Interior Wall 1     | 05 | Drywall        |                                 |    |             |
| Interior Wall 2     |    |                |                                 |    |             |
| Interior Floor 1    | 12 | Hardwood       |                                 |    |             |
| Interior Floor 2    |    |                |                                 |    |             |
| Heat Fuel           | 03 | Gas            |                                 |    |             |
| Heat Type           | 04 | Hot Air        |                                 |    |             |
| AC Type             | 03 | Central        |                                 |    |             |
| Bedrooms            | 03 | 3 Bedrooms     |                                 |    |             |
| Full Baths          | 1  |                |                                 |    |             |
| Half Baths          | 0  |                |                                 |    |             |
| Extra Fixtures      |    |                |                                 |    |             |
| Total Rooms         | 7  | 7 Rooms        |                                 |    |             |
| Bath Style          |    |                |                                 |    |             |
| Kitchen Style       |    |                |                                 |    |             |
| Occupancy           |    |                |                                 |    |             |
| Usrflid 105         |    |                |                                 |    |             |
| Accessory Apt       |    |                |                                 |    |             |
| Foundation Alt      | 01 | Poured Conc.   |                                 |    |             |
| Rms Prts            |    |                |                                 |    |             |
| Bath Split          | 10 | 1 Full-0 Half  |                                 |    |             |

| CONDO DATA  |      |             |         |     |
|-------------|------|-------------|---------|-----|
| Parcel Id   |      | C           | Owne    | 0.0 |
| Adjust Type | Code | Description | Factor% |     |
| Condo Flr   |      |             |         |     |
| Condo Unit  |      |             |         |     |

| COST / MARKET VALUATION  |         |
|--------------------------|---------|
| Building Value New       | 423,851 |
| Year Built               | 1969    |
| Effective Year Built     | 1995    |
| Depreciation Code        | G       |
| Remodel Rating           |         |
| Year Remodeled           |         |
| Depreciation %           | 19      |
| Functional Obsol         | 0       |
| External Obsol           | 0       |
| Trend Factor             | 1       |
| Condition                |         |
| Condition %              |         |
| Percent Good             | 81      |
| RCNLD                    | 343,300 |
| Dep % Ovr                |         |
| Dep Ovr Comment          |         |
| Misc Imp Ovr             |         |
| Misc Imp Ovr Comment     |         |
| Cost to Cure Ovr         |         |
| Cost to Cure Ovr Comment |         |

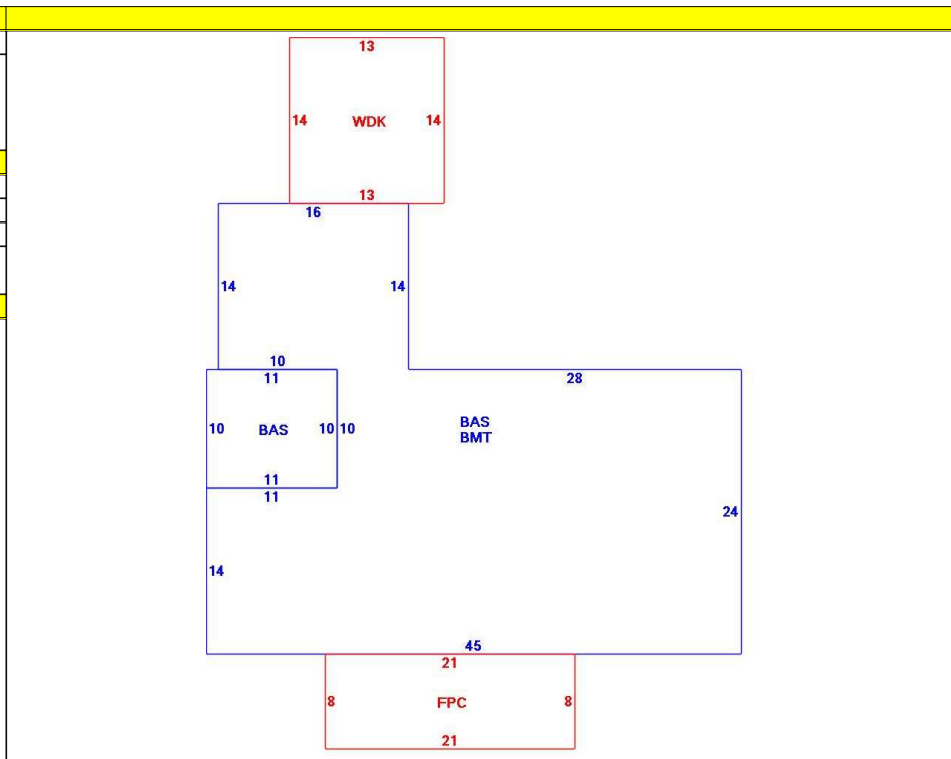

| OB - OUTBUILDING & YARD ITEMS(L) / XF - BUILDING EXTRA FEATURES(B) |                 |     |       |            |        |          |      |       |            |             |
|--|-----------------|-----|-------|------------|--------|----------|------|-------|------------|-------------|
| Code   | Description     | L/B | Units | Unit Price | Yr Blt | Cond. Cd | % Gd | Grade | Grade Adj. | Appr. Value |
| FPL1   | Fireplace 1 sto | B   | 1     | 5000.00    | 1997   |          | 81   |       | 0.00       | 4,100       |
| FGR6   | Gar w/Lft Avg   | L   | 528   | 60.00      | 1988   |          | 69   | C+    | 1.10       | 24,000      |
| WDC  | Wood Deck w/    | L   | 182   | 18.00      | 1999   |          | 60   |       | 0.00       | 2,400       |
| FOPC   | Open Prch-roo   | B   | 168   | 55.00      | 1997   |          | 81   |       | 0.00       | 5,400       |
| BMT  | Basement-Unfi   | B   | 1,194 | 26.01      | 1997   |          | 81   |       | 0.00       | 24,100      |

| BUILDING SUB-AREA SUMMARY SECTION |                        |             |            |          |           |                |
|-----------------------------------|------------------------|-------------|------------|----------|-----------|----------------|
| Code                              | Description            | Living Area | Floor Area | Eff Area | Unit Cost | Undeprec Value |
| BAS                               | First Floor            | 1,304       | 1,304      | 1,304    | 325.04    | 423,851        |
| BMT                               | Basement Area          | 0           | 1,194      | 0        | 0.00      | 0              |
| FPC                               | Open Porch Conc. Floor | 0           | 168        | 0        | 0.00      | 0              |
| WDK                               | Wood Deck              | 0           | 182        | 0        | 0.00      | 0              |
| Ttl Gross Liv / Lease Area        |                        | 1,304       | 2,848      | 1,304    |           | 423,851        |

