

| CURRENT OWNER | | TOPO | UTILITIES | STRT / ROAD | LOCATION | CURRENT ASSESSMENT | | | |
|--|--|---------------------|----------------|------------------|----------|--------------------|------|----------|----------|
| DIMATTIA, PAUL J & KAREN M 9248 GYPSUM WAY NAPLES FL 34120 | | 1 Level | 2 Public Water | 1 Paved | | Description | Code | Assessed | Assessed |
| | | | 4 Gas | | | RESIDNTL | 1010 | 304,300 | 304,300 |
| | | | 6 Septic | | | RES LAND | 1010 | 164,700 | 164,700 |
| SUPPLEMENTAL DATA | | | | | | Total | | | |
| Alt Prcl ID | | Split Zonin RD-1;RC | | Plan Ref. 122/89 | | 469,000 | | | |
| BID Parcel | | | | Land Ct# | | 469,000 | | | |
| ResExpt Q | | | | #SR | | | | | |
| #DL 1 LOT 52 | | | | Life Estate | | | | | |
| #DL 2 | | | | PP STATU | | | | | |
| GIS ID F_973238_2703222 | | | | Assoc Pid# | | | | | |

801
 FY2024
 BARNSTABLE, MA
VISION

| RECORD OF OWNERSHIP | | BK-VOL/PAGE | SALE DATE | Q/U | V/I | SALE PRIC | VC | PREVIOUS ASSESSMENTS (HISTORY) | | | | | | | | |
|------------------------------|--|-------------|------------|-----|-----|-----------|----|--------------------------------|------|----------|------|---------|----------|-------|--|---------|
| DIMATTIA, PAUL J & KAREN M | | 8311 0095 | 11-15-1992 | U | I | 1 | 1F | Year | Code | Assessed | Year | Code | Assessed | | | |
| DIMATTIA, PAUL J & K M & P E | | 5426 0134 | 12-15-1986 | U | I | 1 | A | 2023 | 1010 | 267,200 | 2022 | 1010 | 232,900 | | | |
| DIMATTIA, PAUL J | | 4510 0005 | 04-30-1985 | U | | 0 | | | 1010 | 162,700 | 2021 | 1010 | 115,700 | | | |
| GAGLIARD, FRANCES A | | 2552 0336 | 07-25-1977 | U | | 0 | | | | | | 1010 | 2,200 | | | |
| Total | | | | | | | | 429,900 | | Total | | 348,600 | | Total | | 308,800 |

| EXEMPTIONS | | | OTHER ASSESSMENTS | | | | | |
|------------|------|-------------|-------------------|------|-------------|--------|--------|----------|
| Year | Code | Description | Amount | Code | Description | Number | Amount | Comm Int |
| Total | | | 0.00 | | | | | |

This signature acknowledges a visit by a Data Collector or Assessor

| ASSESSING NEIGHBORHOOD | | | |
|------------------------|-----------|---|---------|
| Nbhd | Nbhd Name | B | Tracing |
| 0106 | | | CENVIL |

| NOTES | | | | | | | | | | | | | | |
|-------|--|--|--|--|--|--|--|--|--|--|--|--|--|--|
| | | | | | | | | | | | | | | |

| APPRAISED VALUE SUMMARY | |
|-------------------------------|---------|
| Appraised Bldg. Value (Card) | 252,800 |
| Appraised Xf (B) Value (Bldg) | 49,200 |
| Appraised Ob (B) Value (Bldg) | 2,300 |
| Appraised Land Value (Bldg) | 164,700 |
| Special Land Value | 0 |
| Total Appraised Parcel Value | 469,000 |
| Valuation Method | C |
| Total Appraised Parcel Value | 469,000 |

| BUILDING PERMIT RECORD | | | | | | | | | | VISIT / CHANGE HISTORY | | | | | |
|------------------------|------------|------|----------------|--------|------------|--------|------------|-------------------------------|--|------------------------|----|------|----|----|----------------------------|
| Permit Id | Issue Date | Type | Description | Amount | Insp Date | % Comp | Date Comp | Comments | | Date | Id | Type | Is | Cd | Purpost/Result |
| 16-335 | 02-16-2016 | 835 | Sid/Wind/Roof/ | 20,000 | 06-30-2016 | 100 | 06-30-2016 | reside & replace 7 windows an | | 03-30-2021 | SR | 02 | | 03 | Cycl Insp Comp |
| 201505205 | 09-01-2015 | IN | Insulation | 1,400 | 06-30-2016 | 100 | 06-30-2016 | INSULATION/WEATHERIZATI | | 02-02-2021 | CK | 22 | | 22 | Change of Address |
| 201408918 | 01-12-2015 | RE | Remodel | 18,000 | | | | RENOVATE EXISTING BATH | | 04-16-2020 | WD | | | FR | Field Review |
| 32338 | 07-27-1998 | WD | Wood Deck | 2,000 | 01-01-1999 | 100 | 12-31-1999 | | | 01-15-2019 | TR | 03 | | 16 | In Office Review |
| | | | | | | | | | | 09-28-2009 | PT | 02 | | 14 | Cyclical Inspection |
| | | | | | | | | | | 12-07-2000 | PT | 01 | | 00 | Meas/Listed-Interior Acces |
| | | | | | | | | | | 07-07-1999 | GB | 02 | | 02 | Bldg Permit Completed |

| LAND LINE VALUATION SECTION | | | | | | | | | | | | | | | | | | |
|-----------------------------|----------|----------------|------|----|------------|------------|------------|---------|------------|-------|-------|-----------|-------|--|--------------------|------------|------------|---------|
| B | Use Code | Description | Zone | LA | Land Units | Unit Price | Size Adj | AC Disc | Site Index | Cond. | Nbhd. | Nbhd. Adj | Notes | | Location Adjustmen | Adj Unit P | Land Value | |
| 1 | 1010 | Single Fam M-0 | SPLI | 3 | 0.200 | AC | 176,344.00 | 4.05999 | 1.0000 | 5 | 1.00 | 0106 | 1.150 | | | 1.0000 | 823,350.1 | 164,700 |

| CONSTRUCTION DETAIL | | | CONSTRUCTION DETAIL (CONTINUED) | | |
|---------------------|----|----------------|---------------------------------|----|-------------|
| Element | Cd | Description | Element | Cd | Description |
| Style | 01 | Ranch | | | |
| Model | 01 | Residential | | | |
| Grade: | C | Average | | | |
| Stories | 1 | 1 Story | | | |
| Exterior Wall 1 | 14 | Wood Shingle | | | |
| Exterior Wall 2 | | | | | |
| RooF Structure | 03 | Gable/Hip | | | |
| RooF Cover | 03 | Asph/F Gls/Cmp | | | |
| Interior Wall 1 | 05 | Drywall | | | |
| Interior Wall 2 | | | | | |
| Interior Floor 1 | 12 | Hardwood | | | |
| Interior Floor 2 | 14 | Carpet | | | |
| Heat Fuel | 03 | Gas | | | |
| Heat Type | 04 | Hot Air | | | |
| AC Type | 01 | None | | | |
| Bedrooms | 02 | 2 Bedrooms | | | |
| Full Baths | 1 | | | | |
| Half Baths | 0 | | | | |
| Extra Fixtures | | | | | |
| Total Rooms | 4 | 4 Rooms | | | |
| Bath Style | | | | | |
| Kitchen Style | | | | | |
| Occupancy | | | | | |
| Usrflid 105 | | | | | |
| Accessory Apt | | | | | |
| Foundation Alt | 01 | Poured Conc. | | | |
| Rms Prts | | | | | |
| Bath Split | 10 | 1 Full-0 Half | | | |

| CONDO DATA | | | |
|-------------|------|-------------|---------|
| Parcel Id | C | B | S |
| Adjust Type | Code | Description | Factor% |
| | | | |
| Condo Flr | | | |
| Condo Unit | | | |

| COST / MARKET VALUATION | |
|--------------------------|---------|
| Building Value New | 293,901 |
| Year Built | 1971 |
| Effective Year Built | 2001 |
| Depreciation Code | VG |
| Remodel Rating | |
| Year Remodeled | |
| Depreciation % | 14 |
| Functional Obsol | 0 |
| External Obsol | 0 |
| Trend Factor | 1 |
| Condition | |
| Condition % | |
| Percent Good | 86 |
| RCNLD | 252,800 |
| Dep % Ovr | |
| Dep Ovr Comment | |
| Misc Imp Ovr | |
| Misc Imp Ovr Comment | |
| Cost to Cure Ovr | |
| Cost to Cure Ovr Comment | |

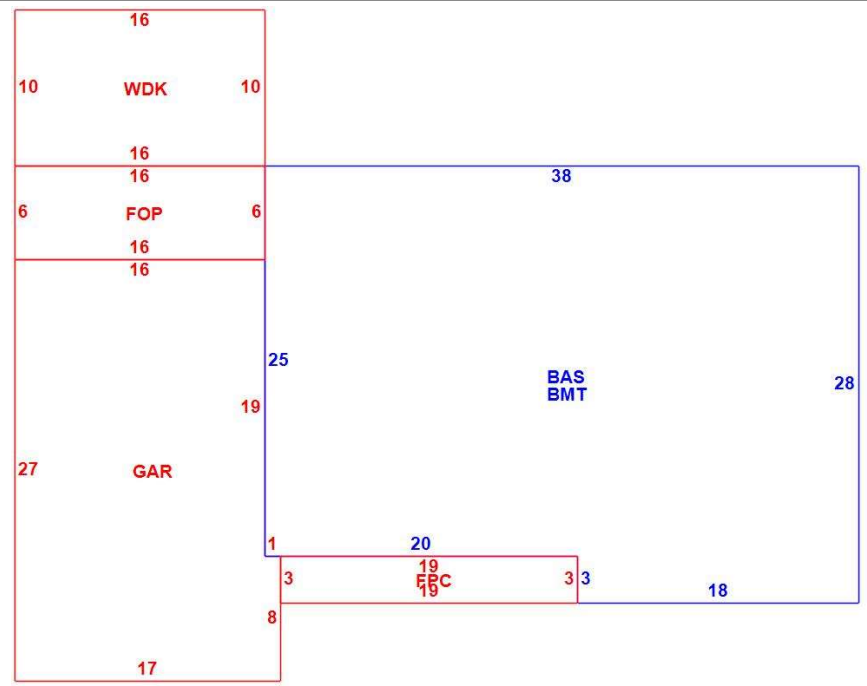

| OB - OUTBUILDING & YARD ITEMS(L) / XF - BUILDING EXTRA FEATURES(B) | | | | | | | | | | |
|--|-----------------|-----|-------|------------|--------|----------|------|-------|------------|-------------|
| Code | Description | L/B | Units | Unit Price | Yr Blt | Cond. Cd | % Gd | Grade | Grade Adj. | Appr. Value |
| FPL1 | Fireplace 1 sto | B | 1 | 5000.00 | 2003 | | 86 | | 0.00 | 4,300 |
| WDC | Wood Decking | L | 160 | 20.00 | 1996 | | 54 | | 0.00 | 2,300 |
| FOP | Open Porch-ro | B | 96 | 55.00 | 2003 | | 86 | | 0.00 | 4,600 |
| GAR | Attached Gara | B | 440 | 40.00 | 2003 | | 86 | | 0.00 | 14,700 |
| BMT | Basement-Unfi | B | 1,004 | 26.01 | 2003 | | 86 | | 0.00 | 22,900 |
| FOPC | Open Prch-roo | B | 57 | 55.00 | 2003 | | 86 | | 0.00 | 2,700 |

| BUILDING SUB-AREA SUMMARY SECTION | | | | | | |
|-----------------------------------|------------------------|-------------|------------|----------|-----------|----------------|
| Code | Description | Living Area | Floor Area | Eff Area | Unit Cost | Undeprec Value |
| BAS | First Floor | 1,004 | 1,004 | 1,004 | 292.73 | 293,901 |
| BMT | Basement Area | 0 | 1,004 | 0 | 0.00 | 0 |
| FOP | Open Porch | 0 | 96 | 0 | 0.00 | 0 |
| FPC | Open Porch Conc. Floor | 0 | 57 | 0 | 0.00 | 0 |
| GAR | Attached Garage | 0 | 440 | 0 | 0.00 | 0 |
| WDK | Wood Deck | 0 | 160 | 0 | 0.00 | 0 |
| Ttl Gross Liv / Lease Area | | 1,004 | 2,761 | 1,004 | | 293,901 |

