

| CURRENT OWNER   |            | TOPO           |               | UTILITIES         |            | STRT / ROAD   |                        | LOCATION  |            | CURRENT ASSESSMENT     |       |                                      |                  | 801<br>FY2024<br>BARNSTABLE, MA<br><br><b>VISION</b> |                            |                      |              |                    |                    |
|---|------------|----------------|---------------|-------------------|------------|---------------|------------------------|---|------------|------------------------|-------|--------------------------------------|------------------|--|----------------------------|----------------------|--------------|--------------------|--------------------|
| CURTIS, JOSEPH G<br><br>PO BOX 152<br><br>COTUIT MA 02635 |            | 1              | Level         | 4                 | Gas        | 3             | Unpaved                |   |            | Description            | Code  | Assessed                             | Assessed         |  |                            | RESIDNTL<br>RES LAND | 1010<br>1010 | 258,200<br>178,400 | 258,200<br>178,400 |
|   |            |                |               | 5                 | Well       |               |                        |   |            |                        |       |                                      |                  |  |                            |                      |              |                    |                    |
|   |            |                |               | 6                 | Septic     |               |                        |   |            |                        |       |                                      |                  |  |                            |                      |              |                    |                    |
| <b>SUPPLEMENTAL DATA</b>                                  |            |                |               |                   |            |               |                        |   |            | Total                  |       |                                      |                  | 436,600  | 436,600                    |                      |              |                    |                    |
| Alt Prcl ID   |            | Split Zonin    |               | Plan Ref. 348/98  |            | Land Ct#      |                        |   |            |                        |       |                                      |                  |  |                            |                      |              |                    |                    |
| BID Parcel  |            | ResExpt Q      |               | #SR               |            | Life Estate   |                        | PP STATU  |            |                        |       |                                      |                  |  |                            |                      |              |                    |                    |
| #DL 1 LOT 1   |            | #DL 2          |               | Assoc Pid#        |            |               |                        |   |            |                        |       |                                      |                  |  |                            |                      |              |                    |                    |
| GIS ID F_943684_2701043                                   |            |                |               |                   |            |               |                        |   |            |                        |       |                                      |                  |  |                            |                      |              |                    |                    |
| RECORD OF OWNERSHIP                                       |            |                |               | BK-VOL/PAGE       |            | SALE DATE     |                        | Q/U V/I   |            | SALE PRIC              |       | VC                                   |                  | PREVIOUS ASSESSMENTS (HISTORY)                       |                            |                      |              |                    |                    |
| CURTIS, JOSEPH G  |            |                |               | 5157              | 0010       | 06-25-1986    | U                      | I   | 1          | A                      | Year  | Code                                 | Assessed         | Year   | Code                       | Assessed             | Year         | Code               | Assessed           |
| CURTIS, JOSEPH G  |            |                |               | 1939              | 0247       | 09-25-1973    | U                      |   | 0          |                        | 2023  | 1010                                 | 221,400          | 2022   | 1010                       | 190,300              | 2021         | 1010               | 153,400            |
|   |            |                |               |                   |            |               |                        |   |            |                        | 1010  | 162,400                              |                  | 1010   | 120,900                    |                      | 1010         | 120,900            |                    |
|   |            |                |               |                   |            |               |                        |   |            |                        |       |                                      |                  |  |                            |                      | 1010         | 2,200              |                    |
|   |            |                |               |                   |            |               |                        |   |            | Total                  |       | 383,800                              | Total            |  | 311,200                    | Total                |              | 276,500            |                    |
| EXEMPTIONS  |            |                |               | OTHER ASSESSMENTS |            |               |                        | This signature acknowledges a visit by a Data Collector or Assessor |            |                        |       |                                      |                  |  |                            |                      |              |                    |                    |
| Year  | Code       | Description    |               | Amount            |            | Code          | Description            | Number  | Amount     | Comm Int               |       |                                      |                  |  |                            |                      |              |                    |                    |
|   |            |                |               |                   |            |               |                        |   |            |                        |       |                                      |                  |  |                            |                      |              |                    |                    |
| Total   |            |                |               | 0.00              |            |               |                        |   |            |                        |       | <b>APPRAISED VALUE SUMMARY</b>       |                  |  |                            |                      |              |                    |                    |
|   |            |                |               |                   |            |               |                        |   |            |                        |       | Appraised Bldg. Value (Card) 231,600 |                  |  |                            |                      |              |                    |                    |
|   |            |                |               |                   |            |               |                        |   |            |                        |       | Appraised Xf (B) Value (Bldg) 24,400 |                  |  |                            |                      |              |                    |                    |
|   |            |                |               |                   |            |               |                        |   |            |                        |       | Appraised Ob (B) Value (Bldg) 2,200  |                  |  |                            |                      |              |                    |                    |
|   |            |                |               |                   |            |               |                        |   |            |                        |       | Appraised Land Value (Bldg) 178,400  |                  |  |                            |                      |              |                    |                    |
|   |            |                |               |                   |            |               |                        |   |            |                        |       | Special Land Value 0                 |                  |  |                            |                      |              |                    |                    |
|   |            |                |               |                   |            |               |                        |   |            |                        |       | Total Appraised Parcel Value 436,600 |                  |  |                            |                      |              |                    |                    |
|   |            |                |               |                   |            |               |                        |   |            |                        |       | Valuation Method C                   |                  |  |                            |                      |              |                    |                    |
|   |            |                |               |                   |            |               |                        |   |            |                        |       | Total Appraised Parcel Value 436,600 |                  |  |                            |                      |              |                    |                    |
| BUILDING PERMIT RECORD                                    |            |                |               |                   |            |               |                        |   |            | VISIT / CHANGE HISTORY |       |                                      |                  |  |                            |                      |              |                    |                    |
| Permit Id   | Issue Date | Type           | Description   | Amount            | Insp Date  | % Comp        | Date Comp              | Comments  |            | Date                   | Id    | Type                                 | Is               | Cd   | Purpost/Result             |                      |              |                    |                    |
| B30964  | 07-01-1987 | SP             | Swimming Pool | 9,000             | 01-15-1991 | 100           |                        | CO SW.POO   |            | 05-21-2020             | LS    |                                      |                  | FR   | Field Review               |                      |              |                    |                    |
| B22692  | 11-01-1980 | DW             | Dwelling      | 0                 | 01-15-1981 | 100           | 12-31-1981             | CO 1 1/2S   |            | 06-25-2014             | TR    | 03                                   |                  | 16   | In Office Review           |                      |              |                    |                    |
|   |            |                |               |                   |            |               |                        |   |            | 03-05-2014             | TP    | 03                                   |                  | 16   | In Office Review           |                      |              |                    |                    |
|   |            |                |               |                   |            |               |                        |   |            | 01-30-2013             | SR    | 02                                   |                  | 14   | Cyclical Inspection        |                      |              |                    |                    |
|   |            |                |               |                   |            |               |                        |   |            | 04-26-2005             | PT    | 04                                   |                  | 44   | Drive by inspection only   |                      |              |                    |                    |
|   |            |                |               |                   |            |               |                        |   |            | 06-27-2002             | PT    | 01                                   |                  | 00   | Meas/Listed-Interior Acces |                      |              |                    |                    |
|   |            |                |               |                   |            |               |                        |   |            | 01-15-1988             | ME    | 02                                   |                  | 01   | Meas/Est                   |                      |              |                    |                    |
| LAND LINE VALUATION SECTION                               |            |                |               |                   |            |               |                        |   |            |                        |       |                                      |                  |  |                            |                      |              |                    |                    |
| B   | Use Code   | Description    | Zone          | LA                | Land Units | Unit Price    | Size Adj               | AC Disc   | Site Index | Cond.                  | Nbhd. | Nbhd. Adj                            | Notes            |  | Location Adjustmen         |                      | Adj Unit P   | Land Value         |                    |
| 1   | 1010       | Single Fam M-0 | RF            | 2                 | 1.000      | AC 176,344.00 | 1.00000                | 1.0000  | 5          | 1.00                   | 0105  | 1.000                                |                  |  | 1.0000                     | 176,344              | 176,300      |                    |                    |
| 1   | 1010       | Single Fam M-0 | RF            | 2                 | 0.150      | AC 14,250.00  | 1.00000                | 1.0000  | 0          | 1.00                   | 0105  | 1.000                                |                  |  | 1.0000                     | 14,250               | 2,100        |                    |                    |
| Total Card Land Units                                     |            |                |               |                   | 1.15       | AC            | Parcel Total Land Area |   |            |                        |       | 1.15                                 | Total Land Value |  |                            |                      |              | 178,400            |                    |

| CONSTRUCTION DETAIL |    |                | CONSTRUCTION DETAIL (CONTINUED) |    |             |
|---------------------|----|----------------|---------------------------------|----|-------------|
| Element             | Cd | Description    | Element                         | Cd | Description |
| Style               | 01 | Ranch          |                                 |    |             |
| Model               | 01 | Residential    |                                 |    |             |
| Grade:              | C  | Average        |                                 |    |             |
| Stories             | 1  | 1 Story        |                                 |    |             |
| Exterior Wall 1     | 14 | Wood Shingle   |                                 |    |             |
| Exterior Wall 2     |    |                |                                 |    |             |
| RooF Structure      | 03 | Gable/Hip      |                                 |    |             |
| RooF Cover          | 03 | Asph/F Gls/Cmp |                                 |    |             |
| Interior Wall 1     | 05 | Drywall        |                                 |    |             |
| Interior Wall 2     |    |                |                                 |    |             |
| Interior Floor 1    | 12 | Hardwood       |                                 |    |             |
| Interior Floor 2    | 14 | Carpet         |                                 |    |             |
| Heat Fuel           | 02 | Oil            |                                 |    |             |
| Heat Type           | 05 | Hot Water      |                                 |    |             |
| AC Type             | 01 | None           |                                 |    |             |
| Bedrooms            | 02 | 2 Bedrooms     |                                 |    |             |
| Full Baths          | 1  |                |                                 |    |             |
| Half Baths          | 0  |                |                                 |    |             |
| Extra Fixtures      |    |                |                                 |    |             |
| Total Rooms         | 4  | 4 Rooms        |                                 |    |             |
| Bath Style          |    |                |                                 |    |             |
| Kitchen Style       |    |                |                                 |    |             |
| Occupancy           |    |                |                                 |    |             |
| Usrflid 105         |    |                |                                 |    |             |
| Accessory Apt       |    |                |                                 |    |             |
| Foundation Alt      | 00 | Typical        |                                 |    |             |
| Rms Prts            |    |                |                                 |    |             |
| Bath Split          | 10 | 1 Full-0 Half  |                                 |    |             |

| CONDO DATA  |      |             |          |
|-------------|------|-------------|----------|
| Parcel Id   |      | C           | Ownr 0.0 |
|             |      | B           | S        |
| Adjust Type | Code | Description | Factor%  |
| Condo Flr   |      |             |          |
| Condo Unit  |      |             |          |

| COST / MARKET VALUATION  |         |
|--------------------------|---------|
| Building Value New       | 313,016 |
| Year Built               | 1968    |
| Effective Year Built     | 1985    |
| Depreciation Code        | F       |
| Remodel Rating           |         |
| Year Remodeled           |         |
| Depreciation %           | 26      |
| Functional Obsol         | 0       |
| External Obsol           | 0       |
| Trend Factor             | 1       |
| Condition                |         |
| Condition %              |         |
| Percent Good             | 74      |
| RCNLD                    | 231,600 |
| Dep % Ovr                |         |
| Dep Ovr Comment          |         |
| Misc Imp Ovr             |         |
| Misc Imp Ovr Comment     |         |
| Cost to Cure Ovr         |         |
| Cost to Cure Ovr Comment |         |

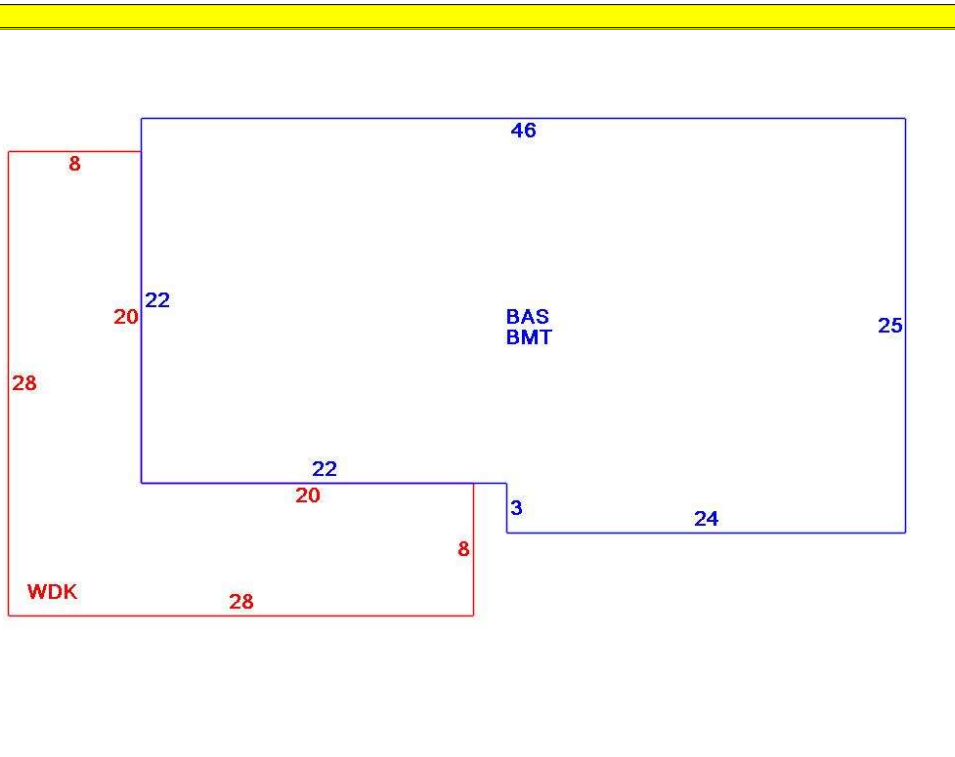

**OB - OUTBUILDING & YARD ITEMS(L) / XF - BUILDING EXTRA FEATURES(B)**

| Code | Description     | L/B | Units | Unit Price | Yr Blt | Cond. Cd | % Gd | Grade | Grade Adj. | Appr. Value |
|------|-----------------|-----|-------|------------|--------|----------|------|-------|------------|-------------|
| BMT  | Basement-Unfi   | B   | 1,084 | 26.01      | 1987   |          | 74   |       | 0.00       | 20,700      |
| FPL1 | Fireplace 1 sto | B   | 1     | 5000.00    | 1987   |          | 74   |       | 0.00       | 3,700       |
| WDC  | Wood Decking    | L   | 384   | 20.00      | 1984   |          | 30   |       | 0.00       | 2,200       |

**BUILDING SUB-AREA SUMMARY SECTION**

| Code                       | Description   | Living Area | Floor Area | Eff Area | Unit Cost | Undeprec Value |
|----------------------------|---------------|-------------|------------|----------|-----------|----------------|
| BAS                        | First Floor   | 1,084       | 1,084      | 1,084    | 288.76    | 313,016        |
| BMT                        | Basement Area | 0           | 1,084      | 0        | 0.00      | 0              |
| WDC                        | Wood Deck     | 0           | 384        | 0        | 0.00      | 0              |
| Ttl Gross Liv / Lease Area |               | 1,084       | 2,552      | 1,084    |           | 313,016        |

