

| CURRENT OWNER | | TOPO | UTILITIES | STRT / ROAD | LOCATION | CURRENT ASSESSMENT | | | | 801 FY2024 BARNSTABLE, MA VISION | |
|--|--|---------|----------------|---|--------------|--------------------|------|----------|----------|--|-----------|
| TINKER, LYNN M TR LYNN M TINKER REAL ESTATE TRUS 21 CASSWAY ROAD WOODBIDGE CT 06252 | | 1 Level | 2 Public Water | 1 Paved | 1 Excel View | Description | Code | Assessed | Assessed | | |
| | | | 4 Gas | | | RESIDENTL | 1010 | 566,300 | 566,300 | | |
| | | | 6 Septic | | | RES LAND | 1010 | 478,300 | 478,300 | | |
| SUPPLEMENTAL DATA | | | | | | Total | | | | 1,044,600 | 1,044,600 |
| Alt Prcl ID Split Zonin BID Parcel ResExpt Q NO APP: #DL 1 LOT B #DL 2 GIS ID F_973457_2710915 | | | | Plan Ref. 395/28 Land Ct# #SR Life Estate PP STATU A:Active Assoc Pid# | | | | | | | |

| RECORD OF OWNERSHIP | | BK-VOL/PAGE | SALE DATE | Q/U | V/I | SALE PRIC | VC | PREVIOUS ASSESSMENTS (HISTORY) | | | | | |
|-----------------------|--|-------------|------------|-----|-----|-----------|----|--------------------------------|-------|----------|-------|---------|----------|
| TINKER, LYNN M TR | | 32254 0025 | 08-28-2019 | Q | I | 695,000 | 00 | Year | Code | Assessed | Year | Code | Assessed |
| KING, PAULA M | | 29139 0123 | 09-15-2015 | Q | I | 682,500 | 00 | 2023 | 1010 | 485,500 | 2022 | 1010 | 358,300 |
| WENTWORTH, PERI | | 22276 0026 | 08-20-2007 | Q | I | 644,500 | 00 | | 1010 | 563,200 | | 1010 | 316,800 |
| EPSTEIN, JEROME S | | 9081 0156 | 03-15-1994 | Q | I | 212,000 | 00 | | | | | 1010 | 10,600 |
| GROSSMAN, MORTON S TR | | 9081 0155 | 03-15-1994 | U | I | 1 | 1F | | | | | | |
| Total | | | | | | | | 1,048,700 | Total | 675,100 | Total | 664,300 | |

| EXEMPTIONS | | | | OTHER ASSESSMENTS | | | | This signature acknowledges a visit by a Data Collector or Assessor | | | | |
|------------|------|--------------------------|--------|-------------------|-------------|--------|--------|---|--|--|--|--|
| Year | Code | Description | Amount | Code | Description | Number | Amount | Comm Int | | | | |
| 2021 | N5C | NO RESIDENTIAL EXEMPTION | 0.00 | | | | | | | | | |
| Total | | | 0.00 | | | | | | | | | |

| ASSESSING NEIGHBORHOOD | | | | APPRAISED VALUE SUMMARY | | | | |
|------------------------|-----------|---|---------|--|--|--|--|--|
| Nbhd | Nbhd Name | B | Tracing | Batch | | | | |
| 0110 | | | | CENVIL | | | | |
| NOTES | | | | Appraised Bldg. Value (Card) 531,400 | | | | |
| | | | | Appraised Xf (B) Value (Bldg) 23,700 | | | | |
| | | | | Appraised Ob (B) Value (Bldg) 11,200 | | | | |
| | | | | Appraised Land Value (Bldg) 478,300 | | | | |
| | | | | Special Land Value 0 | | | | |
| | | | | Total Appraised Parcel Value 1,044,600 | | | | |
| | | | | Valuation Method C | | | | |
| | | | | Total Appraised Parcel Value 1,044,600 | | | | |

| BUILDING PERMIT RECORD | | | | | | | | | VISIT / CHANGE HISTORY | | | | | |
|------------------------|------------|------|--------------|--------|------------|--------|------------|-------------------------|------------------------|-----|------|----|----|--------------------------|
| Permit Id | Issue Date | Type | Description | Amount | Insp Date | % Comp | Date Comp | Comments | Date | Id | Type | Is | Cd | Purpost/Result |
| 201408173 | 11-25-2014 | FP | Fireplace | 800 | 06-30-2016 | 100 | 06-30-2016 | CUT OPENING IN EXISTING | 10-18-2021 | SR | 02 | | 03 | Cycl Insp Comp |
| 200902687 | 07-20-2009 | WD | Wood Deck | 4,000 | 02-01-2010 | 100 | 06-30-2010 | EXTEND WDK | 04-29-2020 | WD | | | FR | Field Review |
| 200801654 | 03-31-2008 | OB | Out Building | 0 | 02-01-2010 | 100 | 06-30-2010 | 10 X 12 SHED | 02-26-2020 | SAF | | | 20 | Sale Review |
| B28373 | 08-01-1985 | RE | Remodel | 20,000 | 01-15-1986 | 100 | | CE ALTER. | 01-23-2020 | CK | 03 | | 16 | In Office Review |
| | | | | | | | | | 06-08-2016 | JR | 03 | | 20 | Sale Review |
| | | | | | | | | | 03-01-2011 | NF | 03 | | 16 | In Office Review |
| | | | | | | | | | 02-18-2010 | PT | 04 | | 44 | Drive by inspection only |

| LAND LINE VALUATION SECTION | | | | | | | | | | | | | | | | |
|-----------------------------|----------|----------------|------|----|------------|------------|------------------------|---------|------------|-------|-------|-----------|-----------------------|--------------------|------------|------------|
| B | Use Code | Description | Zone | LA | Land Units | Unit Price | Size Adj | AC Disc | Site Index | Cond. | Nbhd. | Nbhd. Adj | Notes | Location Adjustmen | Adj Unit P | Land Value |
| 1 | 1010 | Single Fam M-0 | RD- | 3 | 0.490 AC | 176,344.00 | 1.81499 | 1.0000 | 5 | 1.00 | 0111 | 3.050 | DEEDED BEACH RIGHTS T | | 1.0000 | 976,187.4 |
| Total Card Land Units | | | | | 0.49 | AC | Parcel Total Land Area | | | | | 0.49 | Total Land Value | | | 478,300 |

| CONSTRUCTION DETAIL | | | CONSTRUCTION DETAIL (CONTINUED) | | |
|---------------------|----|----------------|--------------------------------------|----|-------------|
| Element | Cd | Description | Element | Cd | Description |
| Style | 03 | Colonial | | | |
| Model | 01 | Residential | | | |
| Grade: | B | Custom | | | |
| Stories | 2 | 2 Stories | | | |
| Exterior Wall 1 | 11 | Clapboard | | | |
| Exterior Wall 2 | | | | | |
| Roof Structure | 03 | Gable/Hip | | | |
| Roof Cover | 03 | Asph/F Gls/Cmp | | | |
| Interior Wall 1 | 03 | Plastered | | | |
| Interior Wall 2 | 05 | Drywall | | | |
| Interior Floor 1 | 14 | Carpet | | | |
| Interior Floor 2 | 12 | Hardwood | | | |
| Heat Fuel | 03 | Gas | | | |
| Heat Type | 04 | Hot Air | | | |
| AC Type | 03 | Central | | | |
| Bedrooms | 03 | 3 Bedrooms | | | |
| Full Baths | 2 | | | | |
| Half Baths | 0 | | | | |
| Extra Fixtures | | | | | |
| Total Rooms | 6 | 6 Rooms | | | |
| Bath Style | | | | | |
| Kitchen Style | | | | | |
| Occupancy | | | | | |
| Usrflid 105 | | | | | |
| Accessory Apt | | | | | |
| Foundation Alt | 01 | Poured Conc. | | | |
| Rms Prts | | | | | |
| Bath Split | 20 | 2 Full-0 Half | | | |
| | | | CONDO DATA | | |
| | | | Parcel Id | C | Owne 0.0 |
| | | | Adjust Type Code Description Factor% | | |
| | | | Condo Flr | | |
| | | | Condo Unit | | |
| | | | COST / MARKET VALUATION | | |
| | | | Building Value New | | 583,969 |
| | | | Year Built | | 1985 |
| | | | Effective Year Built | | 2008 |
| | | | Depreciation Code | | VG |
| | | | Remodel Rating | | |
| | | | Year Remodeled | | |
| | | | Depreciation % | | 9 |
| | | | Functional Obsol | | 0 |
| | | | External Obsol | | 0 |
| | | | Trend Factor | | 1 |
| | | | Condition | | |
| | | | Condition % | | |
| | | | Percent Good | | 91 |
| | | | RCNLD | | 531,400 |
| | | | Dep % Ovr | | |
| | | | Dep Ovr Comment | | |
| | | | Misc Imp Ovr | | |
| | | | Misc Imp Ovr Comment | | |
| | | | Cost to Cure Ovr | | |
| | | | Cost to Cure Ovr Comment | | |

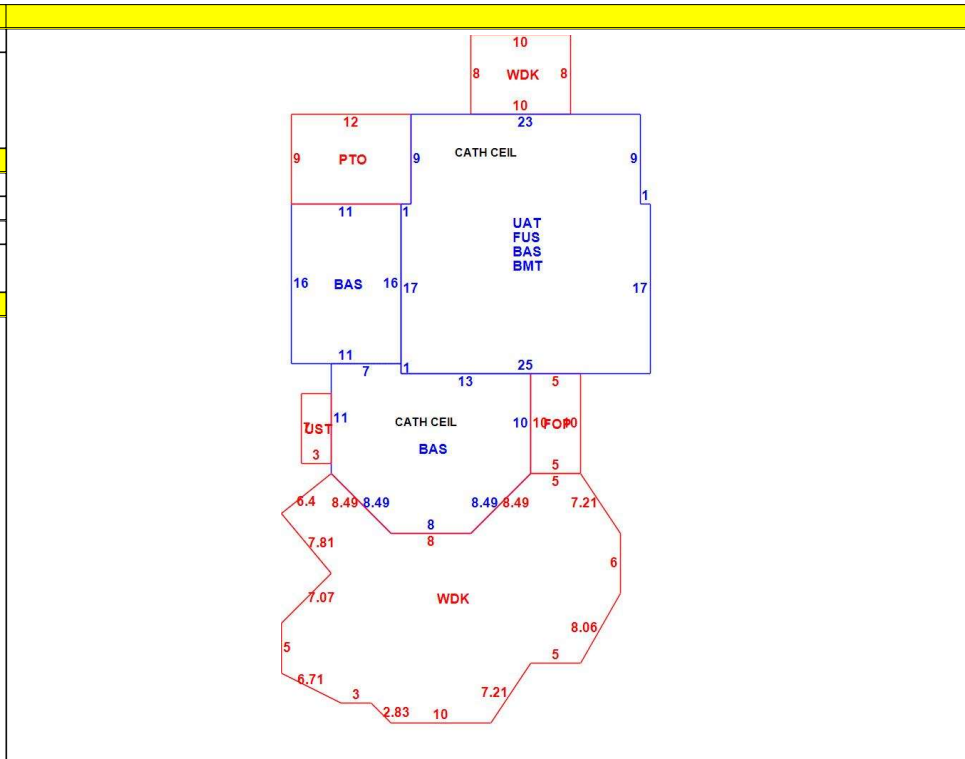

| OB - OUTBUILDING & YARD ITEMS(L) / XF - BUILDING EXTRA FEATURES(B) | | | | | | | | | | |
|--|------------------|-----|-------|------------|--------|----------|------|-------|------------|-------------|
| Code | Description | L/B | Units | Unit Price | Yr Blt | Cond. Cd | % Gd | Grade | Grade Adj. | Appr. Value |
| WDC | Wood Deck w/ | L | 581 | 18.00 | 1999 | | 60 | | 0.00 | 5,800 |
| WDC | Wood Deck w/ | L | 107 | 18.00 | 1999 | | 60 | | 0.00 | 1,900 |
| BMT | Basement-Unfi | B | 632 | 26.01 | 2010 | | 91 | | 0.00 | 18,000 |
| FPLG | Gas Fireplace- | B | 1 | 2500.00 | 2010 | | 91 | | 0.00 | 2,300 |
| SHED | Shed | L | 120 | 18.00 | 2019 | | 100 | | 0.00 | 2,200 |
| FOP | Open Porch-ro | B | 50 | 55.00 | 2010 | | 91 | | 0.00 | 3,000 |
| UST | Utility Storage- | B | 21 | 17.11 | 2010 | | 91 | | 0.00 | 400 |
| PAT2 | Patio-Good | L | 108 | 9.94 | 2021 | | 100 | | 0.00 | 1,300 |

| BUILDING SUB-AREA SUMMARY SECTION | | | | | | |
|-----------------------------------|-------------------|-------------|------------|----------|-----------|----------------|
| Code | Description | Living Area | Floor Area | Eff Area | Unit Cost | Undeprec Value |
| BAS | First Floor | 1,099 | 1,099 | 1,099 | 325.51 | 357,738 |
| BMT | Basement Area | 0 | 632 | 0 | 0.00 | 0 |
| FOP | Open Porch | 0 | 50 | 0 | 0.00 | 0 |
| FUS | Upper Story | 632 | 632 | 632 | 325.51 | 205,724 |
| PTO | Patio | 0 | 108 | 0 | 0.00 | 0 |
| UAT | Attic, Unfinished | 0 | 632 | 63 | 32.45 | 20,507 |
| UST | Utility Enclosure | 0 | 21 | 0 | 0.00 | 0 |
| WDK | Wood Deck | 0 | 688 | 0 | 0.00 | 0 |
| Ttl Gross Liv / Lease Area | | 1,731 | 3,862 | 1,794 | | 583,969 |

