

| CURRENT OWNER | | TOPO | UTILITIES | STRT / ROAD | LOCATION | CURRENT ASSESSMENT | | | |
|---|--|---------|----------------|---|----------|--------------------|------|----------|----------|
| SIVES, MICHAEL J & COURTNEY L 110 CRANBERRY LANE CENTERVILLE MA 02632 | | 1 Level | 2 Public Water | 1 Paved | | Description | Code | Assessed | Assessed |
| | | | 4 Gas | | | RESIDNTL | 1010 | 327,600 | 327,600 |
| | | | 6 Septic | | | RES LAND | 1010 | 157,200 | 157,200 |
| SUPPLEMENTAL DATA | | | | | | Total | | | |
| Alt Prcl ID Split Zonin BID Parcel ResExpt Q YES: #DL 1 LOT 8 #DL 2 GIS ID F_974621_2711635 | | | | Plan Ref. 426/8 Land Ct# #SR Life Estate PP STATU Assoc Pid# | | 484,800 | | | |

801
 FY2024
 BARNSTABLE, MA
VISION

| RECORD OF OWNERSHIP | | BK-VOL/PAGE | SALE DATE | Q/U | V/I | SALE PRIC | VC | PREVIOUS ASSESSMENTS (HISTORY) | | | | | |
|-------------------------------|--|-------------|------------|-----|-----|-----------|----|--------------------------------|------|----------|-------|------|----------|
| SIVES, MICHAEL J & COURTNEY L | | 16470 0321 | 02-27-2003 | U | I | 1 | 1A | Year | Code | Assessed | Year | Code | Assessed |
| SIVES, MICHAEL J | | 11049 0186 | 11-06-1997 | Q | I | 153,750 | 00 | 2023 | 1010 | 291,100 | 2022 | 1010 | 248,100 |
| THOMAS, ADAM A & KELLI E | | 6264 0269 | 05-18-1988 | Q | I | 145,000 | 00 | | 1010 | 142,900 | | 1010 | 105,800 |
| BAYSIDE BUILDING CO INC | | 4990 0190 | 03-31-1986 | Q | I | 300,000 | 00 | Total | | 434,000 | Total | | 353,900 |
| | | | | | | | | Total | | 320,500 | Total | | 320,500 |

| EXEMPTIONS | | | | OTHER ASSESSMENTS | | | |
|------------|------|-----------------------|--------|-------------------|-------------|--------|--------|
| Year | Code | Description | Amount | Code | Description | Number | Amount |
| 2010 | 5C | RESIDENTIAL EXEMPTION | 0.00 | | | | |
| Total | | | 0.00 | | | | |

This signature acknowledges a visit by a Data Collector or Assessor

| ASSESSING NEIGHBORHOOD | | | |
|------------------------|-----------|---|---------|
| Nbhd | Nbhd Name | B | Tracing |
| 0105 | | | BARNS |

| APPRAISED VALUE SUMMARY | |
|-------------------------------|---------|
| Appraised Bldg. Value (Card) | 288,100 |
| Appraised Xf (B) Value (Bldg) | 35,600 |
| Appraised Ob (B) Value (Bldg) | 3,900 |
| Appraised Land Value (Bldg) | 157,200 |
| Special Land Value | 0 |
| Total Appraised Parcel Value | 484,800 |
| Valuation Method | C |
| Total Appraised Parcel Value | 484,800 |

| NOTES | | | | | | | |
|-------|--|--|--|--|--|--|--|
| | | | | | | | |

| BUILDING PERMIT RECORD | | | | | | | | VISIT / CHANGE HISTORY | | | | | | |
|------------------------|--------------------------|-----------|----------------------------|------------------|------------|------------|-----------|---|--|--|--------------------------------------|----|--|--|
| Permit Id | Issue Date | Type | Description | Amount | Insp Date | % Comp | Date Comp | Comments | Date | Id | Type | Is | Cd | Purpost/Result |
| EXPR-23-8 B31707 | 06-20-2023 03-01-1988 | 835 DW | Sid/Wind/Roof/ Dwelling | 1,500 110,000 | 01-15-1989 | 100 100 | | Replace 2 windows , front of h BA 11/2 S | 09-21-2022 08-28-2021 04-30-2020 01-23-2018 02-03-2014 10-22-2012 10-19-2000 | BM CK WD SR JR DR PT | 22 02 02 03 22 01 | | 22 03 FR 03 16 22 00 | Change of Address Cycl Insp Comp Field Review Cycl Insp Comp In Office Review Change of Address Meas/Listed-Interior Acces |

| LAND LINE VALUATION SECTION | | | | | | | | | | | | | | | | | |
|-----------------------------|----------|----------------|------|----|------------|------------------------|----------|---------|------------|-------|-------|------------------|-------|--------------------|------------|------------|---------|
| B | Use Code | Description | Zone | LA | Land Units | Unit Price | Size Adj | AC Disc | Site Index | Cond. | Nbhd. | Nbhd. Adj | Notes | Location Adjustmen | Adj Unit P | Land Value | |
| 1 | 1010 | Single Fam M-0 | RF-1 | 1 | 0.500 AC | 176,344.00 | 1.78240 | 1.0000 | 5 | 1.00 | 0105 | 1.000 | | 1.0000 | 314,315.5 | 157,200 | |
| Total Card Land Units | | | | | 0.50 AC | Parcel Total Land Area | | | | | 0.50 | Total Land Value | | | | | 157,200 |

| CONSTRUCTION DETAIL | | | CONSTRUCTION DETAIL (CONTINUED) | | |
|---------------------|------|----------------|---------------------------------|----|-------------|
| Element | Cd | Description | Element | Cd | Description |
| Style | 04 | Cape Cod | | | |
| Model | 01 | Residential | | | |
| Grade: | C | Average | | | |
| Stories | 1.75 | 1 3/4 Stories | | | |
| Exterior Wall 1 | 14 | Wood Shingle | | | |
| Exterior Wall 2 | 11 | Clapboard | | | |
| RooF Structure | 03 | Gable/Hip | | | |
| RooF Cover | 03 | Asph/F Gls/Cmp | | | |
| Interior Wall 1 | 05 | Drywall | | | |
| Interior Wall 2 | | | | | |
| Interior Floor 1 | 14 | Carpet | | | |
| Interior Floor 2 | 12 | Hardwood | | | |
| Heat Fuel | 03 | Gas | | | |
| Heat Type | 05 | Hot Water | | | |
| AC Type | 01 | None | | | |
| Bedrooms | 03 | 3 Bedrooms | | | |
| Full Baths | 2 | | | | |
| Half Baths | 0 | | | | |
| Extra Fixtures | | | | | |
| Total Rooms | 7 | 7 Rooms | | | |
| Bath Style | | | | | |
| Kitchen Style | | | | | |
| Occupancy | | | | | |
| Usrflid 105 | | | | | |
| Accessory Apt | | | | | |
| Foundation Alt | 01 | Poured Conc. | | | |
| Rms Prts | | | | | |
| Bath Split | 20 | 2 Full-0 Half | | | |

| CONDO DATA | | | |
|-------------|------|-------------|---------|
| Parcel Id | C | Ownr | 0.0 |
| | | | |
| Adjust Type | Code | Description | Factor% |
| Condo Flr | | | |
| Condo Unit | | | |

| COST / MARKET VALUATION | |
|--------------------------|---------|
| Building Value New | 338,912 |
| Year Built | 1988 |
| Effective Year Built | 2000 |
| Depreciation Code | A |
| Remodel Rating | |
| Year Remodeled | |
| Depreciation % | 15 |
| Functional Obsol | 0 |
| External Obsol | 0 |
| Trend Factor | 1 |
| Condition | |
| Condition % | |
| Percent Good | 85 |
| RCNLD | 288,100 |
| Dep % Ovr | |
| Dep Ovr Comment | |
| Misc Imp Ovr | |
| Misc Imp Ovr Comment | |
| Cost to Cure Ovr | |
| Cost to Cure Ovr Comment | |

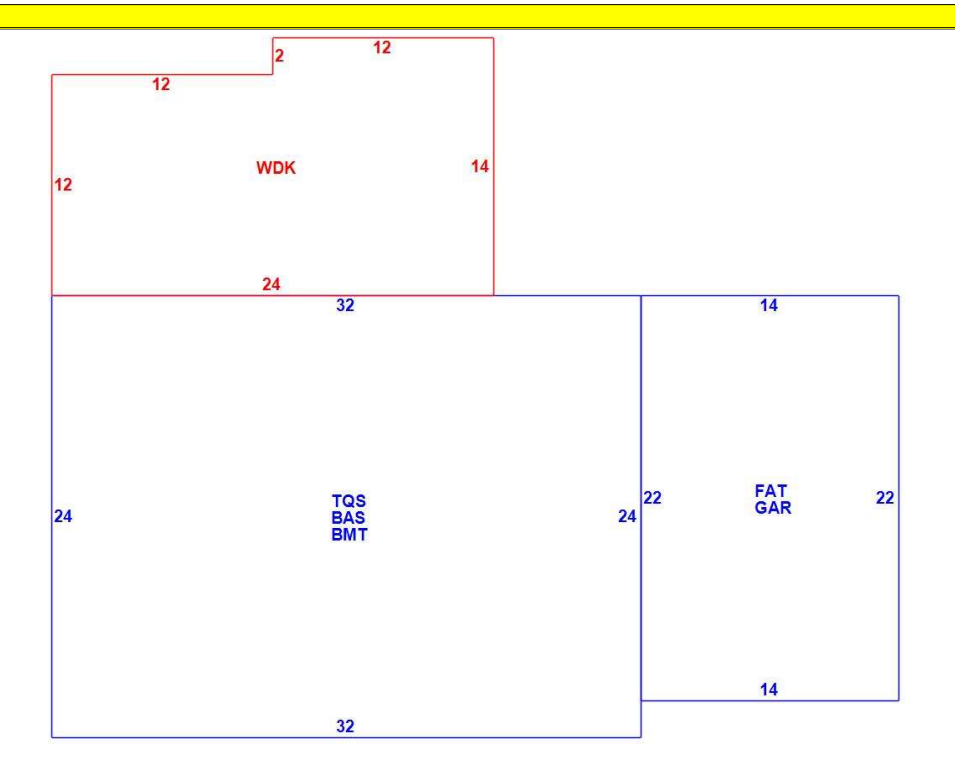

| OB - OUTBUILDING & YARD ITEMS(L) / XF - BUILDING EXTRA FEATURES(B) | | | | | | | | | | |
|--|-----------------|-----|-------|------------|--------|----------|------|-------|------------|-------------|
| Code | Description | L/B | Units | Unit Price | Yr Blt | Cond. Cd | % Gd | Grade | Grade Adj. | Appr. Value |
| FPL2 | Fireplace 1.5 s | B | 1 | 6000.00 | 2002 | | 85 | | 0.00 | 5,100 |
| WDC | Wood Decking | L | 312 | 20.00 | 2000 | | 62 | | 0.00 | 3,900 |
| GAR | Attached Gara | B | 308 | 40.00 | 2002 | | 85 | | 0.00 | 11,600 |
| BMT | Basement-Unfi | B | 768 | 26.01 | 2002 | | 85 | | 0.00 | 18,900 |

| BUILDING SUB-AREA SUMMARY SECTION | | | | | | |
|-----------------------------------|---------------------|-------------|------------|----------|-----------|----------------|
| Code | Description | Living Area | Floor Area | Eff Area | Unit Cost | Undeprec Value |
| BAS | First Floor | 768 | 768 | 768 | 258.12 | 198,236 |
| BMT | Basement Area | 0 | 768 | 0 | 0.00 | 0 |
| FAT | Attic, Finished | 46 | 308 | 46 | 38.55 | 11,874 |
| GAR | Attached Garage | 0 | 308 | 0 | 0.00 | 0 |
| TQS | Three Quarter Story | 499 | 768 | 499 | 167.71 | 128,802 |
| WDC | Wood Deck | 0 | 312 | 0 | 0.00 | 0 |
| Ttl Gross Liv / Lease Area | | 1,313 | 3,232 | 1,313 | | 338,912 |

