

CONSTRUCTION DETAIL			CONSTRUCTION DETAIL (CONTINUED)		
Element	Cd	Description	Element	Cd	Description
Style	04	Cape Cod			
Model	01	Residential			
Grade:	C	Average			
Stories	1.75	1 3/4 Stories			
Exterior Wall 1	25	Vinyl Siding			
Exterior Wall 2					
Roof Structure	03	Gable/Hip			
Roof Cover	03	Asph/F Gls/Cmp			
Interior Wall 1	05	Drywall			
Interior Wall 2					
Interior Floor 1	14	Carpet			
Interior Floor 2	05	Vinyl/Asphalt			
Heat Fuel	02	Oil			
Heat Type	05	Hot Water			
AC Type	01	None			
Bedrooms	03	3 Bedrooms			
Full Baths	1				
Half Baths	1				
Extra Fixtures					
Total Rooms	6	6 Rooms			
Bath Style					
Kitchen Style					
Occupancy					
Usrflid 105					
Accessory Apt					
Foundation Alt	01	Poured Conc.			
Rms Prts					
Bath Split	11	1 Full-1 Half			
			CONDO DATA		
			Parcel Id	C	Ownr 0.0
				B	S
			Adjust Type	Code	Description
			Condo Flr		
			Condo Unit		
			COST / MARKET VALUATION		
			Building Value New		372,515
			Year Built		1977
			Effective Year Built		1994
			Depreciation Code		A
			Remodel Rating		
			Year Remodeled		
			Depreciation %		19
			Functional Obsol		0
			External Obsol		0
			Trend Factor		1
			Condition		
			Condition %		
			Percent Good		81
			RCNLD		301,700
			Dep % Ovr		
			Dep Ovr Comment		
			Misc Imp Ovr		
			Misc Imp Ovr Comment		
			Cost to Cure Ovr		
			Cost to Cure Ovr Comment		

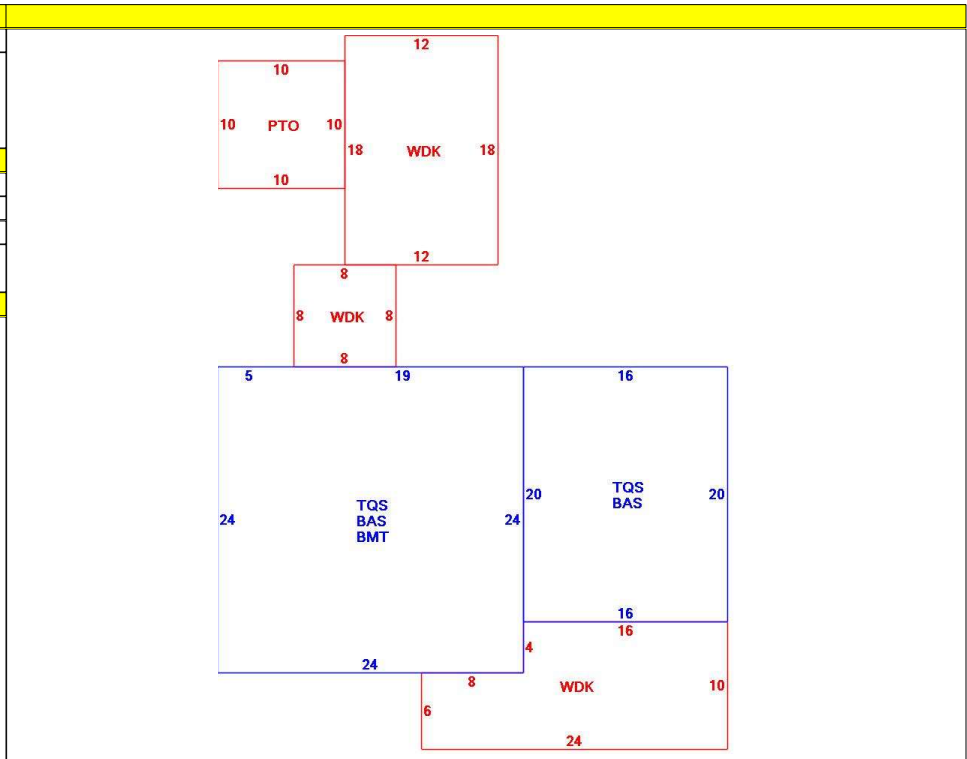

OB - OUTBUILDING & YARD ITEMS(L) / XF - BUILDING EXTRA FEATURES(B)										
Code	Description	L/B	Units	Unit Price	Yr Blt	Cond. Cd	% Gd	Grade	Grade Adj.	Appr. Value
BRR	Bsmt Rec Rm-	B	80	8.05	1996		81		0.00	500
WDC	Wood Decking	L	488	20.00	1997		56		0.00	5,200
PAT1	Patio- Average	L	100	5.89	1997		56		0.00	400
BMT	Basement-Unfi	B	576	26.01	1996		81		0.00	15,100

BUILDING SUB-AREA SUMMARY SECTION						
Code	Description	Living Area	Floor Area	Eff Area	Unit Cost	Undeprec Value
BAS	First Floor	896	896	896	252.04	225,828
BMT	Basement Area	0	576	0	0.00	0
PTO	Patio	0	100	0	0.00	0
TQS	Three Quarter Story	582	896	582	163.71	146,687
WDK	Wood Deck	0	488	0	0.00	0
Ttl Gross Liv / Lease Area		1,478	2,956	1,478		372,515

