

| CURRENT OWNER  |  | TOPO  | UTILITIES      | STRT / ROAD  | LOCATION | CURRENT ASSESSMENT |      |          |          |  |
|--|--|---|----------------|--|----------|--------------------|------|----------|----------|--|
| HYNES, ROBERT E & DOROTHEA F<br>418 STRAWBERRY HILL ROAD REAL<br>C/O ROBERT E & DOROTHEA F HYN<br>89 TACOMA STREET<br>HYDE PARK MA 02136 |  | 1 Level   | 2 Public Water | 1 Paved  |          | Description        | Code | Assessed | Assessed | 801<br>FY2024<br>BARNSTABLE, MA<br><br><h1 style="text-align: center;">VISION</h1> |
|  |  |   | 4 Gas          |  |          | RESIDNTL           | 1010 | 244,200  | 244,200  |  |
|  |  |   | 6 Septic       |  |          | RES LAND           | 1010 | 146,700  | 146,700  |  |
| <b>SUPPLEMENTAL DATA</b>   |  |   |                |  |          | Total              |      |          |          |  |
|  |  | Alt Prcl ID<br>Split Zonin<br>BID Parcel<br>ResExpt Q<br>#DL 1 LOT 68<br>#DL 2<br>GIS ID F_977338_2699812 |                | Plan Ref. 165/41<br>Land Ct#<br>#SR<br>Life Estate<br>PP STATU<br>Assoc Pid# |          |                    |      |          |          |  |
|  |  |   |                |  |          | Total              |      |          |          | 390,900  |

| RECORD OF OWNERSHIP              |  | BK-VOL/PAGE | SALE DATE  | Q/U | V/I | SALE PRIC | VC | PREVIOUS ASSESSMENTS (HISTORY) |      |          |       |      |          |       |      |          |
|----------------------------------|--|-------------|------------|-----|-----|-----------|----|--------------------------------|------|----------|-------|------|----------|-------|------|----------|
| HYNES, ROBERT E & DOROTHEA F TRS |  | 28471 0175  | 10-28-2014 | U   | I   | 100       | 1F | Year                           | Code | Assessed | Year  | Code | Assessed | Year  | Code | Assessed |
| HYNES, ROBERT E & DOROTHEA F TRS |  | 11362 0183  | 04-16-1998 | U   | I   | 10        | 1A | 2023                           | 1010 | 208,200  | 2022  | 1010 | 175,000  | 2021  | 1010 | 137,000  |
| HYNES, ROBERT E & DOROTHEA       |  | 3733 0280   | 05-15-1983 | Q   | I   | 48,000    | U  |                                | 1010 | 133,300  |       | 1010 | 98,800   |       | 1010 | 98,800   |
|                                  |  |             |            |     |     |           |    | Total                          |      | 341,500  | Total |      | 273,800  | Total |      | 236,400  |

| EXEMPTIONS |      |             | OTHER ASSESSMENTS |      |             |        |        |          |
|------------|------|-------------|-------------------|------|-------------|--------|--------|----------|
| Year       | Code | Description | Amount            | Code | Description | Number | Amount | Comm Int |
|            |      |             |                   |      |             |        |        |          |
| Total      |      |             | 0.00              |      |             |        |        |          |

| ASSESSING NEIGHBORHOOD |           |   |         |
|------------------------|-----------|---|---------|
| Nbhd                   | Nbhd Name | B | Tracing |
| 0105                   |           |   | HYAN    |

| NOTES |  |  |  |
|-------|--|--|--|
|       |  |  |  |

| BUILDING PERMIT RECORD |            |      |                |        |            |        |            | VISIT / CHANGE HISTORY           |            |    |      |    |    |                            |
|------------------------|------------|------|----------------|--------|------------|--------|------------|----------------------------------|------------|----|------|----|----|----------------------------|
| Permit Id              | Issue Date | Type | Description    | Amount | Insp Date  | % Comp | Date Comp  | Comments                         | Date       | Id | Type | Is | Cd | Purpost/Result             |
| EXPR-22-11             | 08-12-2022 | 835  | Sid/Wind/Roof/ | 4,950  |            | 100    |            | Install 834 sq ft R45 blown cell | 06-03-2020 | DM |      |    | FR | Field Review               |
| 18-2852                | 01-23-2019 | 804  | Addn Alt-Res   | 9,000  | 05-31-2019 | 100    | 06-30-2019 | repairr rot on rafters remove sk | 08-02-2019 | SR | 02   |    | 02 | Bldg Permit Completed      |
| 200905557              | 11-12-2009 | NR   | New Roof       | 0      | 06-30-2010 | 100    | 06-30-2010 | STRP OLD SHINGLES                | 11-21-2001 | PT | 01   |    | 00 | Meas/Listed-Interior Acces |
| 200902024              | 05-08-2009 | NW   | New Windows    | 3,630  | 06-30-2009 | 100    | 06-30-2009 | REPL UV .30                      | 03-15-1988 | ME | 02   |    | 01 | Meas/Est                   |
| B31283                 | 10-01-1987 | AD   | Addition       | 5,000  | 01-15-1988 | 100    | 06-30-1988 | HP ENC.PC                        |            |    |      |    |    |                            |

| LAND LINE VALUATION SECTION |          |                |      |    |            |                        |          |         |            |       |       |                  |       |                    |            |            |         |
|-----------------------------|----------|----------------|------|----|------------|------------------------|----------|---------|------------|-------|-------|------------------|-------|--------------------|------------|------------|---------|
| B                           | Use Code | Description    | Zone | LA | Land Units | Unit Price             | Size Adj | AC Disc | Site Index | Cond. | Nbhd. | Nbhd. Adj        | Notes | Location Adjustmen | Adj Unit P | Land Value |         |
| 1                           | 1010     | Single Fam M-0 | RB   | 4  | 0.230 AC   | 176,344.00             | 3.61599  | 1.0000  | 5          | 1.00  | 0105  | 1.000            |       | 1.0000             | 637,659.9  | 146,700    |         |
| Total Card Land Units       |          |                |      |    | 0.23 AC    | Parcel Total Land Area |          |         |            |       | 0.23  | Total Land Value |       |                    |            |            | 146,700 |

| CONSTRUCTION DETAIL |    |                | CONSTRUCTION DETAIL (CONTINUED) |      |             |
|---------------------|----|----------------|---------------------------------|------|-------------|
| Element             | Cd | Description    | Element                         | Cd   | Description |
| Style               | 01 | Ranch          |                                 |      |             |
| Model               | 01 | Residential    |                                 |      |             |
| Grade:              | C  | Average        |                                 |      |             |
| Stories             | 1  | 1 Story        |                                 |      |             |
| Exterior Wall 1     | 26 | Aluminum Sidng | <b>CONDO DATA</b>               |      |             |
| Exterior Wall 2     |    |                | Parcel Id                       |      | C           |
| Roof Structure      | 03 | Gable/Hip      |                                 |      | Ownr 0.0    |
| Roof Cover          | 03 | Asph/F Gls/Cmp |                                 |      | B S         |
| Interior Wall 1     | 05 | Drywall        | Adjust Type                     | Code | Description |
| Interior Wall 2     |    |                | Condo Flr                       |      | Factor%     |
| Interior Floor 1    | 14 | Carpet         | Condo Unit                      |      |             |
| Interior Floor 2    | 12 | Hardwood       | <b>COST / MARKET VALUATION</b>  |      |             |
| Heat Fuel           | 03 | Gas            | Building Value New              |      | 324,783     |
| Heat Type           | 05 | Hot Water      | Year Built                      |      | 1963        |
| AC Type             | 03 | Central        | Effective Year Built            |      | 1987        |
| Bedrooms            | 02 | 2 Bedrooms     | Depreciation Code               |      | A           |
| Full Baths          | 1  |                | Remodel Rating                  |      |             |
| Half Baths          | 0  |                | Year Remodeled                  |      |             |
| Extra Fixtures      |    |                | Depreciation %                  |      | 25          |
| Total Rooms         | 5  | 5 Rooms        | Functional Obsol                |      | 0           |
| Bath Style          |    |                | External Obsol                  |      | 0           |
| Kitchen Style       |    |                | Trend Factor                    |      | 1           |
| Occupancy           |    |                | Condition                       |      |             |
| UsrflD 105          |    |                | Condition %                     |      |             |
| Accessory Apt       |    |                | Percent Good                    |      | 75          |
| Foundation Alt      | 01 | Poured Conc.   | RCNLD                           |      | 243,600     |
| Rms Prts            |    |                | Dep % Ovr                       |      |             |
| Bath Split          | 10 | 1 Full-0 Half  | Dep Ovr Comment                 |      |             |
|                     |    |                | Misc Imp Ovr                    |      |             |
|                     |    |                | Misc Imp Ovr Comment            |      |             |
|                     |    |                | Cost to Cure Ovr                |      |             |
|                     |    |                | Cost to Cure Ovr Comment        |      |             |

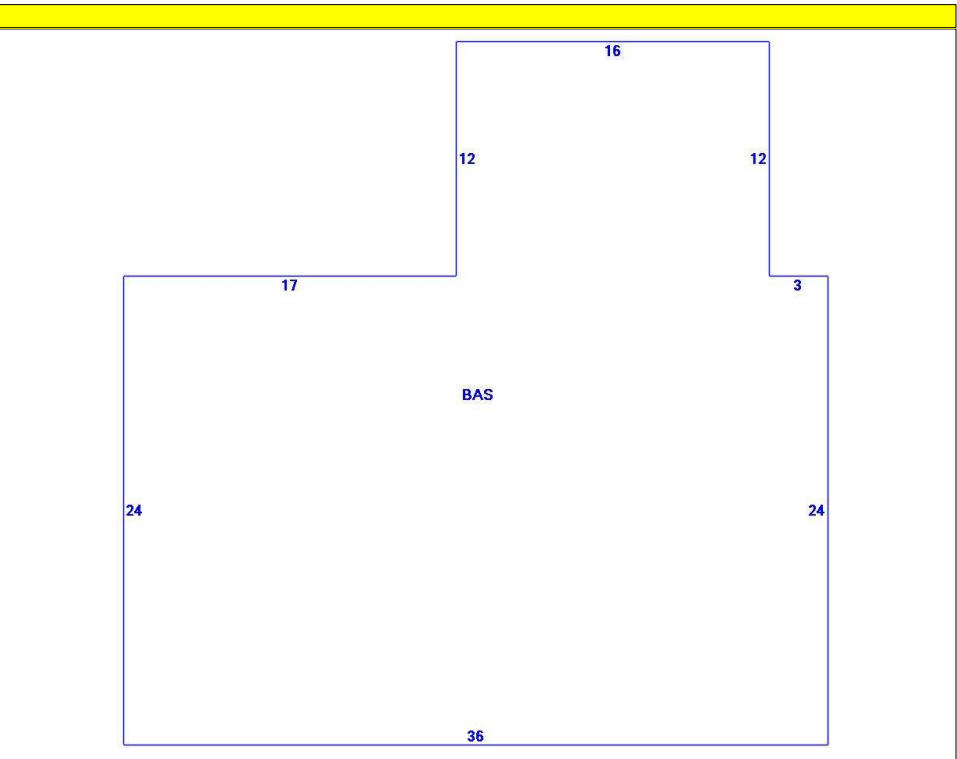

| OB - OUTBUILDING & YARD ITEMS(L) / XF - BUILDING EXTRA FEATURES(B) |             |     |       |            |        |          |      |       |            |             |
|--|-------------|-----|-------|------------|--------|----------|------|-------|------------|-------------|
| Code   | Description | L/B | Units | Unit Price | Yr Blt | Cond. Cd | % Gd | Grade | Grade Adj. | Appr. Value |
| SHED   | Shed        | L   | 80    | 18.00      | 1990   |          | 42   |       | 0.00       | 600         |

| BUILDING SUB-AREA SUMMARY SECTION |             |             |            |          |           |                |
|-----------------------------------|-------------|-------------|------------|----------|-----------|----------------|
| Code                              | Description | Living Area | Floor Area | Eff Area | Unit Cost | Undeprec Value |
| BAS                               | First Floor | 1,056       | 1,056      | 1,056    | 307.56    | 324,783        |
| Ttl Gross Liv / Lease Area        |             | 1,056       | 1,056      | 1,056    |           | 324,783        |

