

CURRENT OWNER		TOPO	UTILITIES	STRT / ROAD	LOCATION	CURRENT ASSESSMENT				
FULCHER, TERRY B						Description	Code	Assessed	Assessed	801 FY2024 BARNSTABLE, MA
9 PLEASANT PARK AVE - UNIT 2E						RESIDNTL	1020	195,000	195,000	
HYANNIS MA 02601										
SUPPLEMENTAL DATA										
Alt Prcl ID		Split Zonin RB;HB			Plan Ref. 357/78-79					
#DL 1		UNIT 2E			Land Ct#					
#DL 2		BLDG 2			#SR					
GIS ID		F_977549_2701097			Life Estate					
					PP STATU					
					Assoc Pid#					
							Total	195,000	195,000	

RECORD OF OWNERSHIP		BK-VOL/PAGE	SALE DATE	Q/U	V/I	SALE PRICE	VC	PREVIOUS ASSESSMENTS (HISTORY)						
FULCHER, TERRY B		13604	0124	03-01-2001	Q	I	87,500	00	Year	Code	Assessed	Year	Code	Assessed
SKIGIS, MARK & KATHERINE		3388	0026	10-30-1981	U		0		2023	1020	192,900	2022	1020	161,600
									2021	1020	161,300	2021	1020	2,100
							Total		Total	192,900	Total	161,600	Total	163,400

EXEMPTIONS				OTHER ASSESSMENTS				This signature acknowledges a visit by a Data Collector or Assessor								
Year	Code	Description	Amount	Code	Description	Number	Amount	Comm Int								
2010	5C	RESIDENTIAL EXEMPTION	0.00													
			Total													
			0.00													

ASSESSING NEIGHBORHOOD				APPRaised VALUE SUMMARY				
Nbhd	Nbhd Name	B	Tracing	Batch				
0001				HYAN				

NOTES											APPRaised VALUE SUMMARY			
											Appraised Bldg. Value (Card)	192,900		
											Appraised Xf (B) Value (Bldg)	0		
											Appraised Ob (B) Value (Bldg)	2,100		
											Appraised Land Value (Bldg)	0		
											Special Land Value	0		
											Total Appraised Parcel Value	195,000		
											Valuation Method	C		
											Total Appraised Parcel Value	195,000		

BUILDING PERMIT RECORD											VISIT / CHANGE HISTORY					
Permit Id	Issue Date	Type	Description	Amount	Insp Date	% Comp	Date Comp	Comments			Date	Id	Type	Is	Cd	Purpost/Result
											05-29-2020	LS			FR	Field Review
											11-26-2018	SR	02		03	Cycl Insp Comp
											07-30-2015	TP	03		16	In Office Review

LAND LINE VALUATION SECTION																			
B	Use Code	Description	Zone	Dist	Land Type	Land Units	Unit Price	Size Adj	Site Index	Cond.	Nbhd.	Nbhd. Adj	Notes	Location Adjustmen	Adj Unit P	Land Value			
1	102U	Condominium M	SPLI	4		0 SF	0.00	1.00000	5	1.00	0001	1.000		0.0000	0	0			
Total Card Land Units						0	SF	Parcel Total Land Area						0.00	Total Land Value				0

CONSTRUCTION DETAIL			CONSTRUCTION DETAIL (CONTINUED)		
Element	Cd	Description	Element	Cd	Description
Style	55	Condominium			
Model	05	Res Condo			
Bedrm Func	C	Average			
Stories	1	1 Story			
Occupancy	0				
Interior Wall 1	05	Drywall			
Interior Wall 2					
Interior Floor 1	14	Carpet			
Interior Floor 2					
Heat Fuel	03	Gas			
Heat Type	04	Hot Air			
AC Type	01	None			
Bedrooms	02	2 Bedrooms			
Full Baths	2	2 Full			
Half Baths	0				
Extra Fixtures					
Total Rooms	4	4 Rooms			
Bath Style					
Kitchen Style					
Master Deed L	975				
Bath Split	20	2 Full-0 Half			
Foundation	01	Poured Conc.			
AC Type Alt					
Sewer Occupan					
CONDO DATA					
Parcel Id	104245	C 0300	Ownr	5.4	
PLEASANT PARK		B 1	S 1		
Adjust Type	Code	Description	Factor%		
Condo Flr	1FU	FIRST FLOOR	100		
Condo Unit	MKT0	MKT0	100		
COST / MARKET VALUATION					
Building Value New			226,981		
Year Built			1981		
Effective Year Built			2000		
Depreciation Code			A		
Remodel Rating					
Year Remodeled					
Depreciation %			15		
Functional Obsol			0		
External Obsol			0		
Trend Factor			1		
Condition					
Condition %					
Percent Good			85		
Cns Sect Rcnd			192,900		
Dep % Ovr					
Dep Ovr Comment					
Misc Imp Ovr					
Misc Imp Ovr Comment					
Cost to Cure Ovr					
Cost to Cure Ovr Comment					

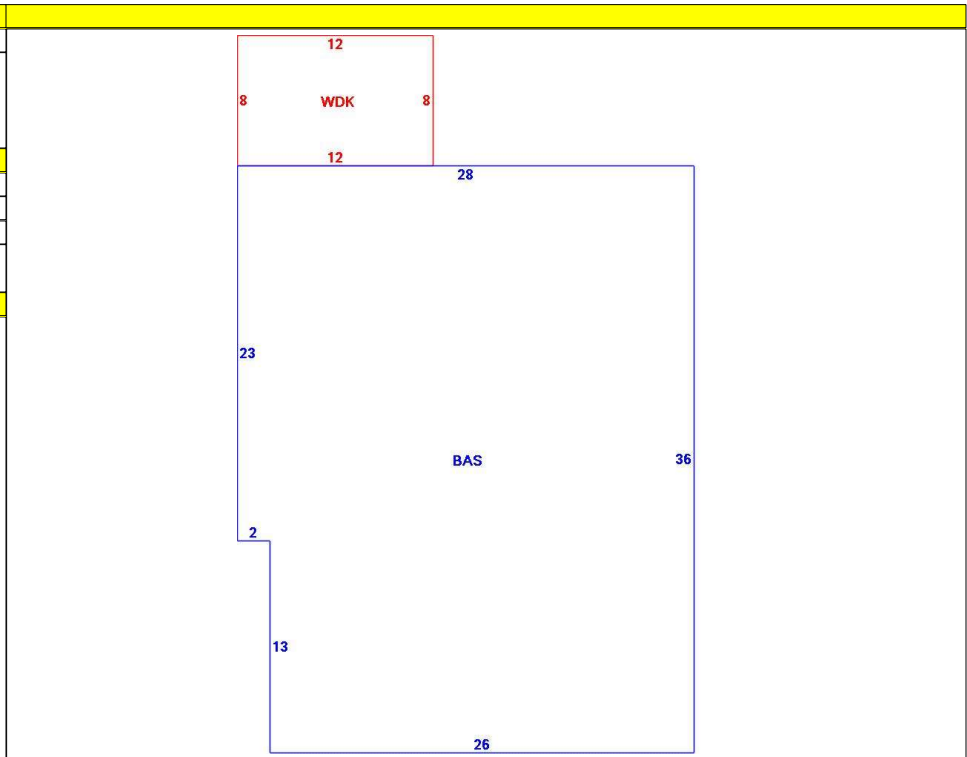

OB - OUTBUILDING & YARD ITEMS(L) / XF - BUILDING EXTRA FEATURES(B)										
Code	Description	L/B	Units	Unit Price	Yr Blt	Cond. Cd	% Gd	Grade	Grade Adj.	Appr. Value
WDC	Wood Decking	L	96	20.00	1999		60		0.00	2,100

BUILDING SUB-AREA SUMMARY SECTION						
Code	Description	Living Area	Floor Area	Eff Area	Unit Cost	Undeprec Value
BAS	First Floor	982	982	982	231.14	226,981
WDK	Wood Deck	0	96	0	0.00	0
Ttl Gross Liv / Lease Area		982	1,078	982		226,981

