

| CURRENT OWNER | | TOPO | UTILITIES | STRT / ROAD | LOCATION | CURRENT ASSESSMENT | | | | 801 FY2024 BARNSTABLE, MA VISION | |
|--|--|----------------|----------------|------------------|----------|--------------------|------|----------|----------|--|---------|
| MIRANDA, RUI A 64 BLUEBERRY HILL RD HYANNIS MA 02601 | | 1 Level | 2 Public Water | 1 Paved | | Description | Code | Assessed | Assessed | | |
| | | | 4 Gas | | | RESIDNTL | 1010 | 364,700 | 364,700 | | |
| | | | 6 Septic | | | RES LAND | 1010 | 152,200 | 152,200 | | |
| SUPPLEMENTAL DATA | | | | | | Total | | | | 516,900 | 516,900 |
| Alt Prcl ID | | Split Zonin | | Plan Ref. 187/51 | | | | | | | |
| BID Parcel | | ResExpt Q YES: | | Land Ct# | | | | | | | |
| #DL 1 LOT 14 | | #DL 2 | | Life Estate | | | | | | | |
| GIS ID F_977324_2702744 | | Assoc Pid# | | | | | | | | | |

| RECORD OF OWNERSHIP | | BK-VOL/PAGE | SALE DATE | Q/U | V/I | SALE PRIC | VC | PREVIOUS ASSESSMENTS (HISTORY) | | | | | | | | |
|------------------------------|-------|-------------|------------|-----|-----|-----------|----|--------------------------------|------|----------|-------|------|----------|-------|------|----------|
| MIRANDA, RUI A | 15072 | 0293 | 04-23-2002 | U | I | 1 | 1F | Year | Code | Assessed | Year | Code | Assessed | Year | Code | Assessed |
| MIRANDA, RUI A | 12092 | 0257 | 03-01-1999 | Q | I | 140,500 | 00 | 2023 | 1010 | 312,300 | 2022 | 1010 | 262,200 | 2021 | 1010 | 247,000 |
| PEARSON, LISA | 10676 | 0109 | 03-31-1997 | Q | I | 127,000 | 00 | | 1010 | 138,400 | | 1010 | 102,500 | | 1010 | 102,500 |
| CONOVER, JEFFREY S & BARBARA | 9584 | 0091 | 03-15-1995 | Q | I | 129,000 | 00 | | | | | | | | 1010 | 4,100 |
| CAVICCHI, THOMAS A & LEANN | 6087 | 0026 | 12-15-1987 | Q | I | 145,000 | 00 | Total | | 450,700 | Total | | 364,700 | Total | | 353,600 |

| EXEMPTIONS | | | | OTHER ASSESSMENTS | | | | This signature acknowledges a visit by a Data Collector or Assessor | | | | | | | | | |
|------------|------|-----------------------|--------|-------------------|-------------|--------|--------|---|--|--|--|--|--|--|--|--|--|
| Year | Code | Description | Amount | Code | Description | Number | Amount | Comm Int | | | | | | | | | |
| 2010 | 5C | RESIDENTIAL EXEMPTION | 0.00 | | | | | | | | | | | | | | |
| Total | | | 0.00 | | | | | | | | | | | | | | |

| ASSESSING NEIGHBORHOOD | | | | APPRAISED VALUE SUMMARY | | | | | | |
|------------------------|-----------|---|--|-------------------------|-------|--|--|-------------------------------|-------------------------------|---------|
| Nbhd | Nbhd Name | B | | Tracing | Batch | | | Appraised Bldg. Value (Card) | 317,600 | |
| 0105 | | | | | HYAN | | | Appraised Xf (B) Value (Bldg) | 43,000 | |
| NOTES | | | | | | | | | Appraised Ob (B) Value (Bldg) | 4,100 |
| | | | | | | | | | Appraised Land Value (Bldg) | 152,200 |
| | | | | | | | | | Special Land Value | 0 |
| | | | | | | | | | Total Appraised Parcel Value | 516,900 |
| | | | | | | | | | Valuation Method | C |
| | | | | | | | | | Total Appraised Parcel Value | 516,900 |

| BUILDING PERMIT RECORD | | | | | | | | | VISIT / CHANGE HISTORY | | | | | | |
|------------------------|------------|------|----------------|--------|------------|--------|------------|---------------------------------|------------------------|----|------|----|----|----------------------------|--|
| Permit Id | Issue Date | Type | Description | Amount | Insp Date | % Comp | Date Comp | Comments | Date | Id | Type | Is | Cd | Purpost/Result | |
| EXPR-21-1 | 11-19-2021 | 835 | Sid/Wind/Roof/ | 10,000 | 03-07-2022 | 100 | 03-07-2022 | strip and re-roof 23SQ * Whole | 06-09-2022 | TR | 03 | | 16 | In Office Review | |
| BLDR-21-11 | 09-17-2021 | 839 | Solar Panel-Re | 4,400 | 06-09-2022 | 0 | 03-07-2022 | Installation of roof mounted ph | 05-29-2020 | LS | | | FR | Field Review | |
| | | | | | | | | | 01-10-2020 | SR | 02 | | 03 | Cycl Insp Comp | |
| | | | | | | | | | 05-12-2010 | PT | 02 | | 14 | Cyclical Inspection | |
| | | | | | | | | | 01-10-2001 | PT | 01 | | 00 | Meas/Listed-Interior Acces | |
| | | | | | | | | | 09-15-1989 | ML | 01 | | 00 | Meas/Listed-Interior Acces | |

| LAND LINE VALUATION SECTION | | | | | | | | | | | | | | | | | | |
|-----------------------------|----------|----------------|------|----|------------|------------|------------------------|---------|------------|-------|-------|-----------|------------------|--------------------|------------|------------|-----------|---------|
| B | Use Code | Description | Zone | LA | Land Units | Unit Price | Size Adj | AC Disc | Site Index | Cond. | Nbhd. | Nbhd. Adj | Notes | Location Adjustmen | Adj Unit P | Land Value | | |
| 1 | 1010 | Single Fam M-0 | RB | 4 | 0.350 | AC | 176,344.00 | 2.46674 | 1.0000 | 5 | 1.00 | 0105 | 1.000 | ABUTS APT COMPLEX | | 1.0000 | 434,987.7 | 152,200 |
| Total Card Land Units | | | | | 0.35 | AC | Parcel Total Land Area | | | | | 0.35 | Total Land Value | | | | | 152,200 |

| CONSTRUCTION DETAIL | | | CONSTRUCTION DETAIL (CONTINUED) | | |
|---------------------|-----|----------------|---------------------------------|------|---------------------|
| Element | Cd | Description | Element | Cd | Description |
| Style | 63 | Gambrel | | | |
| Model | 01 | Residential | | | |
| Grade: | C | Average | | | |
| Stories | 1.8 | | | | |
| Exterior Wall 1 | 11 | Clapboard | | | |
| Exterior Wall 2 | 19 | Brick Veneer | | | |
| RooF Structure | 07 | Gambrel | | | |
| RooF Cover | 03 | Asph/F Gls/Cmp | | | |
| Interior Wall 1 | 05 | Drywall | | | |
| Interior Wall 2 | | | | | |
| Interior Floor 1 | 12 | Hardwood | | | |
| Interior Floor 2 | | | | | |
| Heat Fuel | 03 | Gas | | | |
| Heat Type | 05 | Hot Water | | | |
| AC Type | 01 | None | | | |
| Bedrooms | 02 | 2 Bedrooms | | | |
| Full Baths | 2 | | | | |
| Half Baths | 0 | | | | |
| Extra Fixtures | | | | | |
| Total Rooms | 6 | 6 Rooms | | | |
| Bath Style | | | | | |
| Kitchen Style | | | | | |
| Occupancy | | | | | |
| Usrflid 105 | | | | | |
| Accessory Apt | | | | | |
| Foundation Alt | 01 | Poured Conc. | | | |
| Rms Prts | | | | | |
| Bath Split | 20 | 2 Full-0 Half | | | |
| | | | CONDO DATA | | |
| | | | Parcel Id | C | Owne 0.0 |
| | | | Adjust Type | Code | Description Factor% |
| | | | Condo Flr | | |
| | | | Condo Unit | | |
| | | | COST / MARKET VALUATION | | |
| | | | Building Value New | | 423,526 |
| | | | Year Built | | 1963 |
| | | | Effective Year Built | | 1987 |
| | | | Depreciation Code | | A |
| | | | Remodel Rating | | |
| | | | Year Remodeled | | |
| | | | Depreciation % | | 25 |
| | | | Functional Obsol | | 0 |
| | | | External Obsol | | 0 |
| | | | Trend Factor | | 1 |
| | | | Condition | | |
| | | | Condition % | | |
| | | | Percent Good | | 75 |
| | | | RCNLD | | 317,600 |
| | | | Dep % Ovr | | |
| | | | Dep Ovr Comment | | |
| | | | Misc Imp Ovr | | |
| | | | Misc Imp Ovr Comment | | |
| | | | Cost to Cure Ovr | | |
| | | | Cost to Cure Ovr Comment | | |

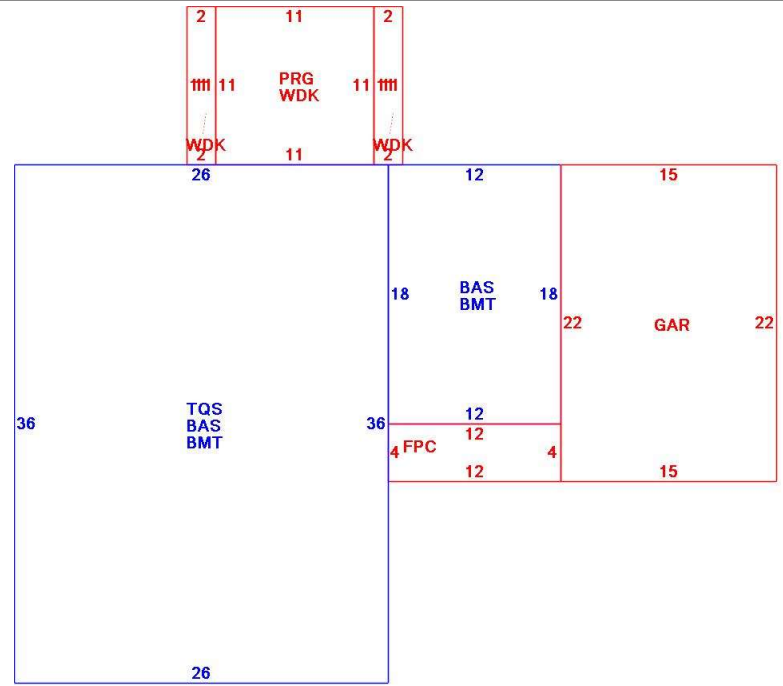

| OB - OUTBUILDING & YARD ITEMS(L) / XF - BUILDING EXTRA FEATURES(B) | | | | | | | | | | |
|--|-----------------|-----|-------|------------|--------|----------|------|-------|------------|-------------|
| Code | Description | L/B | Units | Unit Price | Yr Blt | Cond. Cd | % Gd | Grade | Grade Adj. | Appr. Value |
| FPL2 | Fireplace 1.5 s | B | 1 | 6000.00 | 1989 | | 75 | | 0.00 | 4,500 |
| WDC | Wood Deck w/ | L | 165 | 18.00 | 1994 | | 50 | | 0.00 | 1,900 |
| FOPC | Open Prch-roo | B | 48 | 55.00 | 1989 | | 75 | | 0.00 | 2,100 |
| GAR | Attached Gara | B | 330 | 40.00 | 1989 | | 75 | | 0.00 | 10,700 |
| BMT | Basement-Unfi | B | 1,152 | 26.01 | 1989 | | 75 | | 0.00 | 21,900 |
| FPL1 | Fireplace 1 sto | B | 1 | 5000.00 | 1989 | | 75 | | 0.00 | 3,800 |
| PRG1 | Pergola-Avg | L | 121 | 18.00 | 2020 | | 100 | C | 1.00 | 2,200 |
| SOL1 | Solar PV Pane | B | 28 | 860.00 | 2022 | | 0 | | 0.00 | 0 |

| BUILDING SUB-AREA SUMMARY SECTION | | | | | | |
|-----------------------------------|------------------------|-------------|------------|----------|-----------|----------------|
| Code | Description | Living Area | Floor Area | Eff Area | Unit Cost | Undeprec Value |
| BAS | First Floor | 1,152 | 1,152 | 1,152 | 240.64 | 277,217 |
| BMT | Basement Area | 0 | 1,152 | 0 | 0.00 | 0 |
| FPC | Open Porch Conc. Floor | 0 | 48 | 0 | 0.00 | 0 |
| GAR | Attached Garage | 0 | 330 | 0 | 0.00 | 0 |
| PRG | Pergola | 0 | 121 | 0 | 0.00 | 0 |
| TQS | Three Quarter Story | 608 | 936 | 608 | 156.31 | 146,309 |
| WDK | Wood Deck | 0 | 165 | 0 | 0.00 | 0 |
| Ttl Gross Liv / Lease Area | | 1,760 | 3,904 | 1,760 | | 423,526 |

