

| CURRENT OWNER  |  | TOPO    | UTILITIES      | STRT / ROAD  | LOCATION | CURRENT ASSESSMENT |      |          |          | 801<br>FY2024<br>BARNSTABLE, MA<br><br><b>VISION</b> |
|--|--|---------|----------------|--|----------|--------------------|------|----------|----------|--|
| ANGELIS, ARTHUR G & DIMITRIOS G<br>ANGELIS FAMILY IRREV TRUST<br>3 NEVADA STREET<br><br>WORCESTER MA 01602 |  | 1 Level | 2 Public Water | 1 Paved  |          | Description        | Code | Assessed | Assessed |  |
|  |  |         | 4 Gas          |  |          | RESIDNTL           | 1010 | 325,200  | 325,200  |  |
|  |  |         | 6 Septic       |  |          | RES LAND           | 1010 | 155,500  | 155,500  |  |
| <b>SUPPLEMENTAL DATA</b>   |  |         |                |  |          | Total              |      |          |          | 480,700  |
| Alt Prcl ID<br>Split Zonin<br>BID Parcel<br>ResExpt Q<br>#DL 1 LOT 79<br>#DL 2<br>GIS ID F_978653_2704234  |  |         |                | Plan Ref.<br>Land Ct# 25306B<br>#SR<br>Life Estate<br>PP STATU<br>Assoc Pid# |          |                    |      |          |          |  |

| RECORD OF OWNERSHIP                |         | BK-VOL/PAGE | SALE DATE  | Q/U  | V/I        | SALE PRIC | VC   | PREVIOUS ASSESSMENTS (HISTORY) |       |         |          |       |         |         |      |         |
|------------------------------------|---------|-------------|------------|------|------------|-----------|------|--------------------------------|-------|---------|----------|-------|---------|---------|------|---------|
| Year                               | Code    | Assessed    | Year       | Code | Assessed V | Year      | Code | Assessed                       | Year  | Code    | Assessed |       |         |         |      |         |
| ANGELIS, ARTHUR G & DIMITRIOS G, T | C214175 | 0           | 09-28-2017 | U    | I          | 100       | 1A   | 2023                           | 1010  | 284,000 | 2022     | 1010  | 233,400 | 2021    | 1010 | 188,200 |
| ANGELIS, GEORGE & DOROTHEA         | C169473 | 0           | 06-13-2003 | Q    | I          | 265,000   | 00   |                                | 1010  | 141,400 |          | 1010  | 104,700 |         | 1010 | 104,700 |
| SCHILE, STEPHEN E TR               | C144980 | 0           | 06-30-1997 | U    | I          | 1         | 1A   |                                |       |         |          |       |         |         | 1010 | 2,100   |
| SCHILE, MARION L                   | C144979 | 0           | 06-30-1997 | U    | I          | 1         | 1A   |                                |       |         |          |       |         |         |      |         |
| SCHILE, STEPHEN & MARION           | C92662  | 0           | 07-15-1983 | Q    | I          | 68,421    | U    |                                |       |         |          |       |         |         |      |         |
| Total                              |         |             |            |      |            |           |      | 425,400                        | Total |         | 338,100  | Total |         | 295,000 |      |         |

| EXEMPTIONS |      |             | OTHER ASSESSMENTS |      |             |        | This signature acknowledges a visit by a Data Collector or Assessor |      |     |  |  |  |
|------------|------|-------------|-------------------|------|-------------|--------|---|------|-----|--|--|--|
| Year       | Code | Description | Amount            | Code | Description | Number | Amount  | Comm | Int |  |  |  |
| Total      |      |             | 0.00              |      |             |        |   |      |     |  |  |  |

| ASSESSING NEIGHBORHOOD |           |   |         | APPRaised VALUE SUMMARY |                               |         |  |
|------------------------|-----------|---|---------|-------------------------|-------------------------------|---------|--|
| Nbhd                   | Nbhd Name | B | Tracing | Batch                   |                               |         |  |
| 0105                   |           |   |         | HYAN                    | Appraised Bldg. Value (Card)  | 279,100 |  |
|                        |           |   |         |                         | Appraised Xf (B) Value (Bldg) | 39,000  |  |
|                        |           |   |         |                         | Appraised Ob (B) Value (Bldg) | 7,100   |  |
|                        |           |   |         |                         | Appraised Land Value (Bldg)   | 155,500 |  |
|                        |           |   |         |                         | Special Land Value            | 0       |  |
|                        |           |   |         |                         | Total Appraised Parcel Value  | 480,700 |  |
|                        |           |   |         |                         | Valuation Method              | C       |  |
|                        |           |   |         |                         | Total Appraised Parcel Value  | 480,700 |  |

| NOTES     |            |      |             |        |           |        |           |          |  |  | VISIT / CHANGE HISTORY |    |      |    |    |                            |
|-----------|------------|------|-------------|--------|-----------|--------|-----------|----------|--|--|------------------------|----|------|----|----|----------------------------|
| Permit Id | Issue Date | Type | Description | Amount | Insp Date | % Comp | Date Comp | Comments |  |  | Date                   | Id | Type | Is | Cd | Purpost/Result             |
|           |            |      |             |        |           |        |           |          |  |  | 10-06-2021             | SR | 02   |    | 03 | Cycl Insp Comp             |
|           |            |      |             |        |           |        |           |          |  |  | 04-20-2020             | WD |      |    | FR | Field Review               |
|           |            |      |             |        |           |        |           |          |  |  | 11-04-2003             | PT | 02   |    | 01 | Meas/Est                   |
|           |            |      |             |        |           |        |           |          |  |  | 01-04-2001             | PT | 01   |    | 00 | Meas/Listed-Interior Acces |

| LAND LINE VALUATION SECTION |          |                |      |    |            |            |                        |         |            |       |       |           |                  |                    |            |            |         |
|-----------------------------|----------|----------------|------|----|------------|------------|------------------------|---------|------------|-------|-------|-----------|------------------|--------------------|------------|------------|---------|
| B                           | Use Code | Description    | Zone | LA | Land Units | Unit Price | Size Adj               | AC Disc | Site Index | Cond. | Nbhd. | Nbhd. Adj | Notes            | Location Adjustmen | Adj Unit P | Land Value |         |
| 1                           | 1010     | Single Fam M-0 | RC-  | 4  | 0.450      | AC         | 176,344.00             | 1.95982 | 1.0000     | 5     | 1.00  | 0105      | 1.000            |                    | 1.0000     | 345,598.9  | 155,500 |
| Total Card Land Units       |          |                |      |    | 0.45       | AC         | Parcel Total Land Area |         |            |       |       | 0.45      | Total Land Value |                    |            | 155,500    |         |

| CONSTRUCTION DETAIL |    |                | CONSTRUCTION DETAIL (CONTINUED) |    |             |
|---------------------|----|----------------|---------------------------------|----|-------------|
| Element             | Cd | Description    | Element                         | Cd | Description |
| Style               | 01 | Ranch          |                                 |    |             |
| Model               | 01 | Residential    |                                 |    |             |
| Grade:              | C  | Average        |                                 |    |             |
| Stories             | 1  | 1 Story        |                                 |    |             |
| Exterior Wall 1     | 14 | Wood Shingle   |                                 |    |             |
| Exterior Wall 2     | 11 | Clapboard      |                                 |    |             |
| RooF Structure      | 03 | Gable/Hip      |                                 |    |             |
| RooF Cover          | 03 | Asph/F Gls/Cmp |                                 |    |             |
| Interior Wall 1     | 05 | Drywall        |                                 |    |             |
| Interior Wall 2     |    |                |                                 |    |             |
| Interior Floor 1    | 14 | Carpet         |                                 |    |             |
| Interior Floor 2    | 11 | Ceram Clay Til |                                 |    |             |
| Heat Fuel           | 03 | Gas            |                                 |    |             |
| Heat Type           | 04 | Hot Air        |                                 |    |             |
| AC Type             | 03 | Central        |                                 |    |             |
| Bedrooms            | 03 | 3 Bedrooms     |                                 |    |             |
| Full Baths          | 2  |                |                                 |    |             |
| Half Baths          | 0  |                |                                 |    |             |
| Extra Fixtures      |    |                |                                 |    |             |
| Total Rooms         | 6  | 6 Rooms        |                                 |    |             |
| Bath Style          |    |                |                                 |    |             |
| Kitchen Style       |    |                |                                 |    |             |
| Occupancy           |    |                |                                 |    |             |
| Usrflid 105         |    |                |                                 |    |             |
| Accessory Apt       |    |                |                                 |    |             |
| Foundation Alt      | 01 | Poured Conc.   |                                 |    |             |
| Rms Prts            |    |                |                                 |    |             |
| Bath Split          | 20 | 2 Full-0 Half  |                                 |    |             |

| CONDO DATA  |      |             |          |
|-------------|------|-------------|----------|
| Parcel Id   |      | C           | Ownr 0.0 |
|             |      | B           | S        |
| Adjust Type | Code | Description | Factor%  |
| Condo Flr   |      |             |          |
| Condo Unit  |      |             |          |

| COST / MARKET VALUATION  |         |
|--------------------------|---------|
| Building Value New       | 336,264 |
| Year Built               | 1983    |
| Effective Year Built     | 1997    |
| Depreciation Code        | A       |
| Remodel Rating           |         |
| Year Remodeled           |         |
| Depreciation %           | 17      |
| Functional Obsol         | 0       |
| External Obsol           | 0       |
| Trend Factor             | 1       |
| Condition                |         |
| Condition %              |         |
| Percent Good             | 83      |
| RCNLD                    | 279,100 |
| Dep % Ovr                |         |
| Dep Ovr Comment          |         |
| Misc Imp Ovr             |         |
| Misc Imp Ovr Comment     |         |
| Cost to Cure Ovr         |         |
| Cost to Cure Ovr Comment |         |

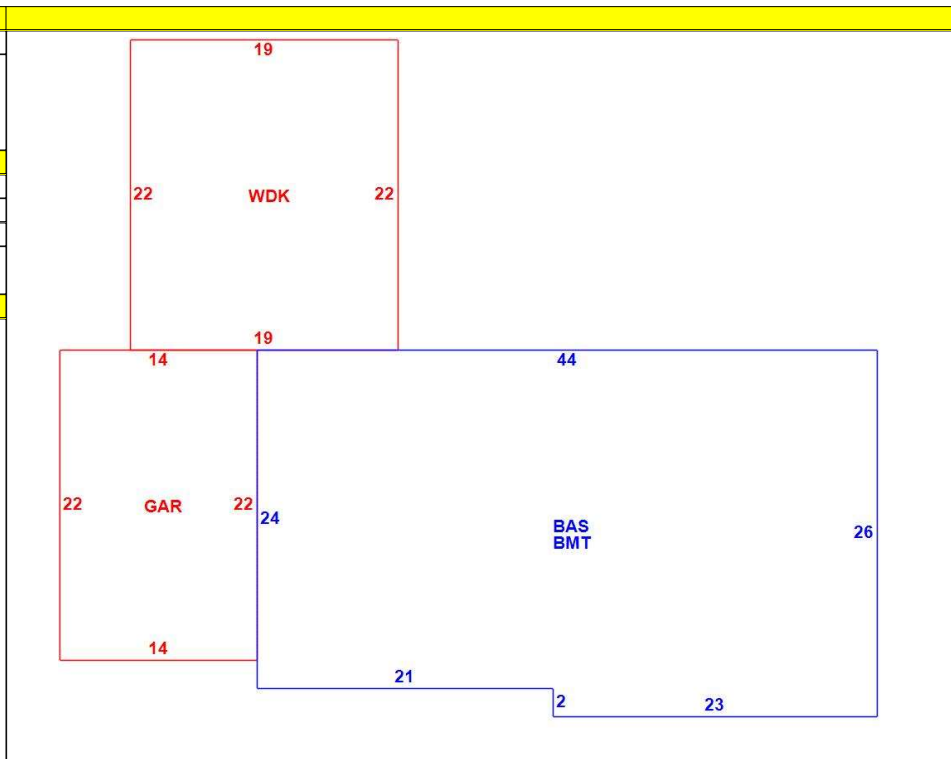

| OB - OUTBUILDING & YARD ITEMS(L) / XF - BUILDING EXTRA FEATURES(B) |                 |     |       |            |        |          |      |       |            |             |
|--|-----------------|-----|-------|------------|--------|----------|------|-------|------------|-------------|
| Code   | Description     | L/B | Units | Unit Price | Yr Blt | Cond. Cd | % Gd | Grade | Grade Adj. | Appr. Value |
| FPL1   | Fireplace 1 sto | B   | 1     | 5000.00    | 1999   |          | 83   |       | 0.00       | 4,200       |
| WDC  | Wood Decking    | L   | 418   | 20.00      | 1999   |          | 60   |       | 0.00       | 4,800       |
| GAR  | Attached Gara   | B   | 308   | 40.00      | 1999   |          | 83   |       | 0.00       | 11,300      |
| BMT  | Basement-Unfi   | B   | 1,102 | 26.01      | 1999   |          | 83   |       | 0.00       | 23,500      |
| SHD2   | Shed w/Elec     | L   | 160   | 26.00      | 1997   |          | 56   |       | 0.00       | 2,300       |

| BUILDING SUB-AREA SUMMARY SECTION |                 |             |            |          |           |                |
|-----------------------------------|-----------------|-------------|------------|----------|-----------|----------------|
| Code                              | Description     | Living Area | Floor Area | Eff Area | Unit Cost | Undeprec Value |
| BAS                               | First Floor     | 1,102       | 1,102      | 1,102    | 305.14    | 336,264        |
| BMT                               | Basement Area   | 0           | 1,102      | 0        | 0.00      | 0              |
| GAR                               | Attached Garage | 0           | 308        | 0        | 0.00      | 0              |
| WDK                               | Wood Deck       | 0           | 418        | 0        | 0.00      | 0              |
| Ttl Gross Liv / Lease Area        |                 | 1,102       | 2,930      | 1,102    |           | 336,264        |

