

| CURRENT OWNER | | TOPO | UTILITIES | STRT / ROAD | LOCATION | CURRENT ASSESSMENT | | | | 801 FY2024 BARNSTABLE, MA VISION |
|---|--|---------|----------------|--|----------|--------------------|------|----------|----------|--|
| DEMATTOS, ROBIN A 100 CAPTAIN ELLIS LANE HYANNIS MA 02601 | | 1 Level | 2 Public Water | 1 Paved | | Description | Code | Assessed | Assessed | |
| | | | 4 Gas | | | RESIDNTL | 1010 | 250,800 | 250,800 | |
| | | | 6 Septic | | | RES LAND | 1010 | 153,600 | 153,600 | |
| SUPPLEMENTAL DATA | | | | | | Total | | | | 404,400 |
| Alt Prcl ID Split Zonin BID Parcel ResExpt Q #DL 1 LOT 19 #DL 2 GIS ID F_977974_2704243 | | | | Plan Ref. 288/18 Land Ct# #SR Life Estate PP STATU Assoc Pid# | | | | | | |

| RECORD OF OWNERSHIP | | BK-VOL/PAGE | SALE DATE | Q/U | V/I | SALE PRIC | VC | PREVIOUS ASSESSMENTS (HISTORY) | | | | | | | | |
|----------------------|-------|-------------|------------|------|------------|-----------|------|--------------------------------|-------|---------|----------|-------|---------|---------|------|---------|
| Year | Code | Assessed | Year | Code | Assessed V | Year | Code | Assessed | Year | Code | Assessed | | | | | |
| DEMATTOS, ROBIN A | 30358 | 0341 | 03-17-2017 | U | I | 1 | 1A | | | | | | | | | |
| DEMATTOS, DAVID PAUL | 25515 | 0070 | 06-17-2011 | U | I | 200,000 | 1S | 2023 | 1010 | 220,600 | 2022 | 1010 | 184,500 | 2021 | 1010 | 156,000 |
| M&M REALTY GROUP INC | 25444 | 0001 | 05-12-2011 | U | I | 1 | 1F | | 1010 | 139,600 | | 1010 | 103,400 | | 1010 | 103,400 |
| MEAGHER, TIMOTHY W | 25443 | 0332 | 05-12-2011 | U | I | 120,000 | 1 | | | | | | | | 1010 | 2,600 |
| SHEAFFER, ROBIN A | 19143 | 0188 | 10-18-2004 | U | I | 0 | 1 | | | | | | | | | |
| Total | | | | | | | | 360,200 | Total | | 287,900 | Total | | 262,000 | | |

| EXEMPTIONS | | | OTHER ASSESSMENTS | | | | | |
|------------|------|-------------|-------------------|------|-------------|--------|--------|----------|
| Year | Code | Description | Amount | Code | Description | Number | Amount | Comm Int |
| Total | | | 0.00 | | | | | |

| ASSESSING NEIGHBORHOOD | | | | |
|------------------------|-----------|---|---------|-------|
| Nbhd | Nbhd Name | B | Tracing | Batch |
| 0105 | | | | HYAN |

| NOTES | | | | |
|---|--|--|--|---------|
| This signature acknowledges a visit by a Data Collector or Assessor | | | | |
| APPRAISED VALUE SUMMARY | | | | |
| Appraised Bldg. Value (Card) | | | | 226,600 |
| Appraised Xf (B) Value (Bldg) | | | | 20,000 |
| Appraised Ob (B) Value (Bldg) | | | | 4,200 |
| Appraised Land Value (Bldg) | | | | 153,600 |
| Special Land Value | | | | 0 |
| Total Appraised Parcel Value | | | | 404,400 |
| Valuation Method | | | | C |
| Total Appraised Parcel Value | | | | 404,400 |

| BUILDING PERMIT RECORD | | | | | | | | | | VISIT / CHANGE HISTORY | | | | | |
|------------------------|------------|------|-------------|--------|------------|--------|------------|-------------------------------|--|------------------------|----|------|----|----|------------------|
| Permit Id | Issue Date | Type | Description | Amount | Insp Date | % Comp | Date Comp | Comments | | Date | Id | Type | Is | Cd | Purpost/Result |
| 20-303 | 01-30-2020 | 822 | Insulation | 0 | 06-30-2020 | 100 | 06-30-2020 | Insulation and weatherization | | 12-29-2022 | DB | 02 | | 03 | Cycl Insp Comp |
| | | | | | | | | | | 04-20-2020 | WD | | | FR | Field Review |
| | | | | | | | | | | 03-17-2017 | AL | 03 | | 16 | In Office Review |
| | | | | | | | | | | 01-28-2014 | JR | 03 | | 16 | In Office Review |

| LAND LINE VALUATION SECTION | | | | | | | | | | | | | | | | | |
|-----------------------------|----------|----------------|------|----|------------|------------|------------------------|---------|------------|-------|-------|-----------|------------------|--------------------|------------|------------|---------|
| B | Use Code | Description | Zone | LA | Land Units | Unit Price | Size Adj | AC Disc | Site Index | Cond. | Nbhd. | Nbhd. Adj | Notes | Location Adjustmen | Adj Unit P | Land Value | |
| 1 | 1010 | Single Fam M-0 | RC- | 4 | 0.390 | AC | 176,344.00 | 2.23277 | 1.0000 | 5 | 1.00 | 0105 | 1.000 | | 1.0000 | 393,740.8 | 153,600 |
| Total Card Land Units | | | | | 0.39 | AC | Parcel Total Land Area | | | | | 0.39 | Total Land Value | | | 153,600 | |

| CONSTRUCTION DETAIL | | | CONSTRUCTION DETAIL (CONTINUED) | | |
|---------------------|-----|----------------|---------------------------------|----|-------------|
| Element | Cd | Description | Element | Cd | Description |
| Style | 04 | Cape Cod | | | |
| Model | 01 | Residential | | | |
| Grade: | C | Average | | | |
| Stories | 1.5 | 1 1/2 Stories | | | |
| Exterior Wall 1 | 11 | Clapboard | | | |
| Exterior Wall 2 | | | | | |
| RooF Structure | 03 | Gable/Hip | | | |
| RooF Cover | 03 | Asph/F Gls/Cmp | | | |
| Interior Wall 1 | 05 | Drywall | | | |
| Interior Wall 2 | | | | | |
| Interior Floor 1 | 14 | Carpet | | | |
| Interior Floor 2 | | | | | |
| Heat Fuel | 03 | Gas | | | |
| Heat Type | 04 | Hot Air | | | |
| AC Type | 01 | None | | | |
| Bedrooms | 03 | 3 Bedrooms | | | |
| Full Baths | 1 | | | | |
| Half Baths | 1 | | | | |
| Extra Fixtures | | | | | |
| Total Rooms | 6 | 6 Rooms | | | |
| Bath Style | | | | | |
| Kitchen Style | | | | | |
| Occupancy | | | | | |
| Usrflid 105 | | | | | |
| Accessory Apt | | | | | |
| Foundation Alt | 01 | Poured Conc. | | | |
| Rms Prts | | | | | |
| Bath Split | 11 | 1 Full-1 Half | | | |

| CONDO DATA | | | | |
|-------------|------|-------------|---------|-----|
| Parcel Id | | C | Owne | 0.0 |
| Adjust Type | Code | Description | Factor% | |
| Condo Flr | | | | |
| Condo Unit | | | | |

| COST / MARKET VALUATION | |
|--------------------------|---------|
| Building Value New | 279,806 |
| Year Built | 1976 |
| Effective Year Built | 1994 |
| Depreciation Code | A |
| Remodel Rating | |
| Year Remodeled | |
| Depreciation % | 19 |
| Functional Obsol | 0 |
| External Obsol | 0 |
| Trend Factor | 1 |
| Condition | |
| Condition % | |
| Percent Good | 81 |
| RCNLD | 226,600 |
| Dep % Ovr | |
| Dep Ovr Comment | |
| Misc Imp Ovr | |
| Misc Imp Ovr Comment | |
| Cost to Cure Ovr | |
| Cost to Cure Ovr Comment | |

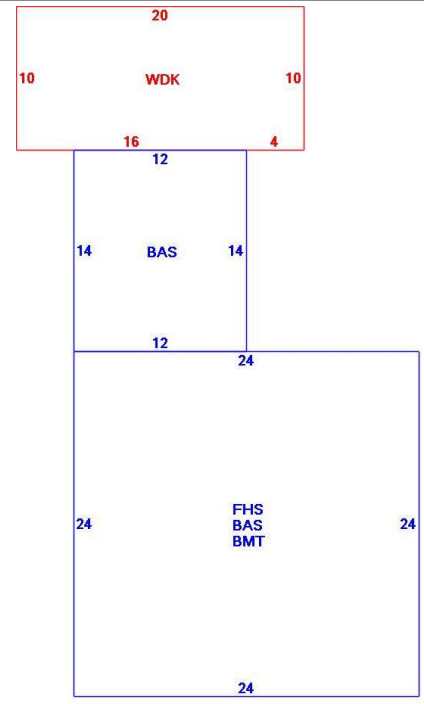

| OB - OUTBUILDING & YARD ITEMS(L) / XF - BUILDING EXTRA FEATURES(B) | | | | | | | | | | |
|--|-----------------|-----|-------|------------|--------|----------|------|-------|------------|-------------|
| Code | Description | L/B | Units | Unit Price | Yr Blt | Cond. Cd | % Gd | Grade | Grade Adj. | Appr. Value |
| FPL2 | Fireplace 1.5 s | B | 1 | 6000.00 | 1996 | | 81 | | 0.00 | 4,900 |
| WDC | Wood Decking | L | 200 | 20.00 | 1997 | | 56 | | 0.00 | 2,600 |
| BMT | Basement-Unfi | B | 576 | 26.01 | 1996 | | 81 | | 0.00 | 15,100 |
| SHED | Shed | L | 108 | 18.00 | 2010 | | 82 | | 0.00 | 1,600 |

| BUILDING SUB-AREA SUMMARY SECTION | | | | | | |
|-----------------------------------|---------------|-------------|------------|----------|-----------|----------------|
| Code | Description | Living Area | Floor Area | Eff Area | Unit Cost | Undeprec Value |
| BAS | First Floor | 744 | 744 | 744 | 271.13 | 201,721 |
| BMT | Basement Area | 0 | 576 | 0 | 0.00 | 0 |
| FHS | Half Story | 288 | 576 | 288 | 135.57 | 78,085 |
| WDK | Wood Deck | 0 | 200 | 0 | 0.00 | 0 |
| Ttl Gross Liv / Lease Area | | 1,032 | 2,096 | 1,032 | | 279,806 |

