

| CURRENT OWNER | | TOPO | UTILITIES | STRT / ROAD | LOCATION | CURRENT ASSESSMENT | | | | 801 FY2024 BARNSTABLE, MA VISION | | | | | | |
|--|------------|----------------|-------------------|------------------|-------------|--------------------|---|--------------------------------|------------|--|-------|--|------------------|--------------------|------------|------------|
| KLUN, VIRGINIA GALE TR BONJON REVOCABLE TRUST DATE 428 SHOOTFLYING HILL ROAD CENTERVILLE MA 02632 | | 1 Level | 2 Public Water | 1 Paved | | Description | Code | Assessed | Assessed | | | RESIDNTL 1010 303,900 303,900 RES LAND 1010 212,700 212,700 | | | | |
| | | | 4 Gas | | | | | | | | | | | | | |
| | | | 6 Septic | | | | | | | | | | | | | |
| SUPPLEMENTAL DATA | | | | | | Total | | 516,600 | 516,600 | | | | | | | |
| Alt Prcl ID | | Split Zonin | | Plan Ref. 47/119 | | | | | | | | | | | | |
| BID Parcel | | ResExpt Q | | Land Ct# | | | | | | | | | | | | |
| #DL 1 LOT 35 | | #DL 2 | | #SR | | | | | | | | | | | | |
| GIS ID F_976912_2705584 | | Assoc Pid# | | Life Estate | | | | | | | | | | | | |
| PP STATU | | | | | | | | | | | | | | | | |
| RECORD OF OWNERSHIP | | BK-VOL/PAGE | SALE DATE | Q/U | V/I | SALE PRIC | VC | PREVIOUS ASSESSMENTS (HISTORY) | | | | | | | | |
| KLUN, VIRGINIA GALE TR | | 27783 0135 | 10-25-2013 | U | I | 1 | 1F | Year | Code | Assessed | Year | Code | Assessed | | | |
| KLUN, VIRGINIA GALE | | 23400 0268 | 01-28-2009 | Q | I | 275,000 | 00 | 2023 | 1010 | 261,700 | 2022 | 1010 | 229,200 | | | |
| UPHAM, VIRGINIA | | 23400 0265 | 01-28-2009 | U | I | 0 | 1 | | 1010 | 193,400 | | 1010 | 133,000 | | | |
| UPHAM, JOHN E & VIRGINIA | | 9557 0177 | 02-14-1995 | U | I | 1 | A | | | | | 1010 | 10,600 | | | |
| BOUDREAU, PHILIP MICHAEL | | 9557 0175 | 02-14-1995 | U | I | 1 | A | Total | | 455,100 | Total | | 362,200 | | | |
| | | | | | | | | Total | | 323,900 | Total | | 323,900 | | | |
| EXEMPTIONS | | | OTHER ASSESSMENTS | | | | This signature acknowledges a visit by a Data Collector or Assessor | | | | | | | | | |
| Year | Code | Description | Amount | Code | Description | Number | Amount | Comm Int | | | | | | | | |
| Total | | 0.00 | | | | | | | | | | | | | | |
| ASSESSING NEIGHBORHOOD | | | | | | | | | | | | | | | | |
| Nbhd | | Nbhd Name | | B | | Tracing | | Batch | | | | | | | | |
| 0107 | | | | | | | | CENVIL | | | | | | | | |
| NOTES | | | | | | | | | | | | | | | | |
| | | | | | | | | | | | | | | | | |
| BUILDING PERMIT RECORD | | | | | | | | | | | | | | | | |
| Permit Id | Issue Date | Type | Description | Amount | Insp Date | % Comp | Date Comp | Comments | Date | Id | Type | Is | Cd | Purpost/Result | | |
| 16903 | 07-29-1996 | AD | Addition | 8,500 | 07-21-1997 | 100 | 01-01-1997 | | 02-16-2023 | TR | 22 | | 22 | Change of Address | | |
| | | | | | | | | | 04-21-2020 | WD | | | FR | Field Review | | |
| | | | | | | | | | 03-01-2018 | SR | 02 | | 03 | Cycl Insp Comp | | |
| LAND LINE VALUATION SECTION | | | | | | | | | | | | | | | | |
| B | Use Code | Description | Zone | LA | Land Units | Unit Price | Size Adj | AC Disc | Site Index | Cond. | Nbhd. | Nbhd. Adj | Notes | Location Adjustmen | Adj Unit P | Land Value |
| 1 | 1010 | Single Fam M-0 | RD- | 3 | 0.340 AC | 176,344.00 | 2.53383 | 1.0000 | 5 | 1.00 | 0107 | 1.400 | | | 1.0000 | 625,562.7 |
| Total Card Land Units | | | | | 0.34 | AC | Parcel Total Land Area | | | | | 0.34 | Total Land Value | | | 212,700 |

| CONSTRUCTION DETAIL | | | CONSTRUCTION DETAIL (CONTINUED) | | |
|---------------------|----|----------------|---------------------------------|----|-------------|
| Element | Cd | Description | Element | Cd | Description |
| Style | 01 | Ranch | | | |
| Model | 01 | Residential | | | |
| Grade: | C | Average | | | |
| Stories | 1 | 1 Story | | | |
| Exterior Wall 1 | 14 | Wood Shingle | | | |
| Exterior Wall 2 | | | | | |
| RooF Structure | 03 | Gable/Hip | | | |
| RooF Cover | 03 | Asph/F Gls/Cmp | | | |
| Interior Wall 1 | 05 | Drywall | | | |
| Interior Wall 2 | | | | | |
| Interior Floor 1 | 12 | Hardwood | | | |
| Interior Floor 2 | | | | | |
| Heat Fuel | 02 | Oil | | | |
| Heat Type | 05 | Hot Water | | | |
| AC Type | 01 | None | | | |
| Bedrooms | 02 | 2 Bedrooms | | | |
| Full Baths | 2 | | | | |
| Half Baths | 0 | | | | |
| Extra Fixtures | | | | | |
| Total Rooms | 5 | 5 Rooms | | | |
| Bath Style | | | | | |
| Kitchen Style | | | | | |
| Occupancy | | | | | |
| Usrflid 105 | | | | | |
| Accessory Apt | | | | | |
| Foundation Alt | 02 | Conc. Block | | | |
| Rms Prts | | | | | |
| Bath Split | 20 | 2 Full-0 Half | | | |

| CONDO DATA | | | |
|-------------|------|-------------|----------|
| Parcel Id | | C | Ownr 0.0 |
| | | B | S |
| Adjust Type | Code | Description | Factor% |
| Condo Flr | | | |
| Condo Unit | | | |

| COST / MARKET VALUATION | |
|--------------------------|---------|
| Building Value New | 379,100 |
| Year Built | 1950 |
| Effective Year Built | 1981 |
| Depreciation Code | A |
| Remodel Rating | |
| Year Remodeled | |
| Depreciation % | 30 |
| Functional Obsol | 0 |
| External Obsol | 0 |
| Trend Factor | 1 |
| Condition | |
| Condition % | |
| Percent Good | 70 |
| RCNLD | 265,400 |
| Dep % Ovr | |
| Dep Ovr Comment | |
| Misc Imp Ovr | |
| Misc Imp Ovr Comment | |
| Cost to Cure Ovr | |
| Cost to Cure Ovr Comment | |

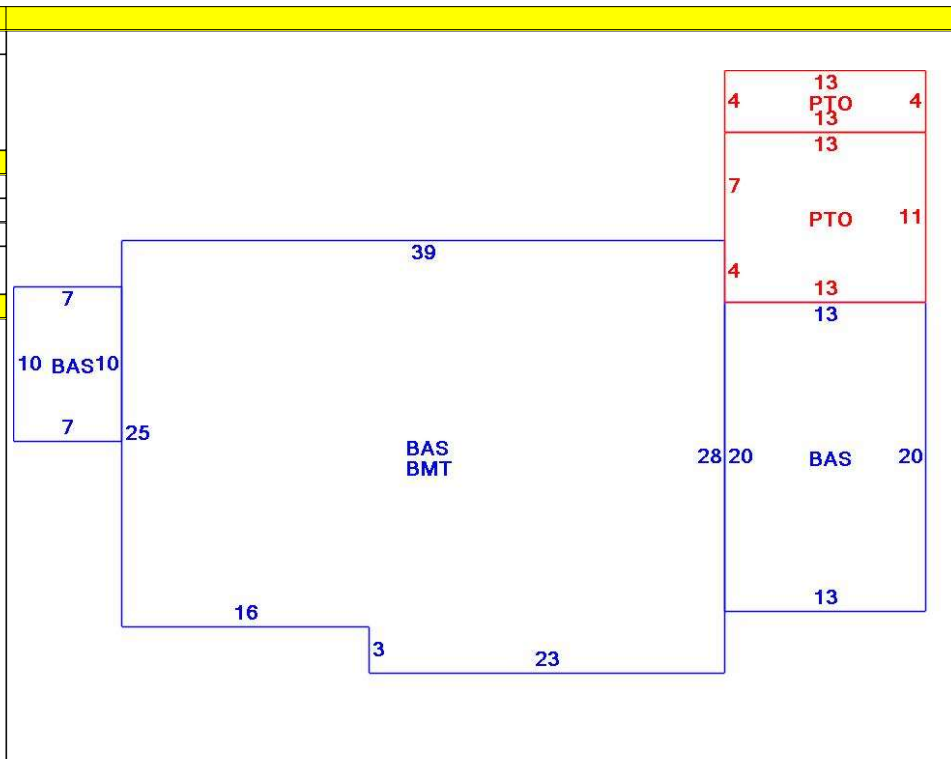

| OB - OUTBUILDING & YARD ITEMS(L) / XF - BUILDING EXTRA FEATURES(B) | | | | | | | | | | |
|--|-----------------|-----|-------|------------|--------|----------|------|-------|------------|-------------|
| Code | Description | L/B | Units | Unit Price | Yr Blt | Cond. Cd | % Gd | Grade | Grade Adj. | Appr. Value |
| FPL1 | Fireplace 1 sto | B | 1 | 5000.00 | 1983 | | 70 | | 0.00 | 3,500 |
| FGR2 | Garage- Avg- | L | 264 | 50.00 | 1990 | | 71 | 00 | 1.00 | 9,400 |
| FPO | Ext FP Openin | B | 1 | 2000.00 | 1983 | | 70 | | 0.00 | 1,400 |
| BRR | Bsmt Rec Rm- | B | 700 | 8.05 | 1983 | | 70 | | 0.00 | 3,900 |
| PAT1 | Patio- Average | L | 143 | 5.89 | 1990 | | 71 | | 0.00 | 700 |
| BMT | Basement-Unfi | B | 1,044 | 26.01 | 1983 | | 70 | | 0.00 | 19,100 |
| PAT2 | Patio-Good | L | 52 | 9.94 | 1990 | | 71 | | 0.00 | 500 |

| BUILDING SUB-AREA SUMMARY SECTION | | | | | | |
|-----------------------------------|---------------|-------------|------------|----------|-----------|----------------|
| Code | Description | Living Area | Floor Area | Eff Area | Unit Cost | Undeprec Value |
| BAS | First Floor | 1,374 | 1,374 | 1,374 | 275.91 | 379,100 |
| BMT | Basement Area | 0 | 1,044 | 0 | 0.00 | 0 |
| PTO | Patio | 0 | 195 | 0 | 0.00 | 0 |
| Ttl Gross Liv / Lease Area | | 1,374 | 2,613 | 1,374 | | 379,100 |

