

| CURRENT OWNER   |  | TOPO    | UTILITIES      | STRT / ROAD   | LOCATION | CURRENT ASSESSMENT |      |          |          | 801<br>FY2024<br>BARNSTABLE, MA<br><br><b>VISION</b> |
|---|--|---------|----------------|---|----------|--------------------|------|----------|----------|--|
| RUSSELL, MARGARET M<br><br>46 OLD TOWN ROAD<br><br>HYANNIS MA 02601                                       |  | 1 Level | 2 Public Water | 1 Paved   |          | Description        | Code | Assessed | Assessed |  |
|   |  |         | 4 Gas          |   |          | RESIDNTL           | 1010 | 197,100  | 197,100  |  |
|   |  |         | 6 Septic       |   |          | RES LAND           | 1010 | 132,700  | 132,700  |  |
| <b>SUPPLEMENTAL DATA</b>  |  |         |                |   |          | Total              |      |          |          | 329,800  |
| Alt Prcl ID<br>Split Zonin<br>BID Parcel<br>ResExpt Q<br>#DL 1 LOT 38<br>#DL 2<br>GIS ID F_980644_2696450 |  |         |                | Plan Ref. 17/49<br>Land Ct#<br>#SR<br>Life Estate<br>PP STATU<br>Assoc Pid# |          |                    |      |          |          |  |

| RECORD OF OWNERSHIP        |  | BK-VOL/PAGE | SALE DATE  | Q/U | V/I | SALE PRIC | VC | PREVIOUS ASSESSMENTS (HISTORY) |      |          |       |      |          |       |      |          |
|----------------------------|--|-------------|------------|-----|-----|-----------|----|--------------------------------|------|----------|-------|------|----------|-------|------|----------|
| RUSSELL, MARGARET M        |  | 22600 0128  | 01-11-2008 | U   | I   | 192,500   | 1S | Year                           | Code | Assessed | Year  | Code | Assessed | Year  | Code | Assessed |
| RESIDENTIAL FUNDING CO LLC |  | 22582 0245  | 01-03-2008 | U   | I   | 288,900   | 1L | 2023                           | 1010 | 174,100  | 2022  | 1010 | 145,100  | 2021  | 1010 | 110,600  |
| CASSIDY, PATRICK L         |  | 18358 0115  | 03-25-2004 | Q   | I   | 230,000   | 00 |                                | 1010 | 120,700  |       | 1010 | 89,400   |       | 1010 | 89,400   |
| DRINKWATER, BYRON A ET AL  |  | 11930 0185  | 12-21-1998 |     |     | 0         |    |                                |      |          |       |      |          |       | 1010 | 4,900    |
| DRINKWATER, BYRON A        |  | 7374 0192   | 12-15-1990 | U   | I   | 1         | A  | Total                          |      | 294,800  | Total |      | 234,500  | Total |      | 204,900  |

| EXEMPTIONS |      |             | OTHER ASSESSMENTS |      |             |        |        |          |
|------------|------|-------------|-------------------|------|-------------|--------|--------|----------|
| Year       | Code | Description | Amount            | Code | Description | Number | Amount | Comm Int |
| Total      |      |             | 0.00              |      |             |        |        |          |

| ASSESSING NEIGHBORHOOD |           |   |               |
|------------------------|-----------|---|---------------|
| Nbhd                   | Nbhd Name | B | Tracing       |
| 0105                   |           |   | Batch<br>HYAN |

| NOTES   |  |  |         |
|---|--|--|---------|
| This signature acknowledges a visit by a Data Collector or Assessor |  |  |         |
| APPRAISED VALUE SUMMARY   |  |  |         |
| Appraised Bldg. Value (Card)  |  |  | 181,700 |
| Appraised Xf (B) Value (Bldg)                                       |  |  | 9,200   |
| Appraised Ob (B) Value (Bldg)                                       |  |  | 6,200   |
| Appraised Land Value (Bldg)   |  |  | 132,700 |
| Special Land Value  |  |  | 0       |
| Total Appraised Parcel Value  |  |  | 329,800 |
| Valuation Method  |  |  | C       |
| Total Appraised Parcel Value  |  |  | 329,800 |

| BUILDING PERMIT RECORD |            |      |             |        |           |        |           | VISIT / CHANGE HISTORY       |            |    |      |    |    |                            |  |
|------------------------|------------|------|-------------|--------|-----------|--------|-----------|------------------------------|------------|----|------|----|----|----------------------------|--|
| Permit Id              | Issue Date | Type | Description | Amount | Insp Date | % Comp | Date Comp | Comments                     | Date       | Id | Type | Is | Cd | Purpost/Result             |  |
| 19-348                 | 02-01-2019 | 822  | Insulation  | 2,200  |           | 100    |           | Basement Ceiling R19 FG batt | 10-14-2020 | SR | 01   |    | 03 | Cycl Insp Comp             |  |
|                        |            |      |             |        |           |        |           |                              | 05-21-2020 | WD |      |    | FR | Field Review               |  |
|                        |            |      |             |        |           |        |           |                              | 05-28-2014 | NF | 03   |    | 16 | In Office Review           |  |
|                        |            |      |             |        |           |        |           |                              | 01-21-2014 | JR | 03   |    | 16 | In Office Review           |  |
|                        |            |      |             |        |           |        |           |                              | 08-29-2012 | DR | 22   |    | 22 | Change of Address          |  |
|                        |            |      |             |        |           |        |           |                              | 07-11-2003 | PT | 02   |    | 01 | Meas/Est                   |  |
|                        |            |      |             |        |           |        |           |                              | 01-02-2002 | PT | 01   |    | 00 | Meas/Listed-Interior Acces |  |

| LAND LINE VALUATION SECTION |          |                |      |    |            |            |                        |         |            |       |       |           |                  |                    |            |            |
|-----------------------------|----------|----------------|------|----|------------|------------|------------------------|---------|------------|-------|-------|-----------|------------------|--------------------|------------|------------|
| B                           | Use Code | Description    | Zone | LA | Land Units | Unit Price | Size Adj               | AC Disc | Site Index | Cond. | Nbhd. | Nbhd. Adj | Notes            | Location Adjustmen | Adj Unit P | Land Value |
| 1                           | 1010     | Single Fam M-0 | RB   | 4  | 0.120 AC   | 176,344.00 | 6.27199                | 1.0000  | 5          | 1.00  | 0105  | 1.000     |                  | 1.0000             | 1,106,029  | 132,700    |
| Total Card Land Units       |          |                |      |    | 0.12       | AC         | Parcel Total Land Area |         |            |       |       | 0.12      | Total Land Value |                    |            | 132,700    |

| CONSTRUCTION DETAIL |      |                | CONSTRUCTION DETAIL (CONTINUED) |    |             |
|---------------------|------|----------------|---------------------------------|----|-------------|
| Element             | Cd   | Description    | Element                         | Cd | Description |
| Style               | 04   | Cape Cod       |                                 |    |             |
| Model               | 01   | Residential    |                                 |    |             |
| Grade:              | C    | Average        |                                 |    |             |
| Stories             | 1.15 | 1 Story w/FAT  |                                 |    |             |
| Exterior Wall 1     | 14   | Wood Shingle   |                                 |    |             |
| Exterior Wall 2     |      |                |                                 |    |             |
| Roof Structure      | 03   | Gable/Hip      |                                 |    |             |
| Roof Cover          | 03   | Asph/F Gls/Cmp |                                 |    |             |
| Interior Wall 1     | 05   | Drywall        |                                 |    |             |
| Interior Wall 2     |      |                |                                 |    |             |
| Interior Floor 1    | 12   | Hardwood       |                                 |    |             |
| Interior Floor 2    |      |                |                                 |    |             |
| Heat Fuel           | 03   | Gas            |                                 |    |             |
| Heat Type           | 04   | Hot Air        |                                 |    |             |
| AC Type             | 03   | Central        |                                 |    |             |
| Bedrooms            | 02   | 2 Bedrooms     |                                 |    |             |
| Full Baths          | 1    |                |                                 |    |             |
| Half Baths          | 0    |                |                                 |    |             |
| Extra Fixtures      |      |                |                                 |    |             |
| Total Rooms         | 5    | 5 Rooms        |                                 |    |             |
| Bath Style          |      |                |                                 |    |             |
| Kitchen Style       |      |                |                                 |    |             |
| Occupancy           |      |                |                                 |    |             |
| Usrflid 105         |      |                |                                 |    |             |
| Accessory Apt       |      |                |                                 |    |             |
| Foundation Alt      | 08   | Mixed          |                                 |    |             |
| Rms Prts            |      |                |                                 |    |             |
| Bath Split          | 10   | 1 Full-0 Half  |                                 |    |             |

| CONDO DATA  |      |             |          |
|-------------|------|-------------|----------|
| Parcel Id   |      | C           | Ownr 0.0 |
|             |      | B           | S        |
| Adjust Type | Code | Description | Factor%  |
| Condo Flr   |      |             |          |
| Condo Unit  |      |             |          |

| COST / MARKET VALUATION  |  |         |
|--------------------------|--|---------|
| Building Value New       |  | 248,839 |
| Year Built               |  | 1939    |
| Effective Year Built     |  | 1984    |
| Depreciation Code        |  | G       |
| Remodel Rating           |  |         |
| Year Remodeled           |  |         |
| Depreciation %           |  | 27      |
| Functional Obsol         |  | 0       |
| External Obsol           |  | 0       |
| Trend Factor             |  | 1       |
| Condition                |  |         |
| Condition %              |  |         |
| Percent Good             |  | 73      |
| RCNLD                    |  | 181,700 |
| Dep % Ovr                |  |         |
| Dep Ovr Comment          |  |         |
| Misc Imp Ovr             |  |         |
| Misc Imp Ovr Comment     |  |         |
| Cost to Cure Ovr         |  |         |
| Cost to Cure Ovr Comment |  |         |

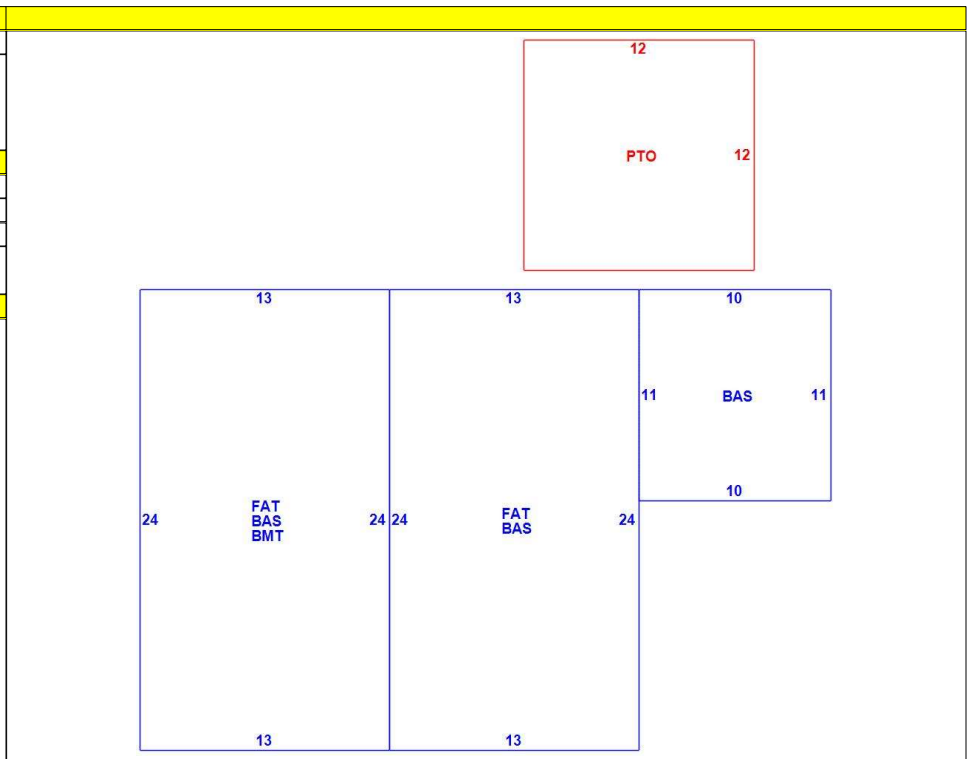

**OB - OUTBUILDING & YARD ITEMS(L) / XF - BUILDING EXTRA FEATURES(B)**

| Code | Description   | L/B | Units | Unit Price | Yr Blt | Cond. Cd | % Gd | Grade | Grade Adj. | Appr. Value |
|------|---------------|-----|-------|------------|--------|----------|------|-------|------------|-------------|
| BMT  | Basement-Unfi | B   | 312   | 26.01      | 1984   |          | 73   |       | 0.00       | 9,200       |
| GEN  | Emergency Ge  | L   | 1     | 5550.00    | 2013   |          | 88   |       | 0.00       | 4,900       |
| PAT2 | Patio-Good    | L   | 144   | 9.94       | 1996   |          | 77   |       | 0.00       | 1,300       |

**BUILDING SUB-AREA SUMMARY SECTION**

| Code                       | Description     | Living Area | Floor Area | Eff Area | Unit Cost | Undeprec Value |
|----------------------------|-----------------|-------------|------------|----------|-----------|----------------|
| BAS                        | First Floor     | 734         | 734        | 734      | 300.53    | 220,589        |
| BMT                        | Basement Area   | 0           | 312        | 0        | 0.00      | 0              |
| FAT                        | Attic, Finished | 94          | 624        | 94       | 45.27     | 28,250         |
| PTO                        | Patio           | 0           | 144        | 0        | 0.00      | 0              |
| Ttl Gross Liv / Lease Area |                 | 828         | 1,814      | 828      |           | 248,839        |

