

| CURRENT OWNER | | TOPO | UTILITIES | STRT / ROAD | LOCATION | CURRENT ASSESSMENT | | | | 801 FY2024 BARNSTABLE, MA VISION | |
|---|--|-------------|----------------|------------------|----------|--------------------|------|----------|----------|--|---------|
| SOARES, EMERSON D 34 OLD TOWN ROAD HYANNIS MA 02601 | | 1 Level | 2 Public Water | 1 Paved | | Description | Code | Assessed | Assessed | | |
| | | | 4 Gas | | | RESIDENTL | 1010 | 365,500 | 365,500 | | |
| | | | 6 Septic | | | RES LAND | 1010 | 149,000 | 149,000 | | |
| SUPPLEMENTAL DATA | | | | | | Total | | | | 514,500 | 514,500 |
| Alt Prcl ID | | Split Zonin | | Plan Ref. 176/37 | | | | | | | |
| BID Parcel | | ResExpt Q | | Land Ct# | | | | | | | |
| #DL 1 LOT 5 | | #DL 2 | | Life Estate | | | | | | | |
| GIS ID F_980720_2696384 | | Assoc Pid# | | | | | | | | | |

| RECORD OF OWNERSHIP | | BK-VOL/PAGE | SALE DATE | Q/U | V/I | SALE PRIC | VC | PREVIOUS ASSESSMENTS (HISTORY) | | | | | |
|---------------------------------|--|-------------|------------|-----|-----|-----------|----|--------------------------------|------|----------|-------|------|----------|
| SOARES, EMERSON D | | 27547 0022 | 07-16-2013 | Q | I | 265,000 | 00 | Year | Code | Assessed | Year | Code | Assessed |
| EFTIMIADDES, MARIA | | 24231 0120 | 12-11-2009 | U | I | 210,000 | 1 | 2023 | 1010 | 317,600 | 2022 | 1010 | 273,200 |
| QUARENTEI, GUARACI | | 20979 0188 | 05-08-2006 | Q | I | 367,000 | 00 | | 1010 | 135,400 | | 1010 | 100,300 |
| SOUVE, NELSON J III & TARA J | | 12513 0223 | 08-31-1999 | Q | I | 138,000 | 00 | | | | | 1010 | 10,100 |
| RUSSELL, HAROLD & MARSHALSEA, B | | 3416 0134 | 12-31-1981 | U | | 0 | | Total | | 453,000 | Total | | 373,500 |
| | | | | | | | | Total | | | Total | | 323,700 |

| EXEMPTIONS | | | OTHER ASSESSMENTS | | | | | This signature acknowledges a visit by a Data Collector or Assessor | | | | | | |
|------------|------|-------------|-------------------|------|-------------|--------|--------|---|-----|--|--|--|--|--|
| Year | Code | Description | Amount | Code | Description | Number | Amount | Comm | Int | | | | | |
| Total | | | 0.00 | | | | | | | | | | | |

| ASSESSING NEIGHBORHOOD | | | | APPRAISED VALUE SUMMARY | | | | | |
|------------------------|-----------|---|---------|-------------------------|--|--|--|--|--|
| Nbhd | Nbhd Name | B | Tracing | Batch | | | | | |
| 0105 | | | | HYAN | | | | | |

| NOTES | | | | | | | | | | APPRAISED VALUE SUMMARY | | | | | |
|-------|--|--|--|--|--|--|--|--|--|-------------------------------|--|--|--|--|---------|
| | | | | | | | | | | Appraised Bldg. Value (Card) | | | | | 326,000 |
| | | | | | | | | | | Appraised Xf (B) Value (Bldg) | | | | | 29,400 |
| | | | | | | | | | | Appraised Ob (B) Value (Bldg) | | | | | 10,100 |
| | | | | | | | | | | Appraised Land Value (Bldg) | | | | | 149,000 |
| | | | | | | | | | | Special Land Value | | | | | 0 |
| | | | | | | | | | | Total Appraised Parcel Value | | | | | 514,500 |
| | | | | | | | | | | Valuation Method | | | | | C |
| | | | | | | | | | | Total Appraised Parcel Value | | | | | 514,500 |

| BUILDING PERMIT RECORD | | | | | | | | | | VISIT / CHANGE HISTORY | | | | | |
|------------------------|------------|------|------------------|--------|------------|--------|------------|-------------------------------|--|------------------------|----|------|----|----|----------------------------|
| Permit Id | Issue Date | Type | Description | Amount | Insp Date | % Comp | Date Comp | Comments | | Date | Id | Type | Is | Cd | Purpost/Result |
| 18-640 | 03-26-2018 | 880 | Alt-Int work-Res | 9,350 | | 0 | 09-26-2018 | EXPIRED relocation the kitche | | 05-21-2020 | WD | | | FR | Field Review |
| 17-1138 | 05-31-2017 | 880 | Alt-Int work-Res | 9,350 | | 0 | 10-20-2017 | EXPIRED relocation of kitchen | | 06-30-2019 | TR | 03 | | 02 | Bldg Permit Completed |
| 201305636 | 08-21-2013 | NW | New Windows | 1,800 | 06-30-2014 | 100 | 06-30-2014 | 3 LARGE BMT WINDS | | 06-18-2018 | SR | 02 | | 13 | CALL BACK |
| B35555 | 12-01-1992 | AD | Addition | 14,500 | 01-15-1994 | 100 | 06-30-1994 | HY ADD'N | | 07-12-2017 | JR | 03 | | 16 | In Office Review |
| B30064 | 10-01-1986 | AD | Addition | 12,500 | 01-15-1988 | 100 | 06-30-1988 | HY ADD'N | | 05-21-2009 | TP | 03 | | 16 | In Office Review |
| | | | | | | | | | | 07-11-2003 | PT | 02 | | 01 | Meas/Est |
| | | | | | | | | | | 01-02-2002 | PT | 01 | | 00 | Meas/Listed-Interior Acces |

| LAND LINE VALUATION SECTION | | | | | | | | | | | | | | | | |
|-----------------------------|----------|----------------|------|----|------------|------------|------------------------|---------|------------|-------|-------|-----------|------------------|--------------------|------------|------------|
| B | Use Code | Description | Zone | LA | Land Units | Unit Price | Size Adj | AC Disc | Site Index | Cond. | Nbhd. | Nbhd. Adj | Notes | Location Adjustmen | Adj Unit P | Land Value |
| 1 | 1010 | Single Fam M-0 | RB | 4 | 0.250 AC | 176,344.00 | 3.37919 | 1.0000 | 5 | 1.00 | 0105 | 1.000 | | 1.0000 | 595,901.6 | 149,000 |
| Total Card Land Units | | | | | 0.25 | AC | Parcel Total Land Area | | | | | 0.25 | Total Land Value | | | 149,000 |

| CONSTRUCTION DETAIL | | | CONSTRUCTION DETAIL (CONTINUED) | | |
|---------------------|----|----------------|---------------------------------|----|-------------|
| Element | Cd | Description | Element | Cd | Description |
| Style | 01 | Ranch | | | |
| Model | 01 | Residential | | | |
| Grade: | C | Average | | | |
| Stories | 1 | 1 Story | | | |
| Exterior Wall 1 | 14 | Wood Shingle | | | |
| Exterior Wall 2 | 11 | Clapboard | | | |
| RooF Structure | 03 | Gable/Hip | | | |
| RooF Cover | 03 | Asph/F Gls/Cmp | | | |
| Interior Wall 1 | 05 | Drywall | | | |
| Interior Wall 2 | | | | | |
| Interior Floor 1 | 12 | Hardwood | | | |
| Interior Floor 2 | | | | | |
| Heat Fuel | 03 | Gas | | | |
| Heat Type | 05 | Hot Water | | | |
| AC Type | 01 | None | | | |
| Bedrooms | 03 | 3 Bedrooms | | | |
| Full Baths | 2 | | | | |
| Half Baths | 0 | | | | |
| Extra Fixtures | | | | | |
| Total Rooms | 5 | 5 Rooms | | | |
| Bath Style | | | | | |
| Kitchen Style | | | | | |
| Occupancy | | | | | |
| Usrflid 105 | | | | | |
| Accessory Apt | | | | | |
| Foundation Alt | 01 | Poured Conc. | | | |
| Rms Prts | | | | | |
| Bath Split | 20 | 2 Full-0 Half | | | |

| CONDO DATA | | | |
|-------------|------|-------------|----------|
| Parcel Id | | C | Owne 0.0 |
| | | B | S |
| Adjust Type | Code | Description | Factor% |
| Condo Flr | | | |
| Condo Unit | | | |

| COST / MARKET VALUATION | |
|--------------------------|---------|
| Building Value New | 417,927 |
| Year Built | 1971 |
| Effective Year Built | 1991 |
| Depreciation Code | A |
| Remodel Rating | |
| Year Remodeled | |
| Depreciation % | 22 |
| Functional Obsol | 0 |
| External Obsol | 0 |
| Trend Factor | 1 |
| Condition | |
| Condition % | |
| Percent Good | 78 |
| RCNLD | 326,000 |
| Dep % Ovr | |
| Dep Ovr Comment | |
| Misc Imp Ovr | |
| Misc Imp Ovr Comment | |
| Cost to Cure Ovr | |
| Cost to Cure Ovr Comment | |

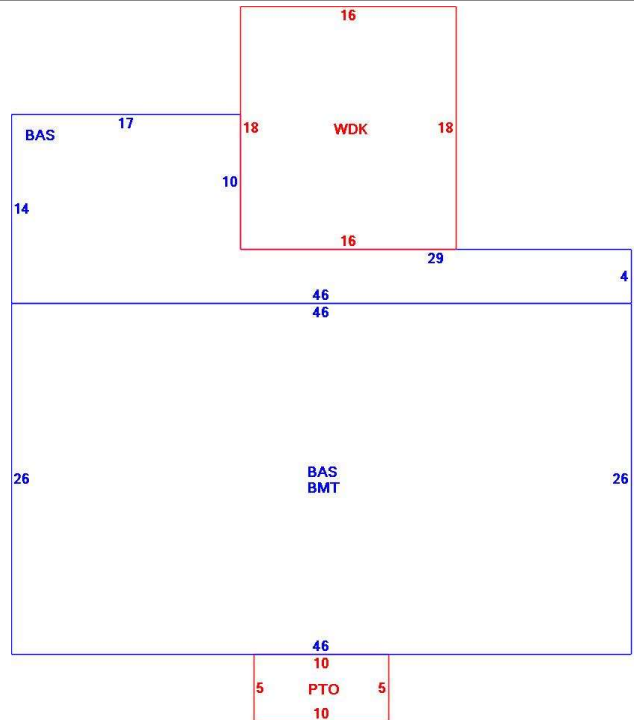

| OB - OUTBUILDING & YARD ITEMS(L) / XF - BUILDING EXTRA FEATURES(B) | | | | | | | | | | |
|--|-----------------|-----|-------|------------|--------|----------|------|-------|------------|-------------|
| Code | Description | L/B | Units | Unit Price | Yr Blt | Cond. Cd | % Gd | Grade | Grade Adj. | Appr. Value |
| BRR | Bsmt Rec Rm- | B | 352 | 8.05 | 1993 | | 78 | | 0.00 | 2,200 |
| FPL1 | Fireplace 1 sto | B | 1 | 5000.00 | 1993 | | 78 | | 0.00 | 3,900 |
| WDC | Wood Deck w/ | L | 288 | 18.00 | 1996 | | 54 | | 0.00 | 2,800 |
| BMT | Basement-Unfi | B | 1,196 | 26.01 | 1993 | | 78 | | 0.00 | 23,300 |
| SHED | Shed | L | 192 | 18.00 | 2017 | | 96 | | 0.00 | 3,300 |
| WDC | Wood Deck w/ | L | 50 | 18.00 | 2017 | | 96 | | 0.00 | 2,400 |
| SHED | Shed | L | 36 | 18.00 | 2017 | | 96 | | 0.00 | 600 |
| PATC | Conc Pavers | L | 50 | 15.46 | 2017 | | 98 | | 0.00 | 1,000 |

| BUILDING SUB-AREA SUMMARY SECTION | | | | | | |
|-----------------------------------|---------------|-------------|------------|----------|-----------|----------------|
| Code | Description | Living Area | Floor Area | Eff Area | Unit Cost | Undeprec Value |
| BAS | First Floor | 1,550 | 1,550 | 1,550 | 269.63 | 417,927 |
| BMT | Basement Area | 0 | 1,196 | 0 | 0.00 | 0 |
| PTO | Patio | 0 | 50 | 0 | 0.00 | 0 |
| WDK | Wood Deck | 0 | 288 | 0 | 0.00 | 0 |
| Ttl Gross Liv / Lease Area | | 1,550 | 3,084 | 1,550 | | 417,927 |

