

| CURRENT OWNER | | TOPO | | UTILITIES | | STRT / ROAD | | LOCATION | | CURRENT ASSESSMENT | | | |
|---|--|------------------|-------|------------|--------------|-------------|-------|----------|--|--------------------|------|----------|----------|
| FERRIE, TRACY & MARYBETH 35 HEAD OF THE POND LN MARSTONS MIL MA 02648 | | 1 | Level | 2 | Public Water | 1 | Paved | | | Description | Code | Assessed | Assessed |
| | | | | 4 | Gas | | | | | RESIDENTL | 1010 | 385,300 | 385,300 |
| | | | | 6 | Septic | | | | | RES LAND | 1010 | 166,700 | 166,700 |
| SUPPLEMENTAL DATA | | | | | | | | | | Total | | 552,000 | 552,000 |
| Alt Prcl ID | | Split Zonin | | Plan Ref. | | 249/79 | | | | | | | |
| BID Parcel | | ResExpt Q | | INFO: | | Life Estate | | PP STATU | | | | | |
| #DL 1 | | LOT 25 | | | | | | | | | | | |
| #DL 2 | | | | | | | | | | | | | |
| GIS ID | | F_943471_2707301 | | Assoc Pid# | | | | | | | | | |

801
 FY2024
 BARNSTABLE, MA

VISION

| RECORD OF OWNERSHIP | | BK-VOL/PAGE | | SALE DATE | | Q/U | | V/I | | SALE PRIC | | VC | | PREVIOUS ASSESSMENTS (HISTORY) | | | | | | |
|-----------------------------|--|-------------|------|------------|--|-----|---|---------|--|-----------|--|---------|-------|--------------------------------|-------|---------|----------|------|------|----------|
| CAMERON, TRISTAN M & SYDNEY | | 35849 | 273 | 06-20-2023 | | Q | I | 584,900 | | 00 | | Year | Code | Assessed | Year | Code | Assessed | Year | Code | Assessed |
| FERRIE, TRACY & MARYBETH | | 19243 | 0171 | 11-15-2004 | | Q | I | 258,100 | | 00 | | 2023 | 1010 | 313,700 | 2022 | 1010 | 273,500 | 2021 | 1010 | 221,700 |
| GUAY, SUSAN M | | 10412 | 0116 | 09-30-1996 | | Q | I | 92,500 | | 00 | | | 1010 | 151,600 | | 1010 | 112,300 | | 1010 | 112,300 |
| WILSON, EDITH C | | 3321 | 0055 | 07-10-1981 | | U | | 0 | | 00 | | | | | | | | | 1010 | 2,600 |
| Total | | | | | | | | | | | | 465,300 | Total | 385,800 | Total | 336,600 | | | | |

| EXEMPTIONS | | | | OTHER ASSESSMENTS | | | | This signature acknowledges a visit by a Data Collector or Assessor | | | | | | | | | | | |
|------------|------|--------------------------|--------|-------------------|-------------|--------|--------|---|--|--|--|--|--|--|--|--|--|--|--|
| Year | Code | Description | Amount | Code | Description | Number | Amount | | | | | | | | | | | | |
| 2024 | N5C | NO RESIDENTIAL EXEMPTION | 0.00 | | | | | | | | | | | | | | | | |
| Total | | | 0.00 | | | | | | | | | | | | | | | | |

| ASSESSING NEIGHBORHOOD | | | | APPRAISED VALUE SUMMARY | | | |
|-------------------------------|-----------|---|---------|-------------------------|--|--|--|
| Nbhd | Nbhd Name | B | Tracing | Batch | | | |
| 0105 | | | MARSTM | | | | |
| Appraised Bldg. Value (Card) | | | | 342,600 | | | |
| Appraised Xf (B) Value (Bldg) | | | | 39,300 | | | |
| Appraised Ob (B) Value (Bldg) | | | | 3,400 | | | |
| Appraised Land Value (Bldg) | | | | 166,700 | | | |
| Special Land Value | | | | 0 | | | |
| Total Appraised Parcel Value | | | | 552,000 | | | |
| Valuation Method | | | | C | | | |
| Total Appraised Parcel Value | | | | 552,000 | | | |

| NOTES | | | | | | | | VISIT / CHANGE HISTORY | | | | | | | |
|-------|--|--|--|--|--|--|--|------------------------|----|------|----|----|----------------------------|--|--|
| | | | | | | | | Date | Id | Type | Is | Cd | Purpost/Result | | |
| | | | | | | | | 11-30-2022 | DB | 01 | | 03 | Cycl Insp Comp | | |
| | | | | | | | | 05-19-2020 | LS | | | FR | Field Review | | |
| | | | | | | | | 09-26-2014 | SR | 02 | | 03 | Cycl Insp Comp | | |
| | | | | | | | | 02-24-2011 | RB | 03 | | 16 | In Office Review | | |
| | | | | | | | | 01-19-2011 | MK | 01 | | 52 | New Construction | | |
| | | | | | | | | 05-17-2005 | PT | 02 | | 01 | Meas/Est | | |
| | | | | | | | | 02-16-1999 | DD | 01 | | 00 | Meas/Listed-Interior Acces | | |

| BUILDING PERMIT RECORD | | | | | | | | LAND LINE VALUATION SECTION | | | | | | | | |
|------------------------|------------|------|-------------|--------|------------|--------|------------|-----------------------------|------------|----|------|----|----------------------------|------------------|--|--|
| Permit Id | Issue Date | Type | Description | Amount | Insp Date | % Comp | Date Comp | Comments | Date | Id | Type | Is | Cd | Purpost/Result | | |
| 201205689 | 09-14-2012 | OT | Other | 1,632 | 06-30-2013 | 100 | 06-30-2013 | 8' CEDAR FNC 56LF | 11-30-2022 | DB | 01 | | 03 | Cycl Insp Comp | | |
| 201006950 | 12-23-2010 | IN | Insulation | 5,000 | 06-30-2011 | 100 | 06-30-2011 | INSULATE-WEATHERIZATIO | 05-19-2020 | LS | | | FR | Field Review | | |
| 201005659 | 10-29-2010 | WD | Wood Deck | 3,000 | 01-19-2011 | 100 | 06-30-2011 | 16X14 DECK | 09-26-2014 | SR | 02 | | 03 | Cycl Insp Comp | | |
| 201002952 | 08-10-2010 | AD | Addition | 30,000 | 01-19-2011 | 100 | 06-30-2011 | 16X 20 FAMILY ROOM ADDIT | 02-24-2011 | RB | 03 | | 16 | In Office Review | | |
| 90036 | 01-30-2006 | NR | New Roof | 10,000 | 12-31-2006 | 100 | 12-31-2006 | REROOF STRIPPING OLD | 01-19-2011 | MK | 01 | | 52 | New Construction | | |
| B19868 | 12-01-1977 | DW | Dwelling | 0 | 01-15-1979 | 100 | 06-30-1979 | MM 1 STOR | 05-17-2005 | PT | 02 | | 01 | Meas/Est | | |
| | | | | | | | | 02-16-1999 | DD | 01 | | 00 | Meas/Listed-Interior Acces | | | |

| B | Use Code | Description | Zone | LA | Land Units | Unit Price | Size Adj | AC Disc | Site Index | Cond. | Nbhd. | Nbhd. Adj | Notes | Location Adjustmen | Adj Unit P | Land Value | | |
|-----------------------|----------|----------------|------|----|------------|------------|------------------------|---------|------------|-------|-------|-----------|------------------|--------------------|------------|------------|---------|---------|
| 1 | 1010 | Single Fam M-0 | RF | 3 | 0.630 | AC | 176,344.00 | 1.50069 | 1.0000 | 5 | 1.00 | 0105 | 1.000 | | 1.0000 | 264,639.4 | 166,700 | |
| Total Card Land Units | | | | | 0.63 | AC | Parcel Total Land Area | | | | | 0.63 | Total Land Value | | | | | 166,700 |

| CONSTRUCTION DETAIL | | | CONSTRUCTION DETAIL (CONTINUED) | | |
|---------------------|----|----------------|---------------------------------|----|-------------|
| Element | Cd | Description | Element | Cd | Description |
| Style | 01 | Ranch | | | |
| Model | 01 | Residential | | | |
| Grade: | C | Average | | | |
| Stories | 1 | 1 Story | | | |
| Exterior Wall 1 | 11 | Clapboard | | | |
| Exterior Wall 2 | 14 | Wood Shingle | | | |
| Roof Structure | 03 | Gable/Hip | | | |
| Roof Cover | 03 | Asph/F Gls/Cmp | | | |
| Interior Wall 1 | 05 | Drywall | | | |
| Interior Wall 2 | | | | | |
| Interior Floor 1 | 14 | Carpet | | | |
| Interior Floor 2 | | | | | |
| Heat Fuel | 02 | Oil | | | |
| Heat Type | 05 | Hot Water | | | |
| AC Type | 03 | Central | | | |
| Bedrooms | 03 | 3 Bedrooms | | | |
| Full Baths | 2 | | | | |
| Half Baths | 0 | | | | |
| Extra Fixtures | | | | | |
| Total Rooms | 5 | 5 Rooms | | | |
| Bath Style | | | | | |
| Kitchen Style | | | | | |
| Occupancy | | | | | |
| Usrflid 105 | | | | | |
| Accessory Apt | | | | | |
| Foundation Alt | 01 | Poured Conc. | | | |
| Rms Prts | | | | | |
| Bath Split | 20 | 2 Full-0 Half | | | |

| CONDO DATA | | | |
|-------------|------|-------------|----------|
| Parcel Id | | C | Owne 0.0 |
| | | B | S |
| Adjust Type | Code | Description | Factor% |
| Condo Flr | | | |
| Condo Unit | | | |

| COST / MARKET VALUATION | |
|--------------------------|---------|
| Building Value New | 422,979 |
| Year Built | 1978 |
| Effective Year Built | 1995 |
| Depreciation Code | A |
| Remodel Rating | |
| Year Remodeled | |
| Depreciation % | 19 |
| Functional Obsol | 0 |
| External Obsol | 0 |
| Trend Factor | 1 |
| Condition | |
| Condition % | |
| Percent Good | 81 |
| RCNLD | 342,600 |
| Dep % Ovr | |
| Dep Ovr Comment | |
| Misc Imp Ovr | |
| Misc Imp Ovr Comment | |
| Cost to Cure Ovr | |
| Cost to Cure Ovr Comment | |

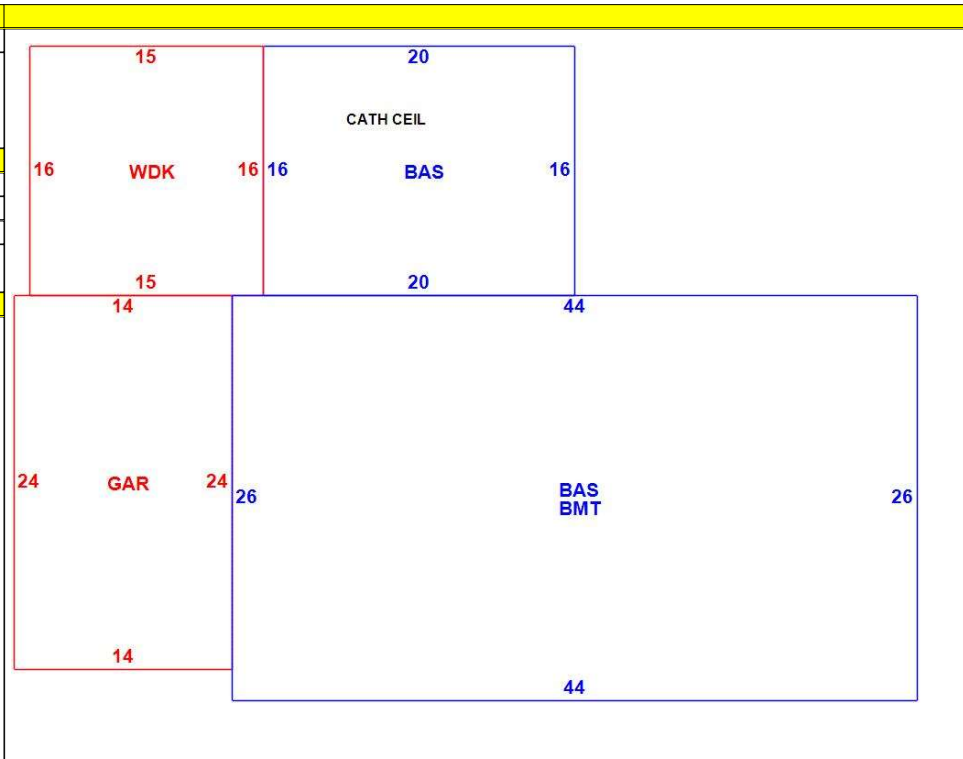

| OB - OUTBUILDING & YARD ITEMS(L) / XF - BUILDING EXTRA FEATURES(B) | | | | | | | | | | |
|--|-----------------|-----|-------|------------|--------|----------|------|-------|------------|-------------|
| Code | Description | L/B | Units | Unit Price | Yr Blt | Cond. Cd | % Gd | Grade | Grade Adj. | Appr. Value |
| FPL1 | Fireplace 1 sto | B | 1 | 5000.00 | 1997 | | 81 | | 0.00 | 4,100 |
| WDC | Wood Deck w/ | L | 240 | 18.00 | 1997 | | 56 | | 0.00 | 2,600 |
| GAR | Attached Gara | B | 336 | 40.00 | 1997 | | 81 | | 0.00 | 11,700 |
| BMT | Basement-Unfi | B | 1,144 | 26.01 | 1997 | | 81 | | 0.00 | 23,500 |
| SHED | Shed | L | 80 | 18.00 | 1997 | | 56 | | 0.00 | 800 |

| BUILDING SUB-AREA SUMMARY SECTION | | | | | | | |
|-----------------------------------|-----------------|-------------|------------|----------|-----------|----------------|--|
| Code | Description | Living Area | Floor Area | Eff Area | Unit Cost | Undeprec Value | |
| BAS | First Floor | 1,464 | 1,464 | 1,464 | 288.92 | 422,979 | |
| BMT | Basement Area | 0 | 1,144 | 0 | 0.00 | 0 | |
| GAR | Attached Garage | 0 | 336 | 0 | 0.00 | 0 | |
| WDC | Wood Deck | 0 | 240 | 0 | 0.00 | 0 | |
| Ttl Gross Liv / Lease Area | | 1,464 | 3,184 | 1,464 | | 422,979 | |