

CONSTRUCTION DETAIL			CONSTRUCTION DETAIL (CONTINUED)		
Element	Cd	Description	Element	Cd	Description
Style	01	Ranch			
Model	01	Residential			
Grade:	C	Average			
Stories	1	1 Story			
Exterior Wall 1	25	Vinyl Siding			
Exterior Wall 2					
RooF Structure	03	Gable/Hip			
RooF Cover	03	Asph/F Gls/Cmp			
Interior Wall 1	05	Drywall			
Interior Wall 2					
Interior Floor 1	12	Hardwood			
Interior Floor 2					
Heat Fuel	03	Gas			
Heat Type	05	Hot Water			
AC Type	03	Central			
Bedrooms	02	2 Bedrooms			
Full Baths	1				
Half Baths	0				
Extra Fixtures					
Total Rooms	5	5 Rooms			
Bath Style					
Kitchen Style					
Occupancy					
Usrflid 105					
Accessory Apt					
Foundation Alt	00	Typical			
Rms Prts					
Bath Split	10	1 Full-0 Half			

CONDO DATA				
Parcel Id		C	Owne	0.0
Adjust Type	Code	Description	Factor%	
Condo Flr				
Condo Unit				

COST / MARKET VALUATION		
Building Value New		345,087
Year Built		1967
Effective Year Built		1994
Depreciation Code		G
Remodel Rating		
Year Remodeled		
Depreciation %		19
Functional Obsol		0
External Obsol		0
Trend Factor		1
Condition		
Condition %		
Percent Good		81
RCNLD		279,500
Dep % Ovr		
Dep Ovr Comment		
Misc Imp Ovr		
Misc Imp Ovr Comment		
Cost to Cure Ovr		
Cost to Cure Ovr Comment		

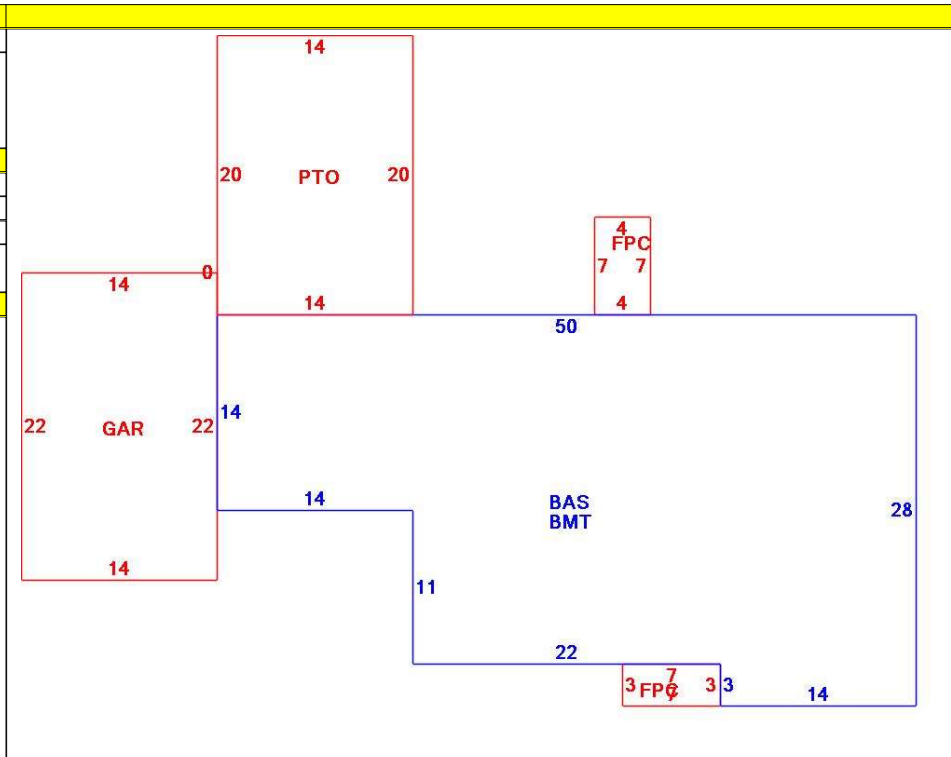

OB - OUTBUILDING & YARD ITEMS(L) / XF - BUILDING EXTRA FEATURES(B)

Code	Description	L/B	Units	Unit Price	Yr Blt	Cond. Cd	% Gd	Grade	Grade Adj.	Appr. Value
FPL1	Fireplace 1 sto	B	1	5000.00	1996		81		0.00	4,100
BRR	Bsmt Rec Rm-	B	800	8.05	1996		81		0.00	5,200
PAT1	Patio- Average	L	280	5.89	1995		76		0.00	1,300
GAR	Attached Gara	B	308	40.00	1996		81		0.00	11,000
BMT	Basement-Unfi	B	1,138	26.01	1996		81		0.00	23,400
FOPC	Open Prch-roo	B	49	55.00	1996		81		0.00	2,300

BUILDING SUB-AREA SUMMARY SECTION

Code	Description	Living Area	Floor Area	Eff Area	Unit Cost	Undeprec Value
BAS	First Floor	1,138	1,138	1,138	303.24	345,087
BMT	Basement Area	0	1,138	0	0.00	0
FPC	Open Porch Conc. Floor	0	49	0	0.00	0
GAR	Attached Garage	0	308	0	0.00	0
PTO	Patio	0	280	0	0.00	0
Ttl Gross Liv / Lease Area		1,138	2,913	1,138		345,087

