

| CURRENT OWNER | | TOPO | UTILITIES | STRT / ROAD | LOCATION | CURRENT ASSESSMENT | | | | | | | | | | | | |
|---|------------|---------------|-------------|-------------------|-------------|--|------------------------|---|--------------------------------------|--|----------|-----------|-------|--------------------|------------|------------|--|---|
| GAGOSIAN, WARREN E TR GAGOSIAN REALTY TRUST 555 HIGH STREET MEDFORD MA 02155 | | | | | | Description | Code | Assessed | Assessed | 801 FY2024 BARNSTABLE, MA VISION | | | | | | | | |
| | | | | | | RESIDNTL | 1020 | 219,700 | 219,700 | | | | | | | | | |
| SUPPLEMENTAL DATA | | | | | | | | | | | | | | | | | | |
| Alt Prcl ID Split Zonin RB;HB BID Parcel ResExpt Q #DL 1 UNIT 1A #DL 2 BLDG 1 GIS ID F_981034_2699932 | | | | | | Plan Ref. 369/35, 370/25 Land Ct# #SR Life Estate PP STATU Assoc Pid# | | | | | | | | | | | | |
| | | | | | | Total | | 219,700 | 219,700 | | | | | | | | | |
| RECORD OF OWNERSHIP | | | BK-VOL/PAGE | SALE DATE | Q/U | V/I | SALE PRICE | VC | PREVIOUS ASSESSMENTS (HISTORY) | | | | | | | | | |
| GAGOSIAN, WARREN E TR | | | 27748 0171 | 10-09-2013 | U | I | 10 | 1F | Year | Code | Assessed | Year | Code | Assessed | | | | |
| GAGOSIAN, WARREN E | | | 6872 0195 | 09-07-1989 | U | I | 1 | A | 2023 | 1020 | 170,600 | 2022 | 1020 | 133,100 | | | | |
| GAGOSIAN, PAULA & WARREN E | | | 3859 0215 | 09-13-1983 | Q | I | 35,000 | U | 2021 | 1020 | 1,200 | 2021 | 1020 | 127,700 | | | | |
| | | | | | | Total | | 170,600 | Total | 133,100 | Total | 128,900 | | | | | | |
| EXEMPTIONS | | | | OTHER ASSESSMENTS | | | | This signature acknowledges a visit by a Data Collector or Assessor | | | | | | | | | | |
| Year | Code | Description | Amount | Code | Description | Number | Amount | Comm Int | | | | | | | | | | |
| Total | | | 0.00 | | | | | | | | | | | | | | | |
| ASSESSING NEIGHBORHOOD | | | | | | | | APPRAISED VALUE SUMMARY | | | | | | | | | | |
| Nbhd | Nbhd Name | | | B | Tracing | | | Batch | Appraised Bldg. Value (Card) 210,300 | | | | | | | | | |
| 0001 | | | | | | | | HYAN | Appraised Xf (B) Value (Bldg) 8,200 | | | | | | | | | |
| NOTES | | | | | | | | Appraised Ob (B) Value (Bldg) 1,200 | | | | | | | | | | |
| | | | | | | | | Appraised Land Value (Bldg) 0 | | | | | | | | | | |
| | | | | | | | | Special Land Value 0 | | | | | | | | | | |
| | | | | | | | | Total Appraised Parcel Value 219,700 | | | | | | | | | | |
| | | | | | | | | Valuation Method C | | | | | | | | | | |
| | | | | | | | | Total Appraised Parcel Value 219,700 | | | | | | | | | | |
| BUILDING PERMIT RECORD | | | | | | | | VISIT / CHANGE HISTORY | | | | | | | | | | |
| Permit Id | Issue Date | Type | Description | Amount | Insp Date | % Comp | Date Comp | Comments | Date | Id | Type | Is | Cd | Purpost/Result | | | | |
| | | | | | | | | | 04-22-2020 | WD | | | FR | Field Review | | | | |
| | | | | | | | | | 12-07-2018 | SR | 02 | | 03 | Cycl Insp Comp | | | | |
| | | | | | | | | | 11-21-2013 | TP | 03 | | 16 | In Office Review | | | | |
| LAND LINE VALUATION SECTION | | | | | | | | | | | | | | | | | | |
| B | Use Code | Description | Zone | Dist | Land Type | Land Units | Unit Price | Size Adj | Site Index | Cond. | Nbhd. | Nbhd. Adj | Notes | Location Adjustmen | Adj Unit P | Land Value | | |
| 1 | 102U | Condominium M | SPLI | 4 | | 0 SF | 0.00 | 1.00000 | 5 | 1.00 | 0001 | 1.000 | | 0.0000 | 0 | 0 | | |
| Total Card Land Units | | | | | | 0 SF | Parcel Total Land Area | | | | | | 0.00 | Total Land Value | | | | 0 |

| CONSTRUCTION DETAIL | | | CONSTRUCTION DETAIL (CONTINUED) | | |
|--------------------------|------------|----------------|---------------------------------|-----|-------------|
| Element | Cd | Description | Element | Cd | Description |
| Style | 55 | Condominium | | | |
| Model | 05 | Res Condo | | | |
| Bedrm Func | C- | Average Minus | | | |
| Stories | 1 | 1 Story | | | |
| Occupancy | 0 | | | | |
| Interior Wall 1 | 05 | Drywall | | | |
| Interior Wall 2 | | | | | |
| Interior Floor 1 | 14 | Carpet | | | |
| Interior Floor 2 | | | | | |
| Heat Fuel | 04 | Electric | | | |
| Heat Type | 07 | Elec Baseboard | | | |
| AC Type | 01 | None | | | |
| Bedrooms | 02 | 2 Bedrooms | | | |
| Full Baths | 1 | 1 Full | | | |
| Half Baths | 0 | | | | |
| Extra Fixtures | | | | | |
| Total Rooms | 5 | 5 Rooms | | | |
| Bath Style | | | | | |
| Kitchen Style | | | | | |
| Master Deed L | 864 | | | | |
| Bath Split | 10 | 1 Full-0 Half | | | |
| Foundation | 01 | Poured Conc. | | | |
| AC Type Alt | | | | | |
| Sewer Occupan | | | | | |
| CONDO DATA | | | | | |
| Parcel Id | 104210 | C 0070 | Owne | 5.0 | |
| | PARK PLACE | B 1 | S 1 | | |
| Adjust Type | Code | Description | Factor% | | |
| Condo Flr | 1FU | FIRST FLOOR | 100 | | |
| Condo Unit | MKT0 | MKT0 | 150 | | |
| COST / MARKET VALUATION | | | | | |
| Building Value New | | 247,365 | | | |
| Year Built | | 1982 | | | |
| Effective Year Built | | 2000 | | | |
| Depreciation Code | | A | | | |
| Remodel Rating | | | | | |
| Year Remodeled | | 15 | | | |
| Depreciation % | | 0 | | | |
| Functional Obsol | | 0 | | | |
| External Obsol | | 0 | | | |
| Trend Factor | | 1 | | | |
| Condition | | | | | |
| Condition % | | 85 | | | |
| Percent Good | | 210,300 | | | |
| Cns Sect Rcnd | | | | | |
| Dep % Ovr | | | | | |
| Dep Ovr Comment | | | | | |
| Misc Imp Ovr | | | | | |
| Misc Imp Ovr Comment | | | | | |
| Cost to Cure Ovr | | | | | |
| Cost to Cure Ovr Comment | | | | | |

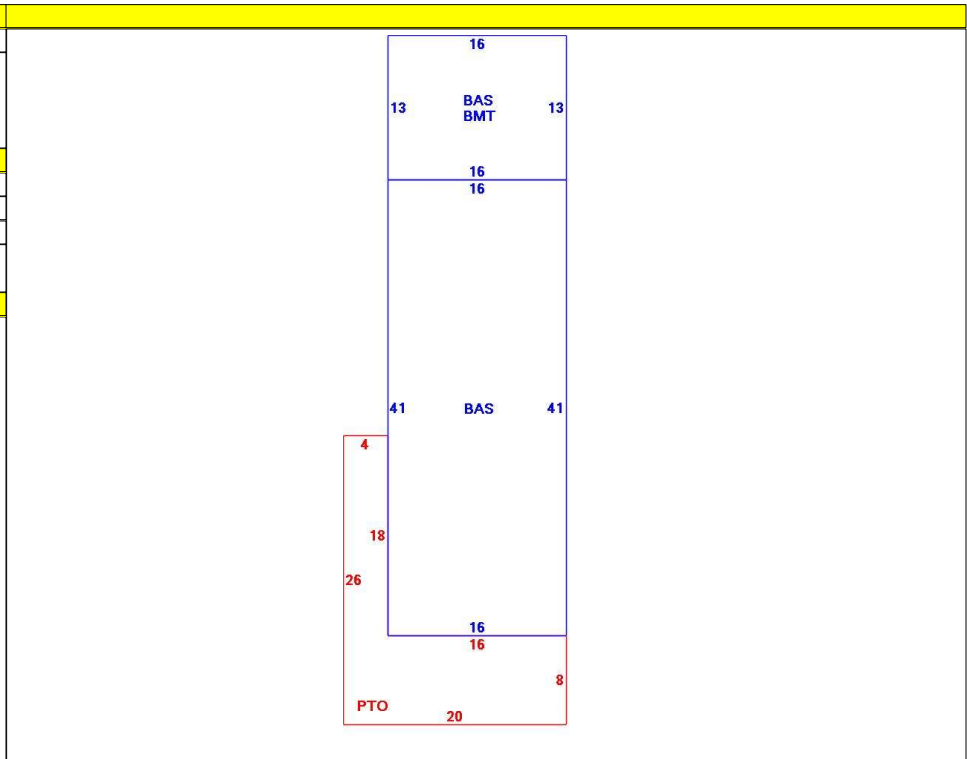

| OB - OUTBUILDING & YARD ITEMS(L) / XF - BUILDING EXTRA FEATURES(B) | | | | | | | | | | |
|--|----------------|-----|-------|------------|--------|----------|------|-------|------------|-------------|
| Code | Description | L/B | Units | Unit Price | Yr Blt | Cond. Cd | % Gd | Grade | Grade Adj. | Appr. Value |
| BMT | Basement-Unfi | B | 208 | 26.01 | 2002 | | 85 | | 0.00 | 8,200 |
| PAT1 | Patio- Average | L | 232 | 5.89 | 1999 | | 80 | | 0.00 | 1,200 |

| BUILDING SUB-AREA SUMMARY SECTION | | | | | | |
|-----------------------------------|---------------|-------------|------------|----------|-----------|----------------|
| Code | Description | Living Area | Floor Area | Eff Area | Unit Cost | Undeprec Value |
| BAS | First Floor | 864 | 864 | 864 | 286.30 | 247,365 |
| BMT | Basement Area | 0 | 208 | 0 | 0.00 | 0 |
| PTO | Patio | 0 | 232 | 0 | 0.00 | 0 |
| Ttl Gross Liv / Lease Area | | 864 | 1,304 | 864 | | 247,365 |

