

CURRENT OWNER		TOPO	UTILITIES	STRT / ROAD	LOCATION	CURRENT ASSESSMENT				
PUOPOLO, VINCENZO & JUDY HYNE PUOPOLO FAMILY HOLDING TRUST 11 GARDNER ROAD READING MA 01867						Description	Code	Assessed	Assessed	801 FY2024 BARNSTABLE, MA <h1>VISION</h1>
						RESIDNTL	1020	228,000	228,000	
						SUPPLEMENTAL DATA		Alt Prcl ID Split Zonin BID Parcel ResExpt Q #DL 1 UNIT 6 #DL 2 BLDG A GIS ID F_981842_2703782		
						Total	228,000	228,000		

RECORD OF OWNERSHIP		BK-VOL/PAGE	SALE DATE	Q/U	V/I	SALE PRICE	VC	PREVIOUS ASSESSMENTS (HISTORY)									
PUOPOLO, VINCENZO & JUDY HYNES TRS HYNES, JUDY		32558	0155	12-18-2019	U	I	100	1F	Year	Code	Assessed	Year	Code	Assessed V	Year	Code	Assessed
		7142	0182	04-15-1990	Q	I	67,900	U	2023	1020	217,600	2022	1020	165,900	2021	1020	142,800
								Total	217,600	Total	165,900	Total	145,700				

EXEMPTIONS			OTHER ASSESSMENTS					This signature acknowledges a visit by a Data Collector or Assessor											
Year	Code	Description	Amount	Code	Description	Number	Amount	Comm Int											
		Total	0.00																

ASSESSING NEIGHBORHOOD				APPRaised VALUE SUMMARY					
Nbhd	Nbhd Name	B	Tracing	Batch					
0001				HYAN					

NOTES													APPRaised VALUE SUMMARY			
													Appraised Bldg. Value (Card)	218,100		
													Appraised Xf (B) Value (Bldg)	7,000		
													Appraised Ob (B) Value (Bldg)	2,900		
													Appraised Land Value (Bldg)	0		
													Special Land Value	0		
													Total Appraised Parcel Value	228,000		
													Valuation Method	C		
													Total Appraised Parcel Value	228,000		

BUILDING PERMIT RECORD										VISIT / CHANGE HISTORY					
Permit Id	Issue Date	Type	Description	Amount	Insp Date	% Comp	Date Comp	Comments		Date	Id	Type	Is	Cd	Purpost/Result
										04-23-2020	WD			FR	Field Review
										12-11-2018	SR	02		03	Cycl Insp Comp
										09-16-2013	TP	03		16	In Office Review

LAND LINE VALUATION SECTION																		
B	Use Code	Description	Zone	Dist	Land Type	Land Units	Unit Price	Size Adj	Site Index	Cond.	Nbhd.	Nbhd. Adj	Notes	Location Adjustmen	Adj Unit P	Land Value		
1	102U	Condominium M	RB	4		0 SF	0.00	1.00000	5	1.00	0001	1.000		0.0000	0	0		
Total Card Land Units						0 SF	Parcel Total Land Area						0.00	Total Land Value				0

CONSTRUCTION DETAIL			CONSTRUCTION DETAIL (CONTINUED)		
Element	Cd	Description	Element	Cd	Description
Style	55	Condominium			
Model	05	Res Condo			
Bedrm Func	C	Average			
Stories	2	2 Stories			
Occupancy	0				
Interior Wall 1	05	Drywall			
Interior Wall 2					
Interior Floor 1	14	Carpet			
Interior Floor 2					
Heat Fuel	04	Electric			
Heat Type	07	Elec Baseboard			
AC Type	01	None			
Bedrooms	02	2 Bedrooms			
Full Baths	1	1 Full			
Half Baths	0				
Extra Fixtures					
Total Rooms	4	4 Rooms			
Bath Style					
Kitchen Style					
Master Deed L					
Bath Split	980	1 Full-0 Half			
Foundation	10	Mixed			
AC Type Alt	08				
Sewer Occupan					
CONDO DATA					
Parcel Id	104288	C 0760	Owne	1.5	
	SEA MEADOW VIL	B 1	S 1		
Adjust Type	Code	Description	Factor%		
Condo Flr	2FE	SECOND FL END	100		
Condo Unit	MKT0	MKT0	100		
COST / MARKET VALUATION					
Building Value New			247,836		
Year Built			1988		
Effective Year Built			2003		
Depreciation Code			A		
Remodel Rating					
Year Remodeled					
Depreciation %			12		
Functional Obsol			0		
External Obsol			0		
Trend Factor			1		
Condition					
Condition %					
Percent Good			88		
Cns Sect Rcnd			218,100		
Dep % Ovr					
Dep Ovr Comment					
Misc Imp Ovr					
Misc Imp Ovr Comment					
Cost to Cure Ovr					
Cost to Cure Ovr Comment					

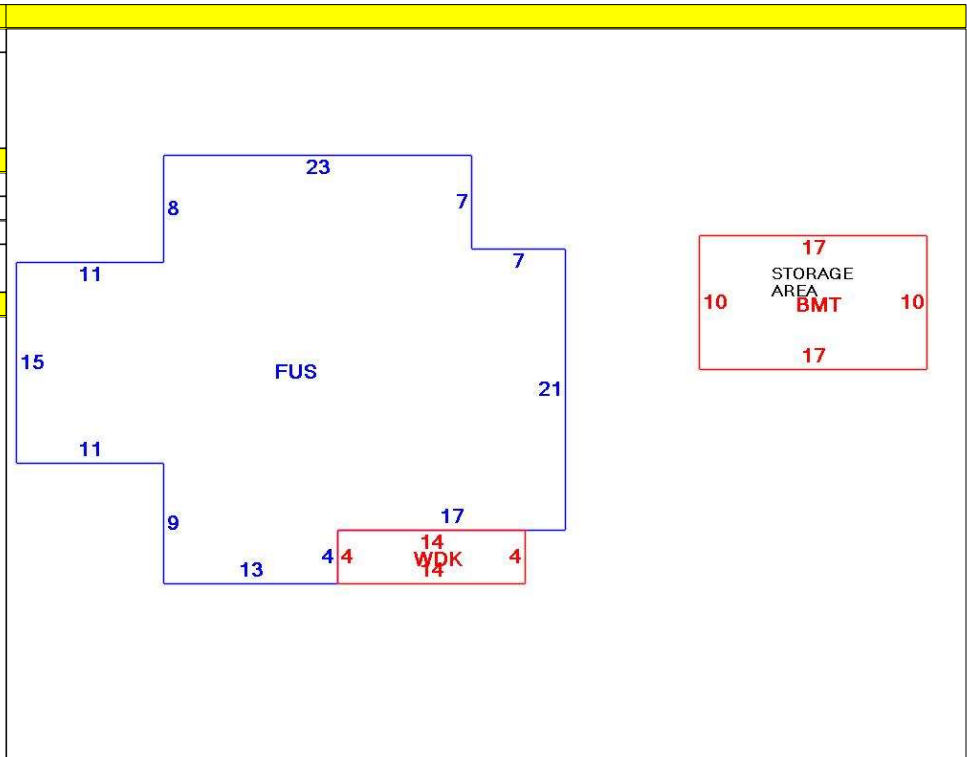

OB - OUTBUILDING & YARD ITEMS(L) / XF - BUILDING EXTRA FEATURES(B)										
Code	Description	L/B	Units	Unit Price	Yr Blt	Cond. Cd	% Gd	Grade	Grade Adj.	Appr. Value
BMT	Basement-Unfi	B	170	26.01	2005		88		0.00	7,000
WDC	Wood Decking	L	56	20.00	2018		98		0.00	2,900

BUILDING SUB-AREA SUMMARY SECTION						
Code	Description	Living Area	Floor Area	Eff Area	Unit Cost	Undeprec Value
BMT	Basement Area	0	170	0	0.00	0
FUS	Upper Story	1,008	1,008	1,008	245.87	247,836
WDC	Wood Deck	0	56	0	0.00	0
Ttl Gross Liv / Lease Area		1,008	1,234	1,008		247,836

