

CURRENT OWNER		TOPO	UTILITIES	STRT / ROAD	LOCATION	CURRENT ASSESSMENT				
HASTINGS, JANET L						Description	Code	Assessed	Assessed	801 FY2024 BARNSTABLE, MA
720 PITCHERS WAY UNIT 9		SUPPLEMENTAL DATA				RESIDNTL	1020	201,000	201,000	
HYANNIS	MA	02601	Alt Prcl ID Split Zonin BID Parcel ResExpt Q #DL 1 #DL 2 GIS ID		Plan Ref. 447/55-56 Land Ct# #SR Life Estate PP STATU Assoc Pid#	Total		201,000	201,000	

VISION

RECORD OF OWNERSHIP		BK-VOL/PAGE	SALE DATE	Q/U	V/I	SALE PRICE	VC	PREVIOUS ASSESSMENTS (HISTORY)								
HASTINGS, JANET L		18530	0153	04-30-2004	Q	I	172,000	00	Year	Code	Assessed	Year	Code	Assessed		
OBRIEN, KATHLEEN A		6375	0258	08-15-1988	Q	I	70,000	U	2023	1020	191,900	2022	1020	146,700		
SEA MEADOW VILLAGE ASSOC		6232	0003	04-15-1988	U	I	1	B	2021	1020	126,000	2021	1020	3,100		
		Total						Total		191,900	Total		146,700	Total		129,100

EXEMPTIONS				OTHER ASSESSMENTS				This signature acknowledges a visit by a Data Collector or Assessor									
Year	Code	Description	Amount	Code	Description	Number	Amount	Comm	Int								
2010	5C	RESIDENTIAL EXEMPTION	0.00														
Total			0.00														

ASSESSING NEIGHBORHOOD				APPRaised VALUE SUMMARY				
Nbhd	Nbhd Name	B	Tracing	Batch				
0001				HYAN				
NOTES				Appraised Bldg. Value (Card)				190,600
				Appraised Xf (B) Value (Bldg)				7,300
				Appraised Ob (B) Value (Bldg)				3,100
				Appraised Land Value (Bldg)				0
				Special Land Value				0
				Total Appraised Parcel Value				201,000
				Valuation Method				C
				Total Appraised Parcel Value				201,000

BUILDING PERMIT RECORD								VISIT / CHANGE HISTORY							
Permit Id	Issue Date	Type	Description	Amount	Insp Date	% Comp	Date Comp	Comments	Date	Id	Type	Is	Cd	Purpost/Result	
									04-23-2020	WD			FR	Field Review	
									12-11-2018	SR	02		03	Cycl Insp Comp	
									09-16-2013	TP	03		16	In Office Review	
									08-04-2004	PT	02		01	Meas/Est	

LAND LINE VALUATION SECTION																		
B	Use Code	Description	Zone	Dist	Land Type	Land Units	Unit Price	Size Adj	Site Index	Cond.	Nbhd.	Nbhd. Adj	Notes	Location Adjustmen	Adj Unit P	Land Value		
1	102U	Condominium M	RB	4		0 SF	0.00	1.00000	5	1.00	0001	1.000		0.0000	0	0		
Total Card Land Units						0 SF	Parcel Total Land Area						0.00	Total Land Value				0

CONSTRUCTION DETAIL			CONSTRUCTION DETAIL (CONTINUED)		
Element	Cd	Description	Element	Cd	Description
Style	55	Condominium			
Model	05	Res Condo			
Bedrm Func	C	Average			
Stories	1	1 Story			
Occupancy	0				
Interior Wall 1	05	Drywall			
Interior Wall 2					
Interior Floor 1	14	Carpet			
Interior Floor 2					
Heat Fuel	04	Electric			
Heat Type	07	Elec Baseboard			
AC Type	01	None			
Bedrooms	01	1 Bedroom			
Full Baths	1	1 Full			
Half Baths	0				
Extra Fixtures					
Total Rooms	3	3 Rooms			
Bath Style					
Kitchen Style					
Master Deed L	1048				
Bath Split	10	1 Full-0 Half			
Foundation	08	Mixed			
AC Type Alt					
Sewer Occupan					
CONDO DATA					
Parcel Id	104288	C 0760	Owne	1.2	
	SEA MEADOW VIL	B 1	S 1		
Adjust Type	Code	Description	Factor%		
Condo Flr	1FU	FIRST FLOOR	100		
Condo Unit	MKT0	MKT0	100		
COST / MARKET VALUATION					
Building Value New		216,550			
Year Built		1988			
Effective Year Built		2003			
Depreciation Code		A			
Remodel Rating					
Year Remodeled		12			
Depreciation %		0			
Functional Obsol		0			
External Obsol		0			
Trend Factor		1			
Condition					
Condition %		88			
Percent Good		190,600			
Cns Sect Rcnd					
Dep % Ovr					
Dep Ovr Comment					
Misc Imp Ovr					
Misc Imp Ovr Comment					
Cost to Cure Ovr					
Cost to Cure Ovr Comment					

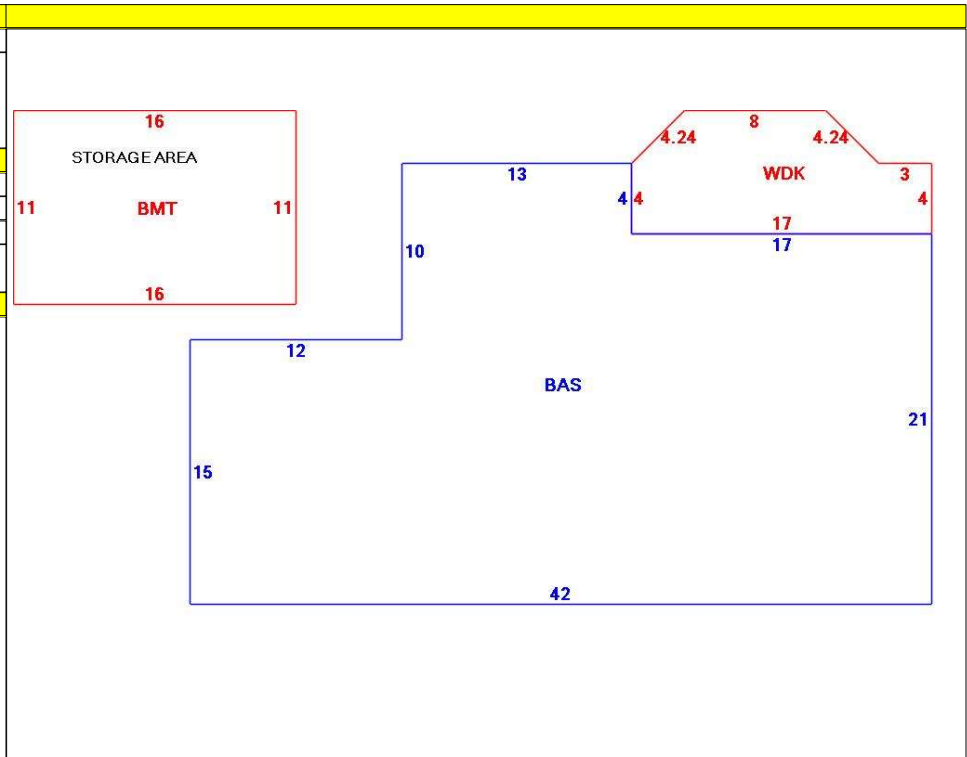

OB - OUTBUILDING & YARD ITEMS(L) / XF - BUILDING EXTRA FEATURES(B)										
Code	Description	L/B	Units	Unit Price	Yr Blt	Cond. Cd	% Gd	Grade	Grade Adj.	Appr. Value
BMT	Basement-Unfi	B	176	26.01	2005		88		0.00	7,300
WDC	Wood Deck w/	L	101	18.00	2018		98		0.00	3,100

BUILDING SUB-AREA SUMMARY SECTION						
Code	Description	Living Area	Floor Area	Eff Area	Unit Cost	Undeprec Value
BAS	First Floor	862	862	862	251.22	216,550
BMT	Basement Area	0	176	0	0.00	0
WDK	Wood Deck	0	101	0	0.00	0
Ttl Gross Liv / Lease Area		862	1,139	862		216,550

