

| CURRENT OWNER | | | | TOPO | UTILITIES | STRT / ROAD | LOCATION | CURRENT ASSESSMENT | | | | 801 FY2024 BARNSTABLE, MA VISION | | | | | | | |
|---|------------|----------------|-------------|--|----------------|------------------------|-----------|---|-------------------------------|--------------------------------|----------|--|----------------------|----------------------------|--------------|--------------------|--------------------|----------|--|
| RAMOS, JUAN C PO BOX 3742 NANTUCKET MA 02584 | | | | 1 Level | 2 Public Water | 1 Paved | | Description | Code | Assessed | Assessed | | | RESIDNTL RES LAND | 1010 1010 | 348,800 153,900 | 348,800 153,900 | | |
| | | | | | 4 Gas | | | | | | | | | | | | | | |
| | | | | | 6 Septic | | | | | | | | | | | | | | |
| SUPPLEMENTAL DATA | | | | | | | | Total | | | | 502,700 | 502,700 | | | | | | |
| Alt Prcl ID Split Zonin BID Parcel ResExpt Q #DL 1 LOT 22 #DL 2 GIS ID F_982065_2706618 | | | | Plan Ref. 271/84 Land Ct# #SR Life Estate PP STATU Assoc Pid# | | | | | | | | | | | | | | | |
| RECORD OF OWNERSHIP | | | | BK-VOL/PAGE | SALE DATE | Q/U | V/I | SALE PRIC | VC | PREVIOUS ASSESSMENTS (HISTORY) | | | | | | | | | |
| RAMOS, JUAN C | | | | 30193 0334 | 12-27-2016 | Q | I | 239,000 | 00 | Year | Code | Assessed | Year | Code | Assessed | Year | Code | Assessed | |
| CIMBRELO, WILLIAM E | | | | 29206 0142 | 10-15-2015 | U | I | 100 | 1A | 2023 | 1010 | 301,000 | 2022 | 1010 | 263,900 | 2021 | 1010 | 214,200 | |
| CIMBRELO, SARA ESTATE OF | | | | 29882 0203 | 08-25-2015 | U | I | 0 | 1A | | 1010 | 139,900 | | 1010 | 103,600 | | 1010 | 103,600 | |
| CIMBRELO, SARA | | | | 29882 0204 | 08-24-2015 | U | I | 0 | 1A | | | | | | | | 1010 | 3,700 | |
| CIMBRELO, RICK & SARA | | | | 4382 0220 | 01-15-1985 | Q | I | 69,000 | U | | | | | | | | | | |
| | | | | Total | | | | | | | | 440,900 | Total | | 367,500 | Total | | 321,500 | |
| EXEMPTIONS | | | | OTHER ASSESSMENTS | | | | This signature acknowledges a visit by a Data Collector or Assessor | | | | | | | | | | | |
| Year | Code | Description | Amount | Code | Description | Number | Amount | Comm Int | | | | | | | | | | | |
| | | | | | | | | | | | | | | | | | | | |
| | | | Total | | | | 0.00 | | | | | | | | | | | | |
| ASSESSING NEIGHBORHOOD | | | | | | | | APPRAISED VALUE SUMMARY | | | | | | | | | | | |
| Nbhd | Nbhd Name | | B | | Tracing | | Batch | | Appraised Bldg. Value (Card) | | | | 301,000 | | | | | | |
| 0105 | | | | | | | HYAN | | Appraised Xf (B) Value (Bldg) | | | | 44,100 | | | | | | |
| | | | | | | | | Appraised Ob (B) Value (Bldg) | | | | 3,700 | | | | | | | |
| | | | | | | | | Appraised Land Value (Bldg) | | | | 153,900 | | | | | | | |
| | | | | | | | | Special Land Value | | | | 0 | | | | | | | |
| | | | | | | | | Total Appraised Parcel Value | | | | 502,700 | | | | | | | |
| | | | | | | | | Valuation Method | | | | C | | | | | | | |
| | | | | | | | | Total Appraised Parcel Value | | | | 502,700 | | | | | | | |
| BUILDING PERMIT RECORD | | | | | | | | VISIT / CHANGE HISTORY | | | | | | | | | | | |
| Permit Id | Issue Date | Type | Description | Amount | Insp Date | % Comp | Date Comp | Comments | Date | Id | Type | Is | Cd | Purpost/Result | | | | | |
| | | | | | | | | | 04-27-2020 | WD | | | FR | Field Review | | | | | |
| | | | | | | | | | 02-23-2018 | KM | 02 | | 03 | Cycl Insp Comp | | | | | |
| | | | | | | | | | 12-28-2016 | AL | 03 | | 16 | In Office Review | | | | | |
| | | | | | | | | | 01-17-2001 | PT | 01 | | 00 | Meas/Listed-Interior Acces | | | | | |
| | | | | | | | | | 09-15-1990 | ME | 02 | | 01 | Meas/Est | | | | | |
| LAND LINE VALUATION SECTION | | | | | | | | | | | | | | | | | | | |
| B | Use Code | Description | Zone | LA | Land Units | Unit Price | Size Adj | AC Disc | Site Index | Cond. | Nbhd. | Nbhd. Adj | Notes | Location Adjustmen | Adj Unit P | Land Value | | | |
| 1 | 1010 | Single Fam M-0 | RC- | 4 | 0.400 AC | 176,344.00 | 2.18159 | 1.0000 | 5 | 1.00 | 0105 | 1.000 | ACROSS FROM TREATMEN | | 1.0000 | 384,712.0 | 153,900 | | |
| Total Card Land Units | | | | | 0.40 AC | Parcel Total Land Area | | | | | 0.40 | Total Land Value | | | | | 153,900 | | |

| CONSTRUCTION DETAIL | | | CONSTRUCTION DETAIL (CONTINUED) | | |
|---------------------|----|----------------|---------------------------------|----|-------------|
| Element | Cd | Description | Element | Cd | Description |
| Style | 01 | Ranch | | | |
| Model | 01 | Residential | | | |
| Grade: | C | Average | | | |
| Stories | 1 | 1 Story | | | |
| Exterior Wall 1 | 14 | Wood Shingle | | | |
| Exterior Wall 2 | 11 | Clapboard | | | |
| RooF Structure | 03 | Gable/Hip | | | |
| RooF Cover | 03 | Asph/F Gls/Cmp | | | |
| Interior Wall 1 | 05 | Drywall | | | |
| Interior Wall 2 | | | | | |
| Interior Floor 1 | 14 | Carpet | | | |
| Interior Floor 2 | 12 | Hardwood | | | |
| Heat Fuel | 02 | Oil | | | |
| Heat Type | 05 | Hot Water | | | |
| AC Type | 01 | None | | | |
| Bedrooms | 02 | 2 Bedrooms | | | |
| Full Baths | 2 | | | | |
| Half Baths | 0 | | | | |
| Extra Fixtures | | | | | |
| Total Rooms | 5 | 5 Rooms | | | |
| Bath Style | | | | | |
| Kitchen Style | | | | | |
| Occupancy | | | | | |
| Usrflid 105 | | | | | |
| Accessory Apt | | | | | |
| Foundation Alt | 01 | Poured Conc. | | | |
| Rms Prts | | | | | |
| Bath Split | 20 | 2 Full-0 Half | | | |

| CONDO DATA | | | |
|-------------|------|-------------|---------|
| Parcel Id | C | Owne | 0.0 |
| Adjust Type | Code | Description | Factor% |
| Condo Flr | | | |
| Condo Unit | | | |

| COST / MARKET VALUATION | |
|--------------------------|---------|
| Building Value New | 367,105 |
| Year Built | 1980 |
| Effective Year Built | 1996 |
| Depreciation Code | A |
| Remodel Rating | |
| Year Remodeled | |
| Depreciation % | 18 |
| Functional Obsol | 0 |
| External Obsol | 0 |
| Trend Factor | 1 |
| Condition | |
| Condition % | |
| Percent Good | 82 |
| RCNLD | 301,000 |
| Dep % Ovr | |
| Dep Ovr Comment | |
| Misc Imp Ovr | |
| Misc Imp Ovr Comment | |
| Cost to Cure Ovr | |
| Cost to Cure Ovr Comment | |

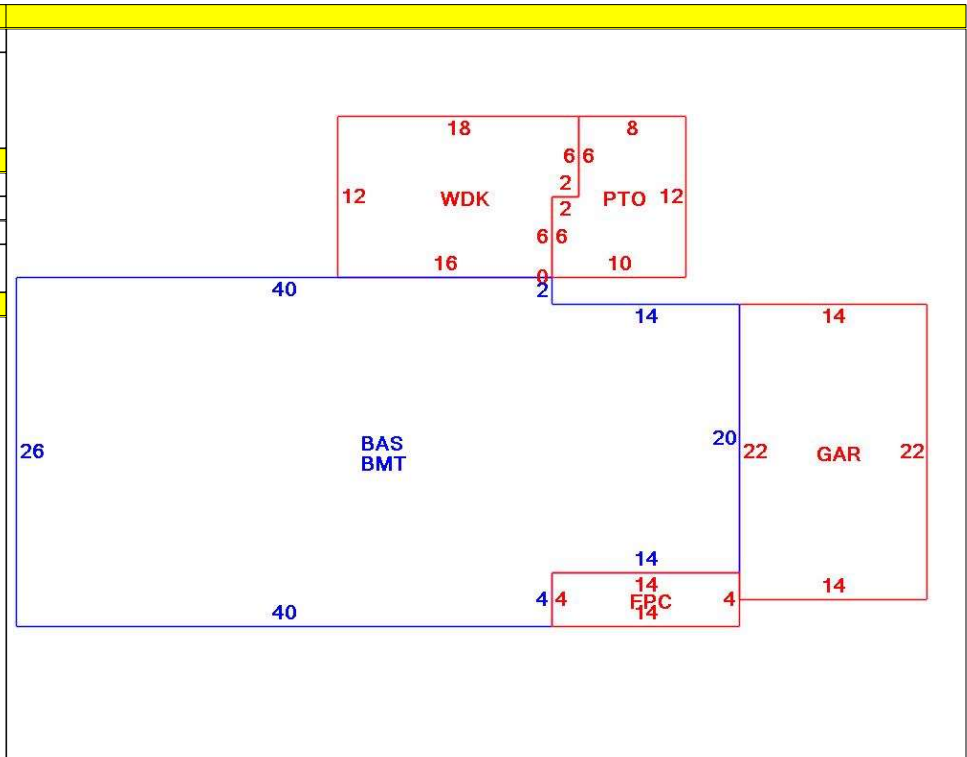

| OB - OUTBUILDING & YARD ITEMS(L) / XF - BUILDING EXTRA FEATURES(B) | | | | | | | | | | |
|--|-----------------|-----|-------|------------|--------|----------|------|-------|------------|-------------|
| Code | Description | L/B | Units | Unit Price | Yr Blt | Cond. Cd | % Gd | Grade | Grade Adj. | Appr. Value |
| FPL1 | Fireplace 1 sto | B | 1 | 5000.00 | 1998 | | 82 | | 0.00 | 4,100 |
| WDC | Wood Decking | L | 204 | 20.00 | 1998 | | 58 | | 0.00 | 2,800 |
| FOPC | Open Prch-roo | B | 56 | 55.00 | 1998 | | 82 | | 0.00 | 2,500 |
| GAR | Attached Gara | B | 308 | 40.00 | 1998 | | 82 | | 0.00 | 11,100 |
| BMT | Basement-Unfi | B | 1,320 | 26.01 | 1998 | | 82 | | 0.00 | 26,400 |
| PAT2 | Patio-Good | L | 108 | 9.94 | 1993 | | 74 | | 0.00 | 900 |

| BUILDING SUB-AREA SUMMARY SECTION | | | | | | |
|-----------------------------------|------------------------|-------------|------------|----------|-----------|----------------|
| Code | Description | Living Area | Floor Area | Eff Area | Unit Cost | Undeprec Value |
| BAS | First Floor | 1,320 | 1,320 | 1,320 | 278.11 | 367,105 |
| BMT | Basement Area | 0 | 1,320 | 0 | 0.00 | 0 |
| FPC | Open Porch Conc. Floor | 0 | 56 | 0 | 0.00 | 0 |
| GAR | Attached Garage | 0 | 308 | 0 | 0.00 | 0 |
| PTO | Patio | 0 | 108 | 0 | 0.00 | 0 |
| WDK | Wood Deck | 0 | 204 | 0 | 0.00 | 0 |
| Ttl Gross Liv / Lease Area | | 1,320 | 3,316 | 1,320 | | 367,105 |

