

| CURRENT OWNER  |  | TOPO    | UTILITIES      | STRT / ROAD  | LOCATION | CURRENT ASSESSMENT |      |          |          |
|--|--|---------|----------------|--|----------|--------------------|------|----------|----------|
| MAIOLO, GAY JANE<br><br>17 GREGOIRE CIR<br><br>CENTERVILLE MA 02632  |  | 1 Level | 2 Public Water | 1 Paved  |          | Description        | Code | Assessed | Assessed |
|  |  |         | 4 Gas          |  |          | RESIDNTL           | 1010 | 306,900  | 306,900  |
|  |  |         | 6 Septic       |  |          | RES LAND           | 1010 | 143,200  | 143,200  |
| <b>SUPPLEMENTAL DATA</b>   |  |         |                |  |          |                    |      |          |          |
| Alt Prcl ID<br>Split Zonin<br>BID Parcel<br>ResExpt Q YES:<br>#DL 1 LOT 7A<br>#DL 2<br>GIS ID F_979401_2707299 |  |         |                | Plan Ref. 167/83<br>Land Ct#<br>#SR<br>Life Estate<br>PP STATU<br>Assoc Pid# |          |                    |      |          |          |
|  |  |         |                |  |          | Total              |      | 450,100  | 450,100  |

801  
FY2024  
BARNSTABLE, MA

**VISION**

| RECORD OF OWNERSHIP         |  | BK-VOL/PAGE | SALE DATE  | Q/U | V/I | SALE PRIC | VC | PREVIOUS ASSESSMENTS (HISTORY) |      |          |       |      |          |
|-----------------------------|--|-------------|------------|-----|-----|-----------|----|--------------------------------|------|----------|-------|------|----------|
| MAIOLO, GAY JANE            |  | 35336 082   | 08-30-2022 | Q   | I   | 487,000   | 00 | Year                           | Code | Assessed | Year  | Code | Assessed |
| AMARAL, MARC C              |  | 30500 0047  | 05-19-2017 | Q   | I   | 290,000   | 00 | 2023                           | 1010 | 260,000  | 2022  | 1010 | 213,400  |
| GRESH, JARED T              |  | 24034 0183  | 09-15-2009 | U   | I   | 194,000   | 1  |                                | 1010 | 130,200  |       | 1010 | 96,400   |
| MCWILLIAMS, WILLIAM         |  | 23976 0170  | 08-19-2009 | U   | I   | 138,000   | 1  |                                |      |          |       | 1010 | 7,600    |
| KENNEDY, MICHAEL F & JILL W |  | 12955 0089  | 04-20-2000 | U   | I   | 42,368    | 1A | Total                          |      | 390,200  | Total |      | 309,800  |
|                             |  |             |            |     |     |           |    | Total                          |      |          | Total |      | 281,500  |

| EXEMPTIONS |      |                       | OTHER ASSESSMENTS |      |             |        |        |          |
|------------|------|-----------------------|-------------------|------|-------------|--------|--------|----------|
| Year       | Code | Description           | Amount            | Code | Description | Number | Amount | Comm Int |
| 2024       | 5C   | RESIDENTIAL EXEMPTION |                   |      |             |        |        |          |
| Total      |      |                       | 0.00              |      |             |        |        |          |

This signature acknowledges a visit by a Data Collector or Assessor

| ASSESSING NEIGHBORHOOD |           |   |            |
|------------------------|-----------|---|------------|
| Nbhd                   | Nbhd Name | B | Tracing    |
| 0105                   |           |   | Batch HYAN |

| APPRAISED VALUE SUMMARY       |         |
|-------------------------------|---------|
| Appraised Bldg. Value (Card)  | 263,700 |
| Appraised Xf (B) Value (Bldg) | 35,300  |
| Appraised Ob (B) Value (Bldg) | 7,900   |
| Appraised Land Value (Bldg)   | 143,200 |
| Special Land Value            | 0       |
| Total Appraised Parcel Value  | 450,100 |
| Valuation Method              | C       |
| Total Appraised Parcel Value  | 450,100 |

| NOTES |  |  |  |  |  |  |  |
|-------|--|--|--|--|--|--|--|
|       |  |  |  |  |  |  |  |

| BUILDING PERMIT RECORD |                          |           |                            |                 |                          |            |                          |                        | VISIT / CHANGE HISTORY   |                                  |                                  |    |                                  |  |
|------------------------|--------------------------|-----------|----------------------------|-----------------|--------------------------|------------|--------------------------|------------------------|--|----------------------------------|----------------------------------|----|----------------------------------|--|
| Permit Id              | Issue Date               | Type      | Description                | Amount          | Insp Date                | % Comp     | Date Comp                | Comments               | Date   | Id                               | Type                             | Is | Cd                               | Purpost/Result   |
| EXPR-23-5<br>58061     | 01-17-2023<br>12-26-2001 | 835<br>AD | Sid/Wind/Roof/<br>Addition | 3,000<br>33,024 | 06-01-2023<br>10-07-2002 | 100<br>100 | 06-30-2023<br>01-01-2003 | RESIDENTIAL WEATHERIZA | 07-24-2023<br>06-01-2023<br>10-11-2022<br>04-28-2020<br>01-05-2018<br>02-14-2014 | YB<br>TR<br>BM<br>WD<br>KM<br>JR | 03<br>02<br>22<br>FR<br>03<br>03 |    | 16<br>20<br>22<br>FR<br>03<br>16 | In Office Review<br>Sale Review<br>Change of Address<br>Field Review<br>Cycl Insp Comp<br>In Office Review |

| LAND LINE VALUATION SECTION |          |                |      |    |            |            |          |         |            |       |       |           |       |                    |            |            |
|-----------------------------|----------|----------------|------|----|------------|------------|----------|---------|------------|-------|-------|-----------|-------|--------------------|------------|------------|
| B                           | Use Code | Description    | Zone | LA | Land Units | Unit Price | Size Adj | AC Disc | Site Index | Cond. | Nbhd. | Nbhd. Adj | Notes | Location Adjustmen | Adj Unit P | Land Value |
| 1                           | 1010     | Single Fam M-0 | RC-  | 4  | 0.200 AC   | 176,344.00 | 4.05999  | 1.0000  | 5          | 1.00  | 0105  | 1.000     |       | 1.0000             | 715,956.6  | 143,200    |

Total Card Land Units 0.20 AC Parcel Total Land Area 0.20

Total Land Value 143,200

| CONSTRUCTION DETAIL |     |                | CONSTRUCTION DETAIL (CONTINUED) |    |             |
|---------------------|-----|----------------|---------------------------------|----|-------------|
| Element             | Cd  | Description    | Element                         | Cd | Description |
| Style               | 04  | Cape Cod       |                                 |    |             |
| Model               | 01  | Residential    |                                 |    |             |
| Grade:              | C   | Average        |                                 |    |             |
| Stories             | 1.5 | 1 1/2 Stories  |                                 |    |             |
| Exterior Wall 1     | 14  | Wood Shingle   |                                 |    |             |
| Exterior Wall 2     |     |                |                                 |    |             |
| RooF Structure      | 03  | Gable/Hip      |                                 |    |             |
| RooF Cover          | 03  | Asph/F Gls/Cmp |                                 |    |             |
| Interior Wall 1     | 05  | Drywall        |                                 |    |             |
| Interior Wall 2     |     |                |                                 |    |             |
| Interior Floor 1    | 14  | Carpet         |                                 |    |             |
| Interior Floor 2    | 12  | Hardwood       |                                 |    |             |
| Heat Fuel           | 02  | Oil            |                                 |    |             |
| Heat Type           | 04  | Hot Air        |                                 |    |             |
| AC Type             | 01  | None           |                                 |    |             |
| Bedrooms            | 03  | 3 Bedrooms     |                                 |    |             |
| Full Baths          | 1   |                |                                 |    |             |
| Half Baths          | 0   |                |                                 |    |             |
| Extra Fixtures      |     |                |                                 |    |             |
| Total Rooms         | 7   | 7 Rooms        |                                 |    |             |
| Bath Style          |     |                |                                 |    |             |
| Kitchen Style       |     |                |                                 |    |             |
| Occupancy           |     |                |                                 |    |             |
| Usrflid 105         |     |                |                                 |    |             |
| Accessory Apt       |     |                |                                 |    |             |
| Foundation Alt      | 01  | Poured Conc.   |                                 |    |             |
| Rms Prts            |     |                |                                 |    |             |
| Bath Split          | 10  | 1 Full-0 Half  |                                 |    |             |

| CONDO DATA  |      |             |         |     |
|-------------|------|-------------|---------|-----|
| Parcel Id   |      | C           | Ownr    | 0.0 |
| Adjust Type | Code | Description | Factor% |     |
| Condo Flr   |      |             |         |     |
| Condo Unit  |      |             |         |     |

| COST / MARKET VALUATION  |         |
|--------------------------|---------|
| Building Value New       | 325,516 |
| Year Built               | 1966    |
| Effective Year Built     | 1994    |
| Depreciation Code        | G       |
| Remodel Rating           |         |
| Year Remodeled           |         |
| Depreciation %           | 19      |
| Functional Obsol         | 0       |
| External Obsol           | 0       |
| Trend Factor             | 1       |
| Condition                |         |
| Condition %              |         |
| Percent Good             | 81      |
| RCNLD                    | 263,700 |
| Dep % Ovr                |         |
| Dep Ovr Comment          |         |
| Misc Imp Ovr             |         |
| Misc Imp Ovr Comment     |         |
| Cost to Cure Ovr         |         |
| Cost to Cure Ovr Comment |         |

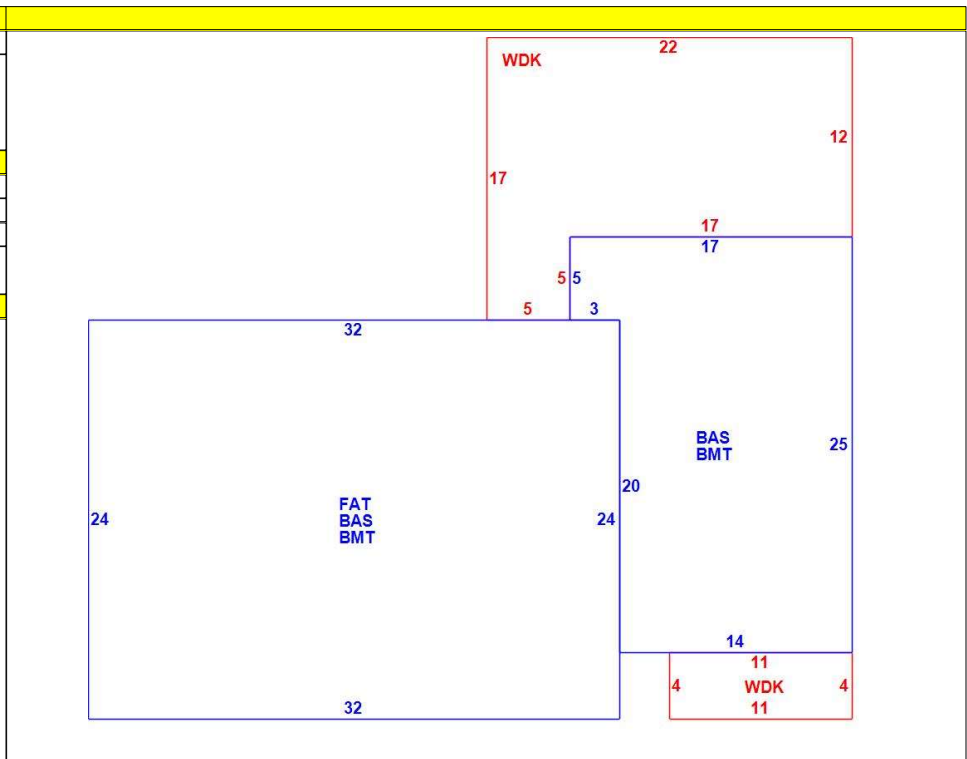

| OB - OUTBUILDING & YARD ITEMS(L) / XF - BUILDING EXTRA FEATURES(B) |                 |     |       |            |        |          |      |       |            |             |
|--|-----------------|-----|-------|------------|--------|----------|------|-------|------------|-------------|
| Code   | Description     | L/B | Units | Unit Price | Yr Blt | Cond. Cd | % Gd | Grade | Grade Adj. | Appr. Value |
| FPL2   | Fireplace 1.5 s | B   | 1     | 6000.00    |        |          | 81   |       | 0.00       | 4,900       |
| WDC  | Wood Decking    | L   | 44    | 20.00      | 2000   |          | 62   |       | 0.00       | 1,600       |
| BMT  | Basement-Unfi   | B   | 1,133 | 26.01      |        |          | 81   |       | 0.00       | 23,400      |
| SHED   | Shed            | L   | 64    | 18.00      | 2018   |          | 98   |       | 0.00       | 1,100       |
| WDC  | Wood Deck w/    | L   | 289   | 18.00      | 2018   |          | 98   |       | 0.00       | 5,200       |
| BFA  | Bsmt Fin-Avg    | B   | 500   | 17.36      |        |          | 81   |       | 0.00       | 7,000       |

| BUILDING SUB-AREA SUMMARY SECTION |                 |             |            |          |           |                |
|-----------------------------------|-----------------|-------------|------------|----------|-----------|----------------|
| Code                              | Description     | Living Area | Floor Area | Eff Area | Unit Cost | Undeprec Value |
| BAS                               | First Floor     | 1,133       | 1,133      | 1,133    | 260.83    | 295,520        |
| BMT                               | Basement Area   | 0           | 1,133      | 0        | 0.00      | 0              |
| FAT                               | Attic, Finished | 115         | 768        | 115      | 39.06     | 29,995         |
| WDK                               | Wood Deck       | 0           | 333        | 0        | 0.00      | 0              |
| Ttl Gross Liv / Lease Area        |                 | 1,248       | 3,367      | 1,248    |           | 325,515        |

