

| CURRENT OWNER | | | TOPO | UTILITIES | STRT / ROAD | LOCATION | CURRENT ASSESSMENT | | | | | | | | |
|---------------------------|-------------|------------|-----------|-----------|-------------|----------|--------------------|--------|------------------|-----------------|---------------------------------|----------|-----|-------------|----------|
| ST PIERRE, DANIEL & LUCIA | | | | | | | Description | Code | Assessed | Assessed | 801 FY2024 BARNSTABLE, MA | | | | |
| 158 TROUT BROOK ROAD | | | | | | | RESIDNTL | 1010 | 310,900 | 310,900 | | | | | |
| COTUIT MA 02635 | | | | | | | RES LAND | 1010 | 218,700 | 218,700 | VISION | | | | |
| SUPPLEMENTAL DATA | | | | | | | Total | | 529,600 | 529,600 | | | | | |
| Alt Prcl ID | Split Zonin | BID Parcel | ResExpt Q | YES: | #DL 1 | LOT 8 | #DL 2 | GIS ID | F_942902_2692133 | Plan Ref. 268/4 | | Land Ct# | #SR | Life Estate | PP STATU |

| RECORD OF OWNERSHIP | | | BK-VOL/PAGE | SALE DATE | Q/U | V/I | SALE PRIC | VC | PREVIOUS ASSESSMENTS (HISTORY) | | | | | | | | | |
|-------------------------------------|--|--|-------------|-----------|------------|-----|-----------|---------|--------------------------------|-------|------|----------|-------|------|----------|-------|------|----------|
| ST PIERRE, DANIEL & LUCIA | | | 29476 | 0096 | 02-26-2016 | U | I | 1 | 1F | Year | Code | Assessed | Year | Code | Assessed | Year | Code | Assessed |
| ST PIERRE, DANIEL & GRINSELL, LUCIA | | | 23753 | 0255 | 05-29-2009 | Q | I | 294,000 | 00 | 2023 | 1010 | 277,600 | 2022 | 1010 | 235,600 | 2021 | 1010 | 191,600 |
| BOGER, DEAN M & PATRICIA M | | | 12365 | 0104 | 06-25-1999 | Q | I | 136,000 | 00 | | 1010 | 198,800 | | 1010 | 136,700 | | 1010 | 138,800 |
| BOUGET, CYNTHIA M & GAGNON, MARK | | | 6710 | 0158 | 04-15-1989 | Q | I | 125,000 | U | | | | | | | | 1010 | 12,500 |
| ROTSTEIN, KOBY A & ARONSON, TINA G | | | 4631 | 0028 | 07-15-1985 | Q | I | 87,000 | U | Total | | 476,400 | Total | | 372,300 | Total | | 342,900 |

| EXEMPTIONS | | | | OTHER ASSESSMENTS | | | | This signature acknowledges a visit by a Data Collector or Assessor | | | | | | | | | | |
|------------|------|-----------------------|--------|-------------------|-------------|--------|--------|---|--|--|--|--|--|--|--|--|--|--|
| Year | Code | Description | Amount | Code | Description | Number | Amount | Comm Int | | | | | | | | | | |
| 2012 | 5C | RESIDENTIAL EXEMPTION | 0.00 | | | | | | | | | | | | | | | |
| Total | | | 0.00 | | | | | | | | | | | | | | | |

| ASSESSING NEIGHBORHOOD | | | | APPRAISED VALUE SUMMARY | | | | | | | | | | | | |
|------------------------|-----------|---|--|-------------------------|--------|--|--|--|--|--|--|--|--|-------------------------------|---------|--|
| Nbhd | Nbhd Name | B | | Tracing | Batch | | | | | | | | | | | |
| 0107 | | | | | COTUIT | | | | | | | | | | | |
| NOTES | | | | | | | | | | | | | | Appraised Bldg. Value (Card) | 263,500 | |
| | | | | | | | | | | | | | | Appraised Xf (B) Value (Bldg) | 33,200 | |
| | | | | | | | | | | | | | | Appraised Ob (B) Value (Bldg) | 14,200 | |
| | | | | | | | | | | | | | | Appraised Land Value (Bldg) | 218,700 | |
| | | | | | | | | | | | | | | Special Land Value | 0 | |
| | | | | | | | | | | | | | | Total Appraised Parcel Value | 529,600 | |
| | | | | | | | | | | | | | | Valuation Method | C | |
| | | | | | | | | | | | | | | Total Appraised Parcel Value | 529,600 | |

| BUILDING PERMIT RECORD | | | | | | | | | | VISIT / CHANGE HISTORY | | | | | |
|------------------------|------------|------|----------------|--------|------------|--------|------------|--|--|------------------------|----|------|----|----|------------------|
| Permit Id | Issue Date | Type | Description | Amount | Insp Date | % Comp | Date Comp | Comments | | Date | Id | Type | Is | Cd | Purpost/Result |
| BLDR-23-13 | 10-02-2023 | 839 | Solar Panel-Re | 19,000 | | 0 | | Installation of a safe and code-replace 5 sq like for like white | | 08-27-2021 | CK | 02 | | 03 | Cycl Insp Comp |
| EXPR-23-4 | 04-27-2023 | 835 | Sid/Wind/Roof/ | 8,670 | | 100 | | Strip and reroof approximately | | 05-26-2020 | DM | | | FR | Field Review |
| EXPR-22-1 | 09-13-2022 | 835 | Sid/Wind/Roof/ | 12,850 | | 100 | | | | 05-01-2017 | LH | 03 | | 16 | In Office Review |
| 69792 | 06-27-2003 | AD | Addition | 3,000 | 09-17-2003 | 100 | 01-01-2004 | | | 02-29-2016 | AL | 03 | | 16 | In Office Review |
| 39704 | 07-13-1999 | NR | New Roof | 4,000 | 01-01-2000 | 100 | 01-01-2000 | | | 01-30-2014 | JR | 03 | | 16 | In Office Review |
| B19272 | 06-01-1977 | DW | Dwelling | 0 | 01-15-1978 | 100 | 12-31-1978 | CO 1.5 ST | | 10-07-2013 | RB | 03 | | 03 | Cycl Insp Comp |
| | | | | | | | | | | 01-05-2005 | PT | 02 | | 01 | Meas/Est |

| LAND LINE VALUATION SECTION | | | | | | | | | | | | | | | | | |
|-----------------------------|----------|----------------|------|----|------------|------------|------------------------|---------|------------|-------|-------|-----------|------------------|--|--------------------|------------|------------|
| B | Use Code | Description | Zone | LA | Land Units | Unit Price | Size Adj | AC Disc | Site Index | Cond. | Nbhd. | Nbhd. Adj | Notes | | Location Adjustmen | Adj Unit P | Land Value |
| 1 | 1010 | Single Fam M-0 | RF | 2 | 0.470 | AC | 176,344.00 | 1.88432 | 1.0000 | 5 | 1.00 | 0107 | 1.400 | | 1.0000 | 465,213.1 | 218,700 |
| Total Card Land Units | | | | | 0.47 | AC | Parcel Total Land Area | | | | | 0.47 | Total Land Value | | | 218,700 | |

| CONSTRUCTION DETAIL | | | CONSTRUCTION DETAIL (CONTINUED) | | |
|---------------------|-----|----------------|---------------------------------|----|-------------|
| Element | Cd | Description | Element | Cd | Description |
| Style | 04 | Cape Cod | | | |
| Model | 01 | Residential | | | |
| Grade: | C | Average | | | |
| Stories | 1.5 | 1 1/2 Stories | | | |
| Exterior Wall 1 | 14 | Wood Shingle | | | |
| Exterior Wall 2 | 11 | Clapboard | | | |
| Roof Structure | 03 | Gable/Hip | | | |
| Roof Cover | 03 | Asph/F Gls/Cmp | | | |
| Interior Wall 1 | 05 | Drywall | | | |
| Interior Wall 2 | | | | | |
| Interior Floor 1 | 12 | Hardwood | | | |
| Interior Floor 2 | | | | | |
| Heat Fuel | 03 | Gas | | | |
| Heat Type | 04 | Hot Air | | | |
| AC Type | 01 | None | | | |
| Bedrooms | 03 | 3 Bedrooms | | | |
| Full Baths | 2 | | | | |
| Half Baths | 0 | | | | |
| Extra Fixtures | | | | | |
| Total Rooms | 7 | 7 Rooms | | | |
| Bath Style | | | | | |
| Kitchen Style | | | | | |
| Occupancy | | | | | |
| Usrflid 105 | | | | | |
| Accessory Apt | | | | | |
| Foundation Alt | 01 | Poured Conc. | | | |
| Rms Prts | | | | | |
| Bath Split | 20 | 2 Full-0 Half | | | |

| CONDO DATA | | | |
|-------------|------|-------------|----------|
| Parcel Id | | C | Owne 0.0 |
| Adjust Type | Code | Description | Factor% |
| Condo Flr | | | |
| Condo Unit | | | |

| COST / MARKET VALUATION | |
|--------------------------|---------|
| Building Value New | 325,305 |
| Year Built | 1977 |
| Effective Year Built | 1994 |
| Depreciation Code | A |
| Remodel Rating | |
| Year Remodeled | |
| Depreciation % | 19 |
| Functional Obsol | 0 |
| External Obsol | 0 |
| Trend Factor | 1 |
| Condition | |
| Condition % | |
| Percent Good | 81 |
| RCNLD | 263,500 |
| Dep % Ovr | |
| Dep Ovr Comment | |
| Misc Imp Ovr | |
| Misc Imp Ovr Comment | |
| Cost to Cure Ovr | |
| Cost to Cure Ovr Comment | |

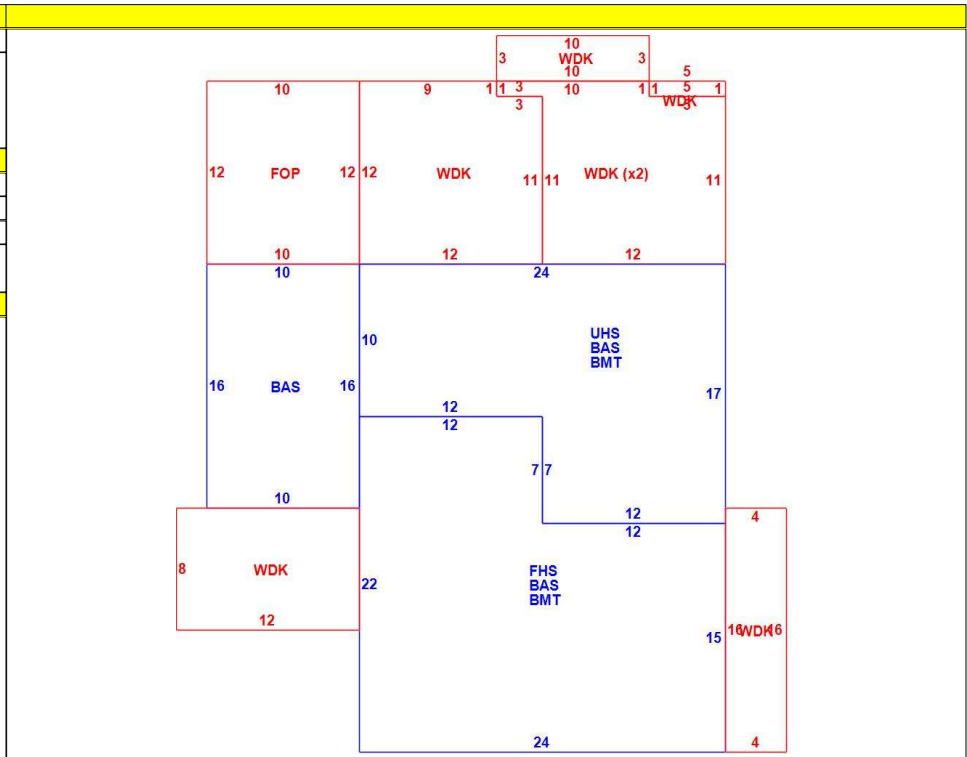

| OB - OUTBUILDING & YARD ITEMS(L) / XF - BUILDING EXTRA FEATURES(B) | | | | | | | | | | |
|--|-----------------|-----|-------|------------|--------|----------|------|-------|------------|-------------|
| Code | Description | L/B | Units | Unit Price | Yr Blt | Cond. Cd | % Gd | Grade | Grade Adj. | Appr. Value |
| BFA | Bsmt Fin-Avg | B | 576 | 17.36 | 1996 | | 81 | | 0.00 | 8,100 |
| WDC | Wood Decking | L | 288 | 20.00 | 1997 | | 56 | | 0.00 | 3,300 |
| FOP | Open Porch-ro | B | 120 | 55.00 | 1996 | | 81 | | 0.00 | 5,100 |
| BMT | Basement-Unfi | B | 768 | 26.01 | 1996 | | 81 | | 0.00 | 18,000 |
| WDC | Wood Decking | L | 172 | 20.00 | 1997 | | 56 | | 0.00 | 2,500 |
| WDC | Wood Deck w/ | L | 60 | 18.00 | 1997 | | 56 | | 0.00 | 1,600 |
| STRS | Stairs to Water | L | 38 | 122.52 | 1997 | | 56 | C | 1.00 | 2,600 |
| FPLG | Gas Fireplace- | B | 1 | 2500.00 | 1996 | | 81 | | 0.00 | 2,000 |
| WDC | Wood Decking | L | 160 | 20.00 | 2020 | | 100 | | 0.00 | 4,200 |

| BUILDING SUB-AREA SUMMARY SECTION | | | | | | |
|-----------------------------------|------------------------|-------------|------------|----------|-----------|----------------|
| Code | Description | Living Area | Floor Area | Eff Area | Unit Cost | Undeprec Value |
| BAS | First Floor | 928 | 928 | 928 | 260.87 | 242,087 |
| BMT | Basement Area | 0 | 768 | 0 | 0.00 | 0 |
| FHS | Half Story | 222 | 444 | 222 | 130.44 | 57,913 |
| FOP | Open Porch | 0 | 120 | 0 | 0.00 | 0 |
| UHS | Half Story, Unfinished | 0 | 324 | 97 | 78.10 | 25,304 |
| WDK | Wood Deck | 0 | 620 | 0 | 0.00 | 0 |
| Ttl Gross Liv / Lease Area | | 1,150 | 3,204 | 1,247 | | 325,304 |

