

| CURRENT OWNER | | TOPO | UTILITIES | STRT / ROAD | LOCATION | CURRENT ASSESSMENT | | | | | | 801 FY2024 BARNSTABLE, MA VISION | | | | | | |
|-----------------------------|------------|------------------------------------------------------------------------------------------------------------|-------------------|-------------|-----------------|------------------------------------------------------------------------------|---------------------------------------------------------------------|--------------------------------|------------|-------------------------------|---------|------------------------------------------------------|------------------|-------|----------------------------|------------|------------|---------|
| JORDAN, OSWALD L | | | | | 1 Marginal View | Description | Code | Assessed | Assessed | | | | | | | | | |
| 31 HOLLIS ST | | SUPPLEMENTAL DATA | | | | RESIDNTL | 1010 | 397,000 | 397,000 | | | | | | | | | |
| BROCKTON MA 02402 | | | | | | RES LAND | 1010 | 225,700 | 225,700 | | | | | | | | | |
| | | Alt Prcl ID Split Zonin BID Parcel ResExpt Q #DL 1 LOT 19A #DL 2 GIS ID F_985003_2695784 | | | | Plan Ref. 96/137 Land Ct# #SR Life Estate PP STATU Assoc Pid# | | Total | | 622,700 | 622,700 | | | | | | | |
| RECORD OF OWNERSHIP | | BK-VOL/PAGE | SALE DATE | Q/U | V/I | SALE PRIC | VC | PREVIOUS ASSESSMENTS (HISTORY) | | | | | | | | | | |
| JORDAN, OSWALD L | | 7463 0125 | 03-15-1991 | U | I | 1 | A | Year | Code | Assessed | Year | Code | Assessed | Year | Code | Assessed | | |
| JORDAN, OSWALD L | | 7463 0119 | 03-15-1991 | U | I | 1 | A | 2023 | 1010 | 352,900 | 2022 | 1010 | 310,700 | 2021 | 1010 | 251,200 | | |
| JORDAN, OSWALD L & EVA A | | 2950 0265 | 07-12-1979 | U | | 0 | | | 1010 | 225,300 | | 1010 | 166,400 | | 1010 | 166,400 | | |
| | | | | | | | | Total | | 578,200 | Total | | 477,100 | Total | | 420,300 | | |
| EXEMPTIONS | | | OTHER ASSESSMENTS | | | | This signature acknowledges a visit by a Data Collector or Assessor | | | | | | | | | | | |
| Year | Code | Description | Amount | Code | Description | Number | Amount | Comm Int | | | | | | | | | | |
| | | | | | | | | | | | | | | | | | | |
| | | | | | | | | | | | | | | | | | | |
| | | | 0.00 | | | | | | | | | | | | | | | |
| ASSESSING NEIGHBORHOOD | | | | | | | | | | APPRAISED VALUE SUMMARY | | | | | | | | |
| Nbhd | | Nbhd Name | | B | | Tracing | | Batch | | Appraised Bldg. Value (Card) | | | | | | 309,400 | | |
| 0106 | | | | | | | | HYAN | | Appraised Xf (B) Value (Bldg) | | | | | | 84,900 | | |
| | | | | | | | | | | Appraised Ob (B) Value (Bldg) | | | | | | 2,700 | | |
| | | | | | | | | | | Appraised Land Value (Bldg) | | | | | | 225,700 | | |
| | | | | | | | | | | Special Land Value | | | | | | 0 | | |
| | | | | | | | | | | Total Appraised Parcel Value | | | | | | 622,700 | | |
| | | | | | | | | | | Valuation Method | | | | | | C | | |
| | | | | | | | | | | Total Appraised Parcel Value | | | | | | 622,700 | | |
| BUILDING PERMIT RECORD | | | | | | | | | | VISIT / CHANGE HISTORY | | | | | | | | |
| Permit Id | Issue Date | Type | Description | Amount | Insp Date | % Comp | Date Comp | Comments | | Date | Id | Type | Is | Cd | Purpost/Result | | | |
| B36820 | 06-01-1994 | AD | Addition | 100,000 | 01-15-1996 | 100 | 12-31-1996 | HP FIRE | | 05-26-2020 | WD | | | FR | Field Review | | | |
| | | | | | | | | | | 10-05-2017 | SR | 02 | | 03 | Cycl Insp Comp | | | |
| | | | | | | | | | | 03-27-2012 | DR | 03 | | 16 | In Office Review | | | |
| | | | | | | | | | | 12-15-1988 | ML | 01 | | 00 | Meas/Listed-Interior Acces | | | |
| LAND LINE VALUATION SECTION | | | | | | | | | | | | | | | | | | |
| B | Use Code | Description | Zone | LA | Land Units | Unit Price | Size Adj | AC Disc | Site Index | Cond. | Nbhd. | Nbhd. Adj | Notes | | Location Adjustmen | Adj Unit P | Land Value | |
| 1 | 1010 | Single Fam M-0 | RB | 4 | 1.000 AC | 176,344.00 | 1.00000 | 1.0000 | 5 | 1.00 | 0106 | 1.150 | | | 1.0000 | 202,795.6 | 202,800 | |
| 1 | 1010 | Single Fam M-0 | RB | 4 | 1.400 AC | 14,250.00 | 1.00000 | 1.0000 | 0 | 1.00 | 0106 | 1.150 | | | 1.0000 | 16,387.5 | 22,900 | |
| Total Card Land Units | | | | | 2.40 | AC | Parcel Total Land Area | | | | | 2.40 | Total Land Value | | | | | 225,700 |

| CONSTRUCTION DETAIL | | | CONSTRUCTION DETAIL (CONTINUED) | | |
|--------------------------------|----|----------------|---------------------------------|---------|-------------|
| Element | Cd | Description | Element | Cd | Description |
| Style | 01 | Ranch | | | |
| Model | 01 | Residential | | | |
| Grade: | C | Average | | | |
| Stories | 1 | 1 Story | | | |
| Exterior Wall 1 | 14 | Wood Shingle | | | |
| Exterior Wall 2 | | | | | |
| RooF Structure | 03 | Gable/Hip | | | |
| RooF Cover | 03 | Asph/F Gls/Cmp | | | |
| Interior Wall 1 | 05 | Drywall | | | |
| Interior Wall 2 | | | | | |
| Interior Floor 1 | 14 | Carpet | | | |
| Interior Floor 2 | 12 | Hardwood | | | |
| Heat Fuel | 02 | Oil | | | |
| Heat Type | 05 | Hot Water | | | |
| AC Type | 01 | None | | | |
| Bedrooms | 04 | 4 Bedrooms | | | |
| Full Baths | 3 | | | | |
| Half Baths | 0 | | | | |
| Extra Fixtures | | | | | |
| Total Rooms | 12 | 12 Rooms | | | |
| Bath Style | | | | | |
| Kitchen Style | | | | | |
| Occupancy | | | | | |
| UsrflD 105 | | | | | |
| Accessory Apt | | | | | |
| Foundation Alt | 02 | Conc. Block | | | |
| Rms Prts | | | | | |
| Bath Split | 30 | 3 Full-0 Half | | | |
| | | | CONDO DATA | | |
| Parcel Id | | | C | Owne | 0.0 |
| Adjust Type | | Code | Description | Factor% | |
| Condo Flr | | Condo Unit | | | |
| COST / MARKET VALUATION | | | | | |
| Building Value New | | | 468,807 | | |
| Year Built | | | 1949 | | |
| Effective Year Built | | | 1975 | | |
| Depreciation Code | | | F | | |
| Remodel Rating | | | | | |
| Year Remodeled | | | | | |
| Depreciation % | | | 34 | | |
| Functional Obsol | | | 0 | | |
| External Obsol | | | 0 | | |
| Trend Factor | | | 1 | | |
| Condition | | | | | |
| Condition % | | | | | |
| Percent Good | | | 66 | | |
| RCNLD | | | 309,400 | | |
| Dep % Ovr | | | | | |
| Dep Ovr Comment | | | | | |
| Misc Imp Ovr | | | | | |
| Misc Imp Ovr Comment | | | | | |
| Cost to Cure Ovr | | | | | |
| Cost to Cure Ovr Comment | | | | | |

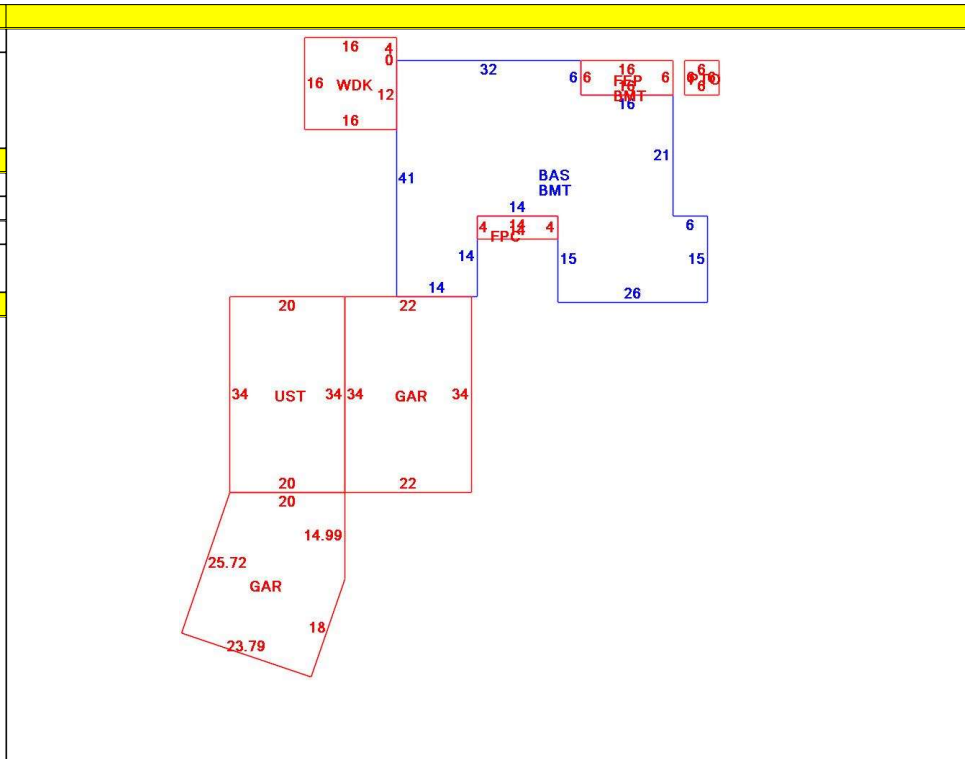

| OB - OUTBUILDING & YARD ITEMS(L) / XF - BUILDING EXTRA FEATURES(B) | | | | | | | | | | |
|--------------------------------------------------------------------|------------------|-----|-------|------------|--------|----------|------|-------|------------|-------------|
| Code | Description | L/B | Units | Unit Price | Yr Blt | Cond. Cd | % Gd | Grade | Grade Adj. | Appr. Value |
| BRR | Bsmt Rec Rm- | B | 1,095 | 8.05 | 1977 | | 66 | | 0.00 | 5,800 |
| FPL1 | Fireplace 1 sto | B | 1 | 5000.00 | 1977 | | 66 | | 0.00 | 3,300 |
| FPO | Ext FP Openin | B | 1 | 2000.00 | 1977 | | 66 | | 0.00 | 1,300 |
| WDC | Wood Decking | L | 256 | 20.00 | 1990 | | 42 | | 0.00 | 2,300 |
| FOPC | Open Prch-roo | B | 56 | 55.00 | 1977 | | 66 | | 0.00 | 2,000 |
| FEP | Enclosed porc | B | 96 | 70.00 | 1977 | | 66 | | 0.00 | 5,400 |
| GAR | Attached Gara | B | 1,418 | 40.00 | 1977 | | 66 | | 0.00 | 27,400 |
| UST | Utility Storage- | B | 680 | 17.11 | 1977 | | 100 | | 0.00 | 11,600 |
| BMT | Basement-Unfi | B | 1,882 | 26.01 | 1977 | | 66 | | 0.00 | 28,100 |
| PATC | Conc Pavers | L | 36 | 15.46 | 1992 | | 46 | | 0.00 | 400 |

| BUILDING SUB-AREA SUMMARY SECTION | | | | | | |
|-----------------------------------|------------------------|-------------|------------|----------|-----------|----------------|
| Code | Description | Living Area | Floor Area | Eff Area | Unit Cost | Undeprec Value |
| BAS | First Floor | 1,786 | 1,786 | 1,786 | 262.49 | 468,807 |
| BMT | Basement Area | 0 | 1,882 | 0 | 0.00 | 0 |
| FEP | Enclosed Porch | 0 | 96 | 0 | 0.00 | 0 |
| FPC | Open Porch Conc. Floor | 0 | 56 | 0 | 0.00 | 0 |
| GAR | Attached Garage | 0 | 1,418 | 0 | 0.00 | 0 |
| PTO | Patio | 0 | 36 | 0 | 0.00 | 0 |
| UST | Utility Enclosure | 0 | 680 | 0 | 0.00 | 0 |
| WDK | Wood Deck | 0 | 256 | 0 | 0.00 | 0 |
| Ttl Gross Liv / Lease Area | | 1,786 | 6,210 | 1,786 | | 468,807 |

