

| CURRENT OWNER | | TOPO | UTILITIES | STRT / ROAD | LOCATION | CURRENT ASSESSMENT | | | | 801 FY2024 BARNSTABLE, MA VISION | |
|--|--|---------|----------------|---|----------|--------------------|------|----------|----------|--|---------|
| PHELAN, MARY J & PAULA JR TRS MARY J PHELAN REVOCABLE LIVIN 42 BRIARWOOD AVENUE HYANNIS MA 02601 | | 1 Level | 2 Public Water | 1 Paved | | Description | Code | Assessed | Assessed | | |
| | | | 4 Gas | | | RESIDNTL | 1010 | 560,000 | 560,000 | | |
| | | | 6 Septic | | | RES LAND | 1010 | 174,000 | 174,000 | | |
| SUPPLEMENTAL DATA | | | | | | Total | | | | 734,000 | 734,000 |
| Alt Prcl ID Split Zonin BID Parcel ResExpt Q YES: #DL 1 LOT 29 #DL 2 GIS ID F_983994_2697140 | | | | Plan Ref. 38/91 Land Ct# #SR Life Estate PP STATU Assoc Pid# | | | | | | | |

| RECORD OF OWNERSHIP | | BK-VOL/PAGE | SALE DATE | Q/U | V/I | SALE PRIC | VC | PREVIOUS ASSESSMENTS (HISTORY) | | | | | |
|-------------------------------|--|-------------|------------|-----|-----|-----------|----|--------------------------------|-------|----------|-------|---------|----------|
| PHELAN, MARY J & PAULA JR TRS | | 31930 0187 | 04-04-2019 | U | I | 1 | 1F | Year | Code | Assessed | Year | Code | Assessed |
| PHELAN, MARY TR | | 25454 0053 | 05-18-2011 | U | I | 10 | 1F | 2023 | 1010 | 497,100 | 2022 | 1010 | 422,500 |
| PHELAN, MARY | | 25439 0121 | 05-11-2011 | U | I | 0 | 1 | | 1010 | 171,900 | | 1010 | 122,200 |
| PHELAN, PAULA & MARY | | 2144 0051 | 01-24-1975 | U | | 0 | | | | | | 1010 | 3,200 |
| Total | | | | | | | | 669,000 | Total | 544,700 | Total | 487,200 | |

| EXEMPTIONS | | | | OTHER ASSESSMENTS | | | | This signature acknowledges a visit by a Data Collector or Assessor | | | | |
|------------|------|-----------------------|--------|-------------------|-------------|--------|--------|---|--|--|--|--|
| Year | Code | Description | Amount | Code | Description | Number | Amount | Comm Int | | | | |
| 2014 | 5C | RESIDENTIAL EXEMPTION | 0.00 | | | | | | | | | |
| Total | | | 0.00 | | | | | | | | | |

| ASSESSING NEIGHBORHOOD | | | | APPRAISED VALUE SUMMARY | | | | |
|------------------------|-----------|---|---------|-------------------------|--|--|--|--|
| Nbhd | Nbhd Name | B | Tracing | Batch | | | | |
| 0106 | | | | HYAN | | | | |

| NOTES | | | | APPRAISED VALUE SUMMARY | | | | |
|-------|--|--|--|-------------------------------|---------|--|--|--|
| | | | | Appraised Bldg. Value (Card) | 497,300 | | | |
| | | | | Appraised Xf (B) Value (Bldg) | 59,500 | | | |
| | | | | Appraised Ob (B) Value (Bldg) | 3,200 | | | |
| | | | | Appraised Land Value (Bldg) | 174,000 | | | |
| | | | | Special Land Value | 0 | | | |
| | | | | Total Appraised Parcel Value | 734,000 | | | |
| | | | | Valuation Method | C | | | |
| | | | | Total Appraised Parcel Value | 734,000 | | | |

| BUILDING PERMIT RECORD | | | | | | | | | VISIT / CHANGE HISTORY | | | | | |
|------------------------|------------|------|-------------|--------|------------|--------|------------|-----------|------------------------|----|------|----|----|----------------------------|
| Permit Id | Issue Date | Type | Description | Amount | Insp Date | % Comp | Date Comp | Comments | Date | Id | Type | Is | Cd | Purpost/Result |
| B37452 | 02-01-1995 | DW | Dwelling | 91,000 | 01-15-1996 | 100 | 01-01-1997 | HY 2 STOR | 05-26-2020 | WD | | | FR | Field Review |
| | | | | | | | | | 01-26-2018 | SR | 02 | | 03 | Cycl Insp Comp |
| | | | | | | | | | 11-06-2013 | GC | 03 | | 16 | In Office Review |
| | | | | | | | | | 05-10-2012 | LH | 03 | | 16 | In Office Review |
| | | | | | | | | | 10-14-2011 | RB | 03 | | 16 | In Office Review |
| | | | | | | | | | 02-12-2002 | PT | 01 | | 00 | Meas/Listed-Interior Acces |
| | | | | | | | | | 08-12-1997 | LK | 02 | | 01 | Meas/Est |

| LAND LINE VALUATION SECTION | | | | | | | | | | | | | | | | |
|-----------------------------|----------|----------------|------|----|------------|------------|------------------------|---------|------------|-------|-------|-----------|------------------|--------------------|------------|------------|
| B | Use Code | Description | Zone | LA | Land Units | Unit Price | Size Adj | AC Disc | Site Index | Cond. | Nbhd. | Nbhd. Adj | Notes | Location Adjustmen | Adj Unit P | Land Value |
| 1 | 1010 | Single Fam M-0 | RB | 4 | 0.320 AC | 176,344.00 | 2.68059 | 1.0000 | 5 | 1.00 | 0106 | 1.150 | | 1.0000 | 543,615.6 | 174,000 |
| Total Card Land Units | | | | | 0.32 | AC | Parcel Total Land Area | | | | | 0.32 | Total Land Value | | | 174,000 |

| CONSTRUCTION DETAIL | | | CONSTRUCTION DETAIL (CONTINUED) | | |
|---------------------|------|----------------|---------------------------------|----|-------------|
| Element | Cd | Description | Element | Cd | Description |
| Style | 04 | Cape Cod | | | |
| Model | 01 | Residential | | | |
| Grade: | C | Average | | | |
| Stories | 1.75 | 1 3/4 Stories | | | |
| Exterior Wall 1 | 11 | Clapboard | | | |
| Exterior Wall 2 | 14 | Wood Shingle | | | |
| RooF Structure | 03 | Gable/Hip | | | |
| RooF Cover | 03 | Asph/F Gls/Cmp | | | |
| Interior Wall 1 | 03 | Plastered | | | |
| Interior Wall 2 | | | | | |
| Interior Floor 1 | 12 | Hardwood | | | |
| Interior Floor 2 | | | | | |
| Heat Fuel | 03 | Gas | | | |
| Heat Type | 05 | Hot Water | | | |
| AC Type | 03 | Central | | | |
| Bedrooms | 03 | 3 Bedrooms | | | |
| Full Baths | 2 | | | | |
| Half Baths | 1 | | | | |
| Extra Fixtures | | | | | |
| Total Rooms | 6 | 6 Rooms | | | |
| Bath Style | | | | | |
| Kitchen Style | | | | | |
| Occupancy | | | | | |
| Usrflid 105 | | | | | |
| Accessory Apt | | | | | |
| Foundation Alt | 01 | Poured Conc. | | | |
| Rms Prts | | | | | |
| Bath Split | 21 | 2 Full-1 Half | | | |

| CONDO DATA | | | | |
|-------------|------|-------------|---------|----------|
| Parcel Id | C | B | S | Owne 0.0 |
| | | | | |
| Adjust Type | Code | Description | Factor% | |
| Condo Flr | | | | |
| Condo Unit | | | | |

| COST / MARKET VALUATION | | |
|--------------------------|--|---------|
| Building Value New | | 565,150 |
| Year Built | | 1996 |
| Effective Year Built | | 2004 |
| Depreciation Code | | A |
| Remodel Rating | | |
| Year Remodeled | | |
| Depreciation % | | 12 |
| Functional Obsol | | 0 |
| External Obsol | | 0 |
| Trend Factor | | 1 |
| Condition | | |
| Condition % | | |
| Percent Good | | 88 |
| RCNLD | | 497,300 |
| Dep % Ovr | | |
| Dep Ovr Comment | | |
| Misc Imp Ovr | | |
| Misc Imp Ovr Comment | | |
| Cost to Cure Ovr | | |
| Cost to Cure Ovr Comment | | |

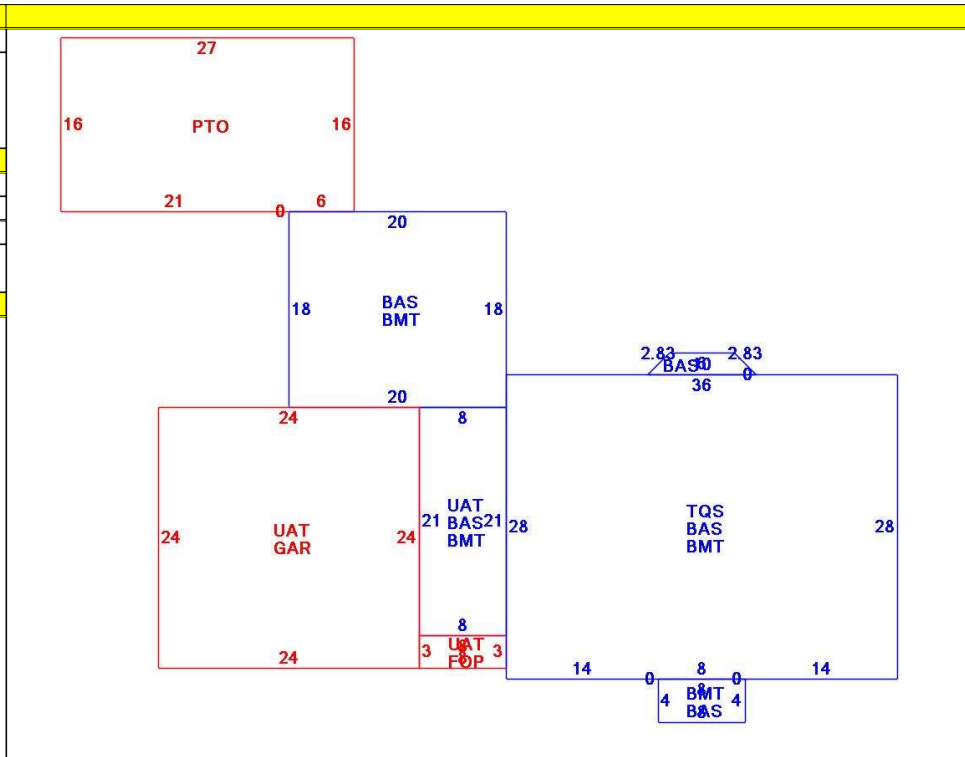

| OB - OUTBUILDING & YARD ITEMS(L) / XF - BUILDING EXTRA FEATURES(B) | | | | | | | | | | |
|--|-----------------|-----|-------|------------|--------|----------|------|-------|------------|-------------|
| Code | Description | L/B | Units | Unit Price | Yr Blt | Cond. Cd | % Gd | Grade | Grade Adj. | Appr. Value |
| FPL2 | Fireplace 1.5 s | B | 1 | 6000.00 | 2006 | | 88 | | 0.00 | 5,300 |
| FOP | Open Porch-ro | B | 24 | 55.00 | 2006 | | 88 | | 0.00 | 1,800 |
| GAR | Attached Gara | B | 576 | 40.00 | 2006 | | 88 | | 0.00 | 18,000 |
| BMT | Basement-Unfi | B | 1,568 | 26.01 | 2006 | | 88 | | 0.00 | 32,200 |
| FPLG | Gas Fireplace- | B | 1 | 2500.00 | 2006 | | 88 | | 0.00 | 2,200 |
| PAT2 | Patio-Good | L | 432 | 9.94 | 1996 | | 77 | | 0.00 | 3,200 |

| BUILDING SUB-AREA SUMMARY SECTION | | | | | | |
|-----------------------------------|---------------------|-------------|------------|----------|-----------|----------------|
| Code | Description | Living Area | Floor Area | Eff Area | Unit Cost | Undeprec Value |
| BAS | First Floor | 1,584 | 1,584 | 1,584 | 244.02 | 386,528 |
| BMT | Basement Area | 0 | 1,568 | 0 | 0.00 | 0 |
| FOP | Open Porch | 0 | 24 | 0 | 0.00 | 0 |
| GAR | Attached Garage | 0 | 576 | 0 | 0.00 | 0 |
| PTO | Patio | 0 | 432 | 0 | 0.00 | 0 |
| TQS | Three Quarter Story | 655 | 1,008 | 655 | 158.56 | 159,833 |
| UAT | Attic, Unfinished | 0 | 768 | 77 | 24.47 | 18,790 |
| Ttl Gross Liv / Lease Area | | 2,239 | 5,960 | 2,316 | | 565,151 |

