

| CURRENT OWNER | | TOPO | UTILITIES | STRT / ROAD | LOCATION | CURRENT ASSESSMENT | | | | | | 801 FY2024 BARNSTABLE, MA | | | | | | |
|----------------------------------|------------|--------------------------|-------------------|---------------------|-------------|--------------------|---|--------------------------------|------------|-------------------------------|-------|---------------------------------|----------|--------------------|------------------|------------|--|---|
| DE MOURA, PAULA | | | | | | Description | Code | Assessed | Assessed | | | | | | | | | |
| 166 WEQUAQUET LANE | | | | | | RESIDNTL | 1020 | 240,600 | 240,600 | | | | | | | | | |
| CENTERVILLE MA 02632 | | SUPPLEMENTAL DATA | | | | | | | | | | | | | | | | |
| Alt Prcl ID | | Split Zonin RB;HB | | Plan Ref. 354/95-96 | | | | | | | | | | | | | | |
| #DL 1 UNIT 1F | | GIS ID F_984576_2699149 | | Land Ct# | | | | | | | | | | | | | | |
| #DL 2 | | | | #SR | | | | | | | | | | | | | | |
| | | | | Life Estate | | | | | | | | | | | | | | |
| | | | | PP STATU | | | | | | | | | | | | | | |
| | | | | Assoc Pid# | | | | | | | | | | | | | | |
| | | | | | | Total | | 240,600 | 240,600 | | | | | | | | | |
| RECORD OF OWNERSHIP | | BK-VOL/PAGE | SALE DATE | Q/U | V/I | SALE PRICE | VC | PREVIOUS ASSESSMENTS (HISTORY) | | | | | | | | | | |
| DE MOURA, PAULA | | 35266 268 | 07-25-2022 | Q | I | 262,000 | 00 | Year | Code | Assessed | Year | Code | Assessed | Year | Code | Assessed | | |
| CHUNG, KAR CHUN & VIRGINIA M TRS | | 27597 0277 | 08-05-2013 | U | I | 1 | 1F | 2023 | 1020 | 232,400 | 2022 | 1020 | 125,700 | 2021 | 1020 | 125,000 | | |
| CHUNG, KAR C & VIRGINIA M | | 9623 0338 | 04-15-1995 | U | I | 35,100 | L | | | | | | | | 1020 | 2,100 | | |
| BOYDSTON, CLARK & MARY | | 3677 0259 | 02-15-1983 | Q | I | 50,000 | U | | | | | | | | | | | |
| HORAN, ROBERT F & CONSTANCE C | | 3573 0264 | 10-01-1982 | Q | I | 50,000 | U | | | | | | | | | | | |
| | | Total | | | | 232,400 | | Total | | 125,700 | Total | | 127,100 | | | | | |
| EXEMPTIONS | | | OTHER ASSESSMENTS | | | | This signature acknowledges a visit by a Data Collector or Assessor | | | | | | | | | | | |
| Year | Code | Description | Amount | Code | Description | Number | Amount | Comm Int | | | | | | | | | | |
| | | | | | | | | | | | | | | | | | | |
| | | Total | | | | 0.00 | | | | | | | | | | | | |
| ASSESSING NEIGHBORHOOD | | | | | | | | | | APPRAISED VALUE SUMMARY | | | | | | | | |
| Nbhd | | Nbhd Name | | B | | Tracing | | Batch | | Appraised Bldg. Value (Card) | | | | | | 238,500 | | |
| 0001 | | | | | | | | HYAN | | Appraised Xf (B) Value (Bldg) | | | | | | 0 | | |
| | | | | | | | | | | Appraised Ob (B) Value (Bldg) | | | | | | 2,100 | | |
| | | | | | | | | | | Appraised Land Value (Bldg) | | | | | | 0 | | |
| | | | | | | | | | | Special Land Value | | | | | | 0 | | |
| | | | | | | | | | | Total Appraised Parcel Value | | | | | | 240,600 | | |
| | | | | | | | | | | Valuation Method | | | | | | C | | |
| | | | | | | | | | | Total Appraised Parcel Value | | | | | | 240,600 | | |
| BUILDING PERMIT RECORD | | | | | | | | | | VISIT / CHANGE HISTORY | | | | | | | | |
| Permit Id | Issue Date | Type | Description | Amount | Insp Date | % Comp | Date Comp | Comments | Date | Id | Type | Is | Cd | Purpost/Result | | | | |
| | | | | | | | | | 05-09-2023 | CK | 04 | | 20 | Sale Review | | | | |
| | | | | | | | | | 04-30-2020 | WD | | | FR | Field Review | | | | |
| | | | | | | | | | 12-14-2018 | SR | 02 | | 03 | Cycl Insp Comp | | | | |
| | | | | | | | | | 12-21-2015 | TP | 03 | | 16 | In Office Review | | | | |
| | | | | | | | | | 07-31-2015 | AL | 22 | | 22 | Change of Address | | | | |
| | | | | | | | | | 07-30-2015 | TP | 03 | | 16 | In Office Review | | | | |
| LAND LINE VALUATION SECTION | | | | | | | | | | | | | | | | | | |
| B | Use Code | Description | Zone | Dist | Land Type | Land Units | Unit Price | Size Adj | Site Index | Cond. | Nbhd. | Nbhd. Adj | Notes | Location Adjustmen | Adj Unit P | Land Value | | |
| 1 | 102U | Condominium M | SPLI | 4 | | 0 SF | 0.00 | 1.00000 | 5 | 1.00 | 0001 | 1.000 | | 0.0000 | 0 | 0 | | |
| Total Card Land Units | | | | | | 0 | SF | Parcel Total Land Area | | | | | | 0.00 | Total Land Value | | | 0 |

VISION

| CONSTRUCTION DETAIL | | | CONSTRUCTION DETAIL (CONTINUED) | | |
|--------------------------------|----------|---------------|---------------------------------|-----|-------------|
| Element | Cd | Description | Element | Cd | Description |
| Style | 55 | Condominium | | | |
| Model | 05 | Res Condo | | | |
| Bedrm Func | C- | Average Minus | | | |
| Stories | 1 | 1 Story | | | |
| Occupancy | 0 | | | | |
| Interior Wall 1 | 05 | Drywall | | | |
| Interior Wall 2 | | | | | |
| Interior Floor 1 | 14 | Carpet | | | |
| Interior Floor 2 | | | | | |
| Heat Fuel | 03 | Gas | | | |
| Heat Type | 04 | Hot Air | | | |
| AC Type | 01 | None | | | |
| Bedrooms | 02 | 2 Bedrooms | | | |
| Full Baths | 2 | 2 Full | | | |
| Half Baths | 0 | | | | |
| Extra Fixtures | | | | | |
| Total Rooms | 4 | 4 Rooms | | | |
| Bath Style | | | | | |
| Kitchen Style | | | | | |
| Master Deed L | 892 | | | | |
| Bath Split | 20 | 2 Full-0 Half | | | |
| Foundation | 03 | Conc. Slab | | | |
| AC Type Alt | | | | | |
| Sewer Occupan | | | | | |
| CONDO DATA | | | | | |
| Parcel Id | 104257 | C 0410 | Ownr | 6.2 | |
| | PONDSIDE | B 1 | S 1 | | |
| Adjust Type | Code | Description | Factor% | | |
| Condo Flr | 2FU | SECOND FLOOR | 100 | | |
| Condo Unit | MKT0 | MKT0 | 100 | | |
| COST / MARKET VALUATION | | | | | |
| Building Value New | | 280,533 | | | |
| Year Built | | 1981 | | | |
| Effective Year Built | | 2000 | | | |
| Depreciation Code | | A | | | |
| Remodel Rating | | | | | |
| Year Remodeled | | | | | |
| Depreciation % | | 15 | | | |
| Functional Obsol | | 0 | | | |
| External Obsol | | 0 | | | |
| Trend Factor | | 1 | | | |
| Condition | | | | | |
| Condition % | | | | | |
| Percent Good | | 85 | | | |
| Cns Sect Rcnd | | 238,500 | | | |
| Dep % Ovr | | | | | |
| Dep Ovr Comment | | | | | |
| Misc Imp Ovr | | | | | |
| Misc Imp Ovr Comment | | | | | |
| Cost to Cure Ovr | | | | | |
| Cost to Cure Ovr Comment | | | | | |

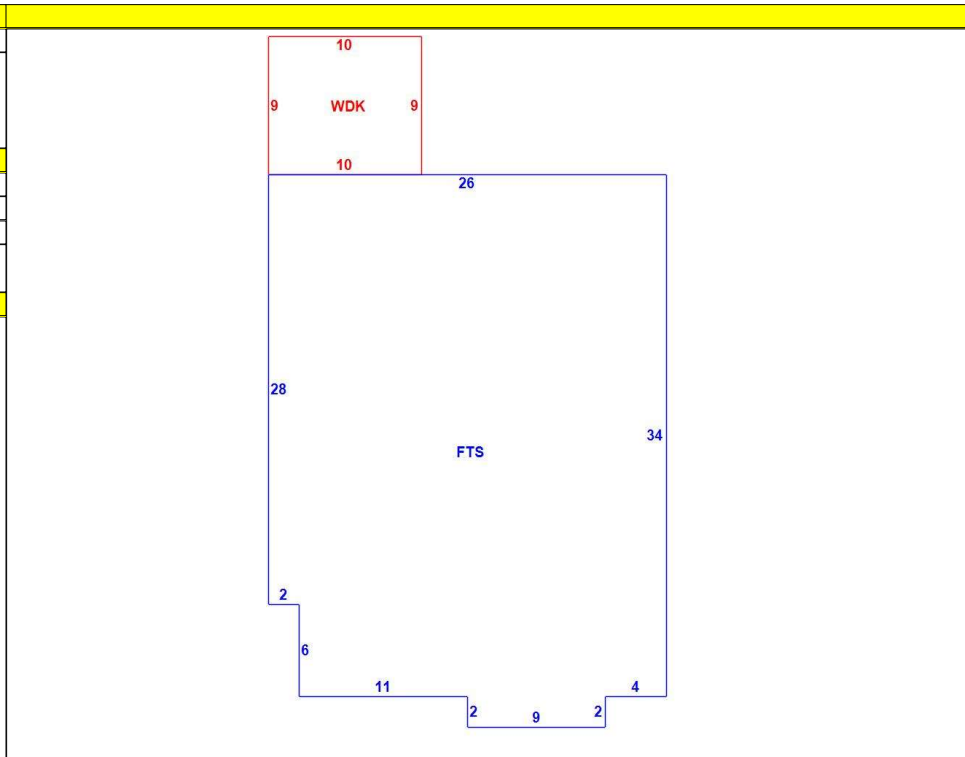

OB - OUTBUILDING & YARD ITEMS(L) / XF - BUILDING EXTRA FEATURES(B)

| Code | Description | L/B | Units | Unit Price | Yr Blt | Cond. Cd | % Gd | Grade | Grade Adj. | Appr. Value |
|------|--------------|-----|-------|------------|--------|----------|------|-------|------------|-------------|
| WDC | Wood Decking | L | 90 | 20.00 | 1999 | | 60 | | 0.00 | 2,100 |

BUILDING SUB-AREA SUMMARY SECTION

| Code | Description | Living Area | Floor Area | Eff Area | Unit Cost | Undeprec Value |
|----------------------------|----------------------|-------------|------------|----------|-----------|----------------|
| FTS | Finished Third Story | 890 | 890 | 890 | 315.21 | 280,533 |
| WDC | Wood Deck | 0 | 90 | 0 | 0.00 | 0 |
| Ttl Gross Liv / Lease Area | | 890 | 980 | 890 | | 280,533 |

