

| CURRENT OWNER | | TOPO | | UTILITIES | | STRT / ROAD | | LOCATION | | CURRENT ASSESSMENT | | | | 801 FY2024 BARNSTABLE, MA | | | | |
|----------------------------------|------------|-------------------------|----------------|-------------------|-------------------------|-------------|-------------|---|------------|------------------------|-------|-----------|----------|---------------------------------|-----------------------|------------|------------------|---------|
| 177 MEGAN ROAD | | 1 | Level | 2 | Public Water | 1 | Paved | | | Description | Code | Assessed | Assessed | | | | | |
| HOLMES, FIDELLA S | | 4 | Gas | | | | | | | RESIDNTL | 1010 | 346,600 | 346,600 | | | | | |
| | | 6 | Septic | | | | | | | RES LAND | 1010 | 137,300 | 137,300 | | | | | |
| SUPPLEMENTAL DATA | | | | | | | | | | | | | | VISION | | | | |
| Alt Prcl ID | | | | | Plan Ref. | | | | | | | | | | | | | |
| Split Zonin | | | | | Land Ct# 27099-B (SH 4) | | | | | | | | | | | | | |
| BID Parcel | | | | | #SR | | | | | | | | | | | | | |
| HYANNIS MA 02601 | | ResExpt Q YES: LOT 27 | | | | | Life Estate | | | | | | | | | | | |
| | | #DL 1 | | | | | PP STATU | | | | | | | | | | | |
| | | #DL 2 | | | | | Assoc Pid# | | | | | | | | | | | |
| | | GIS ID F_983473_2702276 | | | | | | | | | | Total | | 483,900 | 483,900 | | | |
| RECORD OF OWNERSHIP | | BK-VOL/PAGE | | SALE DATE | | Q/U | | V/I | | SALE PRIC | | VC | | PREVIOUS ASSESSMENTS (HISTORY) | | | | |
| HOLMES, FIDELLA S | | C208300 | 0 | 12-18-2015 | | Q | I | | | 247,000 | 00 | Year | Code | Assessed | Year | Code | Assessed | |
| MENDES, GREGGORY C & KELLEY, KRI | | C191359 | 0 | 05-07-2010 | | U | I | | | 185,000 | 1S | 2023 | 1010 | 297,700 | 2022 | 1010 | 256,400 | |
| US BANK NATIONAL ASSOCIATION TR | | C190629 | 0 | 01-29-2010 | | U | I | | | 135,000 | 1L | | 1010 | 131,800 | | 1010 | 97,600 | |
| HOUGHTON, MARISETE | | C173140 | 0 | 05-26-2004 | | Q | I | | | 290,000 | 00 | | | | | 1010 | 4,200 | |
| BRADLEY, EDWARD F & DOROTHY C | | C105152 | 0 | 01-15-1986 | | Q | I | | | 94,000 | U | | | | | | | |
| | | | | | | | | | | Total | | 429,500 | Total | | 354,000 | Total | | 302,300 |
| EXEMPTIONS | | | | OTHER ASSESSMENTS | | | | This signature acknowledges a visit by a Data Collector or Assessor | | | | | | | | | | |
| Year | Code | Description | | Amount | Code | Description | Number | Amount | Comm Int | | | | | | | | | |
| 2018 | 5C | RESIDENTIAL EXEMPTION | | 0.00 | | | | | | | | | | | | | | |
| | | | | Total | | | | | 0.00 | | | | | | | | | |
| ASSESSING NEIGHBORHOOD | | | | | | | | | | | | | | | | | | |
| Nbhd | | Nbhd Name | | B | | Tracing | | Batch | | | | | | | | | | |
| 0104 | | | | | | | | HYAN | | | | | | | | | | |
| NOTES | | | | | | | | | | | | | | | | | | |
| | | | | | | | | | | | | | | | | | | |
| | | | | | | | | | | | | | | | | | | |
| | | | | | | | | | | | | | | | | | | |
| | | | | | | | | | | | | | | | | | | |
| | | | | | | | | | | | | | | | | | | |
| | | | | | | | | | | | | | | | | | | |
| BUILDING PERMIT RECORD | | | | | | | | | | VISIT / CHANGE HISTORY | | | | | | | | |
| Permit Id | Issue Date | Type | Description | Amount | Insp Date | % Comp | Date Comp | Comments | | Date | Id | Type | Is | Cd | Purpost/Result | | | |
| 19-1102 | 04-05-2019 | 835 | Sid/Wind/Roof/ | 21,367 | | 100 | | strip roof shingles and re-roof | | 05-01-2020 | WD | | | FR | Field Review | | | |
| 201001988 | 05-24-2010 | RE | Remodel | 700 | 11-12-2010 | 100 | 06-30-2011 | RESTORE TO SINGLE FAMIL | | 01-17-2018 | KM | 02 | | 03 | Cycl Insp Comp | | | |
| | | | | | | | | | | 12-08-2017 | GC | 03 | | 16 | In Office Review | | | |
| | | | | | | | | | | 06-10-2016 | JR | 03 | | 20 | Sale Review | | | |
| | | | | | | | | | | 08-24-2015 | GC | 03 | | 16 | In Office Review | | | |
| | | | | | | | | | | 03-16-2011 | RB | 03 | | 02 | Bldg Permit Completed | | | |
| | | | | | | | | | | 11-12-2010 | MK | 02 | | 52 | New Construction | | | |
| LAND LINE VALUATION SECTION | | | | | | | | | | | | | | | | | | |
| B | Use Code | Description | Zone | LA | Land Units | Unit Price | Size Adj | AC Disc | Site Index | Cond. | Nbhd. | Nbhd. Adj | Notes | Location Adjustmen | Adj Unit P | Land Value | | |
| 1 | 1010 | Single Fam M-0 | RB | 4 | 0.360 | AC | 176,344.00 | 2.40337 | 1.0000 | 5 | 1.00 | 0104 | 0.900 | | 1.0000 | 381,432.0 | | |
| | | | | | Total Card Land Units | 0.36 | AC | Parcel Total Land Area | | | | | 0.36 | | | | Total Land Value | 137,300 |

| CONSTRUCTION DETAIL | | | CONSTRUCTION DETAIL (CONTINUED) | | |
|---------------------|----|----------------|---------------------------------|----|-------------|
| Element | Cd | Description | Element | Cd | Description |
| Style | 01 | Ranch | | | |
| Model | 01 | Residential | | | |
| Grade: | C | Average | | | |
| Stories | 1 | 1 Story | | | |
| Exterior Wall 1 | 14 | Wood Shingle | | | |
| Exterior Wall 2 | 11 | Clapboard | | | |
| RooF Structure | 03 | Gable/Hip | | | |
| RooF Cover | 03 | Asph/F Gls/Cmp | | | |
| Interior Wall 1 | 05 | Drywall | | | |
| Interior Wall 2 | | | | | |
| Interior Floor 1 | 12 | Hardwood | | | |
| Interior Floor 2 | | | | | |
| Heat Fuel | 03 | Gas | | | |
| Heat Type | 04 | Hot Air | | | |
| AC Type | 03 | Central | | | |
| Bedrooms | 03 | 3 Bedrooms | | | |
| Full Baths | 1 | | | | |
| Half Baths | 0 | | | | |
| Extra Fixtures | | | | | |
| Total Rooms | 6 | 6 Rooms | | | |
| Bath Style | | | | | |
| Kitchen Style | | | | | |
| Occupancy | | | | | |
| Usrflid 105 | | | | | |
| Accessory Apt | | | | | |
| Foundation Alt | 01 | Poured Conc. | | | |
| Rms Prts | | | | | |
| Bath Split | 10 | 1 Full-0 Half | | | |

| CONDO DATA | | | | |
|-------------|------|-------------|---------|-----|
| Parcel Id | | C | Owne | 0.0 |
| Adjust Type | Code | Description | Factor% | |
| Condo Flr | | | | |
| Condo Unit | | | | |

| COST / MARKET VALUATION | |
|--------------------------|---------|
| Building Value New | 349,692 |
| Year Built | 1974 |
| Effective Year Built | 2003 |
| Depreciation Code | VG |
| Remodel Rating | |
| Year Remodeled | |
| Depreciation % | 12 |
| Functional Obsol | 0 |
| External Obsol | 0 |
| Trend Factor | 1 |
| Condition | |
| Condition % | |
| Percent Good | 88 |
| RCNLD | 307,700 |
| Dep % Ovr | |
| Dep Ovr Comment | |
| Misc Imp Ovr | |
| Misc Imp Ovr Comment | |
| Cost to Cure Ovr | |
| Cost to Cure Ovr Comment | |

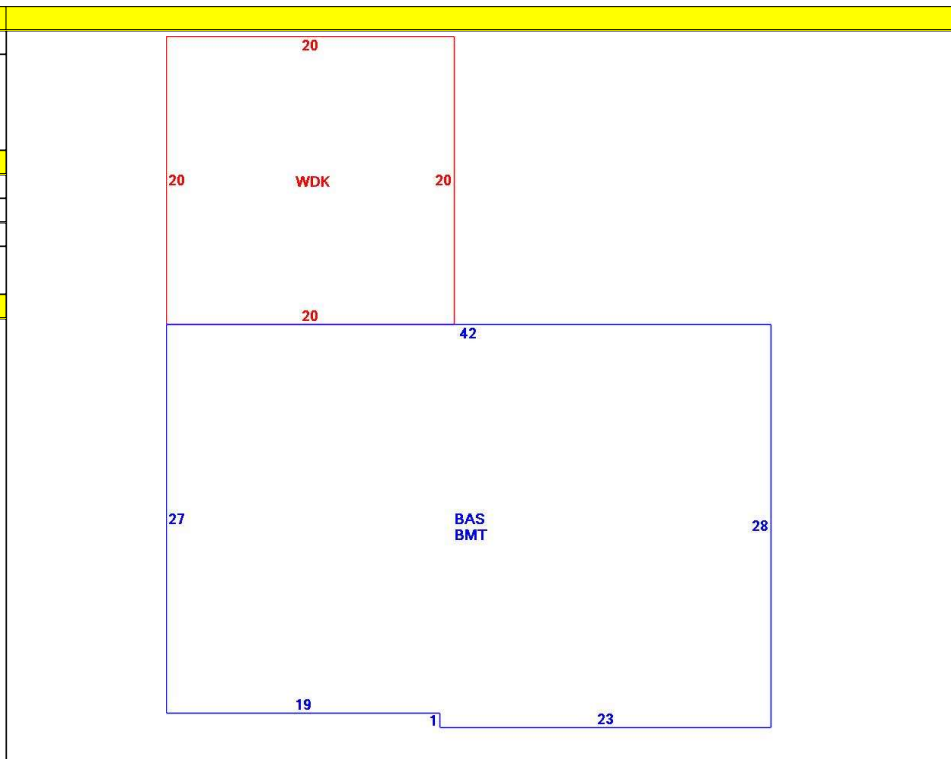

| OB - OUTBUILDING & YARD ITEMS(L) / XF - BUILDING EXTRA FEATURES(B) | | | | | | | | | | |
|--|-----------------|-----|-------|------------|--------|----------|------|-------|------------|-------------|
| Code | Description | L/B | Units | Unit Price | Yr Blt | Cond. Cd | % Gd | Grade | Grade Adj. | Appr. Value |
| FPL1 | Fireplace 1 sto | B | 1 | 5000.00 | 2005 | | 88 | | 0.00 | 4,400 |
| WDC | Wood Decking | L | 400 | 20.00 | 1996 | | 54 | | 0.00 | 4,200 |
| BMT | Basement-Unfi | B | 1,157 | 26.01 | 2005 | | 88 | | 0.00 | 25,700 |
| BFA | Bsmt Fin-Avg | B | 300 | 17.36 | 2005 | | 88 | | 0.00 | 4,600 |

| BUILDING SUB-AREA SUMMARY SECTION | | | | | | |
|-----------------------------------|---------------|-------------|------------|----------|-----------|----------------|
| Code | Description | Living Area | Floor Area | Eff Area | Unit Cost | Undeprec Value |
| BAS | First Floor | 1,157 | 1,157 | 1,157 | 302.24 | 349,692 |
| BMT | Basement Area | 0 | 1,157 | 0 | 0.00 | 0 |
| WDK | Wood Deck | 0 | 400 | 0 | 0.00 | 0 |
| Ttl Gross Liv / Lease Area | | 1,157 | 2,714 | 1,157 | | 349,692 |

