

| CURRENT OWNER | | TOPO | UTILITIES | STRT / ROAD | LOCATION | CURRENT ASSESSMENT | | | | 801 FY2024 BARNSTABLE, MA VISION |
|----------------------------|--|--|----------------|-------------|--|--------------------|-------|----------|----------|--|
| RAUSCH, JOSEPH P & CYNTHIA | | 1 Level | 2 Public Water | 1 Paved | | Description | Code | Assessed | Assessed | |
| 53 BELL RD | | | 4 Gas | | | RESIDNTL | 1010 | 291,100 | 291,100 | |
| HYANNIS MA 02601 | | SUPPLEMENTAL DATA | | | | RES LAND | 1010 | 134,700 | 134,700 | |
| | | Alt Prcl ID Split Zonin BID Parcel ResExpt Q YES: #DL 1 LOT 10 #DL 2 GIS ID F_982784_2703856 | | | Plan Ref. 208/91 Land Ct# #SR Life Estate PP STATU Assoc Pid# | | Total | | 425,800 | 425,800 |

| RECORD OF OWNERSHIP | | BK-VOL/PAGE | SALE DATE | Q/U | V/I | SALE PRIC | VC | PREVIOUS ASSESSMENTS (HISTORY) | | | | | |
|----------------------------|--|-------------|------------|-----|-----|-----------|----|--------------------------------|------|----------|-------|------|----------|
| RAUSCH, JOSEPH P & CYNTHIA | | 8716 0329 | 08-15-1993 | Q | I | 103,000 | U | Year | Code | Assessed | Year | Code | Assessed |
| BASSETT, ROBERT | | 1608 0229 | 02-25-1972 | U | | 0 | | 2023 | 1010 | 249,800 | 2022 | 1010 | 217,600 |
| | | | | | | | | | 1010 | 129,200 | | 1010 | 95,700 |
| | | | | | | | | Total | | 379,000 | Total | | 313,300 |
| | | | | | | | | Total | | | Total | | 268,700 |

| EXEMPTIONS | | | | OTHER ASSESSMENTS | | | | This signature acknowledges a visit by a Data Collector or Assessor | | | | | |
|------------|------|-----------------------|--------|-------------------|-------------|--------|--------|---|-----|--|--|--|--|
| Year | Code | Description | Amount | Code | Description | Number | Amount | Comm | Int | | | | |
| 2010 | 5C | RESIDENTIAL EXEMPTION | 0.00 | | | | | | | | | | |
| Total | | | 0.00 | | | | | | | | | | |

| ASSESSING NEIGHBORHOOD | | | | APPRAISED VALUE SUMMARY | | | | |
|------------------------|-----------|---|---------|-------------------------|--|--|--|--|
| Nbhd | Nbhd Name | B | Tracing | Batch | | | | |
| 0104 | | | | HYAN | | | | |

| NOTES | | | | APPRAISED VALUE SUMMARY | | | | |
|-------|--|--|--|-------------------------------|---------|--|--|--|
| | | | | Appraised Bldg. Value (Card) | 259,700 | | | |
| | | | | Appraised Xf (B) Value (Bldg) | 27,000 | | | |
| | | | | Appraised Ob (B) Value (Bldg) | 4,400 | | | |
| | | | | Appraised Land Value (Bldg) | 134,700 | | | |
| | | | | Special Land Value | 0 | | | |
| | | | | Total Appraised Parcel Value | 425,800 | | | |
| | | | | Valuation Method | C | | | |
| | | | | Total Appraised Parcel Value | 425,800 | | | |

| BUILDING PERMIT RECORD | | | | | | | | VISIT / CHANGE HISTORY | | | | | | |
|------------------------|------------|------|-------------|--------|------------|--------|-----------|------------------------|------------|----|------|----|----|----------------------------|
| Permit Id | Issue Date | Type | Description | Amount | Insp Date | % Comp | Date Comp | Comments | Date | Id | Type | Is | Cd | Purpost/Result |
| 201004777 | 10-06-2010 | OT | Other | 1,500 | | | | 29' WOOD HANDICAP RAMP | 05-04-2020 | WD | | | FR | Field Review |
| 53490 | 05-21-2001 | NS | New Siding | 330 | 01-01-2002 | 100 | | | 11-08-2017 | KM | 02 | | 03 | Cycl Insp Comp |
| | | | | | | | | | 04-18-2002 | MF | 04 | | 44 | Drive by inspection only |
| | | | | | | | | | 02-20-2001 | SM | 01 | | 00 | Meas/Listed-Interior Acces |
| | | | | | | | | | 09-15-1987 | ML | 01 | | 00 | Meas/Listed-Interior Acces |

| LAND LINE VALUATION SECTION | | | | | | | | | | | | | | | | |
|-----------------------------|----------|----------------|------|----|------------|------------|------------------------|---------|------------|-------|-------|-----------|------------------|--------------------|------------|------------|
| B | Use Code | Description | Zone | LA | Land Units | Unit Price | Size Adj | AC Disc | Site Index | Cond. | Nbhd. | Nbhd. Adj | Notes | Location Adjustmen | Adj Unit P | Land Value |
| 1 | 1010 | Single Fam M-0 | RB | 4 | 0.270 AC | 176,344.00 | 3.14262 | 1.0000 | 5 | 1.00 | 0104 | 0.900 | | 1.0000 | 498,771.3 | 134,700 |
| Total Card Land Units | | | | | 0.27 | AC | Parcel Total Land Area | | | | | 0.27 | Total Land Value | | | 134,700 |

| CONSTRUCTION DETAIL | | | CONSTRUCTION DETAIL (CONTINUED) | | |
|---------------------|----|----------------|---------------------------------|----|-------------|
| Element | Cd | Description | Element | Cd | Description |
| Style | 01 | Ranch | | | |
| Model | 01 | Residential | | | |
| Grade: | C | Average | | | |
| Stories | 1 | 1 Story | | | |
| Exterior Wall 1 | 14 | Wood Shingle | | | |
| Exterior Wall 2 | | | | | |
| RooF Structure | 03 | Gable/Hip | | | |
| RooF Cover | 03 | Asph/F Gls/Cmp | | | |
| Interior Wall 1 | 05 | Drywall | | | |
| Interior Wall 2 | 02 | Wall Brd/Wood | | | |
| Interior Floor 1 | 12 | Hardwood | | | |
| Interior Floor 2 | | | | | |
| Heat Fuel | 03 | Gas | | | |
| Heat Type | 05 | Hot Water | | | |
| AC Type | 01 | None | | | |
| Bedrooms | 03 | 3 Bedrooms | | | |
| Full Baths | 1 | | | | |
| Half Baths | 1 | | | | |
| Extra Fixtures | | | | | |
| Total Rooms | 6 | 6 Rooms | | | |
| Bath Style | | | | | |
| Kitchen Style | | | | | |
| Occupancy | | | | | |
| Usrflid 105 | | | | | |
| Accessory Apt | | | | | |
| Foundation Alt | 01 | Poured Conc. | | | |
| Rms Prts | | | | | |
| Bath Split | 11 | 1 Full-1 Half | | | |

| CONDO DATA | | | |
|-------------|------|-------------|----------|
| Parcel Id | | C | Ownr 0.0 |
| | | B | S |
| Adjust Type | Code | Description | Factor% |
| Condo Flr | | | |
| Condo Unit | | | |

| COST / MARKET VALUATION | |
|--------------------------|---------|
| Building Value New | 328,758 |
| Year Built | 1972 |
| Effective Year Built | 1992 |
| Depreciation Code | A |
| Remodel Rating | |
| Year Remodeled | |
| Depreciation % | 21 |
| Functional Obsol | 0 |
| External Obsol | 0 |
| Trend Factor | 1 |
| Condition | |
| Condition % | |
| Percent Good | 79 |
| RCNLD | 259,700 |
| Dep % Ovr | |
| Dep Ovr Comment | |
| Misc Imp Ovr | |
| Misc Imp Ovr Comment | |
| Cost to Cure Ovr | |
| Cost to Cure Ovr Comment | |

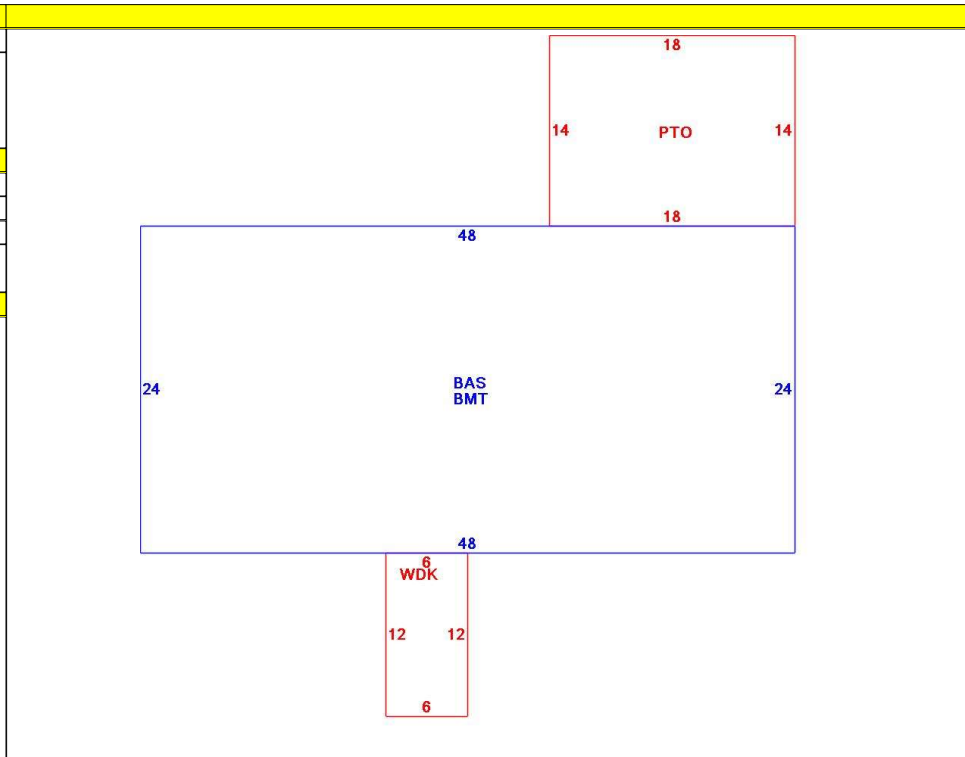

| OB - OUTBUILDING & YARD ITEMS(L) / XF - BUILDING EXTRA FEATURES(B) | | | | | | | | | | |
|--|-----------------|-----|-------|------------|--------|----------|------|-------|------------|-------------|
| Code | Description | L/B | Units | Unit Price | Yr Blt | Cond. Cd | % Gd | Grade | Grade Adj. | Appr. Value |
| FPL1 | Fireplace 1 sto | B | 1 | 5000.00 | 1994 | | 79 | | 0.00 | 4,000 |
| PAT1 | Patio- Average | L | 252 | 5.89 | 1996 | | 77 | | 0.00 | 1,200 |
| BMT | Basement-Unfi | B | 1,152 | 26.01 | 1994 | | 79 | | 0.00 | 23,000 |
| WDC | Wood Decking | L | 72 | 20.00 | 2017 | | 96 | | 0.00 | 3,200 |

| BUILDING SUB-AREA SUMMARY SECTION | | | | | | |
|-----------------------------------|---------------|-------------|------------|----------|-----------|----------------|
| Code | Description | Living Area | Floor Area | Eff Area | Unit Cost | Undeprec Value |
| BAS | First Floor | 1,152 | 1,152 | 1,152 | 285.38 | 328,758 |
| BMT | Basement Area | 0 | 1,152 | 0 | 0.00 | 0 |
| PTO | Patio | 0 | 252 | 0 | 0.00 | 0 |
| WDC | Wood Deck | 0 | 72 | 0 | 0.00 | 0 |
| Ttl Gross Liv / Lease Area | | 1,152 | 2,628 | 1,152 | | 328,758 |

