

| CURRENT OWNER  |            | TOPO                  |                | UTILITIES         |              | STRT / ROAD |                        | LOCATION  |            | CURRENT ASSESSMENT     |       |           |                  | 801<br>FY2024<br>BARNSTABLE, MA<br><br><b>VISION</b> |                            |                      |              |                    |                    |
|--|------------|-----------------------|----------------|-------------------|--------------|-------------|------------------------|---|------------|------------------------|-------|-----------|------------------|--|----------------------------|----------------------|--------------|--------------------|--------------------|
| DEMARTIN, ESTHER L<br><br>27 ALICIA ROAD<br><br>HYANNIS MA 02601 |            | 1                     | Level          | 6                 | Septic       | 1           | Paved                  |   |            | Description            | Code  | Assessed  | Assessed         |  |                            | RESIDNTL<br>RES LAND | 1010<br>1010 | 309,100<br>133,000 | 309,100<br>133,000 |
|  |            |                       |                | 4                 | Gas          |             |                        |   |            |                        |       |           |                  |  |                            |                      |              |                    |                    |
|  |            |                       |                | 2                 | Public Water |             |                        |   |            |                        |       |           |                  |  |                            |                      |              |                    |                    |
| <b>SUPPLEMENTAL DATA</b>   |            |                       |                |                   |              |             |                        |   |            | Total                  |       | 442,100   | 442,100          |  |                            |                      |              |                    |                    |
| Alt Prcl ID  |            | Split Zonin           |                | Plan Ref. 261/37  |              | Land Ct#    |                        |   |            |                        |       |           |                  |  |                            |                      |              |                    |                    |
| BID Parcel   |            | ResExpt Q             |                | YES:              |              | Life Estate |                        | PP STATU  |            |                        |       |           |                  |  |                            |                      |              |                    |                    |
| #DL 1  |            | LOT 104               |                |                   |              |             |                        |   |            |                        |       |           |                  |  |                            |                      |              |                    |                    |
| #DL 2  |            |                       |                |                   |              |             |                        |   |            |                        |       |           |                  |  |                            |                      |              |                    |                    |
| GIS ID   |            | F_984128_2703970      |                | Assoc Pid#        |              |             |                        |   |            |                        |       |           |                  |  |                            |                      |              |                    |                    |
| RECORD OF OWNERSHIP  |            | BK-VOL/PAGE           |                | SALE DATE         |              | Q/U         |                        | V/I   |            | SALE PRIC              |       | VC        |                  | PREVIOUS ASSESSMENTS (HISTORY)                       |                            |                      |              |                    |                    |
| DEMARTIN, ESTHER L   |            | 29761                 | 0095           | 06-28-2016        |              | U           | I                      | 100   |            | 1A                     | Year  | Code      | Assessed         | Year   | Code                       | Assessed             | Year         | Code               | Assessed           |
| DEMARTIN, GORDON H & ESTHER L TR                                 |            | 24687                 | 0004           | 07-16-2010        |              | U           | I                      | 1   |            | 1F                     | 2023  | 1010      | 268,400          | 2022   | 1010                       | 230,800              | 2021         | 1010               | 182,900            |
| DEMARTIN, GORDON H & ESTHER L                                    |            | 1880                  | 0344           | 06-18-1973        |              | Q           |                        | 30,900  |            | U                      |       | 1010      | 127,700          |  | 1010                       | 94,600               |              | 1010               | 89,600             |
|  |            |                       |                |                   |              |             |                        |   |            |                        |       |           |                  |  |                            |                      |              | 1010               | 5,700              |
|  |            |                       |                |                   |              |             |                        |   |            |                        | Total | 396,100   | Total            | 325,400  | Total                      | 278,200              |              |                    |                    |
| EXEMPTIONS   |            |                       |                | OTHER ASSESSMENTS |              |             |                        | This signature acknowledges a visit by a Data Collector or Assessor |            |                        |       |           |                  |  |                            |                      |              |                    |                    |
| Year   | Code       | Description           | Amount         | Code              | Description  | Number      | Amount                 | Comm Int  |            |                        |       |           |                  |  |                            |                      |              |                    |                    |
| 2010   | 5C         | RESIDENTIAL EXEMPTION | 0.00           |                   |              |             |                        |   |            |                        |       |           |                  |  |                            |                      |              |                    |                    |
| Total  |            |                       | 0.00           |                   |              |             |                        |   |            |                        |       |           |                  |  |                            |                      |              |                    |                    |
| ASSESSING NEIGHBORHOOD   |            |                       |                |                   |              |             |                        |   |            |                        |       |           |                  |  |                            |                      |              |                    |                    |
| Nbhd   |            | Nbhd Name             |                | B                 |              | Tracing     |                        | Batch   |            |                        |       |           |                  |  |                            |                      |              |                    |                    |
| 0104   |            |                       |                |                   |              |             |                        | HYAN  |            |                        |       |           |                  |  |                            |                      |              |                    |                    |
| NOTES  |            |                       |                |                   |              |             |                        |   |            |                        |       |           |                  |  |                            |                      |              |                    |                    |
|  |            |                       |                |                   |              |             |                        |   |            |                        |       |           |                  |  |                            |                      |              |                    |                    |
| BUILDING PERMIT RECORD   |            |                       |                |                   |              |             |                        |   |            | VISIT / CHANGE HISTORY |       |           |                  |  |                            |                      |              |                    |                    |
| Permit Id  | Issue Date | Type                  | Description    | Amount            | Insp Date    | % Comp      | Date Comp              | Comments  |            | Date                   | Id    | Type      | Is               | Cd   | Purpost/Result             |                      |              |                    |                    |
| 18-3564  | 10-30-2018 | 835                   | Sid/Wind/Roof/ | 8,500             |              | 100         |                        | re-roof   |            | 05-04-2020             | WD    |           |                  | FR   | Field Review               |                      |              |                    |                    |
|  |            |                       |                |                   |              |             |                        |   |            | 10-02-2017             | KM    | 02        |                  | 03   | Cycl Insp Comp             |                      |              |                    |                    |
|  |            |                       |                |                   |              |             |                        |   |            | 05-19-2017             | TR    | 22        |                  | 22   | Change of Address          |                      |              |                    |                    |
|  |            |                       |                |                   |              |             |                        |   |            | 05-16-2017             | LH    | 03        |                  | 16   | In Office Review           |                      |              |                    |                    |
|  |            |                       |                |                   |              |             |                        |   |            | 02-16-2001             | SM    | 01        |                  | 00   | Meas/Listed-Interior Acces |                      |              |                    |                    |
|  |            |                       |                |                   |              |             |                        |   |            | 09-15-1987             | ML    | 01        |                  | 00   | Meas/Listed-Interior Acces |                      |              |                    |                    |
| LAND LINE VALUATION SECTION                                      |            |                       |                |                   |              |             |                        |   |            |                        |       |           |                  |  |                            |                      |              |                    |                    |
| B  | Use Code   | Description           | Zone           | LA                | Land Units   | Unit Price  | Size Adj               | AC Disc   | Site Index | Cond.                  | Nbhd. | Nbhd. Adj | Notes            | Location Adjustmen                                   | Adj Unit P                 | Land Value           |              |                    |                    |
| 1  | 1010       | Single Fam M-0        | RB             | 4                 | 0.240        | AC          | 176,344.00             | 3.49265   | 1.0000     | 5                      | 1.00  | 0104      | 0.900            |  | 1.0000                     | 554,319.7            | 133,000      |                    |                    |
| Total Card Land Units  |            |                       |                |                   | 0.24         | AC          | Parcel Total Land Area |   |            |                        |       | 0.24      | Total Land Value |  |                            |                      | 133,000      |                    |                    |

| CONSTRUCTION DETAIL |    |                | CONSTRUCTION DETAIL (CONTINUED) |    |             |
|---------------------|----|----------------|---------------------------------|----|-------------|
| Element             | Cd | Description    | Element                         | Cd | Description |
| Style               | 01 | Ranch          |                                 |    |             |
| Model               | 01 | Residential    |                                 |    |             |
| Grade:              | C  | Average        |                                 |    |             |
| Stories             | 1  | 1 Story        |                                 |    |             |
| Exterior Wall 1     | 14 | Wood Shingle   |                                 |    |             |
| Exterior Wall 2     |    |                |                                 |    |             |
| RooF Structure      | 03 | Gable/Hip      |                                 |    |             |
| RooF Cover          | 03 | Asph/F Gls/Cmp |                                 |    |             |
| Interior Wall 1     | 05 | Drywall        |                                 |    |             |
| Interior Wall 2     |    |                |                                 |    |             |
| Interior Floor 1    | 14 | Carpet         |                                 |    |             |
| Interior Floor 2    |    |                |                                 |    |             |
| Heat Fuel           | 03 | Gas            |                                 |    |             |
| Heat Type           | 04 | Hot Air        |                                 |    |             |
| AC Type             | 03 | Central        |                                 |    |             |
| Bedrooms            | 03 | 3 Bedrooms     |                                 |    |             |
| Full Baths          | 1  |                |                                 |    |             |
| Half Baths          | 0  |                |                                 |    |             |
| Extra Fixtures      |    |                |                                 |    |             |
| Total Rooms         | 6  | 6 Rooms        |                                 |    |             |
| Bath Style          |    |                |                                 |    |             |
| Kitchen Style       |    |                |                                 |    |             |
| Occupancy           |    |                |                                 |    |             |
| Usrflid 105         |    |                |                                 |    |             |
| Accessory Apt       |    |                |                                 |    |             |
| Foundation Alt      | 01 | Poured Conc.   |                                 |    |             |
| Rms Prts            |    |                |                                 |    |             |
| Bath Split          | 10 | 1 Full-0 Half  |                                 |    |             |

| CONDO DATA  |      |             |          |
|-------------|------|-------------|----------|
| Parcel Id   |      | C           | Ownr 0.0 |
| Adjust Type | Code | Description | Factor%  |
| Condo Flr   |      |             |          |
| Condo Unit  |      |             |          |

| COST / MARKET VALUATION  |         |
|--------------------------|---------|
| Building Value New       | 349,692 |
| Year Built               | 1973    |
| Effective Year Built     | 1992    |
| Depreciation Code        | A       |
| Remodel Rating           |         |
| Year Remodeled           |         |
| Depreciation %           | 21      |
| Functional Obsol         | 0       |
| External Obsol           | 0       |
| Trend Factor             | 1       |
| Condition                |         |
| Condition %              |         |
| Percent Good             | 79      |
| RCNLD                    | 276,300 |
| Dep % Ovr                |         |
| Dep Ovr Comment          |         |
| Misc Imp Ovr             |         |
| Misc Imp Ovr Comment     |         |
| Cost to Cure Ovr         |         |
| Cost to Cure Ovr Comment |         |

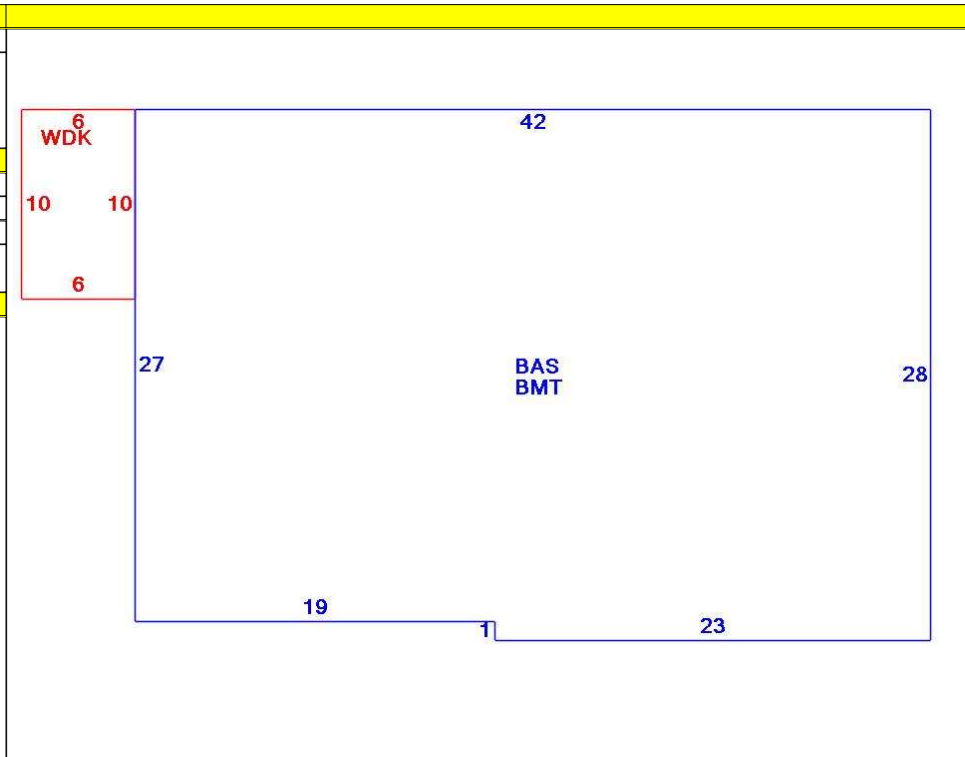

| OB - OUTBUILDING & YARD ITEMS(L) / XF - BUILDING EXTRA FEATURES(B) |                 |     |       |            |        |          |      |       |            |             |
|--|-----------------|-----|-------|------------|--------|----------|------|-------|------------|-------------|
| Code   | Description     | L/B | Units | Unit Price | Yr Blt | Cond. Cd | % Gd | Grade | Grade Adj. | Appr. Value |
| FPL1   | Fireplace 1 sto | B   | 1     | 5000.00    | 1994   |          | 79   |       | 0.00       | 4,000       |
| BMT  | Basement-Unfi   | B   | 1,157 | 26.01      | 1994   |          | 79   |       | 0.00       | 23,100      |
| WDC  | Deck comp w     | L   | 160   | 28.00      | 2017   |          | 96   |       | 0.00       | 5,700       |

| BUILDING SUB-AREA SUMMARY SECTION |               |             |            |          |           |                |
|-----------------------------------|---------------|-------------|------------|----------|-----------|----------------|
| Code                              | Description   | Living Area | Floor Area | Eff Area | Unit Cost | Undeprec Value |
| BAS                               | First Floor   | 1,157       | 1,157      | 1,157    | 302.24    | 349,692        |
| BMT                               | Basement Area | 0           | 1,157      | 0        | 0.00      | 0              |
| WDC                               | Wood Deck     | 0           | 60         | 0        | 0.00      | 0              |
| Ttl Gross Liv / Lease Area        |               | 1,157       | 2,374      | 1,157    |           | 349,692        |

