

| CURRENT OWNER  |  | TOPO    | UTILITIES   | STRT / ROAD | LOCATION | CURRENT ASSESSMENT                  |                      |                                |                                |
|--|--|---------|---|-------------|----------|-------------------------------------|----------------------|--------------------------------|--------------------------------|
| MCDEVITT, MARK J & KAREN E & ER<br>GAEL P RENNIE TRUST<br>564 MAIN STREET<br><br>COTUIT MA 02635         |  | 1 Level | 2 Public Water  |             |          | Description<br>RESIDNTL<br>RES LAND | Code<br>1010<br>1010 | Assessed<br>317,200<br>368,800 | Assessed<br>317,200<br>368,800 |
|  |  |         | 4 Gas   | 1 Paved     |          |                                     |                      |                                |                                |
|  |  |         | 6 Septic  |             |          |                                     |                      |                                |                                |
| SUPPLEMENTAL DATA  |  |         |   |             |          | Total                               |                      |                                |                                |
| Alt Prcl ID<br>Split Zonin<br>BID Parcel<br>ResExpt Q INFO:<br>#DL 1<br>#DL 2<br>GIS ID F_946524_2690583 |  |         | Plan Ref.<br>Land Ct#<br>#SR<br>Life Estate<br>PP STATU<br>Assoc Pid# |             |          | 686,000                             |                      | 686,000                        |                                |

801  
 FY2024  
 BARNSTABLE, MA  
**VISION**

| RECORD OF OWNERSHIP                 |       | BK-VOL/PAGE | SALE DATE  | Q/U | V/I | SALE PRIC | VC | PREVIOUS ASSESSMENTS (HISTORY) |      |          |       |      |          |
|-------------------------------------|-------|-------------|------------|-----|-----|-----------|----|--------------------------------|------|----------|-------|------|----------|
| MCDEVITT, ERIC J & DIANE M          | 36063 | 14          | 10-31-2023 | U   | I   | 10        | 1F | Year                           | Code | Assessed | Year  | Code | Assessed |
| MCDEVITT, MARK J & KAREN E & ERIC J | 36062 | 311         | 04-20-2022 | U   | I   | 0         | 1F | 2023                           | 1010 | 265,900  | 2022  | 1010 | 218,600  |
| RENNIE, GAEL P TR                   | 31811 | 0006        | 01-31-2019 | U   | I   | 10        | 1F |                                | 1010 | 342,900  |       | 1010 | 237,100  |
| RENNIE, GAEL P                      | 31811 | 0001        | 02-26-2018 | U   | I   | 0         | 1F |                                |      |          |       | 1010 | 6,600    |
| RENNIE, EDMUND D & GAEL P           | 3801  | 0046        | 07-15-1983 | U   |     | 0         |    | Total                          |      | 608,800  | Total |      | 455,700  |
|                                     |       | Total       |            |     |     |           |    | Total                          |      | 439,800  | Total |      | 439,800  |

| EXEMPTIONS |      |                          | OTHER ASSESSMENTS |      |             |        |        |          |
|------------|------|--------------------------|-------------------|------|-------------|--------|--------|----------|
| Year       | Code | Description              | Amount            | Code | Description | Number | Amount | Comm Int |
| 2024       | N5C  | NO RESIDENTIAL EXEMPTION | 0.00              |      |             |        |        |          |
|            |      | Total                    | 0.00              |      |             |        |        |          |

This signature acknowledges a visit by a Data Collector or Assessor

| ASSESSING NEIGHBORHOOD |           |   |         |
|------------------------|-----------|---|---------|
| Nbhd                   | Nbhd Name | B | Tracing |
| 0109                   |           |   | COTUIT  |

| APPRAISED VALUE SUMMARY       |         |
|-------------------------------|---------|
| Appraised Bldg. Value (Card)  | 299,300 |
| Appraised Xf (B) Value (Bldg) | 8,400   |
| Appraised Ob (B) Value (Bldg) | 9,500   |
| Appraised Land Value (Bldg)   | 368,800 |
| Special Land Value            | 0       |
| Total Appraised Parcel Value  | 686,000 |
| Valuation Method              | C       |
| Total Appraised Parcel Value  | 686,000 |

| NOTES |  |  |  |  |  |  |  |
|-------|--|--|--|--|--|--|--|
|       |  |  |  |  |  |  |  |

| BUILDING PERMIT RECORD |            |      |              |        |            |        |            |                         | VISIT / CHANGE HISTORY |    |      |    |    |                |
|------------------------|------------|------|--------------|--------|------------|--------|------------|-------------------------|------------------------|----|------|----|----|----------------|
| Permit Id              | Issue Date | Type | Description  | Amount | Insp Date  | % Comp | Date Comp  | Comments                | Date                   | Id | Type | Is | Cd | Purpost/Result |
| 18-1630                | 05-23-2018 | 822  | Insulation   | 3,738  | 06-30-2019 | 100    | 06-30-2019 | INSULATION/WEATHRIZATIO | 08-09-2023             | WT | 02   |    | 03 | Cycl Insp Comp |
| 81528                  | 01-03-2005 | OB   | Out Building | 6,000  | 09-07-2005 | 100    | 01-01-2002 |                         | 06-10-2020             | WD |      |    | FR | Field Review   |
| 76865                  | 05-25-2004 | DE   | Demolish     | 10,000 | 11-05-2004 | 100    | 01-01-2005 | DEMO BARN               | 09-18-2013             | SR | 01   |    | 03 | Cycl Insp Comp |
| B37735                 | 05-01-1995 | AD   | Addition     | 15,850 | 01-15-1996 | 100    | 12-31-1996 | CO REMOD'               |                        |    |      |    |    |                |

| LAND LINE VALUATION SECTION |          |                |      |    |            |            |                        |         |            |       |       |           |                  |                    |            |            |         |
|-----------------------------|----------|----------------|------|----|------------|------------|------------------------|---------|------------|-------|-------|-----------|------------------|--------------------|------------|------------|---------|
| B                           | Use Code | Description    | Zone | LA | Land Units | Unit Price | Size Adj               | AC Disc | Site Index | Cond. | Nbhd. | Nbhd. Adj | Notes            | Location Adjustmen | Adj Unit P | Land Value |         |
| 1                           | 1010     | Single Fam M-0 | RF   | 2  | 0.650      | AC         | 176,344.00             | 1.46256 | 1.0000     | 5     | 1.00  | 0109      | 2.200            |                    | 1.0000     | 567,404.4  | 368,800 |
| Total Card Land Units       |          |                |      |    | 0.65       | AC         | Parcel Total Land Area |         |            |       |       | 0.65      | Total Land Value |                    |            | 368,800    |         |

| CONSTRUCTION DETAIL |     |                | CONSTRUCTION DETAIL (CONTINUED) |      |             |
|---------------------|-----|----------------|---------------------------------|------|-------------|
| Element             | Cd  | Description    | Element                         | Cd   | Description |
| Style               | 06  | Conventional   |                                 |      |             |
| Model               | 01  | Residential    |                                 |      |             |
| Grade:              | C   | Average        |                                 |      |             |
| Stories             | 1.4 |                |                                 |      |             |
| Exterior Wall 1     | 14  | Wood Shingle   |                                 |      |             |
| Exterior Wall 2     |     |                |                                 |      |             |
| Roof Structure      | 03  | Gable/Hip      |                                 |      |             |
| Roof Cover          | 03  | Asph/F Gls/Cmp |                                 |      |             |
| Interior Wall 1     | 05  | Drywall        |                                 |      |             |
| Interior Wall 2     |     |                |                                 |      |             |
| Interior Floor 1    | 14  | Carpet         |                                 |      |             |
| Interior Floor 2    | 09  | Pine/Soft Wood |                                 |      |             |
| Heat Fuel           | 03  | Gas            |                                 |      |             |
| Heat Type           | 05  | Hot Water      |                                 |      |             |
| AC Type             | 01  | None           |                                 |      |             |
| Bedrooms            | 04  | 4 Bedrooms     |                                 |      |             |
| Full Baths          | 1   |                |                                 |      |             |
| Half Baths          | 1   |                |                                 |      |             |
| Extra Fixtures      |     |                |                                 |      |             |
| Total Rooms         | 7   | 7 Rooms        |                                 |      |             |
| Bath Style          |     |                |                                 |      |             |
| Kitchen Style       |     |                |                                 |      |             |
| Occupancy           |     |                |                                 |      |             |
| Usrflid 105         |     |                |                                 |      |             |
| Accessory Apt       |     |                |                                 |      |             |
| Foundation Alt      | 11  | Stone Ftgs     |                                 |      |             |
| Rms Prts            |     |                |                                 |      |             |
| Bath Split          | 11  | 1 Full-1 Half  |                                 |      |             |
|                     |     |                | <b>CONDO DATA</b>               |      |             |
|                     |     |                | Parcel Id                       | C    | Owne 0.0    |
|                     |     |                | Adjust Type                     | Code | Description |
|                     |     |                | Condo Flr                       |      | Factor%     |
|                     |     |                | Condo Unit                      |      |             |
|                     |     |                | <b>COST / MARKET VALUATION</b>  |      |             |
|                     |     |                | Building Value New              |      | 433,781     |
|                     |     |                | Year Built                      |      | 1900        |
|                     |     |                | Effective Year Built            |      | 1979        |
|                     |     |                | Depreciation Code               |      | A           |
|                     |     |                | Remodel Rating                  |      |             |
|                     |     |                | Year Remodeled                  |      |             |
|                     |     |                | Depreciation %                  |      | 31          |
|                     |     |                | Functional Obsol                |      | 0           |
|                     |     |                | External Obsol                  |      | 0           |
|                     |     |                | Trend Factor                    |      | 1           |
|                     |     |                | Condition                       |      |             |
|                     |     |                | Condition %                     |      |             |
|                     |     |                | Percent Good                    |      | 69          |
|                     |     |                | RCNLD                           |      | 299,300     |
|                     |     |                | Dep % Ovr                       |      |             |
|                     |     |                | Dep Ovr Comment                 |      |             |
|                     |     |                | Misc Imp Ovr                    |      |             |
|                     |     |                | Misc Imp Ovr Comment            |      |             |
|                     |     |                | Cost to Cure Ovr                |      |             |
|                     |     |                | Cost to Cure Ovr Comment        |      |             |

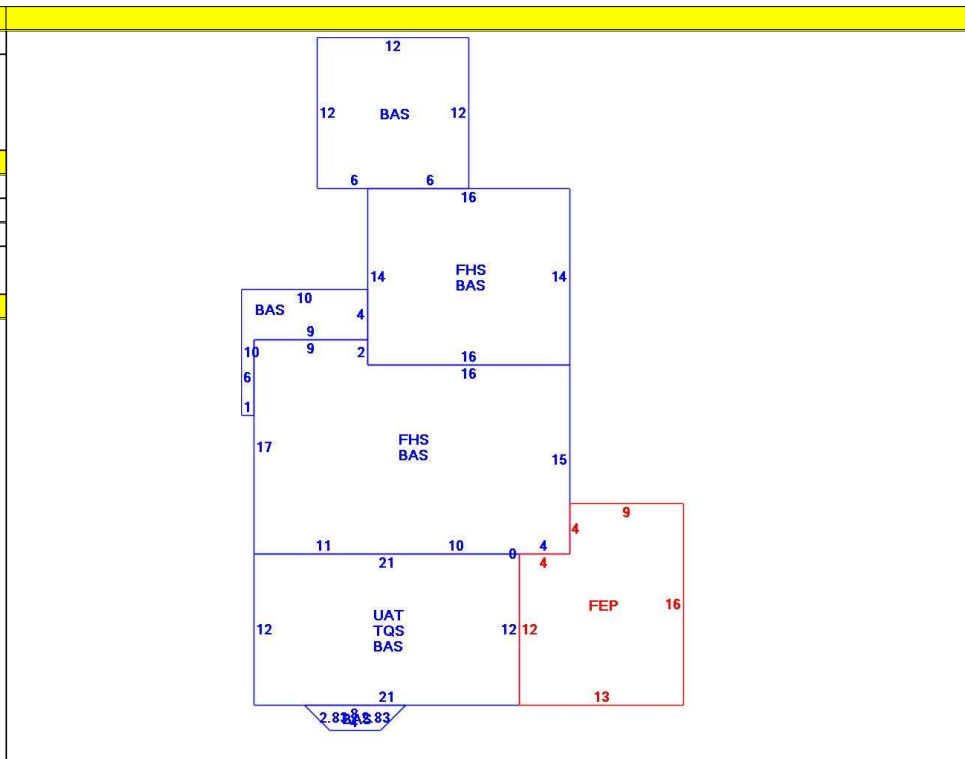

| OB - OUTBUILDING & YARD ITEMS(L) / XF - BUILDING EXTRA FEATURES(B) |               |     |       |            |        |          |      |       |            |             |
|--|---------------|-----|-------|------------|--------|----------|------|-------|------------|-------------|
| Code   | Description   | L/B | Units | Unit Price | Yr Blt | Cond. Cd | % Gd | Grade | Grade Adj. | Appr. Value |
| SHD3   | Shed-High Qu  | L   | 192   | 25.00      | 2010   |          | 82   |       | 0.00       | 3,900       |
| FEP  | Enclosed porc | B   | 192   | 70.00      | 1979   |          | 69   |       | 0.00       | 8,400       |
| GEN  | Emergency Ge  | L   | 1     | 5550.00    | 2020   |          | 100  |       | 0.00       | 5,600       |

| BUILDING SUB-AREA SUMMARY SECTION |                     |             |            |          |           |                |
|-----------------------------------|---------------------|-------------|------------|----------|-----------|----------------|
| Code                              | Description         | Living Area | Floor Area | Eff Area | Unit Cost | Undeprec Value |
| BAS                               | First Floor         | 1,071       | 1,071      | 1,071    | 276.47    | 296,099        |
| FEP                               | Enclosed Porch      | 0           | 192        | 0        | 0.00      | 0              |
| FHS                               | Half Story          | 309         | 617        | 309      | 138.46    | 85,429         |
| TQS                               | Three Quarter Story | 164         | 252        | 164      | 179.92    | 45,341         |
| UAT                               | Attic, Unfinished   | 0           | 252        | 25       | 27.43     | 6,912          |
| Ttl Gross Liv / Lease Area        |                     | 1,544       | 2,384      | 1,569    |           | 433,781        |

