

| CURRENT OWNER | | TOPO | UTILITIES | STRT / ROAD | LOCATION | CURRENT ASSESSMENT | | | | 801 FY2024 BARNSTABLE, MA VISION | | | | | | | | |
|--|------------|------------------|-------------------|----------------------------|-------------|--------------------|------------|---|------------|--|---------------------------------|---------------------------|------------------|-------|-------------------|-----------------------|------------|---------|
| GROUP 1 REALTY INC 800 GESSNER ROAD SUITE 500 HOUSTON TX 77024 | | | | | | Description | Code | Appraised | Assessed | | | Total 1,415,700 1,415,700 | | | | | | |
| | | | | | | COMMERC. | 3310 | 527,000 | 527,000 | | | | | | | | | |
| | | | | | | COM LAND | 3310 | 649,700 | 649,700 | | | | | | | | | |
| SUPPLEMENTAL DATA | | | | | | COMMERC. | 3350 | 239,000 | 239,000 | | | | | | | | | |
| Alt Prcl ID | | Split Zonin HB;B | | Plan Ref. Land Ct# 24626-B | | | | | | | | | | | | | | |
| #DL 1 LOT 3 | | #DL 2 | | Life Estate PP STATU | | | | | | | | | | | | | | |
| GIS ID F_982877_2708284 | | Assoc Pid# | | | | | | | | | | | | | | | | |
| RECORD OF OWNERSHIP | | BK-VOL/PAGE | SALE DATE | Q/U | V/I | SALE PRICE | VC | PREVIOUS ASSESSMENTS (HISTORY) | | | | | | | | | | |
| GROUP 1 REALTY INC | 33902 | 224 | 03-16-2021 | U | I | 16,615,000 | 1V | Year | Code | Assessed | Year | Code | Assessed | Year | Code | Assessed | | |
| AMR REAL ESTATE HOLDINGS-IYANNOUG | C199 | 0 | 12-26-2012 | Q | I | 1,450,000 | 00 | 2023 | 3310 | 527,000 | 2022 | 3310 | 480,600 | 2021 | 3310 | 464,500 | | |
| WALL, BRIAN J TR | C186 | 0 | 07-31-2008 | Q | V | 850,000 | 00 | | 3310 | 649,700 | | 3310 | 584,700 | | 3310 | 584,700 | | |
| SWIFT, WILLIAM P & HARRIETT J TRS | C959 | 0 | 04-09-1984 | U | V | 156,000 | A | | 3350 | 239,000 | | 3350 | 212,700 | | 3310 | 16,100 | | |
| SWIFT, WILLIAM P | C169 | 0 | 09-03-1954 | U | | 0 | | | | | | 3350 | 186,200 | | 3350 | 186,200 | | |
| Total | | | | | | | | 1,415,700 | | Total | | 1,278,000 | | Total | | 1,278,000 | | |
| EXEMPTIONS | | | OTHER ASSESSMENTS | | | | | This signature acknowledges a visit by a Data Collector or Assessor | | | | | | | | | | |
| Year | Code | Description | Amount | Code | Description | Number | Amount | Comm Int | | | | | | | | | | |
| Total | | | 0.00 | | | | | | | | | | | | | | | |
| ASSESSING NEIGHBORHOOD | | | | | | | | | | APPRAISED VALUE SUMMARY | | | | | | | | |
| Nbhd | Nbhd Name | | B | | Tracing | | Batch | | | Appraised Bldg. Value (Card) 723,400 | | | | | | | | |
| CI23 | | | | | | | | HYAN | | | Appraised Xf (B) Value (Bldg) 0 | | | | | | | |
| NOTES | | | | | | | | | | Appraised Ob (B) Value (Bldg) 42,600 | | | | | | | | |
| --TOYOTA RENT-A-CAR-- | | | | | | | | | | Appraised Land Value (Bldg) 649,700 | | | | | | | | |
| | | | | | | | | | | Special Land Value 0 | | | | | | | | |
| | | | | | | | | | | Total Appraised Parcel Value 1,415,700 | | | | | | | | |
| | | | | | | | | | | Valuation Method C | | | | | | | | |
| | | | | | | | | | | Total Appraised Parcel Value 1,415,700 | | | | | | | | |
| BUILDING PERMIT RECORD | | | | | | | | | | VISIT / CHANGE HISTORY | | | | | | | | |
| Permit Id | Issue Date | Type | Description | Amount | Insp Date | % Comp | Date Comp | Comments | | | Date | Id | Type | Is | Cd | Purpost/Result | | |
| 17-718 | 04-13-2017 | 836 | Sign | 0 | 08-28-2018 | 100 | | 48"x72" sign for Toyota Rent A | | | 04-29-2020 | GM | 04 | | FR | Field Review | | |
| 201400554 | 02-06-2014 | CM | Commercial | 85,000 | 06-30-2014 | 100 | 06-30-2014 | KIA IMAGE UPGRADE-COSM | | | 08-28-2018 | SR | 02 | | 02 | Bldg Permit Completed | | |
| 201002574 | 06-08-2010 | CM | Commercial | 257,000 | 06-30-2012 | 100 | 06-30-2012 | NEW DEALERSHIP BLD AT H | | | 08-28-2018 | SR | 02 | | 03 | Cycl Insp Comp | | |
| 201001568 | 04-27-2010 | OT | Other | 214,150 | 06-30-2012 | 100 | 06-30-2012 | NEW CARWASH FACILITY | | | 12-09-2011 | JR | 01 | | 52 | New Construction | | |
| | | | | | | | | | | | 05-22-2006 | JK | 22 | | 22 | Change of Address | | |
| LAND LINE VALUATION SECTION | | | | | | | | | | | | | | | | | | |
| B | Use Code | Description | Zone | LA | Land Type | Land Units | Unit Price | I. Factor | Site Index | Cond. | Nbhd. | Nhbd Adj | Notes | | Location Adjustme | Adj Unit Pric | Land Value | |
| 1 | 3310 | AUTO S S&S M9 | SPLI | 4 | | 0.870 | AC | 330,000.00 | 0.90519 | C | 1.00 | CI23 | 2.500 | | | 0 | 746,790 | 649,700 |
| Total Card Land Units | | | | | | 0.87 | AC | Parcel Total Land Area: 0.87 | | | | | Total Land Value | | | 649,700 | | |

| CONSTRUCTION DETAIL | | | CONSTRUCTION DETAIL (CONTINUED) | | |
|---------------------|-------|----------------|---------------------------------|----|-------------|
| Element | Cd | Description | Element | Cd | Description |
| Style | 12 | Comm Bldg | | | |
| Model | 94 | Commercial | | | |
| Grade | B+ | Custom Plus | | | |
| Stories | 1 | | | | |
| Occupancy | 1.00 | | | | |
| Exterior Wall 1 | 30 | Cement Siding | | | |
| Exterior Wall 2 | | | | | |
| Roof Structure | 01 | Flat | | | |
| Roof Cover | 13 | Elastomeric | | | |
| Interior Wall 1 | 05 | Drywall | | | |
| Interior Wall 2 | | | | | |
| Interior Floor 1 | 11 | Ceram Clay Til | | | |
| Interior Floor 2 | | | | | |
| Heating Fuel | 03 | Gas | | | |
| Heating Type | 04 | Hot Air | | | |
| AC Type | 03 | Central | | | |
| Size Adj Tbl | 3310 | AUTO S S&S M94 | | | |
| Total Rooms | 3 | | | | |
| Bedrooms | 0 | | | | |
| Full Bathrooms | 02 | | | | |
| Bath Split | 02 | 0 Full-2 Half | | | |
| Rms/Partitions | 02 | AVERAGE | | | |
| Heat/AC | 01 | HEAT/AC PKGS | | | |
| Frame Type | 02 | WOOD FRAME | | | |
| Baths/Plumbing | 02 | AVERAGE | | | |
| Ceiling/Wall | 05 | SUS-CEIL & WL | | | |
| Common Wall | 00 | 0% | | | |
| Wall Height | 18.00 | | | | |
| 1st Floor Use: | | | | | |
| Sewer Occupan | | | | | |

| OB - OUTBUILDING & YARD ITEMS(L) / XF - BUILDING EXTRA FEATURES(B) | | | | | | | | | | |
|--|--------------|-----|-------|------------|--------|----------|--------|-------|-----------|-------------|
| Code | Description | L/B | Units | Unit Price | Yr Blt | Cond. Cd | % Good | Grade | Grade Adj | Appr. Value |
| FGPL | Flagpole-25' | L | 2 | 2229.00 | 2018 | | 98 | | 0.00 | 4,400 |
| SGN2 | DOUBLE SIDE | L | 24 | 39.53 | 2018 | | 98 | | 0.00 | 900 |
| SGNP | SIGN POST 6" | L | 16 | 10.66 | | | 100 | | 0.00 | 200 |
| PAV1 | PAVING-ASPH | L | 3,600 | 3.00 | 2018 | | 98 | | 0.00 | 10,600 |

| BUILDING SUB-AREA SUMMARY SECTION | | | | | | | |
|-----------------------------------|------------------------|-------------|------------|----------|-----------|----------------|--|
| Code | Description | Living Area | Floor Area | Eff Area | Unit Cost | Undeprec Value | |
| BAS | First Floor | 3,402 | 3,402 | 3,402 | 152.58 | 519,088 | |
| FPC | Open Porch Conc. Floor | 0 | 98 | 15 | 23.35 | 2,289 | |
| Ttl Gross Liv / Lease Area | | 3,402 | 3,500 | 3,417 | | 521,377 | |

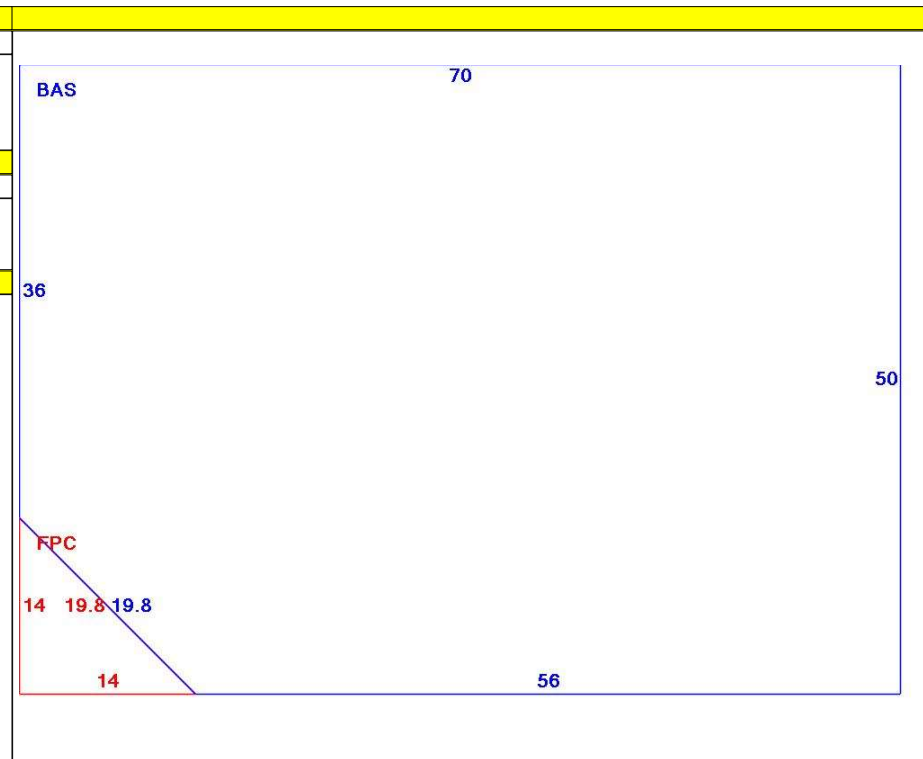

8.28.2018

| CURRENT OWNER | | TOPO | UTILITIES | STRT / ROAD | LOCATION | CURRENT ASSESSMENT | | | | |
|----------------------------|------------------|------|------------|-------------|----------|--------------------|------|-----------|-----------|---------------------------------|
| GROUP 1 REALTY INC | | | | | | Description | Code | Appraised | Assessed | 801 FY2024 BARNSTABLE, MA |
| 800 GESSNER ROAD SUITE 500 | | | | | | COMMERC. | 3310 | 527,000 | 527,000 | |
| HOUSTON TX 77024 | | | | | | COM LAND | 3310 | 649,700 | 649,700 | |
| | | | | | | COMMERC. | 3350 | 239,000 | 239,000 | |
| SUPPLEMENTAL DATA | | | | | | Total | | 1,415,700 | 1,415,700 | VISION |
| Alt Prcl ID | Split Zonin | HB;B | Plan Ref. | Land Ct# | 24626-B | | | | | |
| BID Parcel | ResExpt Q | | #SR | Life Estate | PP STATU | | | | | |
| #DL 1 | LOT 3 | | Assoc Pid# | | | | | | | |
| #DL 2 | | | | | | | | | | |
| GIS ID | F_982877_2708284 | | | | | | | | | |

| RECORD OF OWNERSHIP | | BK-VOL/PAGE | SALE DATE | Q/U | V/I | SALE PRICE | VC | PREVIOUS ASSESSMENTS (HISTORY) | | | | | | | | | |
|-----------------------------------|-------|-------------|------------|-----|-----|------------|----|--------------------------------|------|----------|------|-----------|----------|-------|------|-----------|--|
| GROUP 1 REALTY INC | 33902 | 224 | 03-16-2021 | U | I | 16,615,000 | 1V | Year | Code | Assessed | Year | Code | Assessed | Year | Code | Assessed | |
| AMR REAL ESTATE HOLDINGS-IYANNOUG | C199 | 0 | 12-26-2012 | Q | I | 1,450,000 | 00 | 2023 | 3310 | 527,000 | 2022 | 3310 | 480,600 | 2021 | 3310 | 464,500 | |
| WALL, BRIAN J TR | C186 | 0 | 07-31-2008 | Q | V | 850,000 | 00 | | 3310 | 649,700 | | 3310 | 584,700 | | 3310 | 584,700 | |
| SWIFT, WILLIAM P & HARRIETT J TRS | C959 | 0 | 04-09-1984 | U | V | 156,000 | A | | 3350 | 239,000 | | 3350 | 212,700 | | 3310 | 16,100 | |
| SWIFT, WILLIAM P | C169 | 0 | 09-03-1954 | U | | 0 | | | | | | 3350 | 186,200 | | 3350 | 186,200 | |
| Total | | | | | | | | 1,415,700 | | Total | | 1,278,000 | | Total | | 1,278,000 | |

| EXEMPTIONS | | | OTHER ASSESSMENTS | | | | This signature acknowledges a visit by a Data Collector or Assessor | | | | | | | | | | | |
|------------|------|-------------|-------------------|------|-------------|--------|---|----------|--|--|--|--|--|--|--|--|--|--|
| Year | Code | Description | Amount | Code | Description | Number | Amount | Comm Int | | | | | | | | | | |
| | | | | | | | | | | | | | | | | | | |
| Total | | | 0.00 | | | | | | | | | | | | | | | |

| ASSESSING NEIGHBORHOOD | | | | | | APPRAISED VALUE SUMMARY | | | |
|------------------------|-----------|---|---------|-------|--|-------------------------|--|--|--|
| Nbhd | Nbhd Name | B | Tracing | Batch | | | | | |
| CI23 | | | | HYAN | | | | | |

| NOTES | | | | | | | | | | APPRAISED VALUE SUMMARY | | | | | | |
|-------------|--|--|--|--|--|--|--|--|--|-------------------------------|--|--|--|--|--|-----------|
| --CARWASH-- | | | | | | | | | | Appraised Bldg. Value (Card) | | | | | | 723,400 |
| | | | | | | | | | | Appraised Xf (B) Value (Bldg) | | | | | | 0 |
| | | | | | | | | | | Appraised Ob (B) Value (Bldg) | | | | | | 42,600 |
| | | | | | | | | | | Appraised Land Value (Bldg) | | | | | | 649,700 |
| | | | | | | | | | | Special Land Value | | | | | | 0 |
| | | | | | | | | | | Total Appraised Parcel Value | | | | | | 1,415,700 |
| | | | | | | | | | | Valuation Method | | | | | | C |
| | | | | | | | | | | Total Appraised Parcel Value | | | | | | 1,415,700 |

| BUILDING PERMIT RECORD | | | | | | | | | | VISIT / CHANGE HISTORY | | | | | |
|------------------------|------------|------|-------------|--------|-----------|--------|-----------|----------|------|------------------------|------|----|----|----------------|--|
| Permit Id | Issue Date | Type | Description | Amount | Insp Date | % Comp | Date Comp | Comments | Date | Id | Type | Is | Cd | Purpost/Result | |
| | | | | | | | | | | | | | | | |

| LAND LINE VALUATION SECTION | | | | | | | | | | | | | | | | | | | |
|-----------------------------|----------|-------------|------|----|-----------|------------|------------|------------------------------|------------|-------|-------|----------|-------|-------------------|---------------|------------|--|--|---------|
| B | Use Code | Description | Zone | LA | Land Type | Land Units | Unit Price | I. Factor | Site Index | Cond. | Nbhd. | Nbhd Adj | Notes | Location Adjustme | Adj Unit Pric | Land Value | | | |
| 2 | 3350 | CAR WASH | SPLI | 4 | | 0 SF | 0.00 | 1.00000 | 0 | 1.00 | | 1.000 | | 0 | 0 | 0 | | | |
| Total Card Land Units | | | | | | 0.00 | AC | Parcel Total Land Area: 0.87 | | | | | | Total Land Value | | | | | 649,700 |

| CONSTRUCTION DETAIL | | | CONSTRUCTION DETAIL (CONTINUED) | | |
|---------------------|-------|----------------|---------------------------------|----|-------------|
| Element | Cd | Description | Element | Cd | Description |
| Style | 67 | CarWash-Self | | | |
| Model | 95 | SvcGar/Gar/JS | | | |
| Grade | B | Custom | | | |
| Stories | 1 | | | | |
| Occupancy | 1.00 | | | | |
| Exterior Wall 1 | 02 | Comp./Wall Brd | | | |
| Exterior Wall 2 | | | | | |
| Roof Structure | 03 | Gable/Hip | | | |
| Roof Cover | 03 | Asph/F Gls/Cmp | | | |
| Interior Wall 1 | 02 | Wall Brd/Wood | | | |
| Interior Wall 2 | | | | | |
| Interior Floor 1 | 03 | Concr Finished | | | |
| Interior Floor 2 | | | | | |
| Heating Fuel | 03 | Gas | | | |
| Heating Type | 03 | Hot Air-No Duc | | | |
| AC Type | 01 | None | | | |
| Size Adj Tbl | 3350 | CAR WASH | | | |
| Total Rooms | 1 | | | | |
| Bedrooms | 0 | | | | |
| Full Bathrooms | 0 | | | | |
| Bath Split | 0 | | | | |
| Rms/Partitions | 02 | AVERAGE | | | |
| Heat/AC | 03 | HEAT ONLY | | | |
| Frame Type | 02 | WOOD FRAME | | | |
| Baths/Plumbing | 03 | ABOVE AVERAGE | | | |
| Ceiling/Wall | 00 | NONE | | | |
| Common Wall | 00 | 0% | | | |
| Wall Height | 12.00 | | | | |
| 1st Floor Use: | | | | | |
| Sewer Occupan | | | | | |

| MIXED USE | | |
|-----------|-------------|------------|
| Code | Description | Percentage |
| 3350 | CAR WASH | 100 |
| | | 0 |
| | | 0 |

| COST / MARKET VALUATION | |
|--------------------------|---------|
| RCN | 216,822 |
| Year Built | 2010 |
| Effective Year Built | 2016 |
| Depreciation Code | VG |
| Remodel Rating | |
| Year Remodeled | |
| Depreciation % | 2 |
| Functional Obsol | |
| External Obsol | |
| Trend Factor | 1 |
| Condition | |
| Condition % | |
| Percent Good | 98 |
| RCNLD | 212,500 |
| Dep % Ovr | |
| Dep Ovr Comment | |
| Misc Imp Ovr | |
| Misc Imp Ovr Comment | |
| Cost to Cure Ovr | |
| Cost to Cure Ovr Comment | |

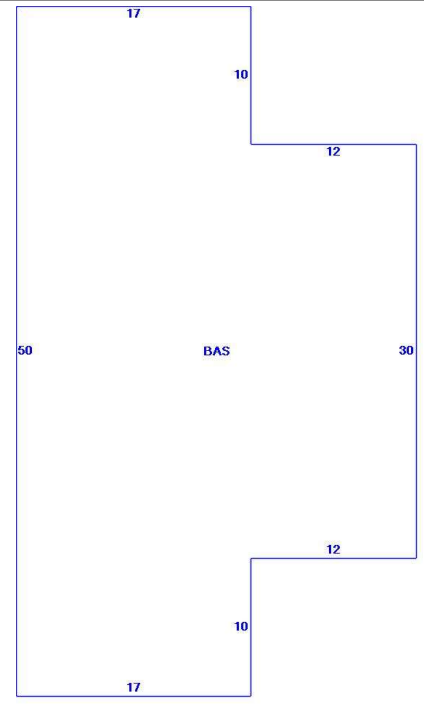

| OB - OUTBUILDING & YARD ITEMS(L) / XF - BUILDING EXTRA FEATURES(B) | | | | | | | | | | |
|--|--------------|-----|-------|------------|--------|----------|--------|-------|-----------|-------------|
| Code | Description | L/B | Units | Unit Price | Yr Blt | Cond. Cd | % Good | Grade | Grade Adj | Appr. Value |
| PAV1 | PAVING-ASPH | L | 9,360 | 3.00 | 2010 | | 82 | | 0.00 | 23,000 |
| LT1 | LT POLE W/MH | L | 1 | 4251.00 | 2010 | | 82 | | 0.00 | 3,500 |

| BUILDING SUB-AREA SUMMARY SECTION | | | | | | | |
|-----------------------------------|-------------|-------------|------------|----------|-----------|----------------|--|
| Code | Description | Living Area | Floor Area | Eff Area | Unit Cost | Undeprec Value | |
| BAS | First Floor | 1,210 | 1,210 | 1,210 | 179.19 | 216,822 | |
| Ttl Gross Liv / Lease Area | | 1,210 | 1,210 | 1,210 | | 216,822 | |

