

| CURRENT OWNER                    |  |  | TOPO | UTILITIES | STRT / ROAD | LOCATION    | CURRENT ASSESSMENT |      |          |          |                                 |
|----------------------------------|--|--|------|-----------|-------------|-------------|--------------------|------|----------|----------|---------------------------------|
| WHELAN, DAVID A & GRIFFIN, SUSAN |  |  |      |           |             |             | Description        | Code | Assessed | Assessed | 801<br>FY2024<br>BARNSTABLE, MA |
| 52 SCHOONER DRIVE                |  |  |      |           |             |             | RESIDNTL           | 1010 | 675,300  | 675,300  |                                 |
| COTUIT MA 02635                  |  |  |      |           |             |             | RES LAND           | 1010 | 208,500  | 208,500  |                                 |
| SUPPLEMENTAL DATA                |  |  |      |           |             |             |                    |      |          |          |                                 |
| Alt Prcl ID                      |  |  |      |           |             | Plan Ref.   | 503/57             |      |          |          |                                 |
| Split Zonin                      |  |  |      |           |             | Land Ct#    |                    |      |          |          |                                 |
| BID Parcel                       |  |  |      |           |             | #SR         |                    |      |          |          |                                 |
| ResExpt Q YES:                   |  |  |      |           |             | Life Estate |                    |      |          |          |                                 |
| #DL 1 LOT 5A                     |  |  |      |           |             | PP STATU    |                    |      |          |          |                                 |
| #DL 2                            |  |  |      |           |             | Assoc Pid#  |                    |      |          |          |                                 |
| GIS ID F_942607_2693634          |  |  |      |           |             |             | Total              |      | 883,800  | 883,800  |                                 |

| RECORD OF OWNERSHIP                |  |  | BK-VOL/PAGE | SALE DATE  | Q/U | V/I | SALE PRIC | VC | PREVIOUS ASSESSMENTS (HISTORY) |      |          |       |      |          |       |         |
|------------------------------------|--|--|-------------|------------|-----|-----|-----------|----|--------------------------------|------|----------|-------|------|----------|-------|---------|
| WHELAN, DAVID A & GRIFFIN, SUSAN M |  |  | 32223 0317  | 08-15-2019 | Q   | I   | 580,000   | 00 | Year                           | Code | Assessed | Year  | Code | Assessed |       |         |
| LANCE, DAVID                       |  |  | 19023 0002  | 09-10-2004 | U   | I   | 0         | 1A | 2023                           | 1010 | 598,600  | 2022  | 1010 | 502,000  |       |         |
| LANCE, DAVID & NANCY               |  |  | 12301 0120  | 05-28-1999 | U   | I   | 289,000   | 2  |                                | 1010 | 206,600  |       | 1010 | 148,400  |       |         |
| STANTON, JOHN M & JOYCE E          |  |  | 9269 0199   | 07-15-1994 | U   | I   | 74,900    | D  |                                |      |          |       | 1010 | 3,500    |       |         |
| ZIEMAN, ALDEN M TR                 |  |  | 8990 0129   | 01-15-1994 | U   | I   | 100       | B  | Total                          |      | 805,200  | Total |      | 650,400  | Total | 560,600 |

| EXEMPTIONS |      |                       |        | OTHER ASSESSMENTS |             |        |        |
|------------|------|-----------------------|--------|-------------------|-------------|--------|--------|
| Year       | Code | Description           | Amount | Code              | Description | Number | Amount |
| 2021       | 5C   | RESIDENTIAL EXEMPTION | 0.00   |                   |             |        |        |
| Total      |      |                       | 0.00   |                   |             |        |        |

| ASSESSING NEIGHBORHOOD |           |   |         |
|------------------------|-----------|---|---------|
| Nbhd                   | Nbhd Name | B | Tracing |
| 0106                   |           |   | COTUIT  |

| NOTES                                                               |  |  |         |
|---------------------------------------------------------------------|--|--|---------|
| This signature acknowledges a visit by a Data Collector or Assessor |  |  |         |
| APPRAISED VALUE SUMMARY                                             |  |  |         |
| Appraised Bldg. Value (Card)                                        |  |  | 606,500 |
| Appraised Xf (B) Value (Bldg)                                       |  |  | 65,300  |
| Appraised Ob (B) Value (Bldg)                                       |  |  | 3,500   |
| Appraised Land Value (Bldg)                                         |  |  | 208,500 |
| Special Land Value                                                  |  |  | 0       |
| Total Appraised Parcel Value                                        |  |  | 883,800 |
| Valuation Method                                                    |  |  | C       |
| Total Appraised Parcel Value                                        |  |  | 883,800 |

| BUILDING PERMIT RECORD |            |      |              |         |            |        |            | VISIT / CHANGE HISTORY        |            |     |      |    |    |                  |
|------------------------|------------|------|--------------|---------|------------|--------|------------|-------------------------------|------------|-----|------|----|----|------------------|
| Permit Id              | Issue Date | Type | Description  | Amount  | Insp Date  | % Comp | Date Comp  | Comments                      | Date       | Id  | Type | Is | Cd | Purpost/Result   |
| BLDR-21-97             | 08-06-2021 | 804  | Addn Alt-Res | 2,769   |            | 100    |            | Insulation and Weatherization | 08-06-2021 | CK  | 01   |    | 03 | Cycl Insp Comp   |
| 201203911              | 06-27-2012 | NR   | New Roof     | 10,000  | 06-30-2012 | 100    | 06-30-2012 | REROOF STRIPPING OLD          | 02-02-2021 | PK  | 03   |    | 16 | In Office Review |
| B36968                 | 08-01-1994 | DW   | Dwelling     | 160,000 | 01-15-1996 | 100    | 12-31-1996 | CO 11/2 S                     | 05-26-2020 | DM  |      |    | FR | Field Review     |
|                        |            |      |              |         |            |        |            |                               | 02-19-2020 | SAF |      |    | 20 | Sale Review      |
|                        |            |      |              |         |            |        |            |                               | 08-29-2014 | JR  | 03   |    | 16 | In Office Review |
|                        |            |      |              |         |            |        |            |                               | 10-09-2013 | RB  | 03   |    | 03 | Cycl Insp Comp   |
|                        |            |      |              |         |            |        |            |                               | 01-06-2005 | PT  | 02   |    | 01 | Meas/Est         |

| LAND LINE VALUATION SECTION |          |                |      |    |            |                        |          |         |            |       |       |                  |         |                    |            |            |         |
|-----------------------------|----------|----------------|------|----|------------|------------------------|----------|---------|------------|-------|-------|------------------|---------|--------------------|------------|------------|---------|
| B                           | Use Code | Description    | Zone | LA | Land Units | Unit Price             | Size Adj | AC Disc | Site Index | Cond. | Nbhd. | Nbhd. Adj        | Notes   | Location Adjustmen | Adj Unit P | Land Value |         |
| 1                           | 1010     | Single Fam M-0 | RF   | 2  | 1.000 AC   | 176,344.00             | 1.00000  | 1.0000  | 5          | 1.00  | 0106  | 1.150            |         | 1.0000             | 202,795.6  | 202,800    |         |
| 1                           | 1010     | Single Fam M-0 | RF   | 2  | 0.340 AC   | 14,250.00              | 1.00000  | 1.0000  | 0          | 1.00  | 0106  | 1.150            |         | 1.0000             | 16,387.5   | 5,600      |         |
| 1                           | 1010     | Single Fam M-0 | RF   | 2  | 0.040 AC   | 2,375.00               | 1.00000  | 1.0000  | 0          | 1.00  | WTLD  | 1.000            | WETLAND | 1.0000             | 2,375      | 100        |         |
| Total Card Land Units       |          |                |      |    | 1.38 AC    | Parcel Total Land Area |          |         |            |       | 1.38  | Total Land Value |         |                    |            |            | 208,500 |

**VISION**

| CONSTRUCTION DETAIL |     |                | CONSTRUCTION DETAIL (CONTINUED) |    |             |
|---------------------|-----|----------------|---------------------------------|----|-------------|
| Element             | Cd  | Description    | Element                         | Cd | Description |
| Style               | 04  | Cape Cod       |                                 |    |             |
| Model               | 01  | Residential    |                                 |    |             |
| Grade:              | B-  | Custom Minus   |                                 |    |             |
| Stories             | 1.5 | 1 1/2 Stories  |                                 |    |             |
| Exterior Wall 1     | 14  | Wood Shingle   |                                 |    |             |
| Exterior Wall 2     | 11  | Clapboard      |                                 |    |             |
| Roof Structure      | 03  | Gable/Hip      |                                 |    |             |
| Roof Cover          | 03  | Asph/F Gls/Cmp |                                 |    |             |
| Interior Wall 1     | 03  | Plastered      |                                 |    |             |
| Interior Wall 2     |     |                |                                 |    |             |
| Interior Floor 1    | 14  | Carpet         |                                 |    |             |
| Interior Floor 2    | 12  | Hardwood       |                                 |    |             |
| Heat Fuel           | 02  | Oil            |                                 |    |             |
| Heat Type           | 05  | Hot Water      |                                 |    |             |
| AC Type             | 03  | Central        |                                 |    |             |
| Bedrooms            | 03  | 3 Bedrooms     |                                 |    |             |
| Full Baths          | 2   |                |                                 |    |             |
| Half Baths          | 1   |                |                                 |    |             |
| Extra Fixtures      |     |                |                                 |    |             |
| Total Rooms         | 5   | 5 Rooms        |                                 |    |             |
| Bath Style          |     |                |                                 |    |             |
| Kitchen Style       |     |                |                                 |    |             |
| Occupancy           |     |                |                                 |    |             |
| Usrflid 105         |     |                |                                 |    |             |
| Accessory Apt       |     |                |                                 |    |             |
| Foundation Alt      | 01  | Poured Conc.   |                                 |    |             |
| Rms Prts            |     |                |                                 |    |             |
| Bath Split          | 21  | 2 Full-1 Half  |                                 |    |             |

| CONDO DATA  |      |             |         |          |
|-------------|------|-------------|---------|----------|
| Parcel Id   |      | C           |         | Owne 0.0 |
| Adjust Type | Code | Description | Factor% |          |
| Condo Flr   |      |             |         |          |
| Condo Unit  |      |             |         |          |

| COST / MARKET VALUATION  |  |         |
|--------------------------|--|---------|
| Building Value New       |  | 689,236 |
| Year Built               |  | 1994    |
| Effective Year Built     |  | 2003    |
| Depreciation Code        |  | A       |
| Remodel Rating           |  |         |
| Year Remodeled           |  |         |
| Depreciation %           |  | 12      |
| Functional Obsol         |  | 0       |
| External Obsol           |  | 0       |
| Trend Factor             |  | 1       |
| Condition                |  |         |
| Condition %              |  |         |
| Percent Good             |  | 88      |
| RCNLD                    |  | 606,500 |
| Dep % Ovr                |  |         |
| Dep Ovr Comment          |  |         |
| Misc Imp Ovr             |  |         |
| Misc Imp Ovr Comment     |  |         |
| Cost to Cure Ovr         |  |         |
| Cost to Cure Ovr Comment |  |         |

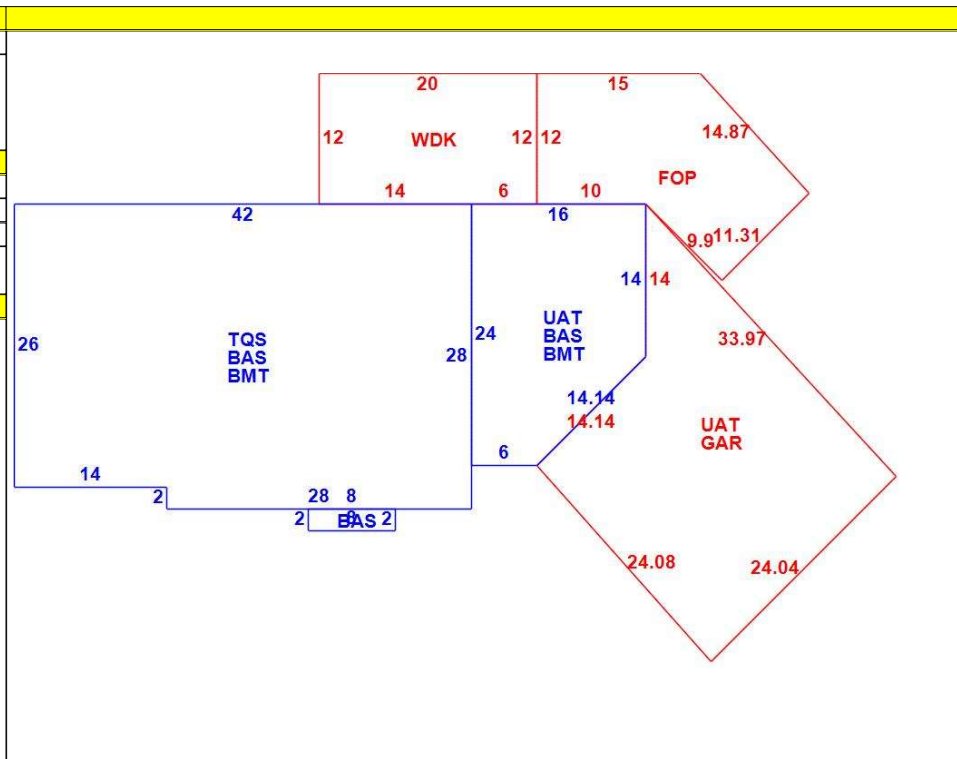

| OB - OUTBUILDING & YARD ITEMS(L) / XF - BUILDING EXTRA FEATURES(B) |                 |     |       |            |        |          |      |       |            |             |
|--------------------------------------------------------------------|-----------------|-----|-------|------------|--------|----------|------|-------|------------|-------------|
| Code                                                               | Description     | L/B | Units | Unit Price | Yr Blt | Cond. Cd | % Gd | Grade | Grade Adj. | Appr. Value |
| FPL2                                                               | Fireplace 1.5 s | B   | 1     | 6000.00    | 2005   |          | 88   |       | 0.00       | 5,300       |
| WDC                                                                | Wood Decking    | L   | 240   | 20.00      | 2002   |          | 66   |       | 0.00       | 3,500       |
| FOP                                                                | Open Porch-ro   | B   | 294   | 55.00      | 2005   |          | 88   |       | 0.00       | 10,200      |
| GAR                                                                | Attached Gara   | B   | 620   | 40.00      | 2005   |          | 88   |       | 0.00       | 18,900      |
| BMT                                                                | Basement-Unfi   | B   | 1,482 | 26.01      | 2005   |          | 88   |       | 0.00       | 30,900      |

| BUILDING SUB-AREA SUMMARY SECTION |                     |             |            |          |           |                |
|-----------------------------------|---------------------|-------------|------------|----------|-----------|----------------|
| Code                              | Description         | Living Area | Floor Area | Eff Area | Unit Cost | Undeprec Value |
| BAS                               | First Floor         | 1,498       | 1,498      | 1,498    | 294.67    | 441,418        |
| BMT                               | Basement Area       | 0           | 1,482      | 0        | 0.00      | 0              |
| FOP                               | Open Porch          | 0           | 294        | 0        | 0.00      | 0              |
| GAR                               | Attached Garage     | 0           | 620        | 0        | 0.00      | 0              |
| TQS                               | Three Quarter Story | 746         | 1,148      | 746      | 191.49    | 219,825        |
| UAT                               | Attic, Unfinished   | 0           | 954        | 95       | 29.34     | 27,994         |
| WDK                               | Wood Deck           | 0           | 240        | 0        | 0.00      | 0              |
| Ttl Gross Liv / Lease Area        |                     | 2,244       | 6,236      | 2,339    |           | 689,237        |

