

CURRENT OWNER		TOPO	UTILITIES	STRT / ROAD	LOCATION	CURRENT ASSESSMENT				801 FY2024 BARNSTABLE, MA VISION							
707 MAIN LLC						Description	Code	Appraised	Assessed								
707 MAIN STREET		SUPPLEMENTAL DATA				COMMERC.	3400	173,100	173,100								
HYANNIS MA 02601		Alt Prcl ID Split Zonin DMS;RB BID Parcel YES ResExpt Q #DL 1 LOT 21 #DL 2 GIS ID F_985859_2698973				COM LAND	3400	156,700	156,700								
						Total		329,800	329,800								
RECORD OF OWNERSHIP		BK-VOL/PAGE	SALE DATE	Q/U	V/I	SALE PRICE	VC	PREVIOUS ASSESSMENTS (HISTORY)									
707 MAIN LLC		C224 0	12-23-2020	U	I	1	1F	Year	Code	Assessed	Year	Code	Assessed				
MARICHAL, JUAN & REARDON JERARD		C216 0	06-20-2018	U	I	212,500	1P	2023	3400	173,100	2022	3400	147,700				
HERMENEDILGO, JAMES		C213 0	07-20-2017	U	I	120,000	1L		3400	156,700	2021	3400	156,700				
WHITCOMB, LINDA		C177 0	06-23-2005	U	I	67,000	1					3400	6,300				
CARADONNA, NICHOLAS M JR		C152 0	02-16-1999	U	I	83,000	1B	Total		329,800	Total		304,400				
								Total		329,800	Total		304,400				
EXEMPTIONS			OTHER ASSESSMENTS					This signature acknowledges a visit by a Data Collector or Assessor									
Year	Code	Description	Amount	Code	Description	Number	Amount	Comm Int									
		Total				0.00											
ASSESSING NEIGHBORHOOD																	
Nbhd		Nbhd Name		B		Tracing		Batch									
CI09								HYAN									
NOTES																	
--SEAPORT VILLAGE REALTY--																	
BUILDING PERMIT RECORD																	
Permit Id	Issue Date	Type	Description	Amount	Insp Date	% Comp	Date Comp	Comments	Date	Id	Type	Is	Cd	Purpost/Result			
18-3537	10-29-2018	803	Addn Alt-Comm	1,500	06-30-2019	100	06-30-2019	Insulation in 2x6 existing wall (04-30-2020	GM	04		FR	Field Review			
18-2836	08-29-2018	836	Sign	0	06-30-2019	100	06-30-2019	Install 2 wall signs 24.5 sq eac	05-08-2019	CK	22		22	Change of Address			
									12-22-2014	JR	03		03	Cycl Insp Comp			
									05-11-2011	DR	03		16	In Office Review			
									01-24-2006	PT	02		01	Meas/Est			
LAND LINE VALUATION SECTION																	
B	Use Code	Description	Zone	LA	Land Type	Land Units	Unit Price	I. Factor	Site Index	Cond.	Nbhd.	Nbhd Adj	Notes	Location Adjustme	Adj Unit Pric	Land Value	
1	3400	OFFICE BLD M9	SPLI	4		0.130	AC	330,000.00	3.84615	C	0.95	CI09	1.000	SS	0	1,205,754	156,700
Total Card Land Units						0.13	AC	Parcel Total Land Area: 0.13						Total Land Value		156,700	

CONSTRUCTION DETAIL			CONSTRUCTION DETAIL (CONTINUED)		
Element	Cd	Description	Element	Cd	Description
Style	18	Office Bldg			
Model	94	Commercial			
Grade	C	Average			
Stories	1				
Occupancy	1.00				
Exterior Wall 1	17	Stucco/Masonry			
Exterior Wall 2					
Roof Structure	01	Flat			
Roof Cover	04	Tar & Gravel			
Interior Wall 1	05	Drywall			
Interior Wall 2					
Interior Floor 1	14	Carpet			
Interior Floor 2					
Heating Fuel	03	Gas			
Heating Type	05	Hot Water			
AC Type	01	None			
Size Adj Tbl	3400	OFFICE BLD M94			
Total Rooms					
Bedrooms	0				
Full Bathrooms	0				
Bath Split	02	0 Full-2 Half			
Rms/Partitions	02	AVERAGE			
Heat/AC	03	HEAT ONLY			
Frame Type	03	MASONRY			
Baths/Plumbing	02	AVERAGE			
Ceiling/Wall	08	TYPICAL			
Common Wall	00	0%			
Wall Height	10.00				
1st Floor Use:	325I				
Sewer Occupan					

MIXED USE		
Code	Description	Percentage
3400	OFFICE BLD M94	100
		0
		0

COST / MARKET VALUATION	
RCN	225,436
Year Built	1925
Effective Year Built	1986
Depreciation Code	G
Remodel Rating	
Year Remodeled	
Depreciation %	26
Functional Obsol	0
External Obsol	0
Trend Factor	1
Condition	
Condition %	
Percent Good	74
RCNLD	166,800
Dep % Ovr	
Dep Ovr Comment	
Misc Imp Ovr	
Misc Imp Ovr Comment	
Cost to Cure Ovr	
Cost to Cure Ovr Comment	

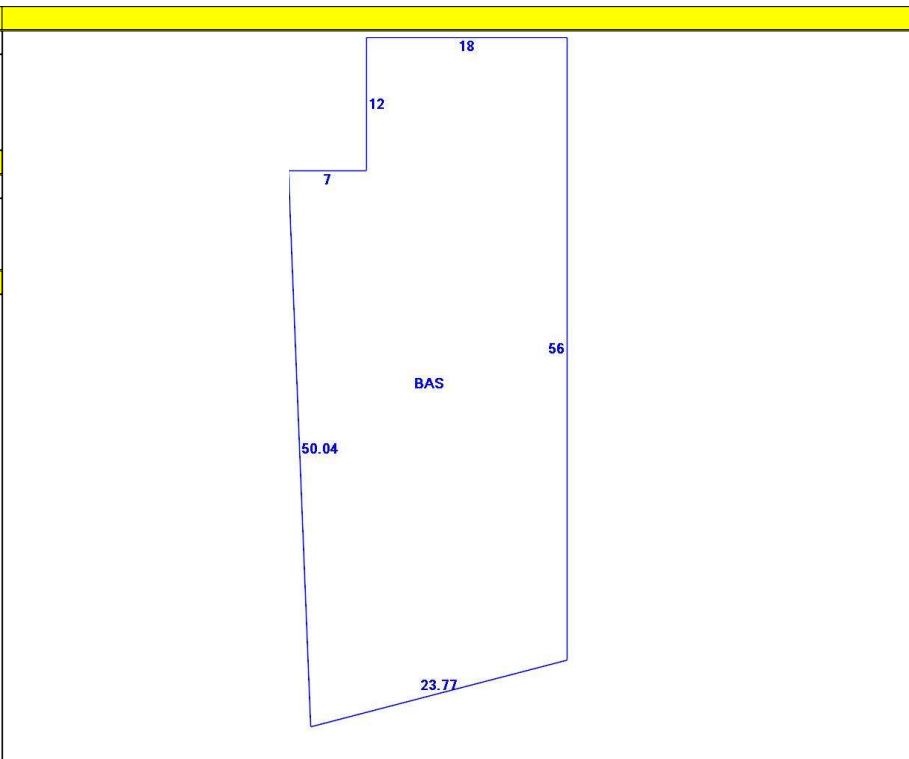

OB - OUTBUILDING & YARD ITEMS(L) / XF - BUILDING EXTRA FEATURES(B)										
Code	Description	L/B	Units	Unit Price	Yr Blt	Cond. Cd	% Good	Grade	Grade Adj	Appr. Value
PAV1	PAVING-ASPH	L	3,500	3.00	1999		60		0.00	6,300

BUILDING SUB-AREA SUMMARY SECTION							
Code	Description	Living Area	Floor Area	Eff Area	Unit Cost	Undeprec Value	
BAS	First Floor	1,347	1,347	1,347	167.36	225,436	
Ttl Gross Liv / Lease Area		1,347	1,347	1,347		225,436	

