

| CURRENT OWNER | | | | TOPO | UTILITIES | STRT / ROAD | LOCATION | CURRENT ASSESSMENT | | | | |
|---|--|--|--|------------------|--------------|-----------------|----------|--------------------|------|----------|----------|--|
| DIAZ, JOSE R & DORIS M 28 SOUTH SHORE ROAD NANTUCKET MA 02554 | | | | 1 Level | 1 All Public | 1 Paved | | Description | Code | Assessed | Assessed | 801 FY2024 BARNSTABLE, MA VISION |
| | | | | | 4 Gas | | | RESIDNTL | 1010 | 270,700 | 270,700 | |
| SUPPLEMENTAL DATA | | | | | | | | RES LAND | 1010 | 131,300 | 131,300 | |
| Alt Prcl ID | | | | Split Zonin | | Plan Ref. 14/41 | | | | | | |
| BID Parcel | | | | ResExpt Q | | Land Ct# | | | | | | |
| #DL 1 | | | | LOT 4 - BLOCK G | | #SR | | | | | | |
| #DL 2 | | | | | | Life Estate | | | | | | |
| GIS ID | | | | F_987785_2703774 | | PP STATU | | | | | | |
| | | | | | | Assoc Pid# | | | | | | |
| | | | | | | | | Total | | 402,000 | 402,000 | |

| RECORD OF OWNERSHIP | | | | BK-VOL/PAGE | SALE DATE | Q/U | V/I | SALE PRIC | VC | PREVIOUS ASSESSMENTS (HISTORY) | | | | | | | | | |
|-----------------------------------|--|--|--|-------------|-----------|------------|-----|-----------|---------|--------------------------------|-------|------|----------|-------|------|----------|------|------|---------|
| DIAZ, JOSE R & DORIS M | | | | 30050 | 0211 | 10-31-2016 | Q | I | 239,000 | 00 | Year | Code | Assessed | Year | Code | Assessed | | | |
| HUSKA, JULIE L & JOYCE, MICHAEL | | | | 27461 | 0204 | 06-14-2013 | U | I | 1 | 1 | 2023 | 1010 | 233,700 | 2022 | 1010 | 197,600 | 2021 | 1010 | 154,700 |
| HUSKA, JEFFREY D & JOYCE, MICHAEL | | | | 25685 | 0330 | 09-16-2011 | U | I | 1 | 1A | | 1010 | 119,300 | | 1010 | 88,400 | | 1010 | 88,400 |
| HUSKA, JEFFREY D TR | | | | 24762 | 0130 | 08-18-2010 | U | I | 1 | 1F | | | | | | | | 1010 | 13,500 |
| HUSKA, JEFFREY D | | | | 24762 | 0125 | 08-18-2010 | U | I | 66,950 | 1S | | | | | | | | | |
| | | | | | | | | Total | | 353,000 | Total | | 286,000 | Total | | 256,600 | | | |

| EXEMPTIONS | | | | OTHER ASSESSMENTS | | | | |
|------------|------|-------------|--------|-------------------|-------------|--------|--------|----------|
| Year | Code | Description | Amount | Code | Description | Number | Amount | Comm Int |
| | | | | | | | | |
| | | | Total | | | | | 0.00 |

| ASSESSING NEIGHBORHOOD | | | |
|------------------------|-----------|---|------------|
| Nbhd | Nbhd Name | B | Tracing |
| 0104 | | | Batch HYAN |

| NOTES | | | |
|---|--|--|---------|
| This signature acknowledges a visit by a Data Collector or Assessor | | | |
| APPRAISED VALUE SUMMARY | | | |
| Appraised Bldg. Value (Card) | | | 228,500 |
| Appraised Xf (B) Value (Bldg) | | | 28,700 |
| Appraised Ob (B) Value (Bldg) | | | 13,500 |
| Appraised Land Value (Bldg) | | | 131,300 |
| Special Land Value | | | 0 |
| Total Appraised Parcel Value | | | 402,000 |
| Valuation Method | | | C |
| Total Appraised Parcel Value | | | 402,000 |

| BUILDING PERMIT RECORD | | | | | | | | | VISIT / CHANGE HISTORY | | | | | |
|------------------------|------------|------|-------------|--------|------------|--------|------------|-----------|------------------------|----|------|----|----|----------------------------|
| Permit Id | Issue Date | Type | Description | Amount | Insp Date | % Comp | Date Comp | Comments | Date | Id | Type | Is | Cd | Purpost/Result |
| 201005314 | 10-14-2010 | RE | Remodel | 50,000 | 08-25-2011 | 100 | 06-30-2012 | REMOD HSE | 05-06-2020 | WD | | | FR | Field Review |
| | | | | | | | | | 12-19-2017 | KM | 02 | | 03 | Cycl Insp Comp |
| | | | | | | | | | 02-01-2017 | JR | 03 | | 20 | Sale Review |
| | | | | | | | | | 12-15-2011 | RB | 03 | | 16 | In Office Review |
| | | | | | | | | | 06-02-2003 | PT | 02 | | 01 | Meas/Est |
| | | | | | | | | | 03-13-2001 | SM | 01 | | 00 | Meas/Listed-Interior Acces |
| | | | | | | | | | 09-15-1987 | ME | 02 | | 01 | Meas/Est |

| LAND LINE VALUATION SECTION | | | | | | | | | | | | | | | | | |
|-----------------------------|----------|----------------|------|----|------------|------------|------------------------|---------|------------|-------|-------|-----------|------------------|--------------------|------------|------------|---------|
| B | Use Code | Description | Zone | LA | Land Units | Unit Price | Size Adj | AC Disc | Site Index | Cond. | Nbhd. | Nbhd. Adj | Notes | Location Adjustmen | Adj Unit P | Land Value | |
| 1 | 1010 | Single Fam M-0 | RB | 4 | 0.110 | AC | 176,344.00 | 6.76653 | 1.0000 | 5 | 1.00 | 0105 | 1.000 | | 1.0000 | 1,193,231 | 131,300 |
| Total Card Land Units | | | | | 0.11 | AC | Parcel Total Land Area | | | | | 0.11 | Total Land Value | | | 131,300 | |

| CONSTRUCTION DETAIL | | | CONSTRUCTION DETAIL (CONTINUED) | | |
|---------------------|------|----------------|---------------------------------|----|-------------|
| Element | Cd | Description | Element | Cd | Description |
| Style | 06 | Conventional | | | |
| Model | 01 | Residential | | | |
| Grade: | C | Average | | | |
| Stories | 1.15 | 1 Story w/FAT | | | |
| Exterior Wall 1 | 25 | Vinyl Siding | | | |
| Exterior Wall 2 | | | | | |
| RooF Structure | 03 | Gable/Hip | | | |
| RooF Cover | 03 | Asph/F Gls/Cmp | | | |
| Interior Wall 1 | 05 | Drywall | | | |
| Interior Wall 2 | | | | | |
| Interior Floor 1 | 14 | Carpet | | | |
| Interior Floor 2 | | | | | |
| Heat Fuel | 03 | Gas | | | |
| Heat Type | 05 | Hot Water | | | |
| AC Type | 01 | None | | | |
| Bedrooms | 03 | 3 Bedrooms | | | |
| Full Baths | 2 | | | | |
| Half Baths | 0 | | | | |
| Extra Fixtures | | | | | |
| Total Rooms | 6 | 6 Rooms | | | |
| Bath Style | | | | | |
| Kitchen Style | | | | | |
| Occupancy | | | | | |
| UsrflD 105 | | | | | |
| Accessory Apt | | | | | |
| Foundation Alt | 01 | Poured Conc. | | | |
| Rms Prts | | | | | |
| Bath Split | 20 | 2 Full-0 Half | | | |

| CONDO DATA | | | | |
|-------------|------|-------------|---------|-----|
| Parcel Id | | C | Owne | 0.0 |
| Adjust Type | Code | Description | Factor% | |
| Condo Flr | | | | |
| Condo Unit | | | | |

| COST / MARKET VALUATION | | |
|--------------------------|--|---------|
| Building Value New | | 256,754 |
| Year Built | | 1920 |
| Effective Year Built | | 2005 |
| Depreciation Code | | E |
| Remodel Rating | | |
| Year Remodeled | | |
| Depreciation % | | 11 |
| Functional Obsol | | 0 |
| External Obsol | | 0 |
| Trend Factor | | 1 |
| Condition | | |
| Condition % | | |
| Percent Good | | 89 |
| RCNLD | | 228,500 |
| Dep % Ovr | | |
| Dep Ovr Comment | | |
| Misc Imp Ovr | | |
| Misc Imp Ovr Comment | | |
| Cost to Cure Ovr | | |
| Cost to Cure Ovr Comment | | |

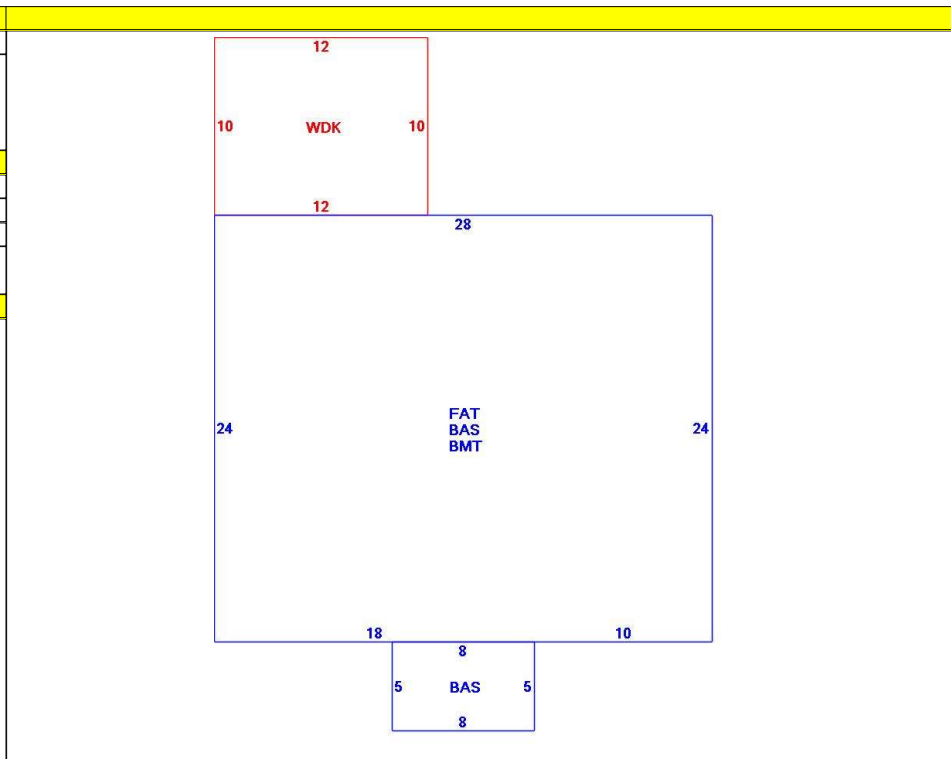

| OB - OUTBUILDING & YARD ITEMS(L) / XF - BUILDING EXTRA FEATURES(B) | | | | | | | | | | |
|--|---------------|-----|-------|------------|--------|----------|------|-------|------------|-------------|
| Code | Description | L/B | Units | Unit Price | Yr Blt | Cond. Cd | % Gd | Grade | Grade Adj. | Appr. Value |
| FGR2 | Garage- Avg- | L | 240 | 50.00 | 2005 | | 86 | 00 | 1.00 | 10,300 |
| BFA | Bsmt Fin-Avg | B | 400 | 17.36 | 2005 | | 89 | | 0.00 | 6,200 |
| FEP | Enclosed porc | B | 40 | 70.00 | 2005 | | 89 | | 0.00 | 4,200 |
| BMT | Basement-Unfi | B | 672 | 26.01 | 2005 | | 89 | | 0.00 | 18,300 |
| WDC | Wood Decking | L | 120 | 20.00 | 2011 | | 84 | | 0.00 | 3,200 |

| BUILDING SUB-AREA SUMMARY SECTION | | | | | | |
|-----------------------------------|-----------------|-------------|------------|----------|-----------|----------------|
| Code | Description | Living Area | Floor Area | Eff Area | Unit Cost | Undeprec Value |
| BAS | First Floor | 712 | 712 | 712 | 315.81 | 224,857 |
| BMT | Basement Area | 0 | 672 | 0 | 0.00 | 0 |
| FAT | Attic, Finished | 101 | 672 | 101 | 47.47 | 31,897 |
| WDC | Wood Deck | 0 | 120 | 0 | 0.00 | 0 |
| Ttl Gross Liv / Lease Area | | 813 | 2,176 | 813 | | 256,754 |

