

| CURRENT OWNER | | TOPO | UTILITIES | STRT / ROAD | LOCATION | CURRENT ASSESSMENT | | | |
|---|--|------------------|------------------|--|----------|--------------------|------|----------|----------|
| LOUMIOTIS, PETER & SANDRA J TR LOUMIOTIS PETER & SANDRA R E T 205 SALT ROCK RD BARNSTABLE MA 02630 | | 2 Above Street | 6 Septic | 1 Paved | | Description | Code | Assessed | Assessed |
| | | | 4 Gas | | | RESIDNTL | 1010 | 458,500 | 458,500 |
| | | | 2 Public Water | | | RES LAND | 1010 | 200,700 | 200,700 |
| SUPPLEMENTAL DATA | | | | | | | | | |
| Alt Prcl ID Split Zonin BID Parcel ResExpt Q YES: #DL 1 LOT 11 #DL 2 GIS ID F_985950_2715518 | | | | Plan Ref. 222/85 Land Ct# #SR Life Estate PP STATU Assoc Pid# | | Total | | 659,200 | 659,200 |

801
 FY2024
 BARNSTABLE, MA

VISION

| RECORD OF OWNERSHIP | | BK-VOL/PAGE | SALE DATE | Q/U | V/I | SALE PRIC | VC | PREVIOUS ASSESSMENTS (HISTORY) | | | | | | | | |
|--|--|-------------|------------|-----|-----|-----------|----|--------------------------------|------|----------|-------|------|----------|-------|--|---------|
| LOUMIOTIS, PETER & SANDRA J TRS LOUMIOTIS, PETER & SOPHIA | | 9560 0095 | 02-16-1995 | U | I | 1 | 1F | Year | Code | Assessed | Year | Code | Assessed | | | |
| | | 3104 0013 | 05-30-1980 | U | | 0 | | 2023 | 1010 | 375,400 | 2022 | 1010 | 324,400 | | | |
| | | | | | | | | 2021 | 1010 | 141,100 | 2021 | 1010 | 263,900 | | | |
| | | | | | | | | | 1010 | 141,100 | | 1010 | 141,100 | | | |
| | | | | | | | | | 1010 | 3,300 | | | 3,300 | | | |
| | | | | | | | | Total | | 573,800 | Total | | 465,500 | Total | | 408,300 |

| EXEMPTIONS | | | | OTHER ASSESSMENTS | | | |
|------------|------|-----------------------|--------|-------------------|-------------|--------|--------|
| Year | Code | Description | Amount | Code | Description | Number | Amount |
| 2011 | 5C | RESIDENTIAL EXEMPTION | 0.00 | | | | |
| Total | | | 0.00 | | | | |

This signature acknowledges a visit by a Data Collector or Assessor

| ASSESSING NEIGHBORHOOD | | | | APPRAISED VALUE SUMMARY | | | |
|------------------------|-----------|---|---------|--------------------------------------|--|--|--|
| Nbhd | Nbhd Name | B | Tracing | Batch | | | |
| 0106 | | | | BARNS | | | |
| NOTES | | | | | | | |
| | | | | Appraised Bldg. Value (Card) 402,200 | | | |
| | | | | Appraised Xf (B) Value (Bldg) 53,000 | | | |
| | | | | Appraised Ob (B) Value (Bldg) 3,300 | | | |
| | | | | Appraised Land Value (Bldg) 200,700 | | | |
| | | | | Special Land Value 0 | | | |
| | | | | Total Appraised Parcel Value 659,200 | | | |
| | | | | Valuation Method C | | | |
| | | | | Total Appraised Parcel Value 659,200 | | | |

| BUILDING PERMIT RECORD | | | | | | | | | VISIT / CHANGE HISTORY | | | | | |
|------------------------|------------|------|----------------|--------|------------|--------|------------|---------------------|------------------------|----|------|----|----|----------------------------|
| Permit Id | Issue Date | Type | Description | Amount | Insp Date | % Comp | Date Comp | Comments | Date | Id | Type | Is | Cd | Purpost/Result |
| 2015-06672 | 04-12-2016 | 835 | Sid/Wind/Roof/ | 13,137 | 06-30-2016 | 100 | 06-30-2016 | REPLACEMENT WINDOWS | 08-17-2023 | SR | 01 | | 03 | Cycl Insp Comp |
| 41941 | 10-25-1999 | AD | Addition | 2,000 | 03-26-2001 | 100 | 01-01-2001 | 6 X 10 | 05-06-2020 | DM | | | FR | Field Review |
| | | | | | | | | | 10-21-2015 | SR | 02 | | 03 | Cycl Insp Comp |
| | | | | | | | | | 10-04-2000 | MF | 01 | | 00 | Meas/Listed-Interior Acces |

| LAND LINE VALUATION SECTION | | | | | | | | | | | | | | | | |
|-----------------------------|----------|----------------|------|----|------------|------------|------------------------|---------|------------|-------|-------|-----------|------------------|--------------------|------------|------------|
| B | Use Code | Description | Zone | LA | Land Units | Unit Price | Size Adj | AC Disc | Site Index | Cond. | Nbhd. | Nbhd. Adj | Notes | Location Adjustmen | Adj Unit P | Land Value |
| 1 | 1010 | Single Fam M-0 | RF-1 | 1 | 0.890 AC | 176,344.00 | 1.11212 | 1.0000 | 5 | 1.00 | 0106 | 1.150 | | 1.0000 | 225,526.3 | 200,700 |
| Total Card Land Units | | | | | 0.89 | AC | Parcel Total Land Area | | | | | 0.89 | Total Land Value | | | 200,700 |

| CONSTRUCTION DETAIL | | | CONSTRUCTION DETAIL (CONTINUED) | | |
|---------------------|----|----------------|---------------------------------|----|-------------|
| Element | Cd | Description | Element | Cd | Description |
| Style | 01 | Ranch | | | |
| Model | 01 | Residential | | | |
| Grade: | C | Average | | | |
| Stories | 1 | 1 Story | | | |
| Exterior Wall 1 | 14 | Wood Shingle | | | |
| Exterior Wall 2 | 11 | Clapboard | | | |
| RooF Structure | 03 | Gable/Hip | | | |
| RooF Cover | 03 | Asph/F Gls/Cmp | | | |
| Interior Wall 1 | 05 | Drywall | | | |
| Interior Wall 2 | | | | | |
| Interior Floor 1 | 12 | Hardwood | | | |
| Interior Floor 2 | | | | | |
| Heat Fuel | 02 | Oil | | | |
| Heat Type | 05 | Hot Water | | | |
| AC Type | 03 | Central | | | |
| Bedrooms | 03 | 3 Bedrooms | | | |
| Full Baths | 2 | | | | |
| Half Baths | 0 | | | | |
| Extra Fixtures | | | | | |
| Total Rooms | 7 | 7 Rooms | | | |
| Bath Style | | | | | |
| Kitchen Style | | | | | |
| Occupancy | | | | | |
| Usrflid 105 | | | | | |
| Accessory Apt | | | | | |
| Foundation Alt | 01 | Poured Conc. | | | |
| Rms Prts | | | | | |
| Bath Split | 20 | 2 Full-0 Half | | | |

| CONDO DATA | | | |
|-------------|------|-------------|----------|
| Parcel Id | | C | Owne 0.0 |
| Adjust Type | Code | Description | Factor% |
| Condo Flr | | | |
| Condo Unit | | | |

| COST / MARKET VALUATION | |
|--------------------------|---------|
| Building Value New | 496,487 |
| Year Built | 1976 |
| Effective Year Built | 1994 |
| Depreciation Code | A |
| Remodel Rating | |
| Year Remodeled | |
| Depreciation % | 19 |
| Functional Obsol | 0 |
| External Obsol | 0 |
| Trend Factor | 1 |
| Condition | |
| Condition % | |
| Percent Good | 81 |
| RCNLD | 402,200 |
| Dep % Ovr | |
| Dep Ovr Comment | |
| Misc Imp Ovr | |
| Misc Imp Ovr Comment | |
| Cost to Cure Ovr | |
| Cost to Cure Ovr Comment | |

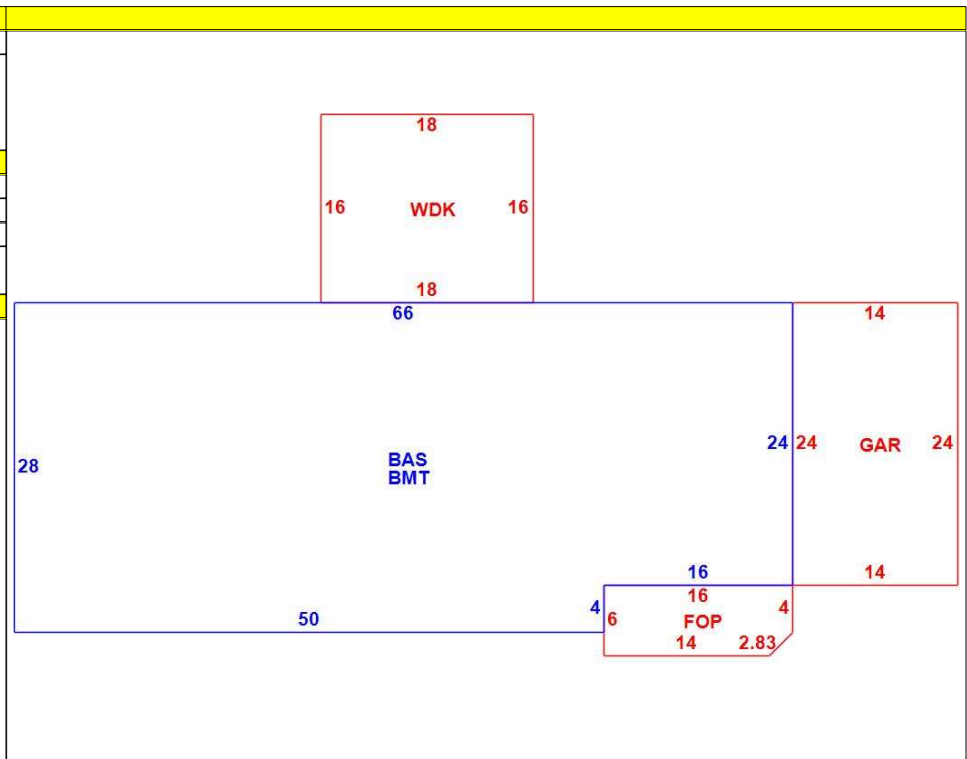

| OB - OUTBUILDING & YARD ITEMS(L) / XF - BUILDING EXTRA FEATURES(B) | | | | | | | | | | |
|--|-----------------|-----|-------|------------|--------|----------|------|-------|------------|-------------|
| Code | Description | L/B | Units | Unit Price | Yr Blt | Cond. Cd | % Gd | Grade | Grade Adj. | Appr. Value |
| FPL1 | Fireplace 1 sto | B | 1 | 5000.00 | 1996 | | 81 | | 0.00 | 4,100 |
| WDC | Wood Decking | L | 288 | 20.00 | 1997 | | 56 | | 0.00 | 3,300 |
| FOP | Open Porch-ro | B | 94 | 55.00 | 1996 | | 81 | | 0.00 | 4,300 |
| GAR | Attached Gara | B | 336 | 40.00 | 1996 | | 81 | | 0.00 | 11,700 |
| BMT | Basement-Unfi | B | 1,784 | 26.01 | 1996 | | 81 | | 0.00 | 32,900 |

| BUILDING SUB-AREA SUMMARY SECTION | | | | | | |
|-----------------------------------|-----------------|-------------|------------|----------|-----------|----------------|
| Code | Description | Living Area | Floor Area | Eff Area | Unit Cost | Undeprec Value |
| BAS | First Floor | 1,784 | 1,784 | 1,784 | 278.30 | 496,487 |
| BMT | Basement Area | 0 | 1,784 | 0 | 0.00 | 0 |
| FOP | Open Porch | 0 | 94 | 0 | 0.00 | 0 |
| GAR | Attached Garage | 0 | 336 | 0 | 0.00 | 0 |
| WDC | Wood Deck | 0 | 288 | 0 | 0.00 | 0 |
| Ttl Gross Liv / Lease Area | | 1,784 | 4,286 | 1,784 | | 496,487 |

