

| CURRENT OWNER  |   | TOPO  | UTILITIES | STRT / ROAD  | LOCATION | CURRENT ASSESSMENT |             |         |          | 801<br>FY2024<br>BARNSTABLE, MA<br><br><b>VISION</b> |          |
|--|---|-------|-----------|--|----------|--------------------|-------------|---------|----------|--|----------|
| PERRIER, RONALD A & SIMONE B<br><br>2 PALOMINO DRIVE<br><br>BARNSTABLE MA 02630                                | 1 | Level | 6         | Septic   | 1        | Paved              | Description | Code    | Assessed |  | Assessed |
|  |   |       | 4         | Gas  |          |                    | RESIDENTL   | 1010    | 456,400  |  | 456,400  |
|  |   |       | 2         | Public Water   |          |                    | RES LAND    | 1010    | 203,000  |  | 203,000  |
| <b>SUPPLEMENTAL DATA</b>   |   |       |           |  |          | Total              |             | 659,400 | 659,400  |  |          |
| Alt Prcl ID<br>Split Zonin<br>BID Parcel<br>ResExpt Q YES:<br>#DL 1 LOT 82<br>#DL 2<br>GIS ID F_985537_2715740 |   |       |           | Plan Ref. 280/55<br>Land Ct#<br>#SR<br>Life Estate<br>PP STATU<br>Assoc Pid# |          |                    |             |         |          |  |          |

| RECORD OF OWNERSHIP            |       | BK-VOL/PAGE | SALE DATE  | Q/U | V/I | SALE PRIC | VC | PREVIOUS ASSESSMENTS (HISTORY) |      |          |       |      |          |
|--------------------------------|-------|-------------|------------|-----|-----|-----------|----|--------------------------------|------|----------|-------|------|----------|
| PERRIER, RONALD A & SIMONE B   | 24775 | 0178        | 08-25-2010 | Q   | I   | 370,000   | 00 | Year                           | Code | Assessed | Year  | Code | Assessed |
| ANDERSON, MARGARET E ESTATE OF | 24775 | 0176        | 08-25-2010 | U   | I   | 0         | 1  | 2023                           | 1010 | 393,000  | 2022  | 1010 | 338,000  |
| ANDERSON, MARGARET E           | 19382 | 0173        | 12-28-2004 | Q   | I   | 430,000   | 00 |                                | 1010 | 200,600  | 2021  | 1010 | 142,700  |
| BLAIR, GEORGE L & DIANNE H     | 2662  | 0121        | 02-16-1978 | U   |     | 0         |    | Total                          |      | 593,600  | Total |      | 480,700  |
|                                |       |             |            |     |     |           |    | Total                          |      | 418,500  | Total |      | 418,500  |

| EXEMPTIONS |      |                       |        | OTHER ASSESSMENTS |             |        |        | APPRAISED VALUE SUMMARY              |   |  |  |  |
|------------|------|-----------------------|--------|-------------------|-------------|--------|--------|--------------------------------------|---|--|--|--|
| Year       | Code | Description           | Amount | Code              | Description | Number | Amount | Comm Int                             | This signature acknowledges a visit by a Data Collector or Assessor |  |  |  |
| 2012       | 5C   | RESIDENTIAL EXEMPTION | 0.00   |                   |             |        |        |                                      | Appraised Bldg. Value (Card) 404,700                                |  |  |  |
| Total      |      |                       | 0.00   |                   |             |        |        | Appraised Xf (B) Value (Bldg) 40,700 |   |  |  |  |

| ASSESSING NEIGHBORHOOD |           |   |         |
|------------------------|-----------|---|---------|
| Nbhd                   | Nbhd Name | B | Tracing |
| 0106                   |           |   | BARNS   |

| NOTES  |  |  |  |
|--|--|--|--|
| <p>Appraised Land Value (Bldg) 203,000</p> <p>Special Land Value 0</p> <p>Total Appraised Parcel Value 659,400</p> <p>Valuation Method C</p> <p>Total Appraised Parcel Value 659,400</p> |  |  |  |

| BUILDING PERMIT RECORD |            |      |                |        |            |        |            |                                  | VISIT / CHANGE HISTORY |    |      |    |    |                  |
|------------------------|------------|------|----------------|--------|------------|--------|------------|----------------------------------|------------------------|----|------|----|----|------------------|
| Permit Id              | Issue Date | Type | Description    | Amount | Insp Date  | % Comp | Date Comp  | Comments                         | Date                   | Id | Type | Is | Cd | Purpost/Result   |
| 20-1438                | 06-08-2020 | 835  | Sid/Wind/Roof/ | 1,100  | 06-30-2020 | 100    | 06-30-2020 | Replacing soft and rotted shak   | 08-21-2023             | SR | 01   |    | 03 | Cycl Insp Comp   |
| 19-1650                | 05-17-2019 | 822  | Insulation     | 6,347  | 06-30-2019 | 100    | 06-30-2019 | Attic Damming, Attic insulation, | 05-06-2020             | DM |      |    | FR | Field Review     |
| 201102837              | 06-06-2011 | WD   | Wood Deck      | 800    | 11-09-2011 | 100    | 06-30-2012 | 12X14 WDK                        | 07-25-2016             | SR | 01   |    | 03 | Cycl Insp Comp   |
| B18929                 | 02-01-1977 | DW   | Dwelling       | 0      | 01-15-1979 | 100    |            | BA 1 STOR                        | 03-27-2012             | RB | 03   |    | 16 | In Office Review |
|                        |            |      |                |        |            |        |            |                                  | 01-17-2012             | TR | 03   |    | 16 | In Office Review |
|                        |            |      |                |        |            |        |            |                                  | 11-15-2011             | RB | 03   |    | 16 | In Office Review |
|                        |            |      |                |        |            |        |            |                                  | 11-09-2011             | NF | 03   |    | 20 | Sale Review      |

| LAND LINE VALUATION SECTION |          |                |      |    |            |               |                        |         |            |       |       |           |                  |                    |            |            |
|-----------------------------|----------|----------------|------|----|------------|---------------|------------------------|---------|------------|-------|-------|-----------|------------------|--------------------|------------|------------|
| B                           | Use Code | Description    | Zone | LA | Land Units | Unit Price    | Size Adj               | AC Disc | Site Index | Cond. | Nbhd. | Nbhd. Adj | Notes            | Location Adjustmen | Adj Unit P | Land Value |
| 1                           | 1010     | Single Fam M-0 | RF-1 | 1  | 1.000      | AC 176,344.00 | 1.00000                | 1.0000  | 5          | 1.00  | 0106  | 1.150     |                  | 1.0000             | 202,795.6  | 202,800    |
| 1                           | 1010     | Single Fam M-0 | RF-1 | 1  | 0.010      | AC 14,250.00  | 1.00000                | 1.0000  | 0          | 1.00  | 0106  | 1.150     |                  | 1.0000             | 16,387.5   | 200        |
| Total Card Land Units       |          |                |      |    | 1.01       | AC            | Parcel Total Land Area |         |            |       |       | 1.01      | Total Land Value |                    |            | 203,000    |

| CONSTRUCTION DETAIL      |    |                | CONSTRUCTION DETAIL (CONTINUED) |         |             |
|--------------------------|----|----------------|---------------------------------|---------|-------------|
| Element                  | Cd | Description    | Element                         | Cd      | Description |
| Style                    | 01 | Ranch          |                                 |         |             |
| Model                    | 01 | Residential    |                                 |         |             |
| Grade:                   | C  | Average        |                                 |         |             |
| Stories                  | 1  | 1 Story        |                                 |         |             |
| Exterior Wall 1          | 14 | Wood Shingle   |                                 |         |             |
| Exterior Wall 2          | 11 | Clapboard      |                                 |         |             |
| RooF Structure           | 03 | Gable/Hip      |                                 |         |             |
| RooF Cover               | 03 | Asph/F Gls/Cmp |                                 |         |             |
| Interior Wall 1          | 05 | Drywall        |                                 |         |             |
| Interior Wall 2          |    |                |                                 |         |             |
| Interior Floor 1         | 12 | Hardwood       |                                 |         |             |
| Interior Floor 2         | 14 | Carpet         |                                 |         |             |
| Heat Fuel                | 03 | Gas            |                                 |         |             |
| Heat Type                | 05 | Hot Water      |                                 |         |             |
| AC Type                  | 01 | None           |                                 |         |             |
| Bedrooms                 | 03 | 3 Bedrooms     |                                 |         |             |
| Full Baths               | 2  |                |                                 |         |             |
| Half Baths               | 0  |                |                                 |         |             |
| Extra Fixtures           |    |                |                                 |         |             |
| Total Rooms              | 6  |                |                                 |         |             |
| Bath Style               |    |                |                                 |         |             |
| Kitchen Style            |    |                |                                 |         |             |
| Occupancy                |    |                |                                 |         |             |
| Usrflid 105              |    |                |                                 |         |             |
| Accessory Apt            |    |                |                                 |         |             |
| Foundation Alt           | 08 | Mixed          |                                 |         |             |
| Rms Prts                 |    |                |                                 |         |             |
| Bath Split               | 20 | 2 Full-0 Half  |                                 |         |             |
|                          |    |                | <b>CONDO DATA</b>               |         |             |
| Parcel Id                |    |                | C                               | Owne    | 0.0         |
| Adjust Type              |    | Code           | Description                     | Factor% |             |
| Condo Flr                |    |                |                                 |         |             |
| Condo Unit               |    |                |                                 |         |             |
|                          |    |                | <b>COST / MARKET VALUATION</b>  |         |             |
| Building Value New       |    |                |                                 | 481,735 |             |
| Year Built               |    |                |                                 | 1977    |             |
| Effective Year Built     |    |                |                                 | 1999    |             |
| Depreciation Code        |    |                |                                 | G       |             |
| Remodel Rating           |    |                |                                 |         |             |
| Year Remodeled           |    |                |                                 |         |             |
| Depreciation %           |    |                |                                 | 16      |             |
| Functional Obsol         |    |                |                                 | 0       |             |
| External Obsol           |    |                |                                 | 0       |             |
| Trend Factor             |    |                |                                 | 1       |             |
| Condition                |    |                |                                 |         |             |
| Condition %              |    |                |                                 |         |             |
| Percent Good             |    |                |                                 | 84      |             |
| RCNLD                    |    |                |                                 | 404,700 |             |
| Dep % Ovr                |    |                |                                 |         |             |
| Dep Ovr Comment          |    |                |                                 |         |             |
| Misc Imp Ovr             |    |                |                                 |         |             |
| Misc Imp Ovr Comment     |    |                |                                 |         |             |
| Cost to Cure Ovr         |    |                |                                 |         |             |
| Cost to Cure Ovr Comment |    |                |                                 |         |             |

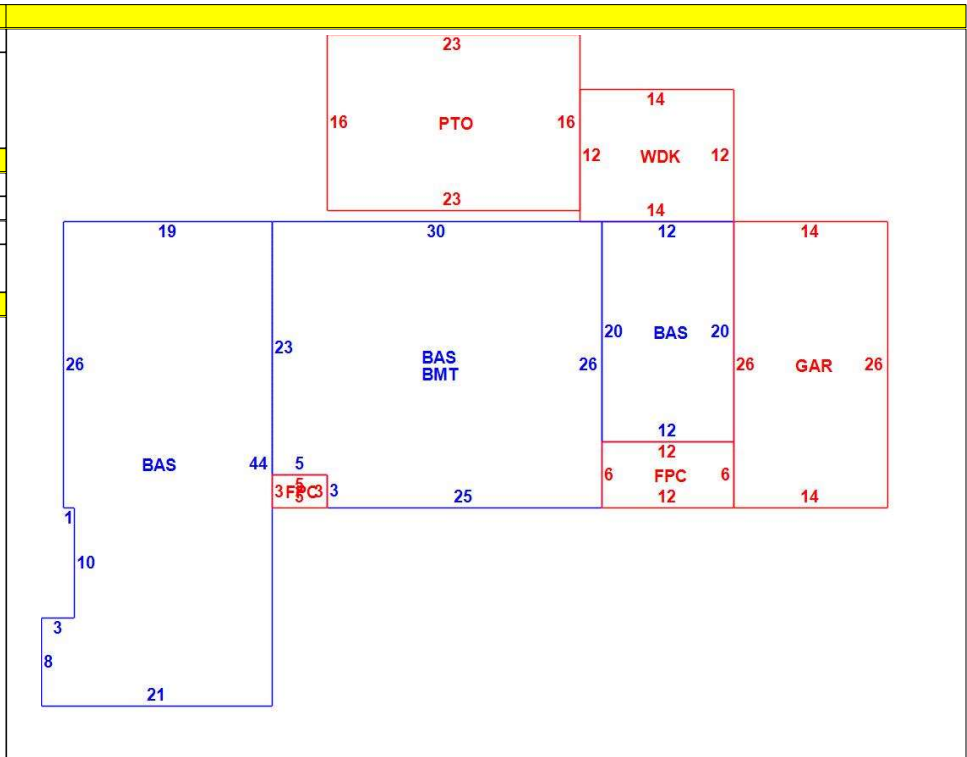

**OB - OUTBUILDING & YARD ITEMS(L) / XF - BUILDING EXTRA FEATURES(B)**

| Code | Description     | L/B | Units | Unit Price | Yr Blt | Cond. Cd | % Gd | Grade | Grade Adj. | Appr. Value |
|------|-----------------|-----|-------|------------|--------|----------|------|-------|------------|-------------|
| FPL1 | Fireplace 1 sto | B   | 1     | 5000.00    | 2001   |          | 84   |       | 0.00       | 4,200       |
| FPO  | Ext FP Openin   | B   | 1     | 2000.00    | 2001   |          | 84   |       | 0.00       | 1,700       |
| FOPC | Open Prch-roo   | B   | 87    | 55.00      | 2001   |          | 84   |       | 0.00       | 3,500       |
| GAR  | Attached Gara   | B   | 364   | 40.00      | 2001   |          | 84   |       | 0.00       | 12,700      |
| BMT  | Basement-Unfi   | B   | 765   | 26.01      | 2001   |          | 84   |       | 0.00       | 18,600      |
| WDC  | Wood Deck w/    | L   | 168   | 18.00      | 2011   |          | 84   |       | 0.00       | 3,300       |
| PAT2 | Patio-Good      | L   | 368   | 9.94       | 1990   |          | 71   |       | 0.00       | 2,600       |
| PAT2 | Patio-Good      | L   | 48    | 9.94       | 2020   |          | 100  |       | 0.00       | 600         |
| FPIT | Fire Pit        | L   | 1     | 3010.00    | 2020   |          | 100  | C     | 1.00       | 3,000       |
| SHED | Shed            | L   | 96    | 18.00      | 2012   |          | 86   |       | 0.00       | 1,500       |

**BUILDING SUB-AREA SUMMARY SECTION**

| Code                       | Description            | Living Area | Floor Area | Eff Area | Unit Cost | Undeprec Value |
|----------------------------|------------------------|-------------|------------|----------|-----------|----------------|
| BAS                        | First Floor            | 1,847       | 1,847      | 1,847    | 260.82    | 481,735        |
| BMT                        | Basement Area          | 0           | 765        | 0        | 0.00      | 0              |
| FPC                        | Open Porch Conc. Floor | 0           | 87         | 0        | 0.00      | 0              |
| GAR                        | Attached Garage        | 0           | 364        | 0        | 0.00      | 0              |
| PTO                        | Patio                  | 0           | 368        | 0        | 0.00      | 0              |
| WDK                        | Wood Deck              | 0           | 168        | 0        | 0.00      | 0              |
| Ttl Gross Liv / Lease Area |                        | 1,847       | 3,599      | 1,847    |           | 481,735        |

