

| CURRENT OWNER | | TOPO | UTILITIES | STRT / ROAD | LOCATION | CURRENT ASSESSMENT | | | | 801 FY2024 BARNSTABLE, MA VISION |
|--|--|---------|----------------|--|----------|--------------------|------|----------|----------|--|
| ABBATINOZZI, MARIE C P O BOX 414 COTUIT MA 02635 | | 1 Level | 2 Public Water | 1 Paved | | Description | Code | Assessed | Assessed | |
| | | | 4 Gas | | | RESIDNTL | 1010 | 337,900 | 337,900 | |
| | | | 6 Septic | | | RES LAND | 1010 | 159,600 | 159,600 | |
| SUPPLEMENTAL DATA | | | | | | Total | | | | 497,500 |
| Alt Prcl ID Split Zonin BID Parcel ResExpt Q YES: #DL 1 LOT 54 #DL 2 GIS ID F_946823_2697179 | | | | Plan Ref. 282/27 Land Ct# #SR Life Estate PP STATU Assoc Pid# | | | | | | |

| RECORD OF OWNERSHIP | | BK-VOL/PAGE | SALE DATE | Q/U | V/I | SALE PRIC | VC | PREVIOUS ASSESSMENTS (HISTORY) | | | | | | | | |
|----------------------------------|--|-------------|------------|-----|-----|-----------|----|--------------------------------|------|----------|-------|------|----------|-------|------|----------|
| ABBATINOZZI, MARIE C | | 10284 0193 | 07-02-1996 | Q | I | 104,000 | U | Year | Code | Assessed | Year | Code | Assessed | Year | Code | Assessed |
| DAVIS, SUZANNE F | | 7493 0326 | 04-15-1991 | U | I | 1 | A | 2023 | 1010 | 292,900 | 2022 | 1010 | 254,900 | 2021 | 1010 | 209,400 |
| DAVIS, NELSON M & SUZANNE F | | 4548 0062 | 05-15-1985 | Q | I | 85,000 | U | | 1010 | 145,100 | | 1010 | 107,500 | | 1010 | 107,500 |
| THEOHARIDIS, DEON | | 4492 0247 | 04-15-1985 | U | I | 1 | A | | | | | | | | 1010 | 2,600 |
| THEOHARIDIS, SPERO & MAGDALENE T | | 3565 0199 | 09-15-1982 | U | V | 0 | | Total | | 438,000 | Total | | 362,400 | Total | | 319,500 |

| EXEMPTIONS | | | | OTHER ASSESSMENTS | | | | This signature acknowledges a visit by a Data Collector or Assessor | | | | | | | | |
|------------|------|-----------------------|--------|-------------------|-------------|--------|--------|---|--|--|--|--|--|--|--|--|
| Year | Code | Description | Amount | Code | Description | Number | Amount | Comm Int | | | | | | | | |
| 2011 | 5C | RESIDENTIAL EXEMPTION | 0.00 | | | | | | | | | | | | | |
| Total | | | 0.00 | | | | | | | | | | | | | |

| ASSESSING NEIGHBORHOOD | | | | APPRAISED VALUE SUMMARY | | | |
|------------------------|-----------|---|---------|-------------------------|--|--|--|
| Nbhd | Nbhd Name | B | Tracing | Batch | | | |
| 0105 | | | COTUIT | | | | |

| NOTES | | | | | | | | | | APPRAISED VALUE SUMMARY | | | | | | |
|-------|--|--|--|--|--|--|--|--|--|-------------------------------|--|--|--|--|--|---------|
| | | | | | | | | | | Appraised Bldg. Value (Card) | | | | | | 282,900 |
| | | | | | | | | | | Appraised Xf (B) Value (Bldg) | | | | | | 51,800 |
| | | | | | | | | | | Appraised Ob (B) Value (Bldg) | | | | | | 3,200 |
| | | | | | | | | | | Appraised Land Value (Bldg) | | | | | | 159,600 |
| | | | | | | | | | | Special Land Value | | | | | | 0 |
| | | | | | | | | | | Total Appraised Parcel Value | | | | | | 497,500 |
| | | | | | | | | | | Valuation Method | | | | | | C |
| | | | | | | | | | | Total Appraised Parcel Value | | | | | | 497,500 |

| BUILDING PERMIT RECORD | | | | | | | | | VISIT / CHANGE HISTORY | | | | | |
|------------------------|------------|------|-------------|--------|------------|--------|------------|------------------------|------------------------|----|------|----|----|----------------------------|
| Permit Id | Issue Date | Type | Description | Amount | Insp Date | % Comp | Date Comp | Comments | Date | Id | Type | Is | Cd | Purpost/Result |
| 201203806 | 07-03-2012 | AD | Addition | 40,000 | 06-30-2013 | 100 | 06-30-2013 | 3 SEASON RM-NOT HEATED | 07-31-2021 | BM | 02 | | 03 | Cycl Insp Comp |
| 200805510 | 10-02-2008 | NR | New Roof | 10,420 | 06-30-2009 | 100 | 06-30-2009 | REROOF STRIPPING OLD | 06-11-2020 | WD | | | FR | Field Review |
| B26458 | 05-01-1984 | DW | Dwelling | 0 | 04-15-1985 | 100 | 06-30-1985 | CO 1 ST | 09-24-2013 | RB | 03 | | 03 | Cycl Insp Comp |
| | | | | | | | | | 07-11-2005 | PT | 02 | | 01 | Meas/Est |
| | | | | | | | | | 07-17-1999 | FS | 01 | | 00 | Meas/Listed-Interior Acces |
| | | | | | | | | | 04-15-1985 | FR | | | | |

| LAND LINE VALUATION SECTION | | | | | | | | | | | | | | | | |
|-----------------------------|----------|----------------|------|----|------------|------------|------------------------|---------|------------|-------|-------|-----------|------------------|--------------------|------------|------------|
| B | Use Code | Description | Zone | LA | Land Units | Unit Price | Size Adj | AC Disc | Site Index | Cond. | Nbhd. | Nbhd. Adj | Notes | Location Adjustmen | Adj Unit P | Land Value |
| 1 | 1010 | Single Fam M-0 | RF | 2 | 0.530 AC | 176,344.00 | 1.70777 | 1.0000 | 5 | 1.00 | 0105 | 1.000 | ABUTS ROUTE 28 | | 1.0000 | 301,160.2 |
| Total Card Land Units | | | | | 0.53 | AC | Parcel Total Land Area | | | | | 0.53 | Total Land Value | | | 159,600 |

| CONSTRUCTION DETAIL | | | CONSTRUCTION DETAIL (CONTINUED) | | |
|---------------------|----|----------------|---------------------------------|----|-------------|
| Element | Cd | Description | Element | Cd | Description |
| Style | 01 | Ranch | | | |
| Model | 01 | Residential | | | |
| Grade: | C | Average | | | |
| Stories | 1 | 1 Story | | | |
| Exterior Wall 1 | 12 | Cedar or Redwd | | | |
| Exterior Wall 2 | | | | | |
| Roof Structure | 03 | Gable/Hip | | | |
| Roof Cover | 03 | Asph/F Gls/Cmp | | | |
| Interior Wall 1 | 05 | Drywall | | | |
| Interior Wall 2 | | | | | |
| Interior Floor 1 | 14 | Carpet | | | |
| Interior Floor 2 | | | | | |
| Heat Fuel | 03 | Gas | | | |
| Heat Type | 05 | Hot Water | | | |
| AC Type | 03 | Central | | | |
| Bedrooms | 03 | 3 Bedrooms | | | |
| Full Baths | 1 | | | | |
| Half Baths | 1 | | | | |
| Extra Fixtures | | | | | |
| Total Rooms | 5 | 5 Rooms | | | |
| Bath Style | | | | | |
| Kitchen Style | | | | | |
| Occupancy | | | | | |
| Usrflid 105 | | | | | |
| Accessory Apt | | | | | |
| Foundation Alt | 01 | Poured Conc. | | | |
| Rms Prts | | | | | |
| Bath Split | 11 | 1 Full-1 Half | | | |

| CONDO DATA | | | |
|-------------|------|-------------|----------|
| Parcel Id | | C | Ownr 0.0 |
| | | B | S |
| Adjust Type | Code | Description | Factor% |
| Condo Flr | | | |
| Condo Unit | | | |

| COST / MARKET VALUATION | |
|--------------------------|---------|
| Building Value New | 336,753 |
| Year Built | 1984 |
| Effective Year Built | 1998 |
| Depreciation Code | A |
| Remodel Rating | |
| Year Remodeled | |
| Depreciation % | 16 |
| Functional Obsol | 0 |
| External Obsol | 0 |
| Trend Factor | 1 |
| Condition | |
| Condition % | |
| Percent Good | 84 |
| RCNLD | 282,900 |
| Dep % Ovr | |
| Dep Ovr Comment | |
| Misc Imp Ovr | |
| Misc Imp Ovr Comment | |
| Cost to Cure Ovr | |
| Cost to Cure Ovr Comment | |

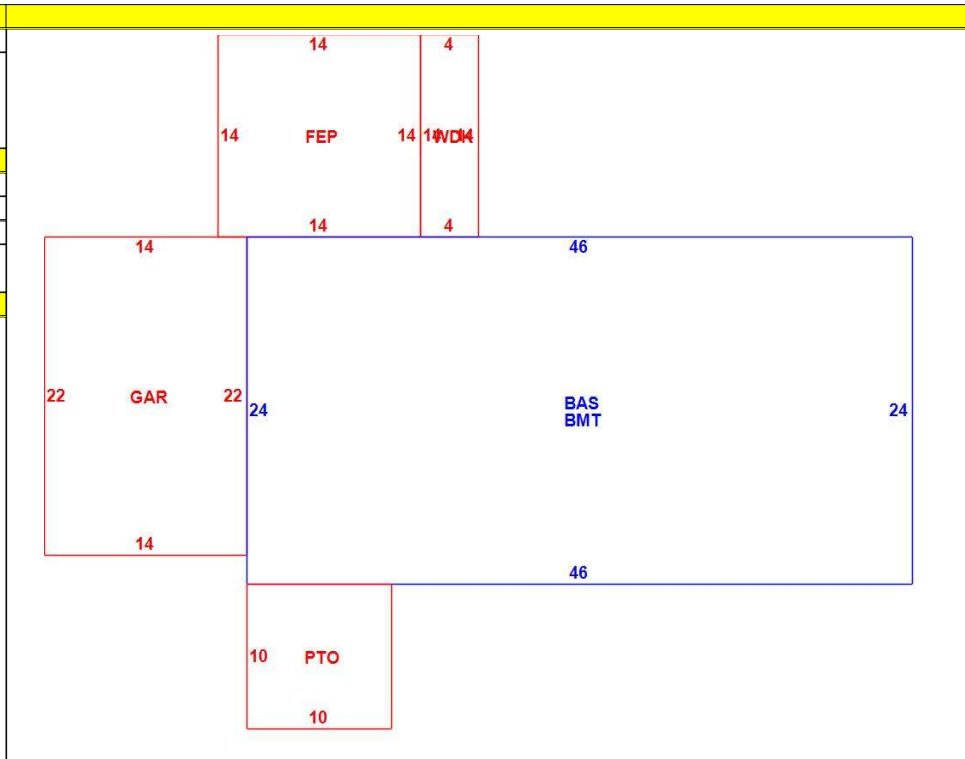

| OB - OUTBUILDING & YARD ITEMS(L) / XF - BUILDING EXTRA FEATURES(B) | | | | | | | | | | |
|--|-----------------|-----|-------|------------|--------|----------|------|-------|------------|-------------|
| Code | Description | L/B | Units | Unit Price | Yr Blt | Cond. Cd | % Gd | Grade | Grade Adj. | Appr. Value |
| FPL1 | Fireplace 1 sto | B | 1 | 5000.00 | 2000 | | 84 | | 0.00 | 4,200 |
| BRR | Bsmt Rec Rm- | B | 300 | 8.05 | 2000 | | 84 | | 0.00 | 2,000 |
| WDC | Wood Decking | L | 56 | 20.00 | 2012 | | 86 | | 0.00 | 2,600 |
| GAR | Attached Gara | B | 308 | 40.00 | 2000 | | 84 | | 0.00 | 11,400 |
| BMT | Basement-Unfi | B | 1,104 | 26.01 | 2000 | | 84 | | 0.00 | 23,800 |
| FEP | Enclosed porc | B | 196 | 70.00 | 2000 | | 84 | | 0.00 | 10,400 |
| PAT1 | Patio- Average | L | 100 | 5.89 | 2000 | | 81 | | 0.00 | 600 |

| BUILDING SUB-AREA SUMMARY SECTION | | | | | | |
|-----------------------------------|-----------------|-------------|------------|----------|-----------|----------------|
| Code | Description | Living Area | Floor Area | Eff Area | Unit Cost | Undeprec Value |
| BAS | First Floor | 1,104 | 1,104 | 1,104 | 305.03 | 336,753 |
| BMT | Basement Area | 0 | 1,104 | 0 | 0.00 | 0 |
| FEP | Enclosed Porch | 0 | 196 | 0 | 0.00 | 0 |
| GAR | Attached Garage | 0 | 308 | 0 | 0.00 | 0 |
| PTO | Patio | 0 | 100 | 0 | 0.00 | 0 |
| WDC | Wood Deck | 0 | 56 | 0 | 0.00 | 0 |
| Ttl Gross Liv / Lease Area | | 1,104 | 2,868 | 1,104 | | 336,753 |

