

| CURRENT OWNER  |  | TOPO    | UTILITIES    | STRT / ROAD  | LOCATION | CURRENT ASSESSMENT |         |          |          | 801<br>FY2024<br>BARNSTABLE, MA<br><br><b>VISION</b> |
|--|--|---------|--------------|--|----------|--------------------|---------|----------|----------|--|
| REID, STACY ANN  |  | 1 Level | 1 All Public | 1 Paved  |          | Description        | Code    | Assessed | Assessed |  |
| 19 BROOKSHIRE ROAD   |  |         |              |  | RESIDNTL | 1010               | 238,000 | 238,000  |          |  |
| HYANNIS MA 02601   |  |         |              |  | RES LAND | 1010               | 127,800 | 127,800  |          |  |
| <b>SUPPLEMENTAL DATA</b>   |  |         |              |  |          | Total              |         |          |          | 365,800  |
| Alt Prcl ID<br>Split Zonin<br>BID Parcel<br>ResExpt Q YES:<br>#DL 1 LOT 19<br>#DL 2<br>GIS ID F_988941_2703986 |  |         |              | Plan Ref. 85/101<br>Land Ct#<br>#SR<br>Life Estate<br>PP STATU<br>Assoc Pid# |          |                    |         |          |          |  |

| RECORD OF OWNERSHIP       |  | BK-VOL/PAGE | SALE DATE  | Q/U | V/I | SALE PRIC | VC | PREVIOUS ASSESSMENTS (HISTORY) |      |          |       |         |          |         |
|---------------------------|--|-------------|------------|-----|-----|-----------|----|--------------------------------|------|----------|-------|---------|----------|---------|
| REID, STACY ANN           |  | 34405 201   | 08-23-2021 | Q   | I   | 385,000   | 00 | Year                           | Code | Assessed | Year  | Code    | Assessed |         |
| GAZOLLA, RODOLPHO RIBEIRO |  | 32418 0059  | 10-28-2019 | Q   | I   | 240,000   | 00 | 2023                           | 1010 | 210,400  | 2022  | 1010    | 175,700  |         |
| DING, LE                  |  | 31664 0169  | 11-15-2018 | U   | I   | 1         | 1F |                                | 1010 | 122,600  |       | 1010    | 90,800   |         |
| GAO, BAO FENG             |  | 21189 0095  | 07-17-2006 | Q   | I   | 288,750   | 00 |                                |      |          |       | 1010    | 1,600    |         |
| FARIA, JOSE F & LUCINDA R |  | 11064 0188  | 11-17-1997 | U   | I   | 0         | 1A | Total                          |      | 333,000  | Total | 266,500 | Total    | 237,300 |

| EXEMPTIONS |      | OTHER ASSESSMENTS     |        |      |             |        |        |          |
|------------|------|-----------------------|--------|------|-------------|--------|--------|----------|
| Year       | Code | Description           | Amount | Code | Description | Number | Amount | Comm Int |
| 2023       | 5C   | RESIDENTIAL EXEMPTION |        |      |             |        |        |          |
| Total      |      |                       | 0.00   |      |             |        |        |          |

| ASSESSING NEIGHBORHOOD |           |   |            |
|------------------------|-----------|---|------------|
| Nbhd                   | Nbhd Name | B | Tracing    |
| 0104                   |           |   | Batch HYAN |

| NOTES   |  |  |         |
|---|--|--|---------|
| This signature acknowledges a visit by a Data Collector or Assessor |  |  |         |
| <b>APPRAISED VALUE SUMMARY</b>                                      |  |  |         |
| Appraised Bldg. Value (Card)  |  |  | 218,100 |
| Appraised Xf (B) Value (Bldg)                                       |  |  | 18,300  |
| Appraised Ob (B) Value (Bldg)                                       |  |  | 1,600   |
| Appraised Land Value (Bldg)   |  |  | 127,800 |
| Special Land Value  |  |  | 0       |
| Total Appraised Parcel Value  |  |  | 365,800 |
| Valuation Method  |  |  | C       |
| Total Appraised Parcel Value  |  |  | 365,800 |

| BUILDING PERMIT RECORD |            |      |                |        |           |        |            | VISIT / CHANGE HISTORY         |            |     |      |    |    |                            |
|------------------------|------------|------|----------------|--------|-----------|--------|------------|--------------------------------|------------|-----|------|----|----|----------------------------|
| Permit Id              | Issue Date | Type | Description    | Amount | Insp Date | % Comp | Date Comp  | Comments                       | Date       | Id  | Type | Is | Cd | Purpost/Result             |
| 20-462                 | 02-28-2020 | 839  | Solar Panel-Re | 3,520  |           | 0      | 08-28-2020 | EXPIRED Installation of roof m | 08-24-2022 | LH  | 03   |    | 22 | Change of Address          |
|                        |            |      |                |        |           |        |            |                                | 08-05-2022 | EG  | 03   |    | 16 | In Office Review           |
|                        |            |      |                |        |           |        |            |                                | 05-12-2020 | WD  |      |    | FR | Field Review               |
|                        |            |      |                |        |           |        |            |                                | 03-03-2020 | SAF |      |    | 20 | Sale Review                |
|                        |            |      |                |        |           |        |            |                                | 11-03-2017 | SR  | 02   |    | 03 | Cycl Insp Comp             |
|                        |            |      |                |        |           |        |            |                                | 03-27-2001 | PT  | 01   |    | 00 | Meas/Listed-Interior Acces |

| LAND LINE VALUATION SECTION |          |                |      |    |            |            |                        |         |            |       |       |           |                  |                    |            |            |
|-----------------------------|----------|----------------|------|----|------------|------------|------------------------|---------|------------|-------|-------|-----------|------------------|--------------------|------------|------------|
| B                           | Use Code | Description    | Zone | LA | Land Units | Unit Price | Size Adj               | AC Disc | Site Index | Cond. | Nbhd. | Nbhd. Adj | Notes            | Location Adjustmen | Adj Unit P | Land Value |
| 1                           | 1010     | Single Fam M-0 | DN   | 4  | 0.190 AC   | 176,344.00 | 4.23746                | 1.0000  | 5          | 1.00  | 0104  | 0.900     |                  |                    | 1.0000     | 672,523.1  |
| Total Card Land Units       |          |                |      |    | 0.19       | AC         | Parcel Total Land Area |         |            |       |       | 0.19      | Total Land Value |                    |            | 127,800    |

| CONSTRUCTION DETAIL |     |                | CONSTRUCTION DETAIL (CONTINUED) |    |             |
|---------------------|-----|----------------|---------------------------------|----|-------------|
| Element             | Cd  | Description    | Element                         | Cd | Description |
| Style               | 04  | Cape Cod       |                                 |    |             |
| Model               | 01  | Residential    |                                 |    |             |
| Grade:              | C   | Average        |                                 |    |             |
| Stories             | 1.5 | 1 1/2 Stories  |                                 |    |             |
| Exterior Wall 1     | 14  | Wood Shingle   |                                 |    |             |
| Exterior Wall 2     |     |                |                                 |    |             |
| Roof Structure      | 03  | Gable/Hip      |                                 |    |             |
| Roof Cover          | 03  | Asph/F Gls/Cmp |                                 |    |             |
| Interior Wall 1     | 05  | Drywall        |                                 |    |             |
| Interior Wall 2     |     |                |                                 |    |             |
| Interior Floor 1    | 14  | Carpet         |                                 |    |             |
| Interior Floor 2    |     |                |                                 |    |             |
| Heat Fuel           | 03  | Gas            |                                 |    |             |
| Heat Type           | 04  | Hot Air        |                                 |    |             |
| AC Type             | 01  | None           |                                 |    |             |
| Bedrooms            | 04  | 4 Bedrooms     |                                 |    |             |
| Full Baths          | 1   |                |                                 |    |             |
| Half Baths          | 0   |                |                                 |    |             |
| Extra Fixtures      |     |                |                                 |    |             |
| Total Rooms         | 6   | 6 Rooms        |                                 |    |             |
| Bath Style          |     |                |                                 |    |             |
| Kitchen Style       |     |                |                                 |    |             |
| Occupancy           |     |                |                                 |    |             |
| Usrflid 105         |     |                |                                 |    |             |
| Accessory Apt       |     |                |                                 |    |             |
| Foundation Alt      | 02  | Conc. Block    |                                 |    |             |
| Rms Prts            |     |                |                                 |    |             |
| Bath Split          | 10  | 1 Full-0 Half  |                                 |    |             |

| CONDO DATA  |      |             |          |
|-------------|------|-------------|----------|
| Parcel Id   |      | C           | Owne 0.0 |
|             |      | B           | S        |
| Adjust Type | Code | Description | Factor%  |
| Condo Flr   |      |             |          |
| Condo Unit  |      |             |          |

| COST / MARKET VALUATION  |         |
|--------------------------|---------|
| Building Value New       | 325,516 |
| Year Built               | 1950    |
| Effective Year Built     | 1976    |
| Depreciation Code        | F       |
| Remodel Rating           |         |
| Year Remodeled           |         |
| Depreciation %           | 33      |
| Functional Obsol         | 0       |
| External Obsol           | 0       |
| Trend Factor             | 1       |
| Condition                |         |
| Condition %              |         |
| Percent Good             | 67      |
| RCNLD                    | 218,100 |
| Dep % Ovr                |         |
| Dep Ovr Comment          |         |
| Misc Imp Ovr             |         |
| Misc Imp Ovr Comment     |         |
| Cost to Cure Ovr         |         |
| Cost to Cure Ovr Comment |         |

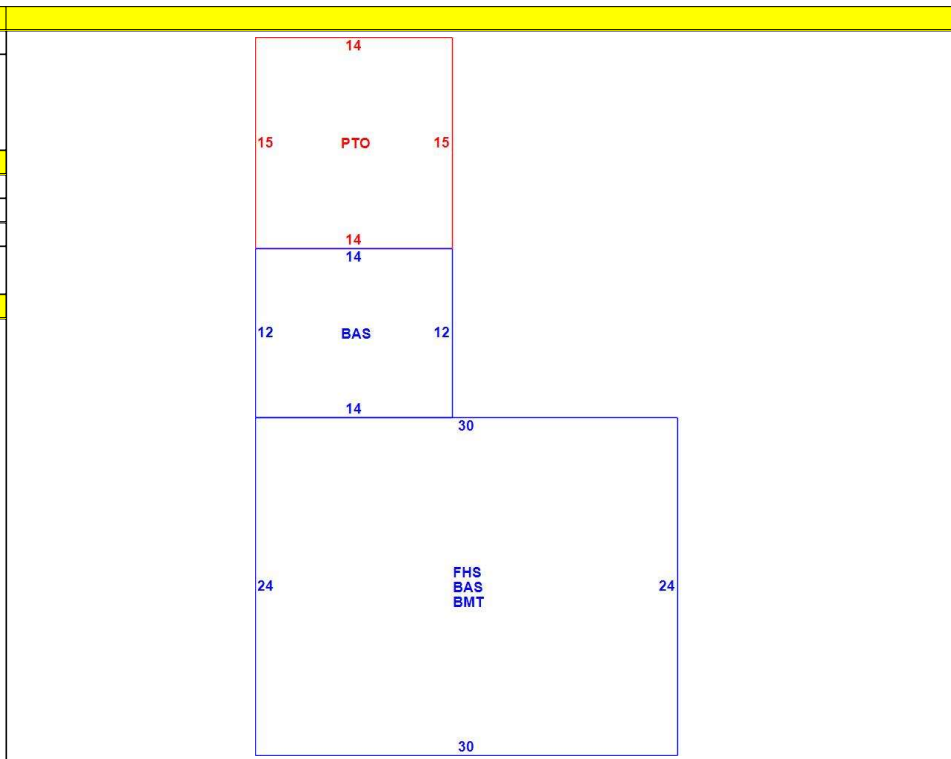

| OB - OUTBUILDING & YARD ITEMS(L) / XF - BUILDING EXTRA FEATURES(B) |                 |     |       |            |        |          |      |       |            |             |
|--|-----------------|-----|-------|------------|--------|----------|------|-------|------------|-------------|
| Code   | Description     | L/B | Units | Unit Price | Yr Blt | Cond. Cd | % Gd | Grade | Grade Adj. | Appr. Value |
| FPL2   | Fireplace 1.5 s | B   | 1     | 6000.00    | 1978   |          | 67   |       | 0.00       | 4,000       |
| PAT2   | Patio-Good      | L   | 210   | 9.94       | 1990   |          | 71   |       | 0.00       | 1,600       |
| BMT  | Basement-Unfi   | B   | 720   | 26.01      | 1978   |          | 67   |       | 0.00       | 14,300      |

| BUILDING SUB-AREA SUMMARY SECTION |               |             |            |          |           |                |
|-----------------------------------|---------------|-------------|------------|----------|-----------|----------------|
| Code                              | Description   | Living Area | Floor Area | Eff Area | Unit Cost | Undeprec Value |
| BAS                               | First Floor   | 888         | 888        | 888      | 260.83    | 231,617        |
| BMT                               | Basement Area | 0           | 720        | 0        | 0.00      | 0              |
| FHS                               | Half Story    | 360         | 720        | 360      | 130.42    | 93,899         |
| PTO                               | Patio         | 0           | 210        | 0        | 0.00      | 0              |
| Ttl Gross Liv / Lease Area        |               | 1,248       | 2,538      | 1,248    |           | 325,516        |

