

| CURRENT OWNER  |  | TOPO    | UTILITIES    | STRT / ROAD  | LOCATION | CURRENT ASSESSMENT |      |          |          |
|--|--|---------|--------------|--|----------|--------------------|------|----------|----------|
| MAHONEY, RICHARD G & MAUREEN   |  | 1 Level | 1 All Public | 1 Paved  |          | Description        | Code | Assessed | Assessed |
| PO BOX 242   |  |         |              |  |          | RESIDNTL           | 1010 | 281,800  | 281,800  |
| WEST BARNSTA MA 02668  |  |         |              |  |          | RES LAND           | 1010 | 129,900  | 129,900  |
| SUPPLEMENTAL DATA  |  |         |              |  |          |                    |      |          |          |
| Alt Prcl ID<br>Split Zonin<br>BID Parcel<br>ResExpt Q<br>#DL 1 LOT B<br>#DL 2<br>GIS ID F_990611_2703312 |  |         |              | Plan Ref. 78/3<br>Land Ct#<br>#SR<br>Life Estate<br>PP STATU<br>Assoc Pid# |          | Total              |      | 411,700  | 411,700  |

801  
 FY2024  
 BARNSTABLE, MA

**VISION**

| RECORD OF OWNERSHIP            |  | BK-VOL/PAGE | SALE DATE | Q/U        | V/I | SALE PRIC | VC      | PREVIOUS ASSESSMENTS (HISTORY) |      |      |          |      |      |          |
|--------------------------------|--|-------------|-----------|------------|-----|-----------|---------|--------------------------------|------|------|----------|------|------|----------|
| MAHONEY, RICHARD G & MAUREEN J |  | 27072       | 0337      | 01-25-2013 | Q   | I         | 142,500 | 00                             | Year | Code | Assessed | Year | Code | Assessed |
| SIGEL, ERIC J TR               |  | 15009       | 0047      | 04-03-2002 | U   | I         | 1       | 1A                             | 2023 | 1010 | 236,800  | 2022 | 1010 | 192,900  |
| SIGEL, ERIC J & RONDA          |  | 13835       | 0213      | 05-16-2001 | U   | I         | 125,000 | 1                              |      | 1010 | 124,700  |      | 1010 | 92,300   |
| HOULE, ALFRED A EXECUTOR       |  | P0146EP     | 0         | 05-15-2001 | U   | I         | 0       | 1A                             |      |      |          |      |      |          |
| HOULE, ALFRED J                |  | 2811        | 0272      | 11-01-1978 | U   |           | 0       | 1A                             |      |      |          |      |      |          |
| Total                          |  |             |           |            |     |           |         |                                |      |      | 361,500  |      |      | 285,200  |
|                                |  |             |           |            |     |           |         |                                |      |      |          |      |      | 205,300  |

| EXEMPTIONS |      |             |        | OTHER ASSESSMENTS |             |        |        |
|------------|------|-------------|--------|-------------------|-------------|--------|--------|
| Year       | Code | Description | Amount | Code              | Description | Number | Amount |
|            |      |             |        |                   |             |        |        |
| Total      |      |             | 0.00   |                   |             |        |        |

This signature acknowledges a visit by a Data Collector or Assessor

| ASSESSING NEIGHBORHOOD |           |   |         |
|------------------------|-----------|---|---------|
| Nbhd                   | Nbhd Name | B | Tracing |
| 0104                   |           |   | HYAN    |

| NOTES |  |  |  |
|-------|--|--|--|
|       |  |  |  |

| APPRAISED VALUE SUMMARY       |         |
|-------------------------------|---------|
| Appraised Bldg. Value (Card)  | 278,000 |
| Appraised Xf (B) Value (Bldg) | 3,800   |
| Appraised Ob (B) Value (Bldg) | 0       |
| Appraised Land Value (Bldg)   | 129,900 |
| Special Land Value            | 0       |
| Total Appraised Parcel Value  | 411,700 |
| Valuation Method              | C       |
| Total Appraised Parcel Value  | 411,700 |

| BUILDING PERMIT RECORD |            |      |                |        |            |        |            |  | VISIT / CHANGE HISTORY |    |      |    |    |                       |
|------------------------|------------|------|----------------|--------|------------|--------|------------|--|------------------------|----|------|----|----|-----------------------|
| Permit Id              | Issue Date | Type | Description    | Amount | Insp Date  | % Comp | Date Comp  | Comments                               | Date                   | Id | Type | Is | Cd | Purpost/Result        |
| 20-1391                | 07-28-2020 | 803  | Addn Alt-Comm  | 40,000 | 06-09-2021 | 100    | 06-30-2021 | Expanding office space with an re-roof | 06-09-2021             | SR | 02   |    | 02 | Bldg Permit Completed |
| 19-3565                | 10-23-2019 | 835  | Sid/Wind/Roof/ | 5,000  | 06-30-2020 | 100    | 06-30-2020 |  | 09-04-2020             | RB | 03   |    | 16 | In Office Review      |
| 53448                  | 06-13-2001 | NR   | New Roof       | 2,900  | 01-01-2002 | 100    | 12-31-2002 |  | 05-13-2020             | WD |      |    |    | FR                    |
|                        |            |      |                |        |            |        |            |  | 11-17-2017             | KM | 02   |    | 03 | Cycl Insp Comp        |
|                        |            |      |                |        |            |        |            |  | 08-28-2015             | NF | 03   |    | 16 | In Office Review      |
|                        |            |      |                |        |            |        |            |  | 07-30-2013             | DR | 22   |    | 22 | Change of Address     |
|                        |            |      |                |        |            |        |            |  | 03-08-2011             | TP | 03   |    | 15 | Abatement Review      |

| LAND LINE VALUATION SECTION |          |                |      |    |            |            |                        |         |            |       |       |           |                  |                    |            |            |         |
|-----------------------------|----------|----------------|------|----|------------|------------|------------------------|---------|------------|-------|-------|-----------|------------------|--------------------|------------|------------|---------|
| B                           | Use Code | Description    | Zone | LA | Land Units | Unit Price | Size Adj               | AC Disc | Site Index | Cond. | Nbhd. | Nbhd. Adj | Notes            | Location Adjustmen | Adj Unit P | Land Value |         |
| 1                           | 1010     | Single Fam M-0 | HC   | 4  | 0.210      | AC         | 176,344.00             | 3.89789 | 1.0000     | 5     | 1.00  | 0104      | 0.900            |                    | 1.0000     | 618,632.3  | 129,900 |
| Total Card Land Units       |          |                |      |    | 0.21       | AC         | Parcel Total Land Area |         |            |       |       | 0.21      | Total Land Value |                    |            | 129,900    |         |

| CONSTRUCTION DETAIL |     |                | CONSTRUCTION DETAIL (CONTINUED) |    |             |
|---------------------|-----|----------------|---------------------------------|----|-------------|
| Element             | Cd  | Description    | Element                         | Cd | Description |
| Style               | 06  | Conventional   |                                 |    |             |
| Model               | 01  | Residential    |                                 |    |             |
| Grade:              | C   | Average        |                                 |    |             |
| Stories             | 1.5 | 1 1/2 Stories  |                                 |    |             |
| Exterior Wall 1     | 26  | Aluminum Sidng |                                 |    |             |
| Exterior Wall 2     |     |                |                                 |    |             |
| Roof Structure      | 03  | Gable/Hip      |                                 |    |             |
| Roof Cover          | 03  | Asph/F Gls/Cmp |                                 |    |             |
| Interior Wall 1     | 05  | Drywall        |                                 |    |             |
| Interior Wall 2     |     |                |                                 |    |             |
| Interior Floor 1    | 09  | Pine/Soft Wood |                                 |    |             |
| Interior Floor 2    |     |                |                                 |    |             |
| Heat Fuel           | 02  | Oil            |                                 |    |             |
| Heat Type           | 05  | Hot Water      |                                 |    |             |
| AC Type             | 03  | Central        |                                 |    |             |
| Bedrooms            | 03  | 3 Bedrooms     |                                 |    |             |
| Full Baths          | 2   |                |                                 |    |             |
| Half Baths          | 0   |                |                                 |    |             |
| Extra Fixtures      |     |                |                                 |    |             |
| Total Rooms         | 7   | 6 Rooms        |                                 |    |             |
| Bath Style          |     |                |                                 |    |             |
| Kitchen Style       |     |                |                                 |    |             |
| Occupancy           |     |                |                                 |    |             |
| Usrflid 105         |     |                |                                 |    |             |
| Accessory Apt       |     |                |                                 |    |             |
| Foundation Alt      | 09  | Blk/Pour Ftgs  |                                 |    |             |
| Rms Prts            |     |                |                                 |    |             |
| Bath Split          | 20  | 2 Full-0 Half  |                                 |    |             |

| CONDO DATA  |      |             |          |
|-------------|------|-------------|----------|
| Parcel Id   |      | C           | Ownr 0.0 |
| Adjust Type | Code | Description | Factor%  |
| Condo Flr   |      |             |          |
| Condo Unit  |      |             |          |

| COST / MARKET VALUATION  |         |
|--------------------------|---------|
| Building Value New       | 434,370 |
| Year Built               | 1860    |
| Effective Year Built     | 1979    |
| Depreciation Code        | A       |
| Remodel Rating           |         |
| Year Remodeled           |         |
| Depreciation %           | 31      |
| Functional Obsol         | 0       |
| External Obsol           | 5       |
| Trend Factor             | 1       |
| Condition                |         |
| Condition %              |         |
| Percent Good             | 64      |
| RCNLD                    | 278,000 |
| Dep % Ovr                |         |
| Dep Ovr Comment          |         |
| Misc Imp Ovr             |         |
| Misc Imp Ovr Comment     |         |
| Cost to Cure Ovr         |         |
| Cost to Cure Ovr Comment |         |

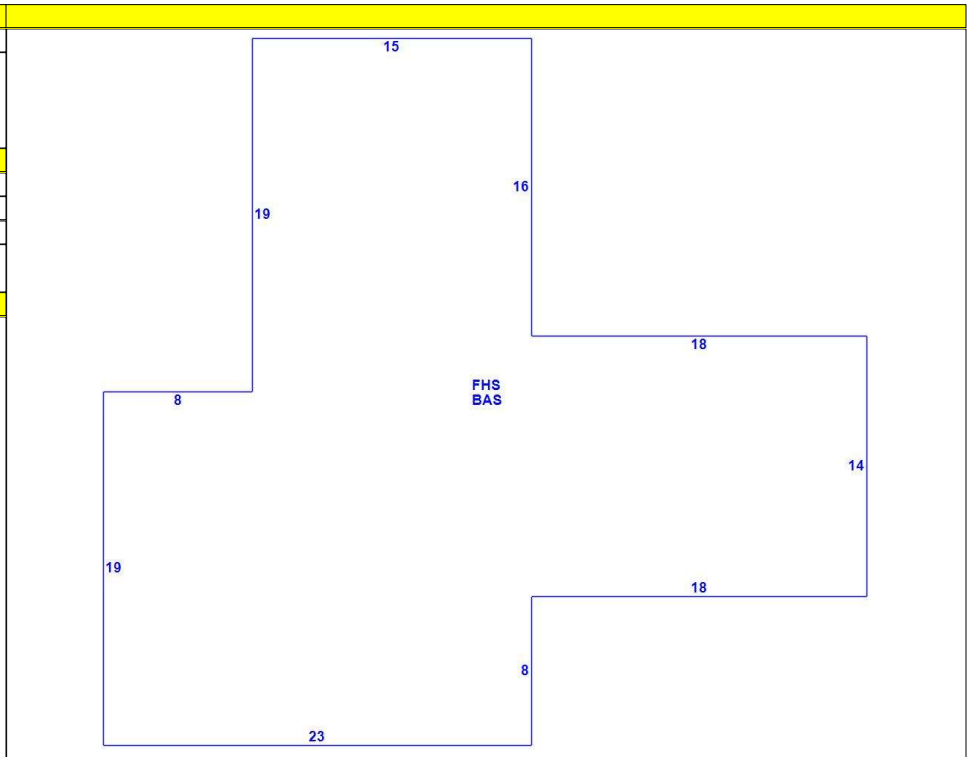

| OB - OUTBUILDING & YARD ITEMS(L) / XF - BUILDING EXTRA FEATURES(B) |                 |     |       |            |        |          |      |       |            |             |
|--|-----------------|-----|-------|------------|--------|----------|------|-------|------------|-------------|
| Code   | Description     | L/B | Units | Unit Price | Yr Blt | Cond. Cd | % Gd | Grade | Grade Adj. | Appr. Value |
| FPL2   | Fireplace 1.5 s | B   | 1     | 6000.00    | 1979   |          | 64   |       | 0.00       | 3,800       |

| BUILDING SUB-AREA SUMMARY SECTION |             |             |            |          |           |                |
|-----------------------------------|-------------|-------------|------------|----------|-----------|----------------|
| Code                              | Description | Living Area | Floor Area | Eff Area | Unit Cost | Undeprec Value |
| BAS                               | First Floor | 974         | 974        | 974      | 297.31    | 289,580        |
| FHS                               | Half Story  | 487         | 974        | 487      | 148.66    | 144,790        |
| Ttl Gross Liv / Lease Area        |             | 1,461       | 1,948      | 1,461    |           | 434,370        |

