

CURRENT OWNER		TOPO	UTILITIES	STRT / ROAD	LOCATION	CURRENT ASSESSMENT			
MARKS, ROBERT A & LEISA J	3	Below Street	2	Public Water		Description RESIDNTL RES LAND	Code 1010 1010	Assessed 428,900 246,900	Assessed 428,900 246,900
	4	Gas	1	Paved					
	6	Septic							
1065 PUTNAM AVENUE						<b>SUPPLEMENTAL DATA</b>			
MARSTONS MIL MA 02648		Alt Prcl ID Split Zonin BID Parcel ResExpt Q YES: #DL 1 LOT 5 #DL 2 GIS ID F_950772_2698384		Plan Ref. Land Ct# 39483-B #SR Life Estate PP STATU Assoc Pid#		Total 675,800 675,800			

801  
 FY2024  
 BARNSTABLE, MA  
**VISION**

RECORD OF OWNERSHIP		BK-VOL/PAGE	SALE DATE	Q/U	V/I	SALE PRIC	VC	PREVIOUS ASSESSMENTS (HISTORY)								
MARKS, ROBERT A & LEISA J FRANCO, NICHOLAS D TR GREENBRIER CORPORATION BAYSIDE BUILDING CO INC DACEY, BRIAN T	C117250	0	04-15-1989	Q	I	159,900	U	Year	Code	Assessed	Year	Code	Assessed	Year	Code	Assessed
	C115025	0	08-15-1988	Q	I	156,500	U	2023	1010	368,300	2022	1010	320,600	2021	1010	256,300
	C114226	0	05-15-1988	U	V	60,000	B		1010	224,400		1010	154,400		1010	156,800
	C109056	0	12-15-1986	U	V	1	B								1010	6,000
C109055	0	12-15-1986	U	V	1	B	Total		592,700	Total		475,000	Total		419,100	

EXEMPTIONS			OTHER ASSESSMENTS					
Year	Code	Description	Amount	Code	Description	Number	Amount	Comm Int
2024	5C	RESIDENTIAL EXEMPTION						
Total			0.00					

This signature acknowledges a visit by a Data Collector or Assessor

ASSESSING NEIGHBORHOOD			
Nbhd	Nbhd Name	B	Tracing
0107			MARSTM

APPRAISED VALUE SUMMARY	
Appraised Bldg. Value (Card)	381,000
Appraised Xf (B) Value (Bldg)	41,900
Appraised Ob (B) Value (Bldg)	6,000
Appraised Land Value (Bldg)	246,900
Special Land Value	0
Total Appraised Parcel Value	675,800
Valuation Method	C
Total Appraised Parcel Value	675,800

NOTES								

**LAND LINE VALUATION SECTION**

B	Use Code	Description	Zone	LA	Land Units	Unit Price	Size Adj	AC Disc	Site Index	Cond.	Nbhd.	Nbhd. Adj	Notes	Location Adjustmen	Adj Unit P	Land Value	
1	1010	Single Fam M-0	RF	3	1.000	AC	176,344.00	1.00000	1.0000	5	1.00	0107	1.400		1.0000	246,881.6	246,900

CONSTRUCTION DETAIL			CONSTRUCTION DETAIL (CONTINUED)		
Element	Cd	Description	Element	Cd	Description
Style	01	Ranch			
Model	01	Residential			
Grade:	C	Average			
Stories	1	1 Story			
Exterior Wall 1	14	Wood Shingle			
Exterior Wall 2	11	Clapboard			
Roof Structure	03	Gable/Hip			
Roof Cover	03	Asph/F Gls/Cmp			
Interior Wall 1	05	Drywall			
Interior Wall 2					
Interior Floor 1	14	Carpet			
Interior Floor 2	12	Hardwood			
Heat Fuel	03	Gas			
Heat Type	04	Hot Air			
AC Type	01	None			
Bedrooms	03	3 Bedrooms			
Full Baths	2				
Half Baths	0				
Extra Fixtures					
Total Rooms	7	7 Rooms			
Bath Style					
Kitchen Style					
Occupancy					
Usrflid 105					
Accessory Apt					
Foundation Alt	01	Poured Conc.			
Rms Prts					
Bath Split	20	2 Full-0 Half			

CONDO DATA				
Parcel Id		C	Owne	0.0
			B	S
Adjust Type	Code	Description	Factor%	
Condo Flr				
Condo Unit				

COST / MARKET VALUATION	
Building Value New	428,108
Year Built	1988
Effective Year Built	2005
Depreciation Code	G
Remodel Rating	
Year Remodeled	
Depreciation %	11
Functional Obsol	0
External Obsol	0
Trend Factor	1
Condition	
Condition %	
Percent Good	89
RCNLD	381,000
Dep % Ovr	
Dep Ovr Comment	
Misc Imp Ovr	
Misc Imp Ovr Comment	
Cost to Cure Ovr	
Cost to Cure Ovr Comment	

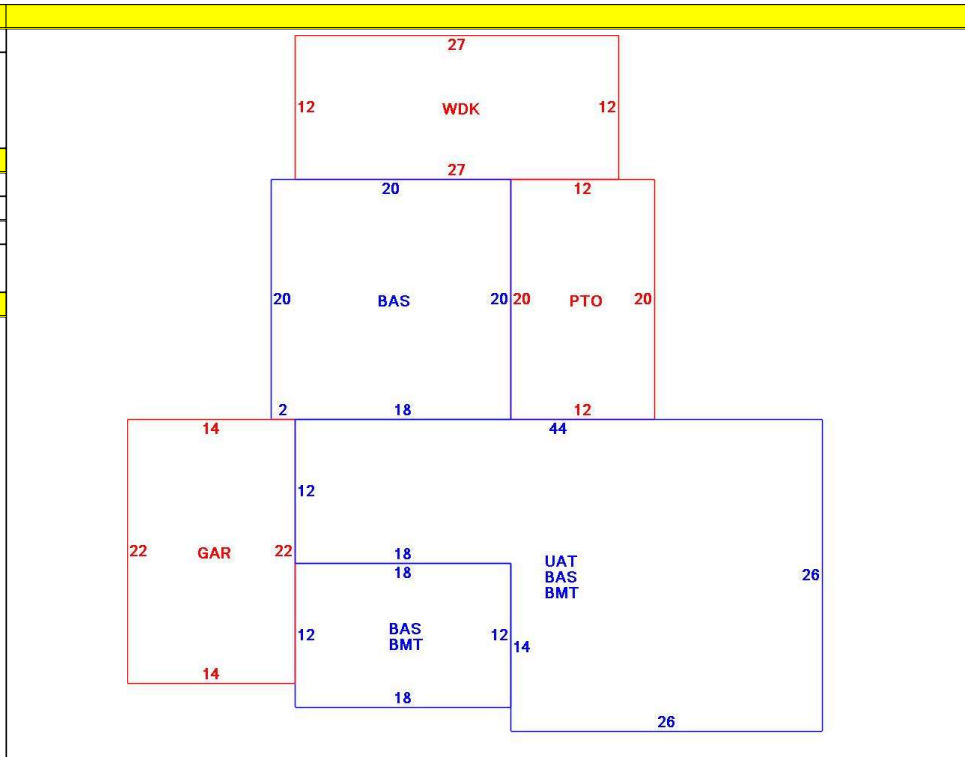

OB - OUTBUILDING & YARD ITEMS(L) / XF - BUILDING EXTRA FEATURES(B)										
Code	Description	L/B	Units	Unit Price	Yr Blt	Cond. Cd	% Gd	Grade	Grade Adj.	Appr. Value
FPL1	Fireplace 1 sto	B	1	5000.00	2007		89		0.00	4,500
WDC	Wood Decking	L	324	20.00	2000		62		0.00	4,000
PAT2	Patio-Good	L	240	9.94	2000		81		0.00	2,000
GAR	Attached Gara	B	308	40.00	2007		89		0.00	12,100
BMT	Basement-Unfi	B	1,108	26.01	2007		89		0.00	25,300

BUILDING SUB-AREA SUMMARY SECTION						
Code	Description	Living Area	Floor Area	Eff Area	Unit Cost	Undeprec Value
BAS	First Floor	1,508	1,508	1,508	268.07	404,250
BMT	Basement Area	0	1,108	0	0.00	0
GAR	Attached Garage	0	308	0	0.00	0
PTO	Patio	0	240	0	0.00	0
UAT	Attic, Unfinished	0	892	89	26.75	23,858
WDK	Wood Deck	0	324	0	0.00	0
Ttl Gross Liv / Lease Area		1,508	4,380	1,597		428,108

